

NOTES

- DO NOT SCALE FROM THIS DRAWING.
- ALL DIMENSIONS ARE IN MILLIMETRES U.N.O.
- ALL LEVELS ARE IN METRES ABOVE ORDANCE DATUM U.N.O.
- THIS DRAWING IS TO BE READ IN CONJUNCTION WITH ALL RELEVANT ARCHITECTS AND ENGINEERS DRAWINGS AND SPECIFICATIONS.

- MESA® OUTDOOR STEEL FLAT PEDESTALS AT 600MM CENTRES, OR EQUAL APPROVED PRODUCTS TO ARCHITECTS SPECIFICATION Q25 480A.
- KINLEY 30mm PERFORATED GALVANISED STEEL SURFACE SUPPORT ROOFTRAY (600x540x28) OR EQUAL APPROVED PRODUCTS. NBS Q25 480C.
- BRACKETS AND BASE PLATE FITTED TO PLANTER WALL AND ROOF TRAY RETROSPECTIVELY AS PER MANUFACTURER'S RECOMMENDATIONS NBS Q37 470A.
- 100mm RECYCLED POLYSTYRENE CUT TO HEIGHT OF PLANTER WALL AND AROUND BRACKETS, WALL FOR ROOT INSULATION AND PROTECTION FROM ELEMENTS.
- WALLS OF PLANTER TREATED WITH LIQUID APPLIED FLEXIBLE WATERPROOFING LAYER. ALL FIXINGS AND JOINTS TO BE SEALED WITH CLEAR, EXTERNALLY RATED SEALANT AS PER MANUFACTURERS RECOMMENDATIONS.
- KINLEY "PERIMITA" PLANTER, 6mm PREFORMED, POWDER COATED STEEL PLANTER OR EQUAL APPROVED PRODUCTS. COLOUR RAL6011 (GREEN). FIX DOWN TO PLATE USING 4 NO. SUPPLIED STAINLESS STEEL 4.5mm X 35mm SELF DRILLING SCREWS NBS Q37 470A.
- WAXMAN CERAMICS ROCKLAND GREY 600X600mm PORCELAIN TILE OR EQUAL APPROVED PRODUCT. STACK BOND, 3mm SPACER TABS. NBS Q25 127A.

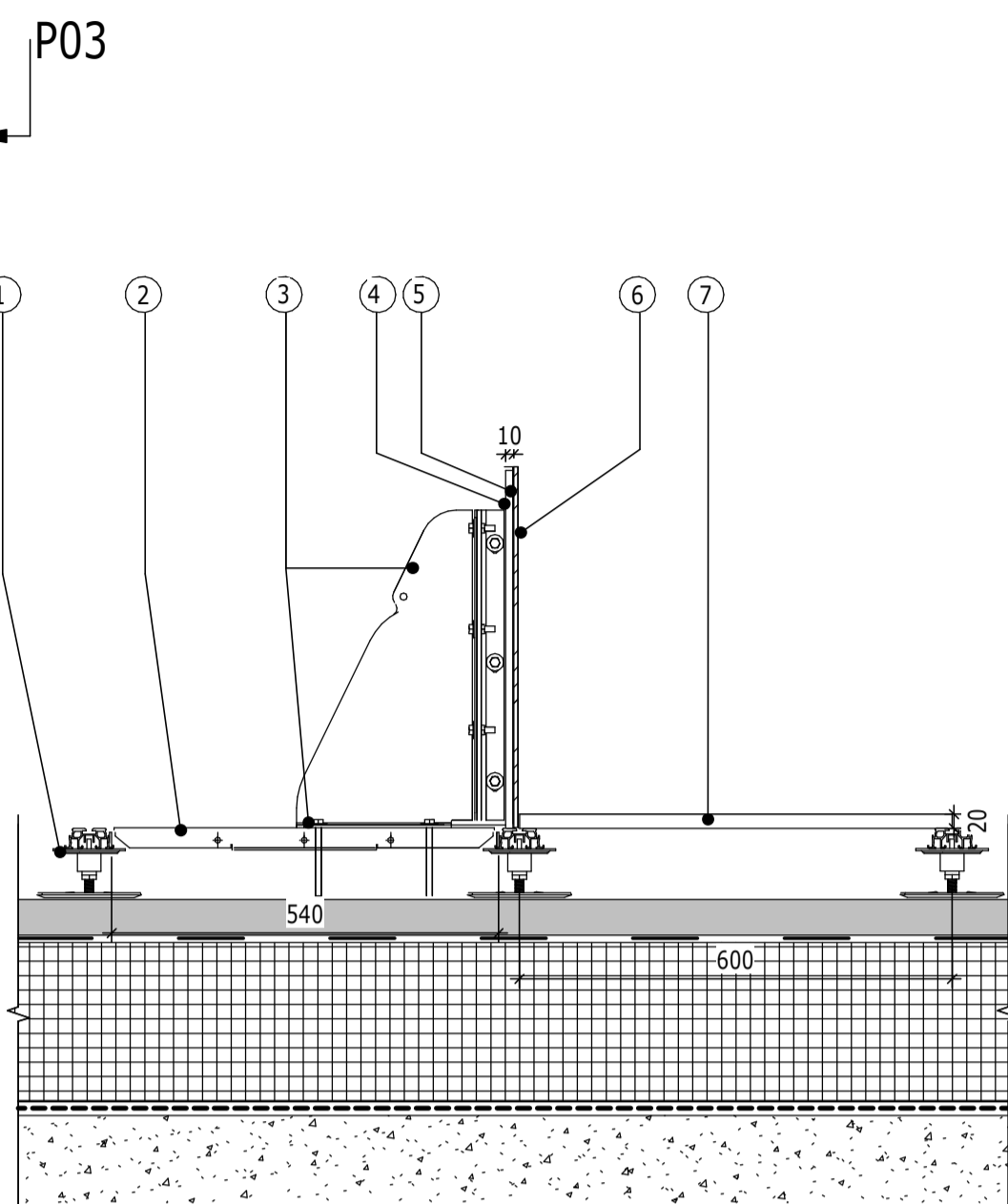

DETAIL 1
1 : 10
TYPICAL PLANTER INTERFACES

IN ABYCEANCE - SEEKING CLARIFICATION FROM ARCHITECTS ON BUILD UP AND DRAINAGE

- HERBACEOUS PLANTING: - REFER TO PLANT SCHEDULE KXC-S4-001-L-RAMXXX-91-0900.
- PERIMETER BULKHEAD WALL AS PER ENGINEER'S SPECIFICATION.
- BESPOKE FABRICATED 6mm PREFORMED, POWDER COATED STEEL PLANTER, COLOUR RAL9001 (WHITE) TO ARCHITECT'S SPECIFICATIONS, WITH CONDUIT FOR INTEGRATED LIGHTING AS PER EXTERNAL LIGHTING STRATEGY AND DESIGN DRAWINGS.
- 300mm DEEP LIGHTWEIGHT TOPSOIL. BELOW 300mm DEPTH, LIGHTWEIGHT SUBSOIL TO BE INSTALLED NBS Q28.
- SKY-GARDEN HDPE 20mm CUSPATED DRAINAGE BOARD W/FILTER FLEECE OR APPROVED EQUAL TO ENGINEERS SPEC. NBS Q37 350B
- XPS INSULATION AND BASE BUILD UP LAYERS TO ARCHITECT'S SPECIFICATION.
- DRAINAGE HOLES TO ARCHITECT'S SPECIFICATION.
- METAL BALUSTRADE, BY OTHERS.
- WAXMAN CERAMICS ROCKLAND GREY 600X600mm PORCELAIN TILE OR EQUAL APPROVED PRODUCT. STACK BOND, 3mm SPACER TABS. NBS Q25 127A.
- MESA® OUTDOOR STEEL FLAT PEDESTALS AT 600MM CENTRES, OR EQUAL APPROVED PRODUCTS TO ARCHITECTS SPECIFICATION Q25 480A.
- 50mm PEBBLE AND BASALT REFER TO ARCHITECTS DETAILS.

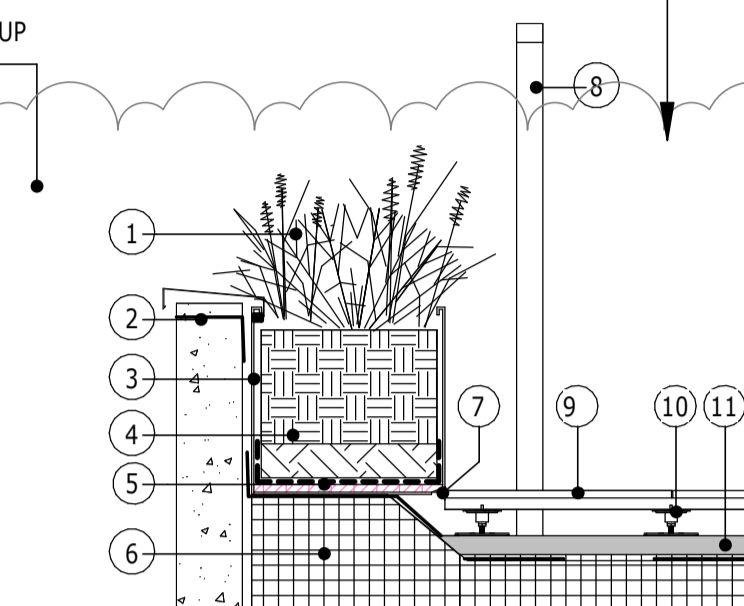

DETAIL 2
1 : 20
TYPICAL BULKHEAD PLANTER

- STRUCTURAL WALL AND EXTERNAL FACADE, TO ARCHITECTS' SPECIFICATION
- PLANTING, SEE PLANT SCHEDULE KXC-S4-001-L-RAMXXX-91-0900
- KINLEY "PERIMITA" PLANTER, 6mm PREFORMED, POWDER COATED STEEL PLANTER OR EQUAL APPROVED PRODUCT, COLOUR RAL9011 (GREEN) NBS Q37 470A. REAR PLANTER EDGE ABUTS EXTERNAL FACADE OF BUILDING.
- GEOTEXTILE FABRIC, TERRAM 1000 OR APPROVED EQUAL Q31 385.
- KINLEY PERFORATED GALVANISED STEEL ROOF TRAY OR EQUAL APPROVED PRODUCTS Q25 480C.
- 20mm RECYCLED POLYSTYRENE CUT TO HEIGHT OF PLANTER WALL AND AROUND BRACKETS, WALL FOR ROOT INSULATION AND PROTECTION FROM ELEMENTS (SOIL TO COVER TOP OF POLYSTYRENE)
- 300mm DEEP LIGHTWEIGHT TOPSOIL IN POWDER COATED MILD STEEL RAISED PLANTER. BELOW 300mm DEPTH, LIGHTWEIGHT SUBSOIL TO BE INSTALLED NBS Q28.
- IRRIGATION SYSTEM, TO SPECIALIST DESIGN.
- WAXMAN CERAMICS ROCKLAND GREY 600X600mm PORCELAIN TILE OR EQUAL APPROVED PRODUCT. STACK BOND, 3mm SPACER TABS. NBS Q25 127A.
- MESA® OUTDOOR STEEL FLAT PEDESTALS AT 600MM CENTRES, OR EQUAL APPROVED PRODUCTS TO ARCHITECTS SPECIFICATION Q25 480A.
- PEBBLE AND BASALT, REFER TO ARCHITECTS DETAILS.

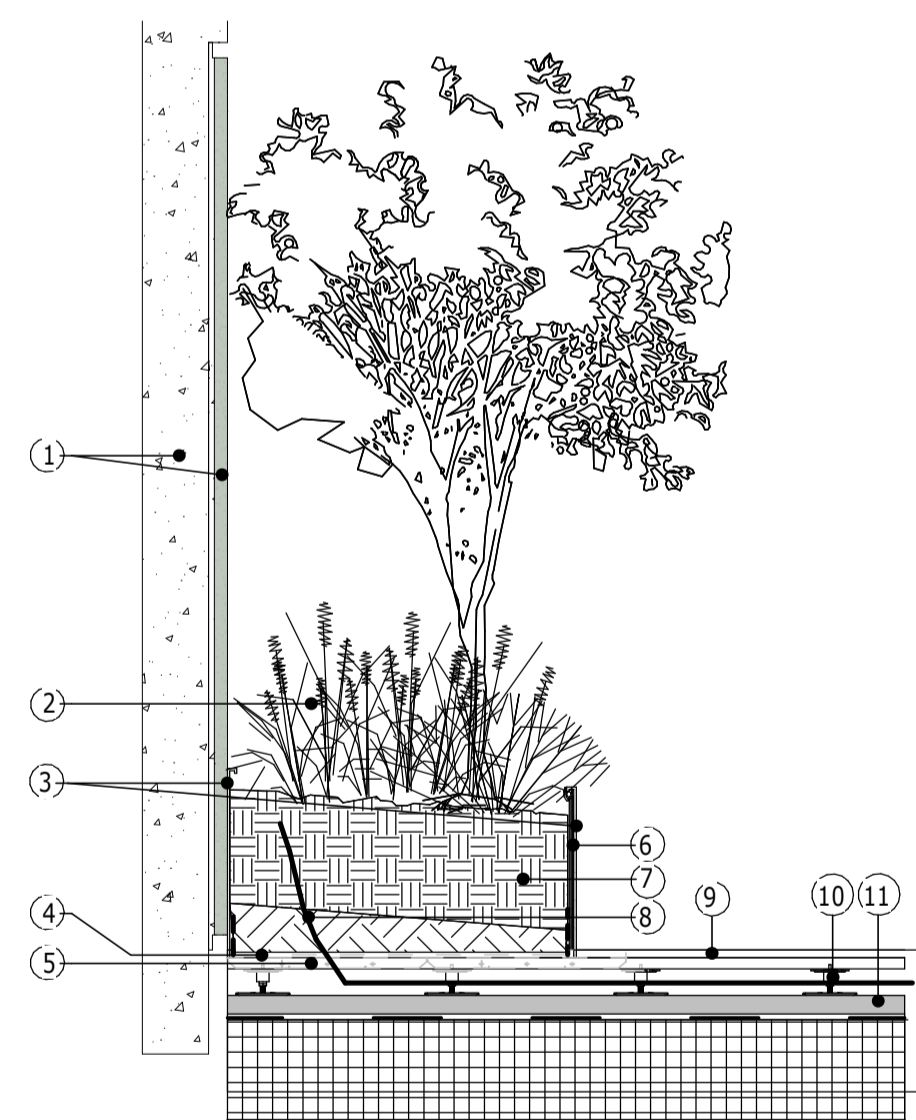

DETAIL 3
1 : 20
EXTERNAL FACADE/ PLANTER INTERFACE

- PERGOLA SLATS AND POSTS, BY OTHERS
- CLIMBING VINES, REFER TO PLANTING SCHEDULE: KXC-S4-001-L-RAMXXX-91-0900. CLIMBER LIGHTLY SECURED TO SUPPORTS WITH WIRE ROPE, TURNBUCKLE AND TENSIONER KIT ATTACHED DIRECTLY ONTO METAL PERGOLA WITH STAINLESS STEEL SCREW EYES AS PER NBS Q31 420.
- 300mm DEEP LIGHTWEIGHT TOPSOIL IN POWDER COATED MILD STEEL RAISED PLANTER. BELOW 300mm DEPTH, LIGHTWEIGHT SUBSOIL TO BE INSTALLED NBS Q28.
- KINLEY "PERIMITA" 6mm PREFORMED, POWDER COATED STEEL PLANTER OR EQUAL APPROVED PRODUCT, COLOUR RAL6011 (GREEN) NBS Q37 470A.
- 20mm RECYCLED POLYSTYRENE CUT TO HEIGHT OF PLANTER WALL AND AROUND BRACKETS, WALL FOR ROOT INSULATION AND PROTECTION FROM ELEMENTS. (SOIL TO COVER TOP OF POLYSTYRENE)
- GEOTEXTILE FABRIC, TERRAM 1000 OR APPROVED EQUAL Q31 385.
- KINLEY PERFORATED GALVANISED STEEL ROOF TRAY OR EQUAL APPROVED PRODUCT. Q25 480C.
- WAXMAN CERAMICS ROCKLAND GREY 600X600mm PORCELAIN TILE OR EQUAL APPROVED PRODUCT. STACK BOND, 3mm SPACER TABS. NBS Q25 127A.
- MESA® OUTDOOR STEEL FLAT PEDESTALS AT 600MM CENTRES, OR EQUAL APPROVED PRODUCTS TO ARCHITECTS SPECIFICATION Q25 480A.
- IRRIGATION SYSTEM, TO SPECIALIST DESIGN.
- PEBBLE AND BASALT REFER TO ARCHITECTS DETAILS.
- FILTER LAYER REFER TO ARCHITECTS DETAILS
- VARIABLE THICKNESS XPS INSULATION LAYER REFER TO ARCHITECTS DETAILS
- WATERPROOFING AND LEVELING SCREED REFER TO ARCHITECTS DETAILS

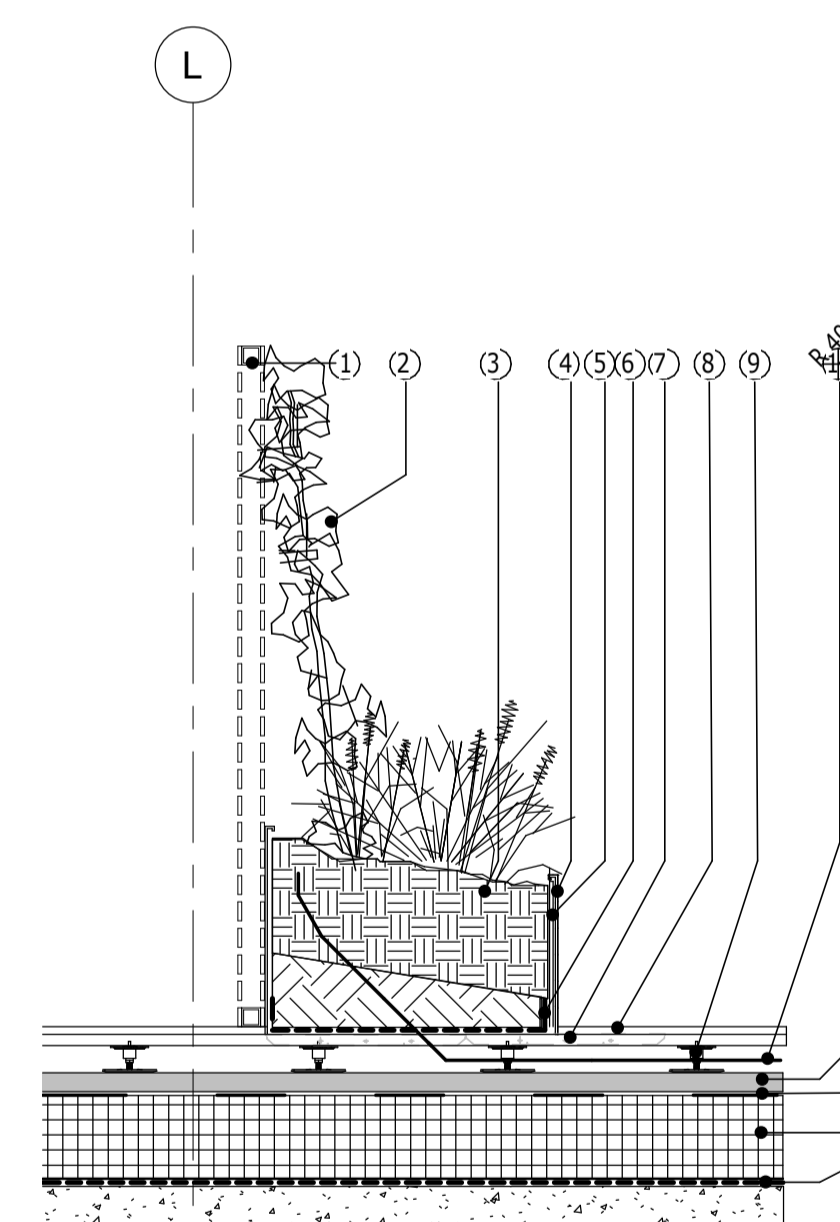

DETAIL 4
1 : 20
PERGOLA/ PLANTER INTERFACE

Rev	Description	Date	By	App
P03	STAGE 4 REISSUE WITH COMMENTS INCORPORATED	22/10/2021	AMQ RP	AD
P02	STAGE 4 REISSUE CORRECT DOC REF	27/09/2021	AMQ RP	AD
P01	STAGE 4 ISSUE	03/09/2021	JM RP	AD

STAGE 4

KINGS CROSS S4



www.ramboll.co.uk

LANDSCAPE DETAILS SHEET 3

Project No: 1620006900	Scale (@ A1): As indicated	Date: JULY 21	Drawn: JM
Drawing No: KXC-S4-001-L-RAMXXX-90-0503	Rev: P03		