

**PROPOSED EXTERIOR ELEVATION**  
1:10

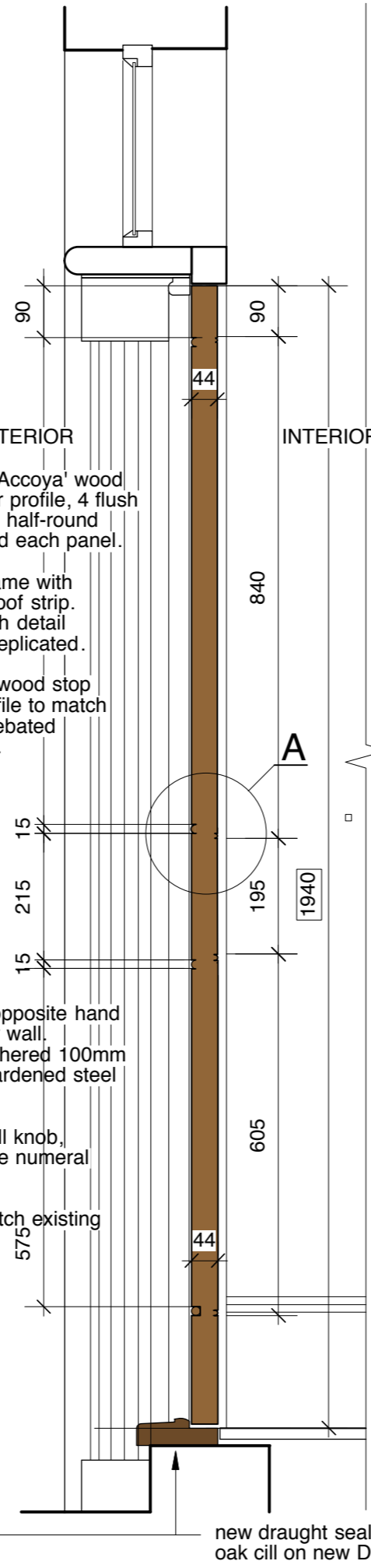

**PROPOSED SECTION A-A**  
1:10

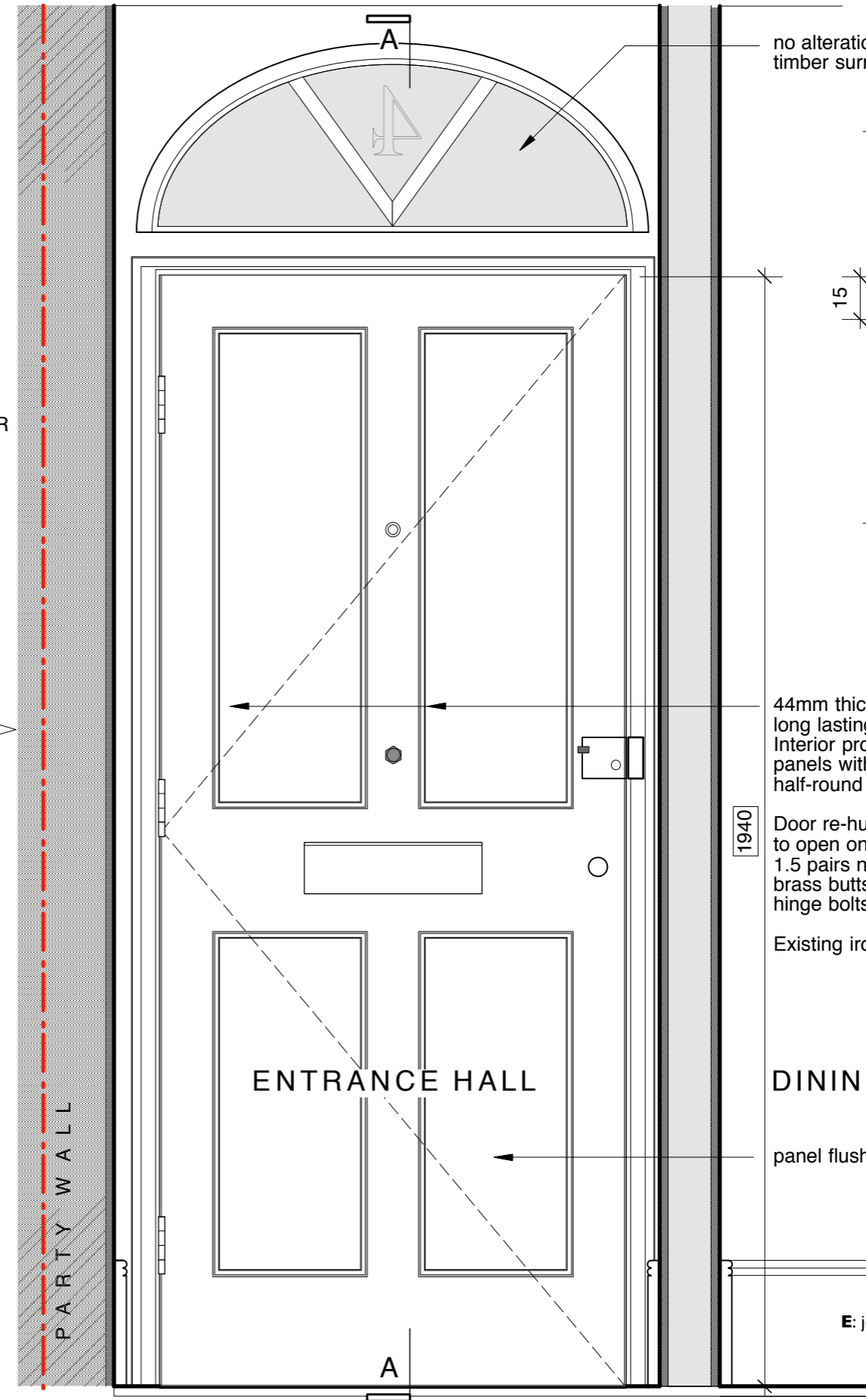

**PROPOSED INTERIOR ELEVATION**  
1:10

no alteration to fanlight glass or timber surround

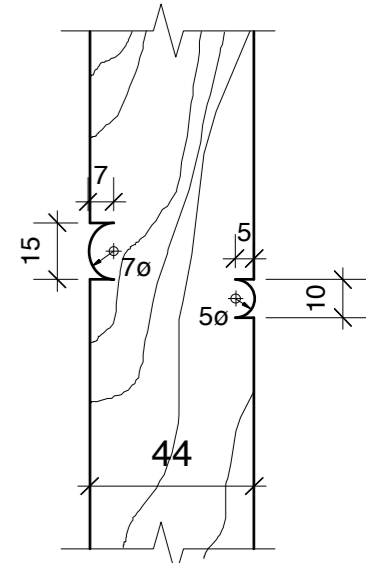

**DETAIL A**  
1-2

New 44mm thick 'Accoya' wood front door. Exterior profile, 4 flush panels with 15mm half-round reed routed around each panel.

New hardwood frame with integral draughtproof strip. Internal birdsmouth detail and corner bead replicated.

New exterior hardwood stop thickness and profile to match existing. Hidden rebated draughtproof strip.

Door re-hung on opposite hand to open onto party wall. 1.5 pairs new washered 100mm brass butts. 2 x hardened steel hinge bolts.

Existing centre pull knob, letterbox and house numeral re-instated.

Door colour to match existing

44mm thick 'Accoya' modified long lasting FSC timber. Interior profile, 4 flush panels with routed 10mm half-round reed to each panel.

Door re-hung on opposite hand to open onto party wall. 1.5 pairs new washered 100mm brass butts. 2 x hardened steel hinge bolts.

Existing ironmongery reinstated

**DINING ROOM**

panel flush with frame

E: john@greenarchitecture.co.uk  
T: +44 (0)7941 118819  
4 JEFFREYS STREET  
LONDON  
NW1 9PR

DO NOT SCALE DRAWINGS  
VERIFY ALL DIMENSIONS BEFORE COMMENCING WORK  
REPORT SUSPECTED DISCREPANCIES OR OMISSIONS  
© GREENARCHITECTURE

<b>APPLICANT</b> JOHN GREEN	<b>DRAWN</b> JG	<b>STATUS</b> PLANNING & LISTED BUILDING CONSENT
<b>PROJECT</b> PROPOSED REPLACEMENT FRONT DOOR AT 4 JEFFREYS STREET LONDON. NW1 9PR	<b>DATE</b> 15:03:2022	<b>SCALE</b> 1:10 and 1:2 @ A3
<b>DRAWING</b> PROPOSED DOOR - EXTERIOR FACE, INTERIOR FACE, SECTION AA - 1:10 JOINERY DETAIL - 1:2	<b>JOB N°</b> 4JS	<b>DRAWING N°</b> PL-03
		<b>ISSUE</b> P1