

no alteration to existing fanlight or timber surround

no alteration to timber fluted quarter pilasters, plain plinths and capitals

existing 36mm thick six panel door with applied bolelection mouldings to be removed. Existing door thermally poor and not secure to forced entry.

existing ironmongery to be removed and reinstated on new door.

existing extended half-round timber stop bead to be removed

existing timber door cill removed and replaced with new oak external draughtproofed cill on dpc

EXISTING EXTERIOR ELEVATION

1:10

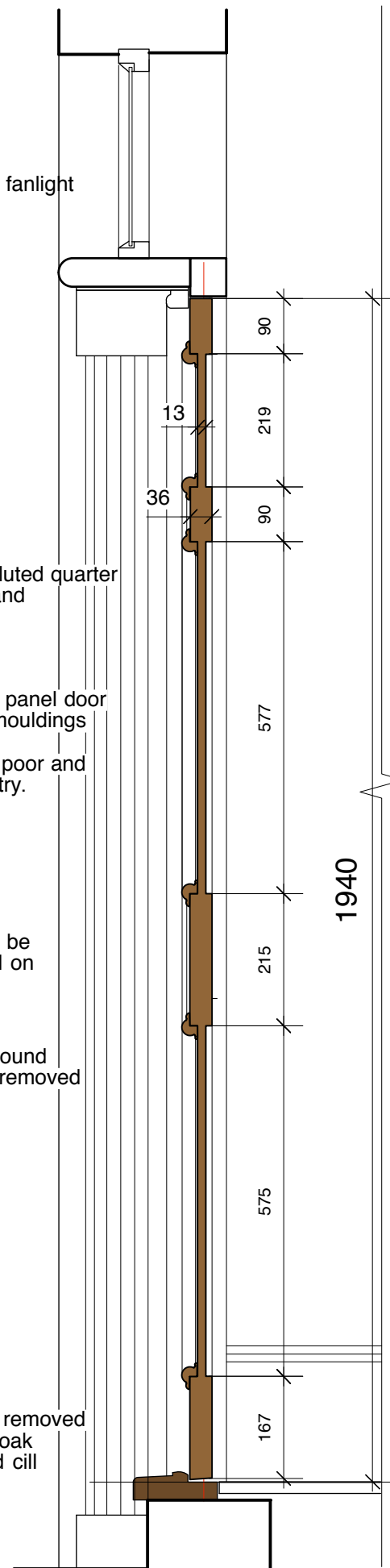

EXISTING SECTION A-A

1:10

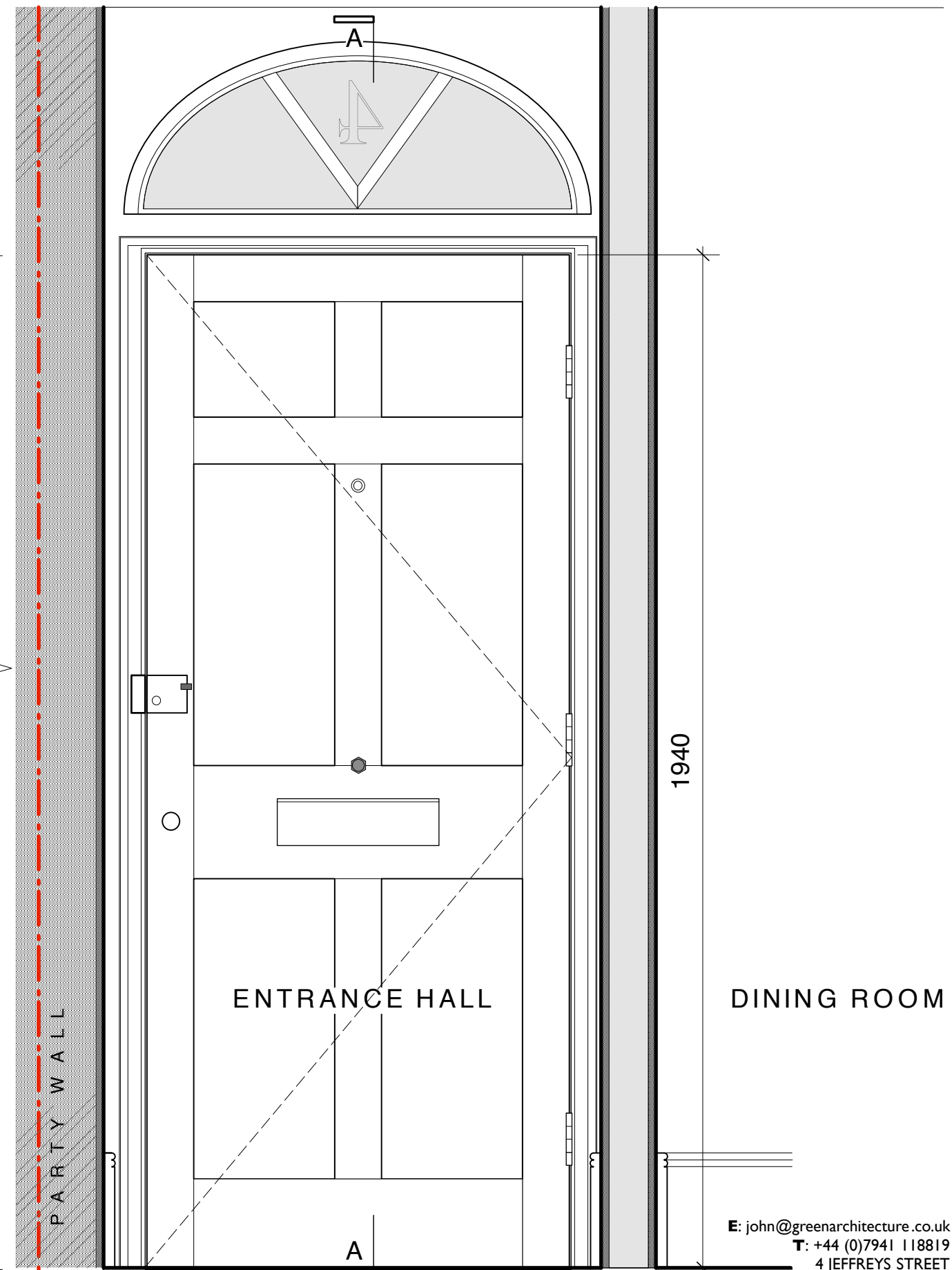

EXISTING INTERIOR ELEVATION

1:10

APPLICANT	DRAWN	STATUS
JOHN GREEN	JG	PLANNING & LISTED BUILDING
PROJECT	DATE	CONSENT
PROPOSED REPLACEMENT FRONT DOOR AT 4 JEFFREYS STREET LONDON. NW1 9PR	15:01:2022	SCALE
DRAWING	JOB N°	DRAWING N°
DOOR - EXISTING EXTERIOR FACE, INTERIOR FACE, SECTION AA - 1:10 JOINERY DETAIL - 1:2	4JS	PL-02
		ISSUE
		P1