

Rev	Date	By	Description
P1	11.08.18	JSO	Preliminary Issue
P2	29.08.18	JSO	Preliminary Issue
P3	13.03.19	JSO	Preliminary Issue

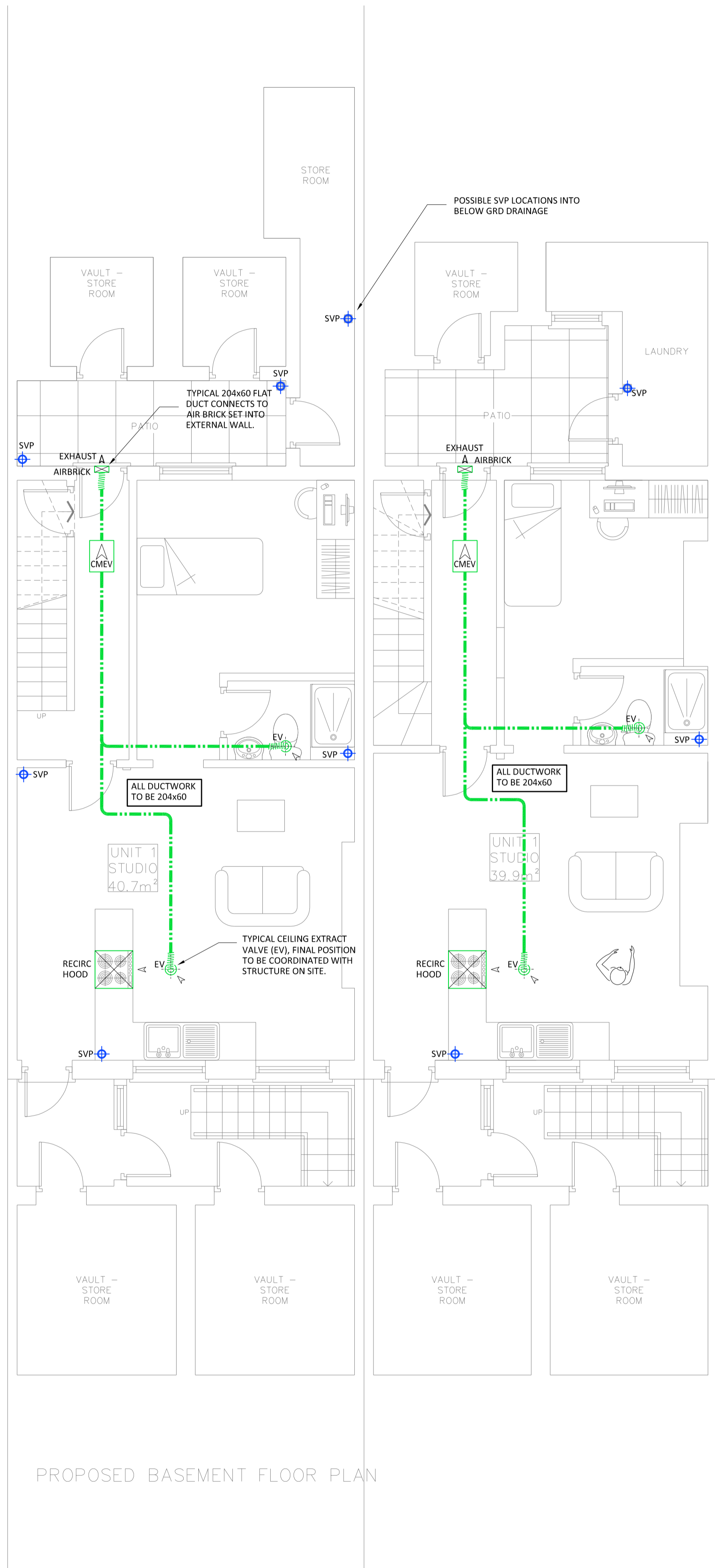

PROPOSED BASEMENT FLOOR PLAN

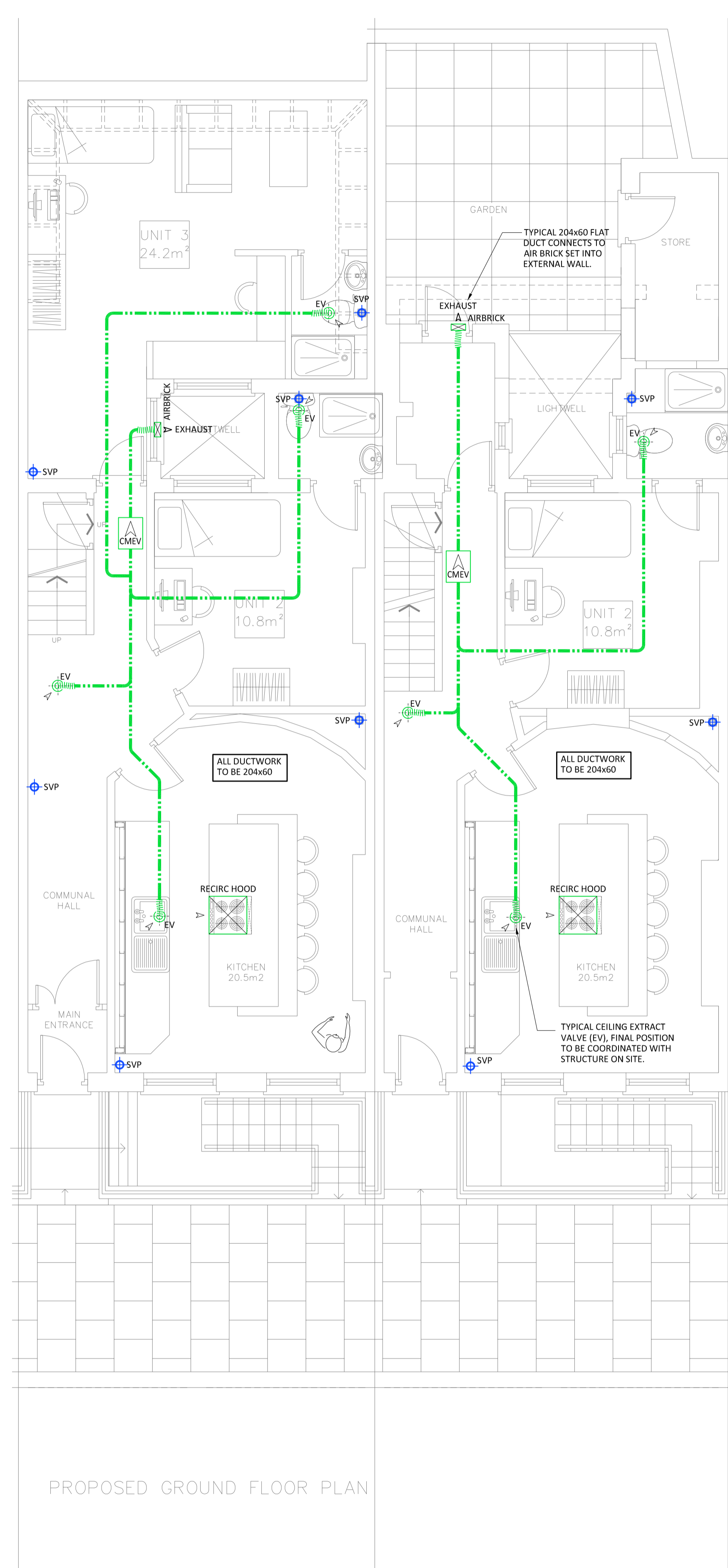

PROPOSED GROUND FLOOR PLAN

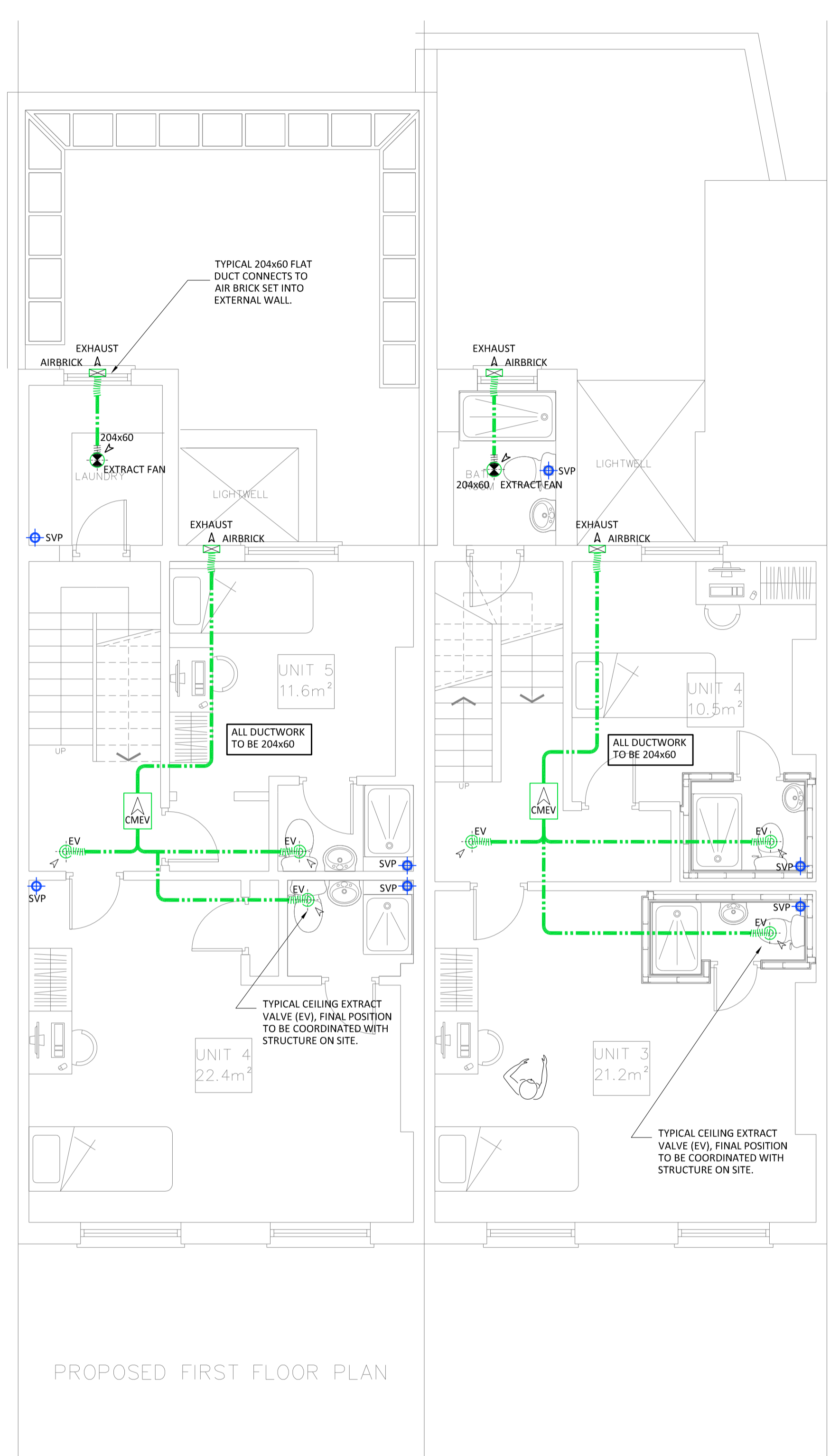

PROPOSED FIRST FLOOR PLAN

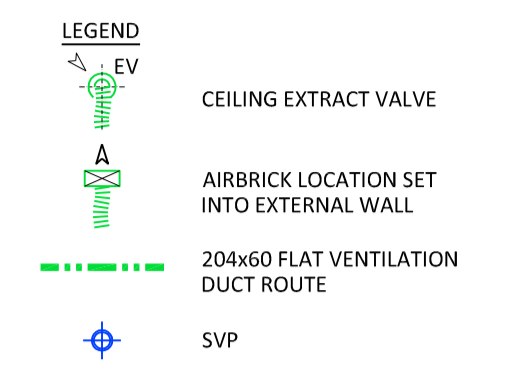

- DO NOT SCALE FROM THIS DRAWING. ALL DIMENSIONS ARE NOMINAL AND MUST BE CHECKED ON SITE.
- TO BE READ IN CONJUNCTION WITH ARCHITECTS AND ENGINEERING DRAWINGS, SPECIFICATIONS & SCHEDULES.
- THESE DRAWINGS ARE FOR INITIAL INFORMATION ONLY AND ARE SUBJECT TO CHANGE DURING FINAL DESIGN STAGE.
- THESE DRAWINGS ARE COPYRIGHT OF OAKLEY M&E. PLEASE OBTAIN PERMISSION BEFORE COPYING. THESE DRAWINGS MUST NOT BE MODIFIED OTHER THAN BY OAKLEY M&E.



99 Wey Hill, Haslemere, Surrey, GU27 1HT  
 Email Us - info@oakleymed.co.uk  
 Visit Us - www.oakleymed.co.uk  
 Call Us - 01403 785426

Client:  
**Oceanic Jewellers**

Project:  
**109 & 110 Guilford Street  
 London**

Title:  
**Mechanical Services  
 Extract Ventilation & SVP Layout  
 Basement, Ground & First Floor**

Date: 10.08.2018 Drawn: HH Checked: JSO Scale @ A1: 1:50

Xref: Xref-GuilfordSt-10-08-2018

Drawing Status:  
**Preliminary**

Drawing Number: **P1110-M-100** Rev: **P3**