

This drawing is the property of Architon LLP and must not be divulged to anyone, copied or reproduced, or used for marketing, advertising or promotional purposes without the express written permission of Architon LLP.

All dimensions are to be checked on site and not scaled from this drawing. Contractors must verify all dimensions on site before setting out, commencing work or preparing shop drawings. Any discrepancies on this drawing with other contract documentation to be reported immediately for clarification.

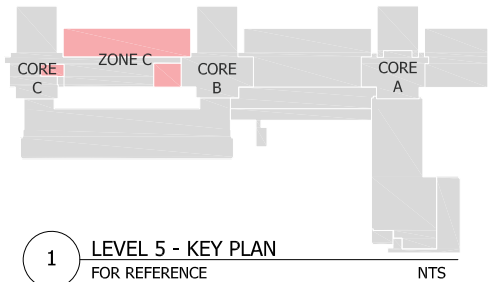

Notes



1 LEVEL 5 - KEY PLAN  
FOR REFERENCE

NTS

**ENSURE NO STRIP OUT, DEMOLITION OR BUILDING WORKS ARE UNDERTAKEN WITHOUT THE REQUIRED LISTED BUILDING AND PLANNING CONSENTS FROM THE LOCAL AUTHORITY AND ENGLISH HERITAGE.**

DRAWINGS ARE BASED ON INFORMATION PROVIDED BY UCL.

- DRAWINGS TO BE READ IN CONJUNCTION WITH:-
- ARCHITECTURAL DRAWINGS, SCHEDULES AND SPECIFICATIONS.
  - STRUCTURAL DRAWINGS AND SPECIFICATIONS.
  - M&E DRAWINGS AND SPECIFICATIONS.
  - ACOUSTIC REPORTS.
  - FIRE STRATEGY.

ALL WORKS TO BE FULLY CO-ORDINATED WITH MEP / STRUCTURAL PROPOSALS, AS APPROPRIATE.

ALL SETTING-OUT INFORMATION TO BE CHECKED AGAINST SITE DIMENSIONS

ALL WORKS TO BE IN ACCORDANCE WITH ALL STATUTORY REQUIREMENTS, WHERE AMENDED PROPOSALS DIFFER FROM THOSE APPROVED BY LA, NEW APPROVALS TO BE OBTAINED PRIOR TO COMMENCING WORKS.

FIRE RATED COMPONENTS TO BE IN ACCORDANCE WITH OVER-ARCHING FIRE STRATEGY FOR THE IOE.

ACOUSTIC RATED COMPONENTS TO BE IN ACCORDANCE WITH ACOUSTIC STRATEGY - PREPARED BY B.H.

## PLANNING ISSUE

P2	PLANNING ISSUE	07.03.2022
Rev	Description	Date

Client



Job title

University College London  
Institute of Education  
Woburn Square Package  
20 Bedford Way, WC1H 0AL

Drawing title

Level 5 - Zone C  
Proposed Wall & Window Finishes  
Planning Application WS1

Scale	Date	Drawn
1:100 @A1	FEB 22	MJR

## ARCHITON LLP

CHARTERED ARCHITECTS - DESIGN  
PLANNING CONSULTANTS - DEVELOPMENT  
BUILDING COST MANAGEMENT

UPPER DECK  
17A WEST STREET  
EPSOM KT18 7RL  
Email: info@architon.com

TEL: 01372 745600

Drawing No

3147-WS1-0508 P2

ARCHITON LLP  
certified to:  
BS EN ISO 9001  
BS EN ISO 14001  
ITP Accreditation

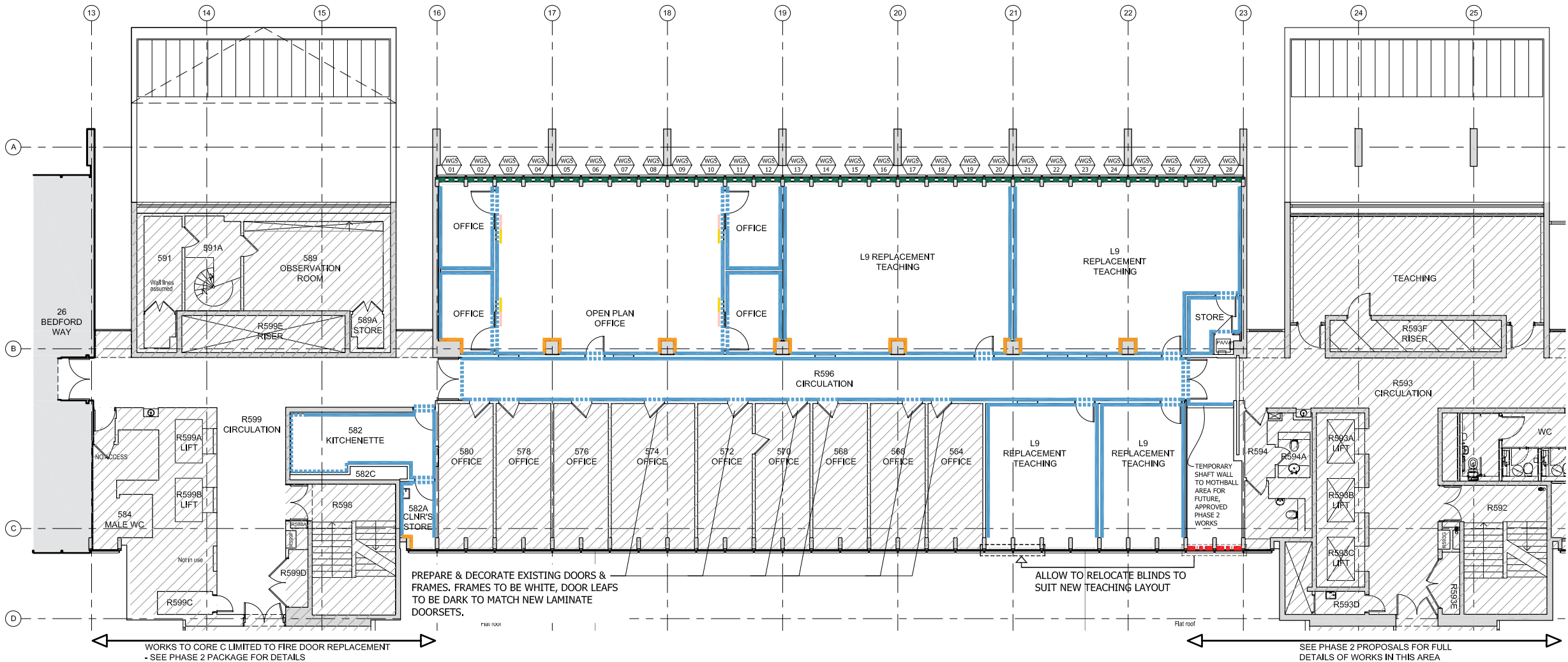

2 LEVEL 5 PLAN - WALL & WINDOW FINISHES  
1:100

### LEGEND

- AREA OUTSIDE SCOPE OF WORKS FOR WOBURN SQUARE PACKAGE, EXCEPT FOR MAKING GOOD WHERE DISTURBED
- WINDOW TREATMENT - GLARE BLINDS (MANUAL)
- WINDOW TREATMENT - OPAQUE WINDOW FILM
- WINDOW TREATMENT - MANIFESTATION
- WALL FINISH - WHITE MATT EMULSION PAINT  
- H/L ABOVE GLAZING / DOOR / OTHER
- ALL CONCRETE COLUMNS, MULLIONS, WALLS TO BE CLEANED AND HAVE ANY EXISTING PAINT FINISHES REMOVED
- HYGIENIC CLADDING IN THREE STANDARD COLOURS SUBJECT TO FINAL DESIGN - COLOUR TBC -
- IPS PANELING - REFER TO JOINERY PACKAGE/ TOILET DETAIL DRAWING FOR DETAIL
- BESPOKE JOINERY / ACOUSTIC CLADDING / LINING PANEL

CONTRACTOR TO REVIEW ALL WINDOWS AND PREPARE A SCHEDULE OF REMEDIAL WORKS REQUIRED TO MAKE EACH FULLY OPERATIONAL. THIS SHOULD INCLUDE REPLACEMENT OF HANDLES / SEALS/ RESTRICTORS /ETC AS MAY BE REQUIRED AS WELL AS GENERALLY CLEAN AND LUBRICATION.

ALL HIGH LEVEL PLASTERBOARD BULKHEADS TO BE FINISHED TO MATCH ADJACENT PARTITIONS / LININGS.

1:100 0 1 2 3 4 5m