

Revision	Date	Description
00	24-09-2021	For Planning Application

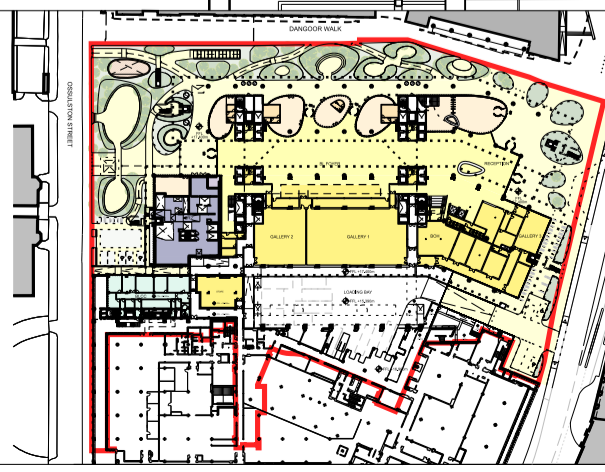

Legend
 BL Accommodation / BL Foyer / Circulation / Commercial Entrance / Retail / BOH
 Commercial Space
 BLCC
 Alan Turing Institute
 CR2
 Unassigned Areas

Internal arrangements are shown for illustrative purposes only and are not for determination (CR2 areas for fit-out by TfL).

NOTE: 1, 2, Community Garden: Please note that the landscaping shown is illustrative. It is anticipated that details will be developed following a co-design process with the community and submitted and approved pursuant to planning condition following the grant of planning permission.

3. Vent area: The area shown hatched beige is to be safeguarded for the provision of ventilation infrastructure for Crossrail 2. It is expected that such infrastructure would be consented pursuant to a separate approval process, to be applied for at a later date.

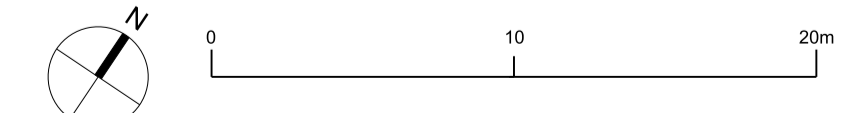

Drawing Purpose
FOR PLANNING APPLICATION

Drawn by RSHP	Checked by RSHP	Authorised by RSHP
-------------------------	---------------------------	------------------------------

Do not scale from drawing. The author of this drawing takes no responsibility for any dimensions obtained by measuring or scaling from this drawing and no reliance may be placed on such dimensions. If no dimension is given, it is the responsibility of the recipient to ascertain the dimension specifically from the author or by site measurement. The sizing of all structural and service elements must always be checked against the relevant engineers' drawings. No reliance should be placed upon sizing information shown on this drawing.

This drawing has been prepared at a preliminary stage of the design. It is indicative and illustrative only and has not been developed in detail. Further development of the design and clarification of design assumptions will result in changes and RSHP do not undertake any responsibility that this drawing will represent the final construction.

Project
BRITISH LIBRARY

Contact
Rogers Stirk Harbour + Partners

The Leadenhall Building
122 Leadenhall Street
London
EC3V 4AB

tel: 020 7385 1235
fax: 020 7385 8409
email: J11010@rsh-p.com
www.rsh-p.com

Drawing Title		
© copyright Rogers Stirk Harbour + Partners, all rights reserved 2021		
PROPOSED PLAN LEVEL LG		
Scale @ A1 1:250	Drawing Number RSHP-P-1149-P-LG	
Drawing Date 24-09-2021	Revision Date -	Revision 00

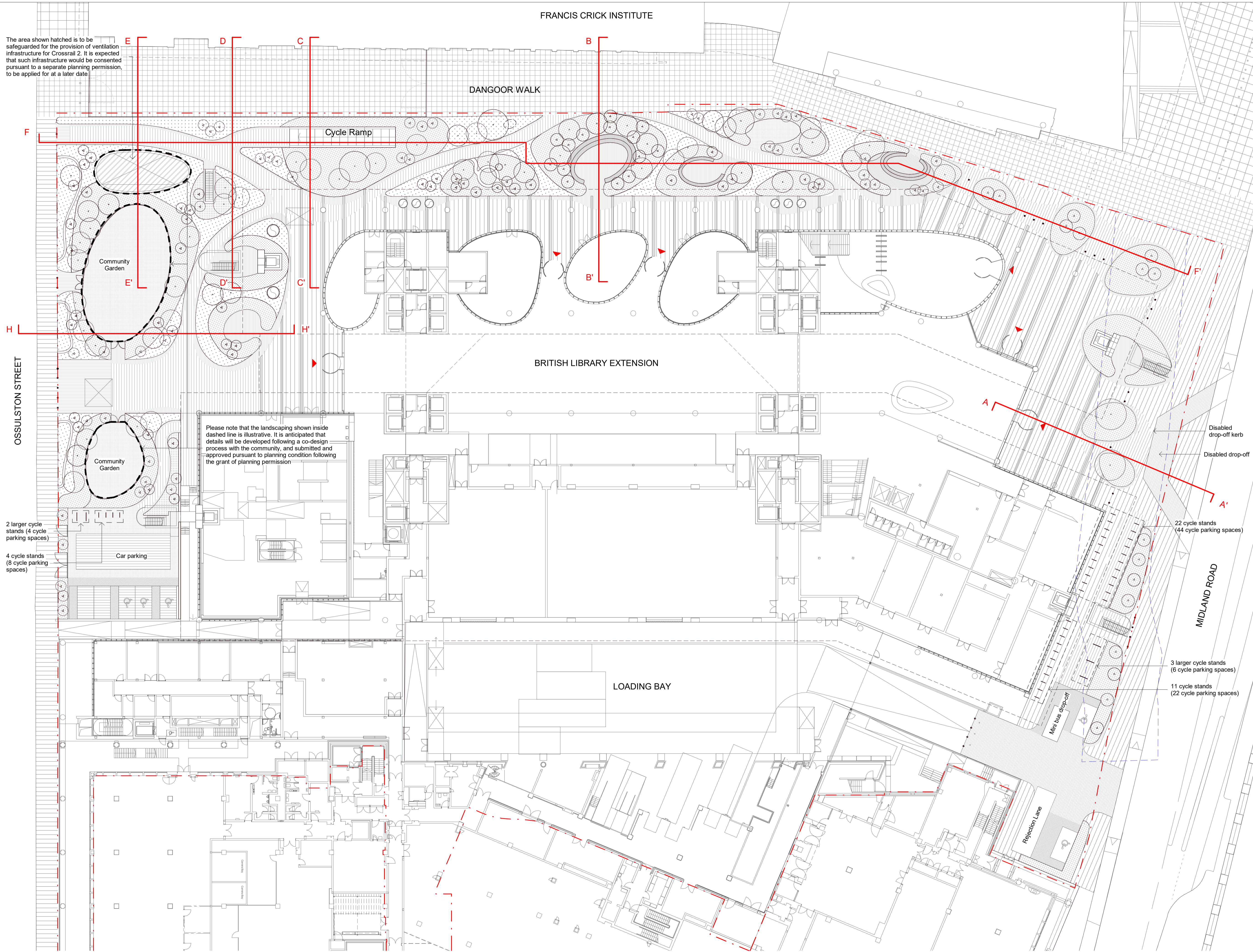

The area shown hatched is to be safeguarded for the provision of ventilation infrastructure for Crossrail 2. It is expected that such infrastructure would be consented pursuant to a separate planning permission, to be applied for at a later date

Please note that the landscaping shown inside dashed line is illustrative. It is anticipated that details will be developed following a co-design process with the community, and submitted and approved pursuant to planning condition following the grant of planning permission

2 larger cycle stands (4 cycle parking spaces)
4 cycle stands (8 cycle parking spaces)

GENERAL NOTES:
The layout of proposed new buildings is shown for reference only. Refer to the Architect's Planning drawings for details.
The detailed layout of landscaped areas and ancillary external areas will be subject to design development.
The precise setting out of finished levels, drainage, paving, planting and furniture will be the subject of non-material changes and may vary from the layouts shown in these plans. These minor alterations will not affect the location and arrangements of landscaped areas nor will they affect the relative relationship with existing and proposed buildings on site.
All materials shown or highlighted are indicative only and may be subject to changes made during detailed design development.
All structure is subject to ongoing design co-ordination and development.

Landscape design around facade subject to cleaning strategy requirements
Landscape layout beyond red line boundary indicative only

Existing levels subject to survey
- - - Site boundary
- - - Anticipated easement area for existing below ground services. Survey required
▶ Building Entrances

Soft Landscape
Soft Landscaping. Refer to Planting Plan on drawing 20.014 and Planting Schedule 60.001
○ Single Stem Tree
⊗ Multi Stem Tree

Hard Landscape
Existing Pavement
Natural stone paving Type 01
Natural stone paving Type 02
Natural stone paving Type 03
Natural stone paving Type 04
Natural stone paving Type 05
Permeable surface paving Type 05
Future planting area for the Community Garden
Timber decking Type 06
Mixed paving Type 07

Furniture
Seating
Cycle stand
Larger cycle stand
Bollards

Please refer to the Transport Report for further cycle parking details
Proposed location for insect houses and log piles, as per Ecologist's recommendations, to be coordinated in later stages of design development. Please refer to Ecology Report for proposed numbers of insect boxes and log piles.

P4	19/08/21	Issued for Planning
P3	13/08/21	Issued for Planning
P2	11/08/21	Issued for Planning
P1	30/07/21	Issued for Planning

PLANNING

DSDHA
357 Kennington Lane London SE11 5QY
T 020 7703 3555
F 020 7703 3890
E info@dsdha.co.uk
W www.dsdha.co.uk

project
British Library Public Realm
96 Euston Road, Somers Town, London, NW1 2DB

drawing title
Proposed Landscape Ground Floor GA Plan

drawn	size	date	scale
MT/MVR	A1	15/07/21	1:250
drawing number	revision		
273_20.011	P4		

REPORT DISCREPANCIES DO NOT SCALE FROM THIS DRAWING COPYRIGHT DSDHA
USE LATEST REVISION CHECK DIMENSIONS ON SITE



