

OSSLULSTON STREET

BRILL PLACE

BRITISH LIBRARY LAND

MIDLAND ROAD

NOTES

1. THIS DRAWING IS TO BE READ IN CONJUNCTION WITH ALL OTHER ARCHITECTS AND ENGINEERS DRAWINGS, SPECIFICATIONS AND DETAILS.
2. ALL DIMENSIONS ARE SHOWN IN MILLIMETRES UNLESS STATED OTHERWISE
3. DO NOT SCALE FROM THIS DRAWING
4. FOR MOVEMENT AND TOLERANCES REFER TO DRAWING No A041949-S-005
5. FOR GENERAL NOTES PLEASE REFER TO A041949-S-001/004
6. PILE DIAMETER INDICATED IS BASED ON INFORMATION PROVIDED IN SITE INVESTIGATION REPORT BY NORWEST HOLST DATED MARCH 2010. FINAL PILE DESIGN IS TO RELEVANT SUB-CONTRACTOR
7. FOR PILE DIAMETER, CUT OFF LEVELS AND PILE LOADS REFER TO PILING SCHEDULE DRAWING A041949-S-051
8. PILING NECESSARY FOR CRANE BASES ARE THE RESPONSIBILITY OF THE MAIN CONTRACTOR

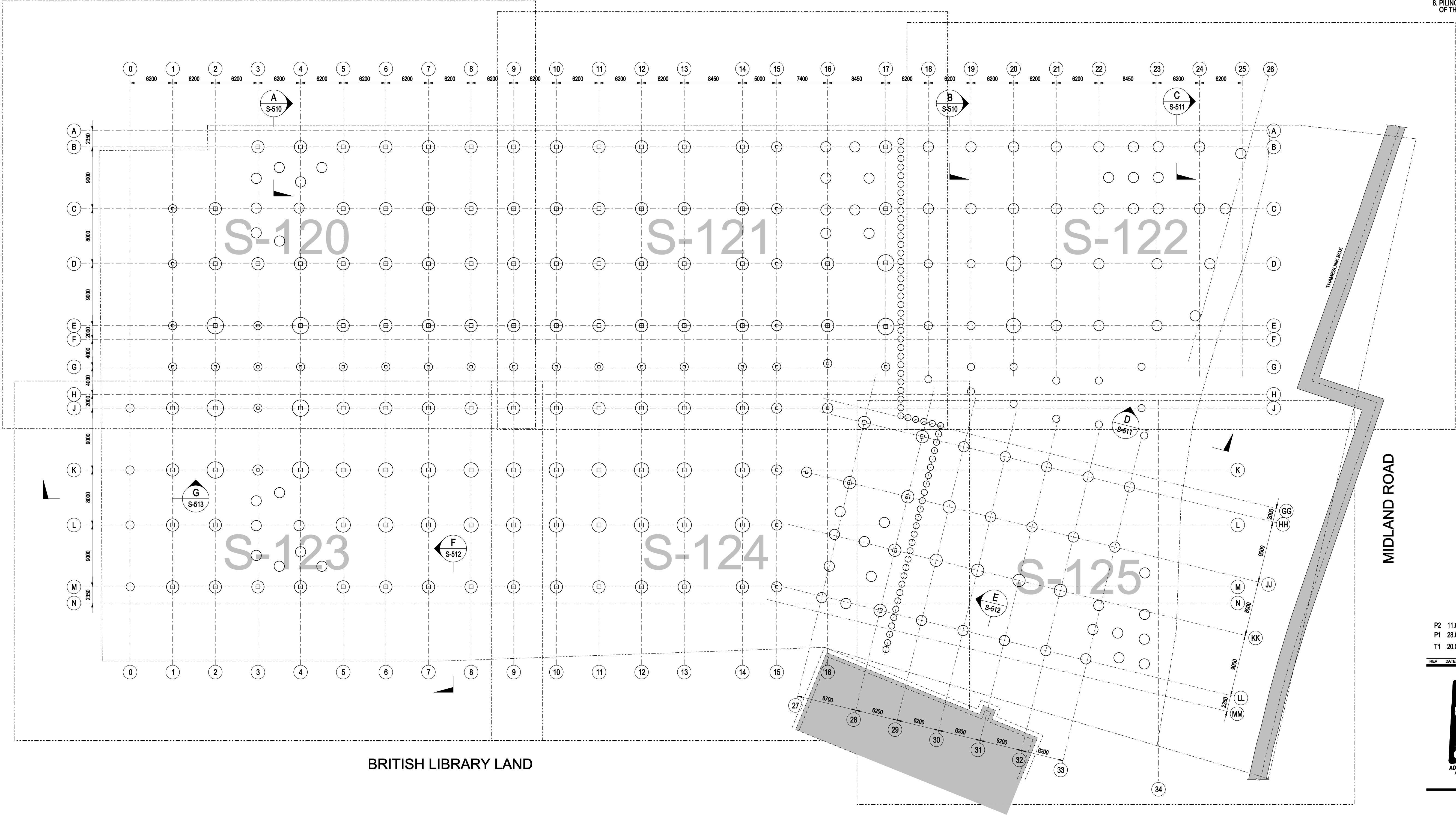

P2	11.02.11	ISSUED FOR STAGE D	TS	RP
P1	28.01.11	ISSUED FOR STAGE D - INFORMATION	BB	RP
T1	20.08.10	ISSUED FOR TENDER	BB	RP

REV	DATE	DESCRIPTION	BY	CHECKED
-----	------	-------------	----	---------



Consulting Structural and Civil Engineers
100 St. John Street
London EC1M 4ED
T +44 (0)20 7250 7777
F +44 (0)20 7250 7555
E info@akt-uk.com
W www.akt-uk.com

UKCMRI

CLIENT

UKCMRI

PROJECT

OVERALL
PILING LAYOUT

TITLE

DRAWN BB SCALE 1:300 @ A1 CAD FILENAME S-PLN-100.dgn

DATE JULY '10 CHECKED RP STATUS INFORMATION

A041949 S-PLN-100 P2

PROJECT No. DRAWING No. REVISION

PLOT DATE 11/02/2011 BY ben.bulder

FOR INFORMATION ONLY

1. THIS DRAWING IS TO BE READ IN CONJUNCTION WITH ALL OTHER ARCHITECTS AND ENGINEERS DRAWINGS, SPECIFICATIONS AND DETAILS.
2. ALL DIMENSIONS ARE SHOWN IN MILLIMETRES UNLESS STATED OTHERWISE
3. DO NOT SCALE FROM THIS DRAWING
4. FOR MOVEMENT AND TOLERANCES REFER TO DRAWING No A041949-S-005
5. FOR GENERAL NOTES PLEASE REFER TO A041949-S-001/004

OSSULSTON STREET



REV	DATE	DESCRIPTION	BY	CHECKED
-----	------	-------------	----	---------



CLIENT

PROJECT

TITLE

A041040 C D L N 101 D2

PERSONNEL YEAR	WORKING YEAR	PERSONNEL YEAR

PLOT DATE 11/02/2011 BY ben.butler

FOR INFORMATION ONLY

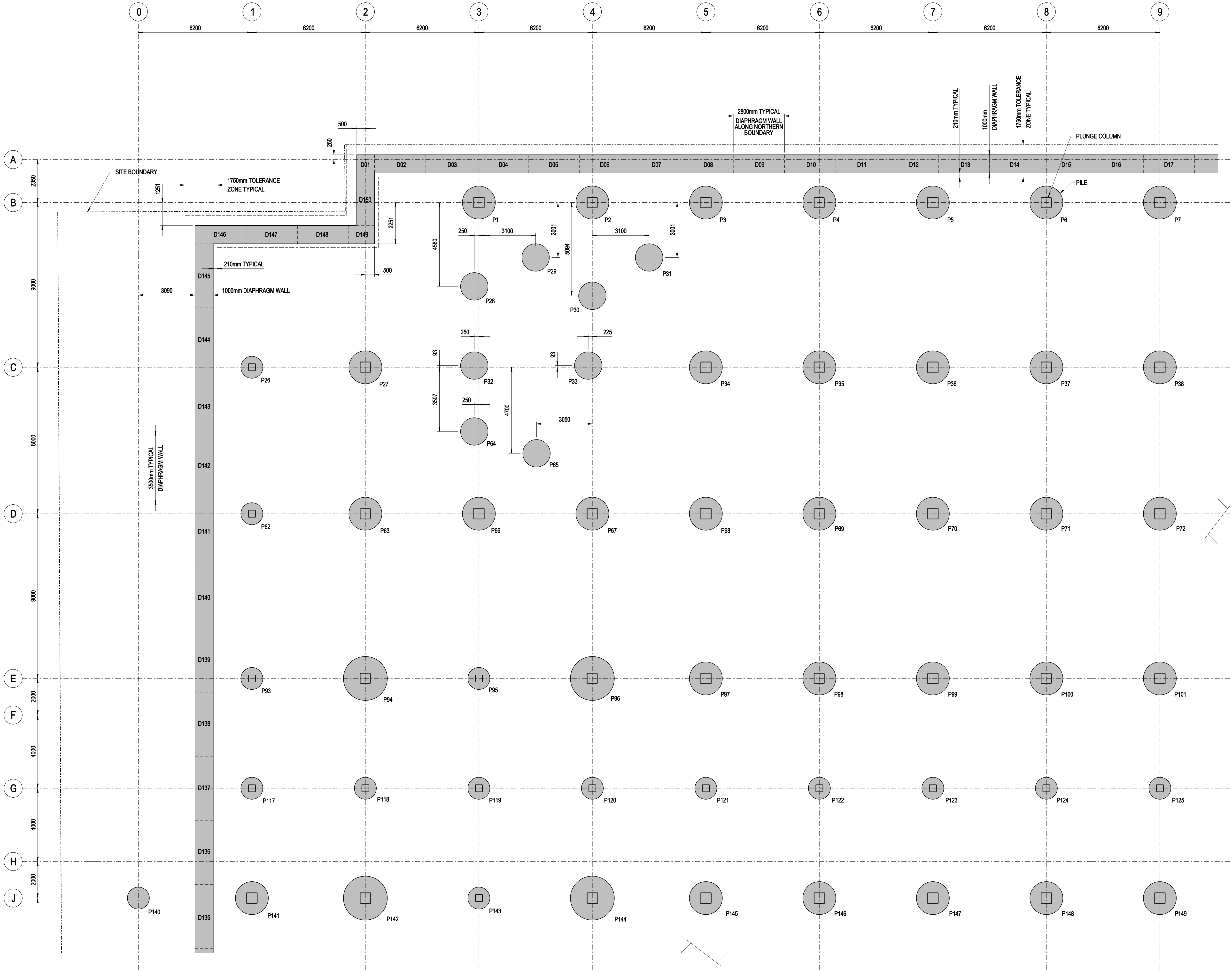

- NOTES
1. THIS DRAWING IS TO BE READ IN CONJUNCTION WITH ALL OTHER ARCHITECTS AND ENGINEERS DRAWINGS, SPECIFICATIONS AND DETAILS.
 2. ALL DIMENSIONS ARE SHOWN IN MILLIMETRES UNLESS STATED OTHERWISE
 3. DO NOT SCALE FROM THIS DRAWING
 4. FOR MOVEMENT AND TOLERANCES REFER TO DRAWING No S-GEN-005
 5. FOR GENERAL NOTES PLEASE REFER TO S-GEN-001/004
 6. PILE DIAMETER INDICATED ARE BASED ON INFORMATION OBTAINED FROM SITE INVESTIGATION REPORT. FOR DETAIL OF FULL SITE INVESTIGATION REFER TO NORTHWEST HOLST REPORT REF: F15469, No. F02, REVISION "FINAL" DATED 31/03/2010 AND ADDENDUM "ADDITIONAL TRIAL PITS ALONG THE NORTHERN BOUNDARY WALL" REF F15469/F03-ADD, DATED 27/07/2010
 7. FOR PILE DIAMETER, CUT OFF LEVELS AND DETAILS ON PLUNGE COLUMNS REFER TO SCHEDULES ON DRAWING S-GEN-051/052
 8. FOR ASSUMED INSTALLATION TOLERANCES OF PILES, DIAPHRAGM WALL PANELS AND PLUNGE COLUMNS REFER TO DRAWING S-GEN-010 AND 011
 9. PILING NECESSARY FOR CRANE BASES ARE THE RESPONSIBILITY OF THE MAIN CONTRACTOR
 10. FOR CDM PROJECT RISKS REFER TO SECTION 10 OF GENERAL NOTES DRAWING S-GEN-003

FINAL DESIGN OF PILES, PLUNGE COLUMNS AND EMBEDDED RETAINING WALLS BY RELEVANT SUB-CONTRACTOR

FOR CONTINUATION OF PILING AND DIAPHRAGM WALL SEE DRAWING No. S-FND-121

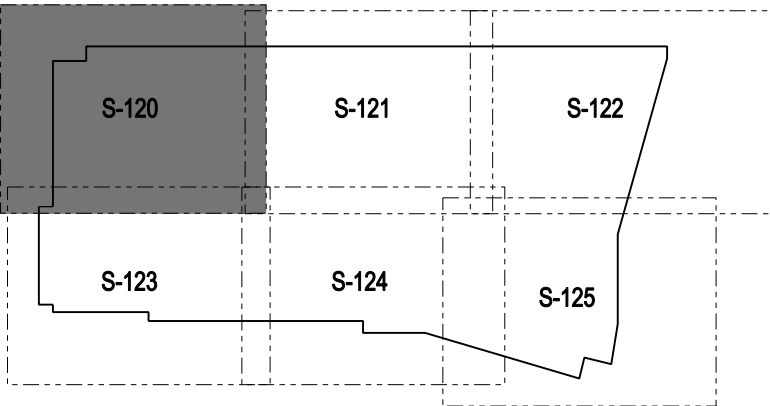

KEY PLAN

P2	11.02.11	ISSUED FOR STAGE D	TS	RP
P1	28.01.11	ISSUED FOR STAGE D - INFORMATION	BB	RP
T1	20.09.10	ISSUED FOR TENDER	BB	RP

REV	DATE	DESCRIPTION	BY	CHECKED
-----	------	-------------	----	---------



Consulting Structural and Civil Engineers
100 St. John Street
London EC1M 4ED
T +44 (0)20 7250 7777
F +44 (0)20 7250 7555
E info@akt-uk.com
W www.akt-uk.com

UKCMRI

CLIENT

UKCMRI

PROJECT

PILING AND DIAPHRAGM WALL
SHEET 1 OF 6

TITLE

DRAWN BB SCALE 1:100 @ A1 CAD FILENAME S-FND-120.dgn

DATE JULY '10 CHECKED RP STATUS INFORMATION

A041949 S-FND-120 P2

PROJECT No. DRAWING No. REVISION

PLOT DATE 11/02/2011 BY ben.bulder

FOR CONTINUATION OF PILING AND DIAPHRAGM WALL SEE DRAWING No. S-FND-123

FOR INFORMATION ONLY



FOR CONTINUATION OF PILING AND DIAPHRAGM WALL SEE DRAWING NO. S-FND-120

FOR CONTINUATION OF PILING AND DIAPHRAGM WALL SEE DRAWING No. S-FND-124

FOR INFORMATION ONLY

- FINAL DESIGN OF PILES,
PLUNGE COLUMNS AND EMBEDDED
RETAINING WALLS BY RELEVANT
SUB-CONTRACTOR**



P2	11.02.11	ISSUED FOR STAGE D	TS	RP
P1	28.01.11	ISSUED FOR STAGE D - INFORMATION	BB	RP
T1	20.09.10	ISSUED FOR TENDER	BB	RP

REV	DATE	DESCRIPTION	BY	CHECKED
-----	------	-------------	----	---------



Consulting Structural and Civil Engineers
100 St. John Street
London EC1M 4EH
T +44 (0)20 7250 7777
F +44 (0)20 7250 7555
E info@akt-uk.com
W www.akt-uk.com

UKCMRI

CUENT

UKCMRI

PROJE

PILING AND DIAPHRAGM WALL
SHEET 2 OF 6

TITLE

BB 1:100 @ A1 S-FND-121.dgn

DATE	JULY '10	CHECKED	RP	STATUS	INFORMATION
------	----------	---------	----	--------	-------------

A041949	S-FND-121	P2
PROJECT No.	DRAWING No.	REVISION

FOR CONTINUATION OF PILING AND DIAPHRAGM WALL SEE DRAWING No. S-FND-121

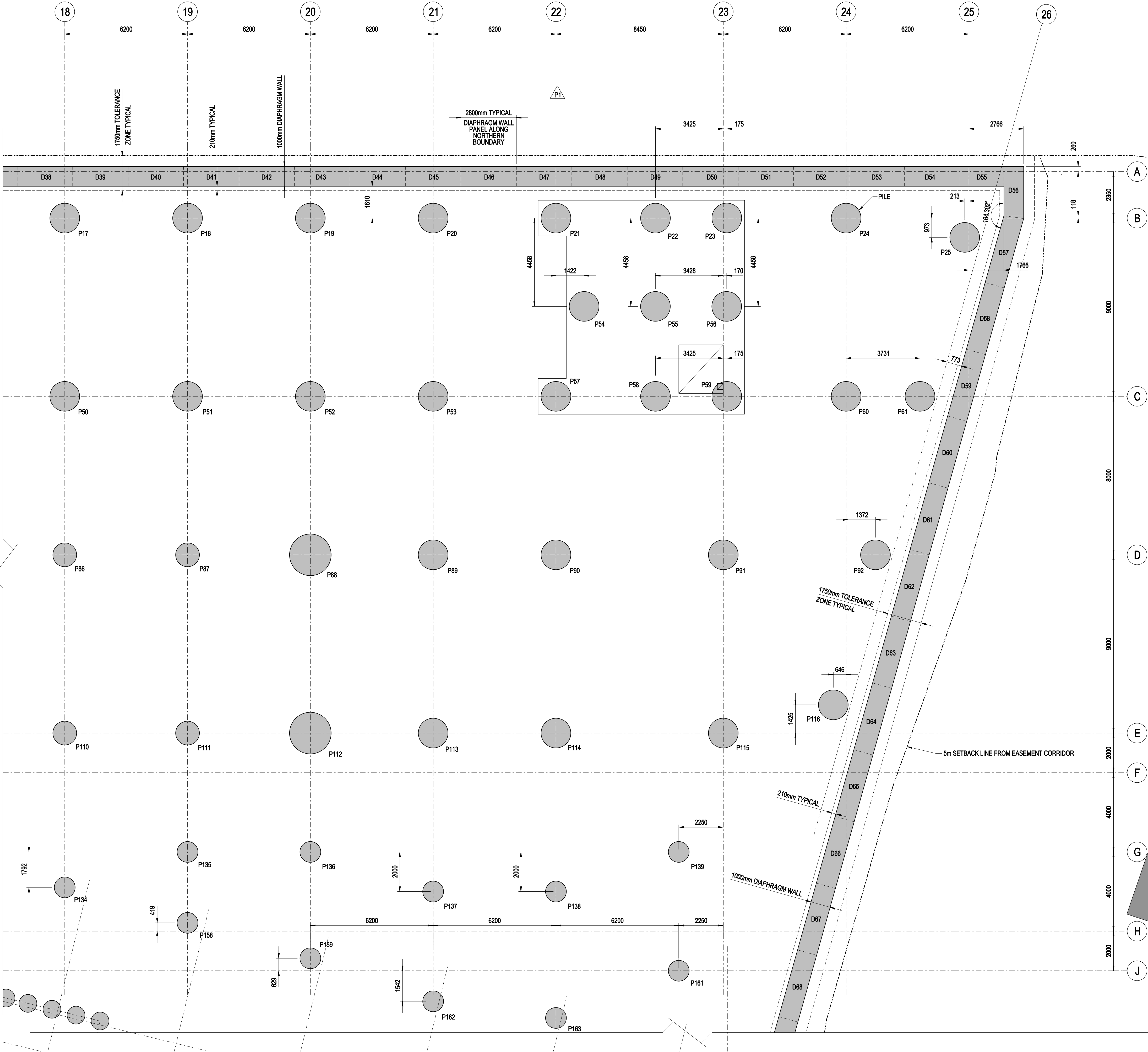

FOR CONTINUATION OF PILING AND DIAPHRAGM WALL SEE DRAWING No. S-FND-125

FOR INFORMATION ONLY

- NOTES
1. THIS DRAWING IS TO BE READ IN CONJUNCTION WITH ALL OTHER ARCHITECTS AND ENGINEERS DRAWINGS, SPECIFICATIONS AND DETAILS.
 2. ALL DIMENSIONS ARE SHOWN IN MILLIMETRES UNLESS STATED OTHERWISE
 3. DO NOT SCALE FROM THIS DRAWING
 4. FOR MOVEMENT AND TOLERANCES REFER TO DRAWING No S-GEN-005
 5. FOR GENERAL NOTES PLEASE REFER TO S-GEN-001/004
 6. PILE DIAMETER INDICATED ARE BASED ON INFORMATION OBTAINED FROM SITE INVESTIGATION REPORT. FOR DETAIL OF FULL SITE INVESTIGATION REFER TO NORTHWEST HOLST REPORT REF: F15469 No. F02, REVISION "FINAL" DATED 31/03/2010 AND ADDENDUM "ADDITIONAL TRIAL PITS ALONG THE NORTHERN BOUNDARY WALL" REF F15469/F03-ADD, DATED 27/07/2010
 7. FOR PILE DIAMETER, CUT OFF LEVELS AND DETAILS ON PLUNGE COLUMNS REFER TO SCHEDULES ON DRAWING S-GEN-051/052
 8. FOR ASSUMED INSTALLATION TOLERANCES OF PILES, DIAPHRAGM WALL PANELS AND PLUNGE COLUMNS REFER TO DRAWING S-GEN-010 AND 011
 9. PILING NECESSARY FOR CRANE BASES ARE THE RESPONSIBILITY OF THE MAIN CONTRACTOR
 10. FOR CDM PROJECT RISKS REFER TO SECTION 10 OF GENERAL NOTES DRAWING S-GEN-003

FINAL DESIGN OF PILES, PLUNGE COLUMNS AND EMBEDDED RETAINING WALLS BY RELEVANT SUB-CONTRACTOR

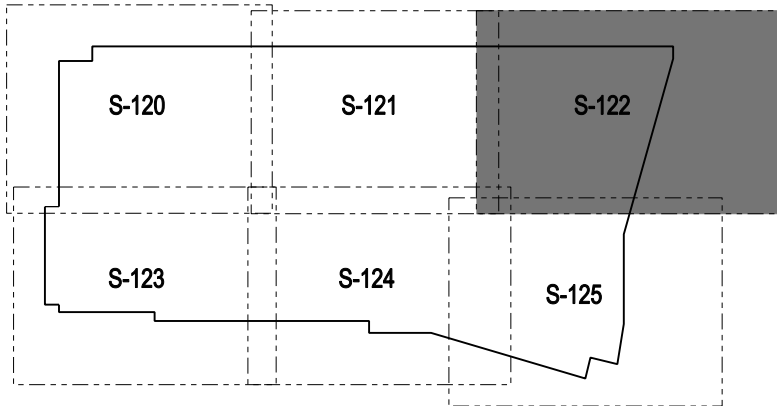

KEY PLAN

P2	11.02.11	ISSUED FOR STAGE D	TS	RP
P1	28.01.11	ISSUED FOR STAGE D - INFORMATION	BB	RP
T1	20.09.10	ISSUED FOR TENDER	BB	RP

REV	DATE	DESCRIPTION	BY	CHECKED
-----	------	-------------	----	---------



Consulting Structural and Civil Engineers
100 St. John Street
London EC1M 4ED
T +44 (0)20 7250 7777
F +44 (0)20 7250 7555
E info@akt-uk.com
W www.akt-uk.com

UKCMRI

CLIENT

UKCMRI

PROJECT

PILING AND DIAPHRAGM WALL
SHEET 3 OF 6

TITLE

DRAWN BB SCALE 1:100 @ A1 CAD FILENAME S-FND-122.dgn

DATE JULY '10 CHECKED RP STATUS INFORMATION

A041949 S-FND-122 P2
PROJECT No. DRAWING No. REVISION

PLOT DATE 11/02/2011 BY ben.bulder

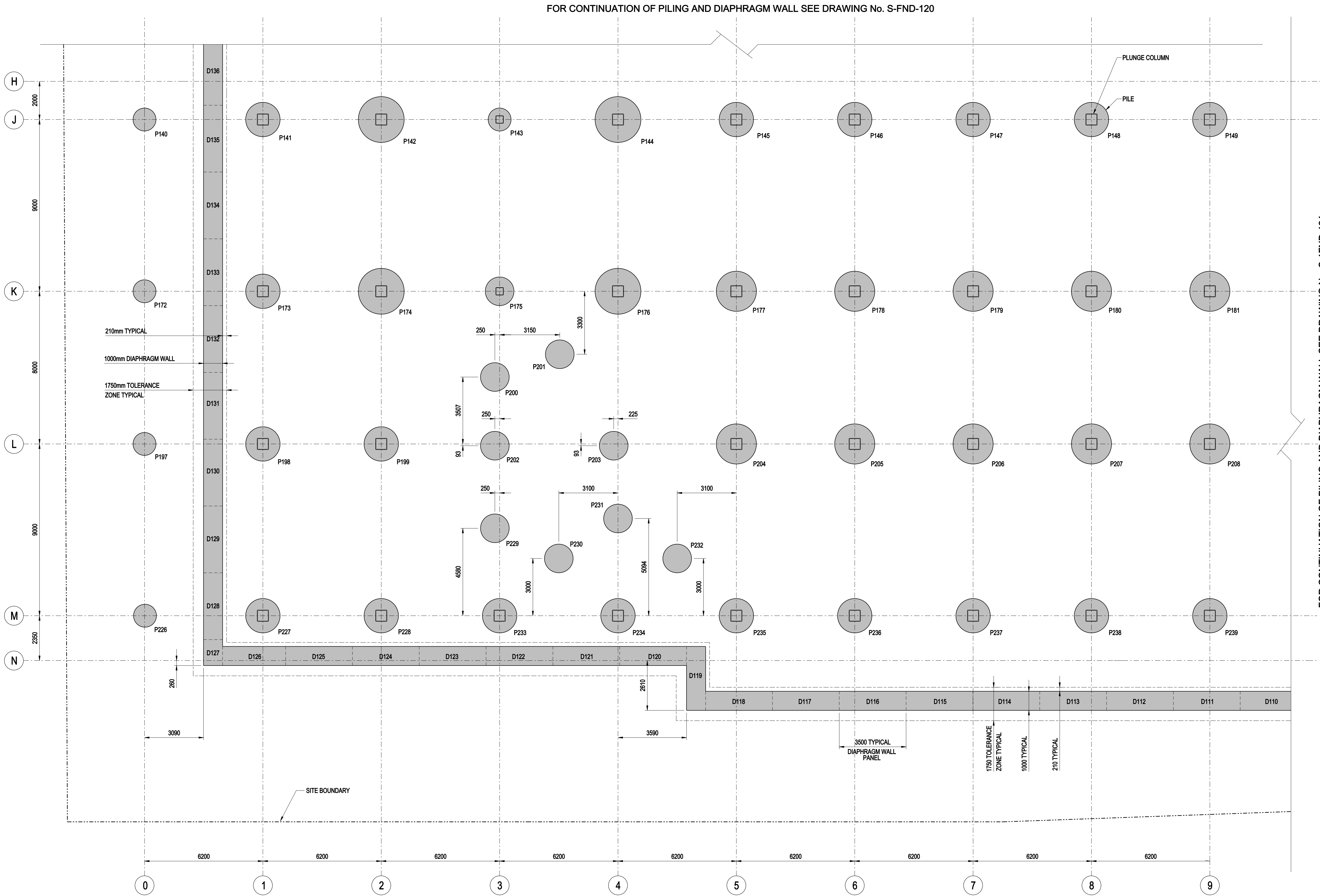

- NOTES
1. THIS DRAWING IS TO BE READ IN CONJUNCTION WITH ALL OTHER ARCHITECTS AND ENGINEERS DRAWINGS, SPECIFICATIONS AND DETAILS.
 2. ALL DIMENSIONS ARE SHOWN IN MILLIMETRES UNLESS STATED OTHERWISE
 3. DO NOT SCALE FROM THIS DRAWING
 4. FOR MOVEMENT AND TOLERANCES REFER TO DRAWING No S-GEN-005
 5. FOR GENERAL NOTES PLEASE REFER TO S-GEN-001/004
 6. PILE DIAMETER INDICATED ARE BASED ON INFORMATION OBTAINED FROM SITE INVESTIGATION REPORT. FOR DETAIL OF FULL SITE INVESTIGATION REFER TO NORTHWEST HOLST REPORT REF: F15469, No. F02, REVISION "FINAL" DATED 31/03/2010 AND ADDENDUM "ADDITIONAL TRIAL PITS ALONG THE NORTHERN BOUNDARY WALL" REF F15469/F03-ADD, DATED 27/07/2010
 7. FOR PILE DIAMETER, CUT OFF LEVELS AND DETAILS ON PLUNGE COLUMNS REFER TO SCHEDULES ON DRAWING S-GEN-051/052
 8. FOR ASSUMED INSTALLATION TOLERANCES OF PILES, DIAPHRAGM WALL PANELS AND PLUNGE COLUMNS REFER TO DRAWING S-GEN-010 AND 011
 9. PILING NECESSARY FOR CRANE BASES ARE THE RESPONSIBILITY OF THE MAIN CONTRACTOR
 10. FOR CDM PROJECT RISKS REFER TO SECTION 10 OF GENERAL NOTES DRAWING S-GEN-003

FINAL DESIGN OF PILES,
PLUNGE COLUMNS AND EMBEDDED
RETAINING WALLS BY RELEVANT
SUB-CONTRACTOR

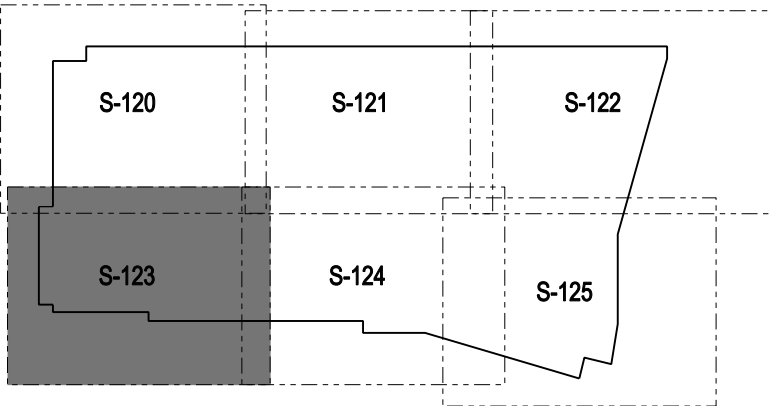

KEY PLAN

P2	11.02.11	ISSUED FOR STAGE D	TS	RP
P1	28.01.11	ISSUED FOR STAGE D - INFORMATION	TS	RP
T1	20.09.10	ISSUED FOR TENDER	BB	RP

REV	DATE	DESCRIPTION	BY	CHECKED
-----	------	-------------	----	---------



Consulting Structural and Civil Engineers
100 St. John Street
London EC3M 4ED
T +44 (0)20 7250 7777
F +44 (0)20 7250 7555
E info@akt-uk.com
W www.akt-uk.com

UKCMRI

CLIENT

UKCMRI

PROJECT

PILING AND DIAPHRAGM WALL
SHEET 4 OF 6

TITLE

DRAWN BB SCALE 1:100 @ A1 CAD FILENAME S-FND-123.dgn

DATE JULY '10 CHECKED RP STATUS INFORMATION

A041949 S-FND-123 P2

PROJECT No. DRAWING No. REVISION

PLOT DATE 11/02/2011 BY ben.bulder

FOR INFORMATION ONLY

NOTES

- THIS DRAWING IS TO BE READ IN CONJUNCTION WITH ALL OTHER ARCHITECTS AND ENGINEERS DRAWINGS, SPECIFICATIONS AND DETAILS.
- ALL DIMENSIONS ARE SHOWN IN MILLIMETRES UNLESS STATED OTHERWISE
- DO NOT SCALE FROM THIS DRAWING
- FOR MOVEMENT AND TOLERANCES REFER TO DRAWING No S-GEN-005
- FOR GENERAL NOTES PLEASE REFER TO -S-GEN-001/004
- PILE DIAMETER INDICATED ARE BASED ON INFORMATION OBTAINED FROM SITE INVESTIGATION REPORT. FOR DETAIL OF FULL SITE INVESTIGATION REFER TO NORWEST HOLST REPORT REF: F15489, No. F02, REVISION "FINAL" DATED 31/03/2010 AND ADDENDUM "ADDITIONAL TRIAL PITS ALONG THE NORTHERN BOUNDARY WALL" REF F15489/F03-ADD, DATED 27/07/2010
- FOR PILE DIAMETER, CUT OFF LEVELS AND DETAILS ON PLUNGE COLUMNS REFER TO SCHEDULES ON DRAWING -S-GEN-051/052
- FOR ASSUMED INSTALLATION TOLERANCES OF PILES, DIAPHRAGM WALL PANELS AND PLUNGE COLUMNS REFER TO DRAWING -S-GEN-010 AND 011
- PILING NECESSARY FOR CRANE BASES ARE THE RESPONSIBILITY OF THE MAIN CONTRACTOR
- FOR CDM PROJECT RISKS REFER TO SECTION 10 OF GENERAL NOTES DRAWING S-GEN-003

FINAL DESIGN OF PILES,
PLUNGE COLUMNS AND EMBEDDED
RETAINING WALLS BY RELEVANT
SUB-CONTRACTOR

FOR CONTINUATION OF PILING AND DIAPHRAGM WALL SEE DRAWING No. S-FND-123

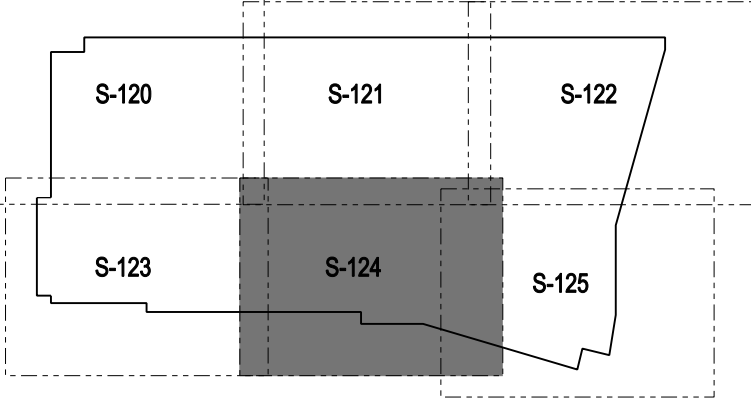

KEY PLAN

P2	11.02.11	ISSUED FOR STAGE D	TS	RP
P1	28.01.11	ISSUED FOR STAGE D - INFORMATION	BB	RP
T1	20.09.10	ISSUED FOR TENDER	BB	RP

REV	DATE	DESCRIPTION	BY	CHECKED
-----	------	-------------	----	---------



Consulting Structural and Civil Engineers
100 St. John Street
London EC1M 4ED
T +44 (0)20 7250 7777
F +44 (0)20 7250 7555
E info@akt-uk.com
W www.akt-uk.com

UKCMRI

CLIENT

UKCMRI

PROJECT

PILING AND DIAPHRAGM WALL
SHEET 5 OF 6

TITLE

DRAWN BB SCALE 1:100 @ A1 CAD FILENAME S-FND-124.dgn

DATE JULY '10 CHECKED RP STATUS INFORMATION

A041949 S-FND-124 P2
PROJECT No. DRAWING No. REVISION

PLOT DATE 11/02/2011 BY ben.bulder

FOR CONTINUATION OF PILING AND DIAPHRAGM WALL SEE DRAWING No. S-FND-123

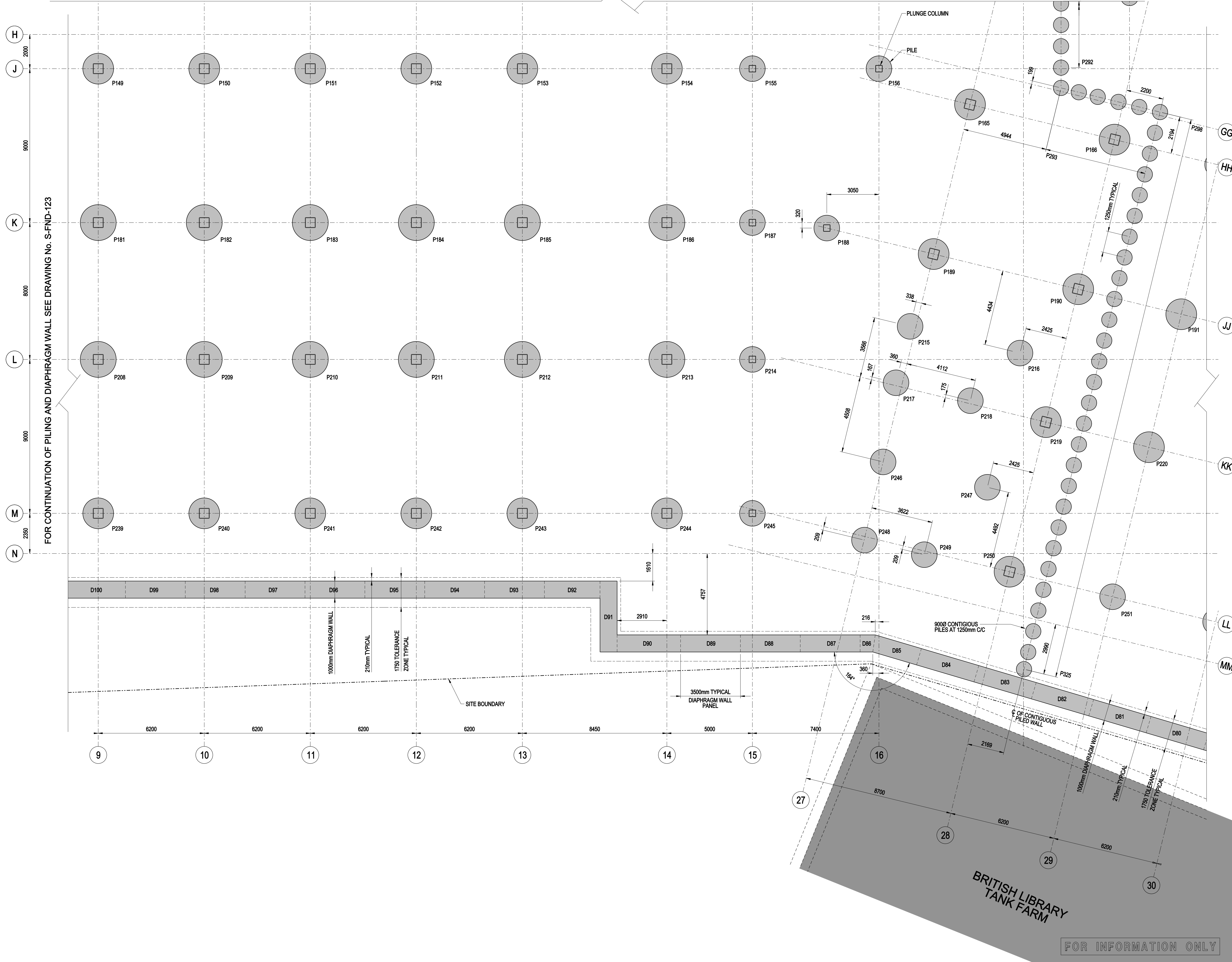

FOR CONTINUATION OF PILING AND DIAPHRAGM WALL SEE DRAWING No. S-FND-122

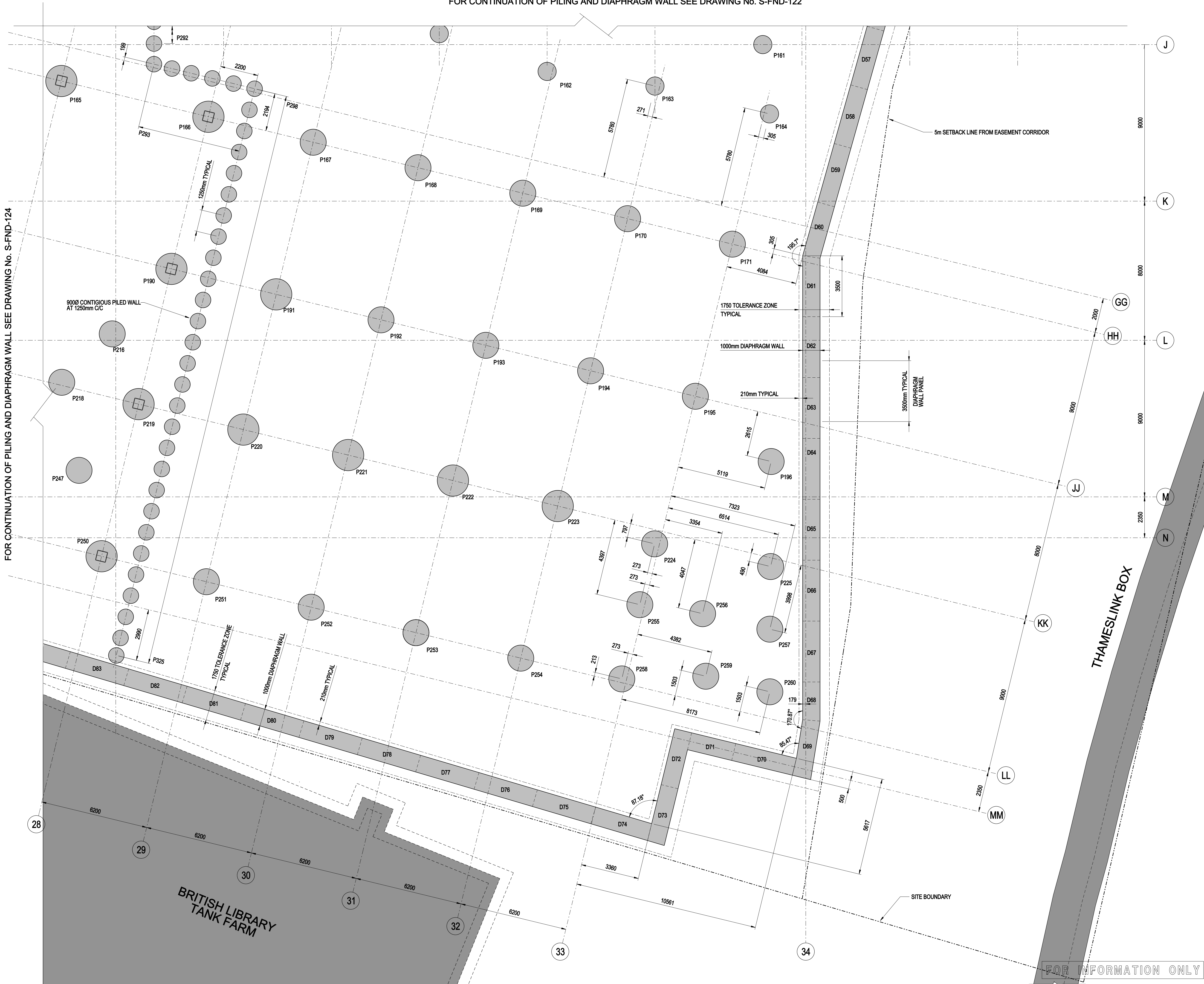

NOTES

1. THIS DRAWING IS TO BE READ IN CONJUNCTION WITH ALL OTHER ARCHITECTS AND ENGINEERS DRAWINGS, SPECIFICATIONS AND DETAILS.
2. ALL DIMENSIONS ARE SHOWN IN MILLIMETRES UNLESS STATED OTHERWISE
3. DO NOT SCALE FROM THIS DRAWING
4. FOR MOVEMENT AND TOLERANCES REFER TO DRAWING No S-GEN-005
5. FOR GENERAL NOTES PLEASE REFER TO S-GEN-001/004
6. PILE DIAMETER INDICATED ARE BASED ON INFORMATION OBTAINED FROM SITE INVESTIGATION REPORT. FOR DETAIL OF FULL SITE INVESTIGATION REFER TO NORTHWEST HOLST REPORT REF: F15469 No. F02, REVISION "FINAL" DATED 31/03/2010 AND ADDENDUM "ADDITIONAL TRIAL PITS ALONG THE NORTHERN BOUNDARY WALL" REF F15469/F03-ADD, DATED 27/07/2010
7. FOR PILE DIAMETER, CUT OFF LEVELS AND DETAILS ON PLUNGE COLUMNS REFER TO SCHEDULES ON DRAWING S-GEN-051/052
8. FOR ASSUMED INSTALLATION TOLERANCES OF PILES, DIAPHRAGM WALL PANELS AND PLUNGE COLUMNS REFER TO DRAWING S-GEN-010 AND 011
9. PILING NECESSARY FOR CRANE BASES ARE THE RESPONSIBILITY OF THE MAIN CONTRACTOR
10. FOR CDM PROJECT RISKS REFER TO SECTION 10 OF GENERAL NOTES DRAWING S-GEN-003

FINAL DESIGN OF PILES, PLUNGE COLUMNS AND EMBEDDED RETAINING WALLS BY RELEVANT SUB-CONTRACTOR

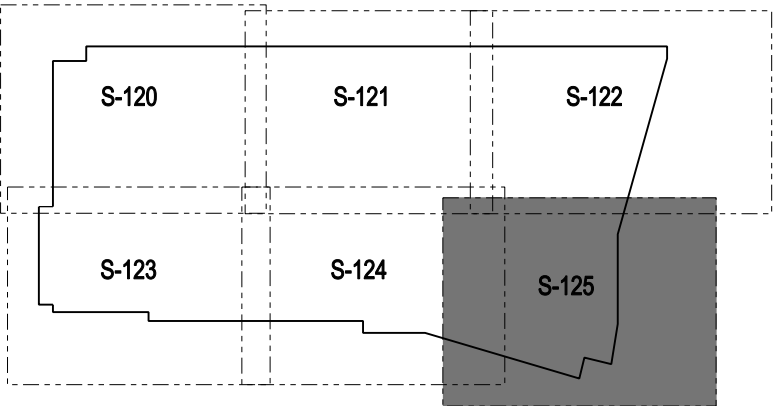

KEY PLAN

P2	11.02.11	ISSUED FOR STAGE D	TS	RP
P1	28.01.11	ISSUED FOR STAGE D - INFORMATION	BB	RP
T1	20.09.10	ISSUED FOR TENDER	BB	RP

REV	DATE	DESCRIPTION	BY	CHECKED
-----	------	-------------	----	---------



Consulting Structural and Civil Engineers
100 St. John Street
London EC1M 4ED
T +44 (0)20 7250 7777
F +44 (0)20 7250 7555
E info@akt-uk.com
W www.akt-uk.com

UKCMRI

CLIENT

UKCMRI

PROJECT

PILING AND DIAPHRAGM WALL
SHEET 6 OF 6

TITLE

DRAWN BB SCALE 1:100 @ A1 CAD FILENAME S-FND-125.dgn

DATE JULY '10 CHECKED RP STATUS INFORMATION

A041949 S-FND-125 P2
PROJECT No. DRAWING No. REVISION

PLOT DATE 11/02/2011 BY ben.bulder

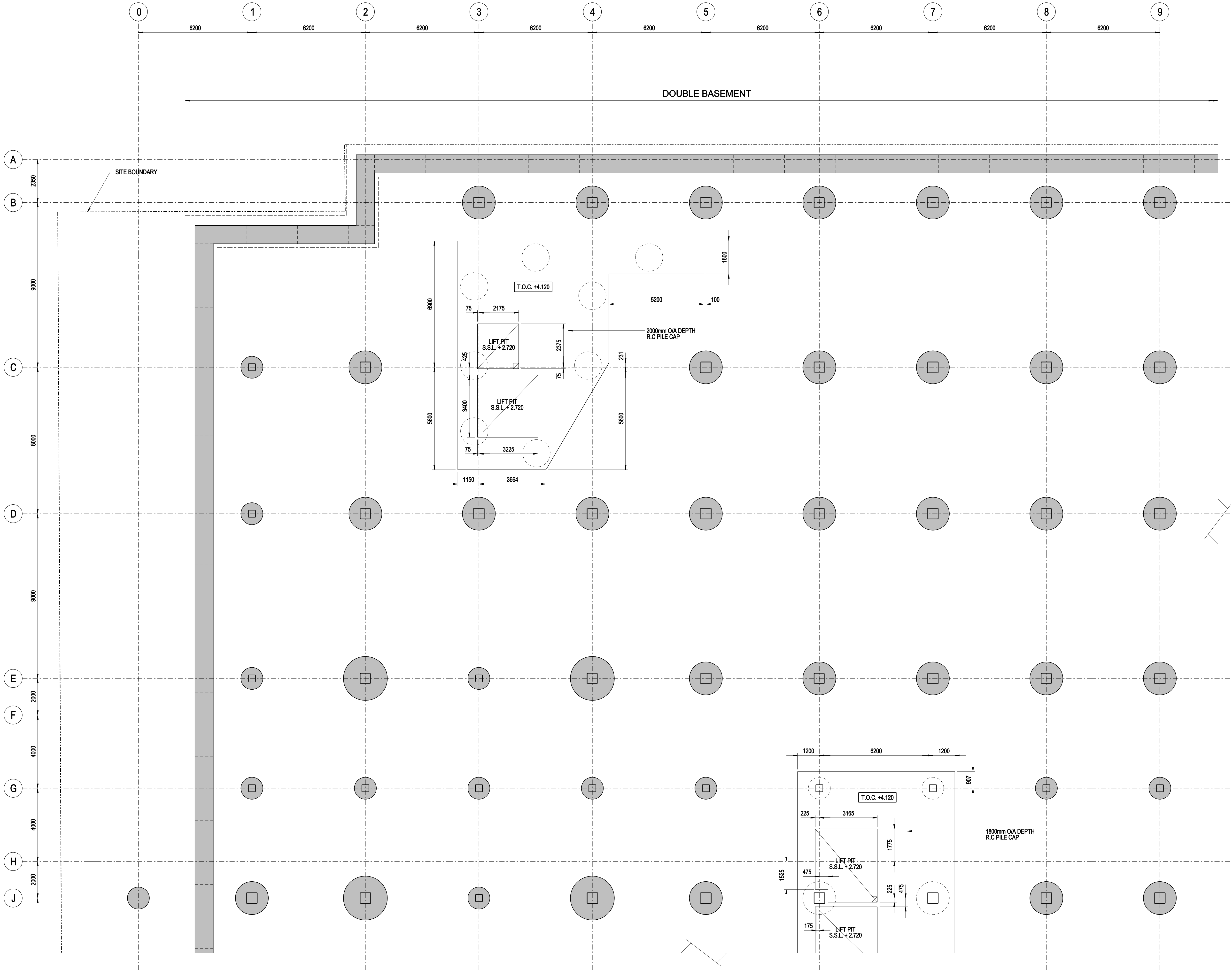

- NOTES
1. THIS DRAWING IS TO BE READ IN CONJUNCTION WITH ALL OTHER ARCHITECTS AND ENGINEERS DRAWINGS, SPECIFICATIONS AND DETAILS.
 2. ALL DIMENSIONS ARE SHOWN IN MILLIMETRES UNLESS STATED OTHERWISE.
 3. DO NOT SCALE FROM THIS DRAWING
 4. FOR MOVEMENT AND TOLERANCES REFER TO DRAWING No S-GEN-005
 5. FOR GENERAL NOTES PLEASE REFER TO S-GEN-001/004
 6. FOR COLUMN AND BEAM SCHEDULE REFER TO S-GEN-050
 7. BASEMENT WATERPROOFING TO ARCHITECTS DETAILS
 8. FOR CDM PROJECT RISKS REFER TO SECTION 10 OF GENERAL NOTES DRAWING S-GEN-003
 9. GENERALLY THE STRUCTURE HAS BEEN DEFINED FOR 2hr FIRE RATING IN ACCORDANCE WITH EXOVIAS DRAWINGS. FOR AREAS OF 4hr FIRE RATING REFER TO HOK's FIRE COMPARTMENTATION DRAWINGS. INCREASED CONCRETE COVER + SACRIFICIAL D88 MESH REQUIRED WITHIN CONCRETE ELEMENTS.
 10. FOR ALL BUILDERS WORK INFORMATION REFER TO APPROPRIATE ARCHITECTS, MEP OR SUB-CONTRACTORS DRAWINGS AND SPECIFICATIONS, INCLUDING:
 - CONCRETE PLINTS / SUPPORT FRAMING TO PLANT / EQUIPMENT
 - CAST IN FIXINGS SUCH AS HALFEN CHANNELS, CLADDING BRACKETS
 - LIGHTENING PROTECTION AND EARTHING FITS
 - NON-STRUCTURAL UPSTANDS
 - ALL HOLES WITH ANY DIMENSION EQUAL TO OR LESS THAN 150mm
 11. REFER TO ARCHITECTS DRAWINGS AND SPECIFICATIONS FOR ALL DETAILS OF EXPOSED CONCRETE ELEMENTS AND DETAILS OF ALL NOTCHES, RECESSES, CHAMFERS ETC

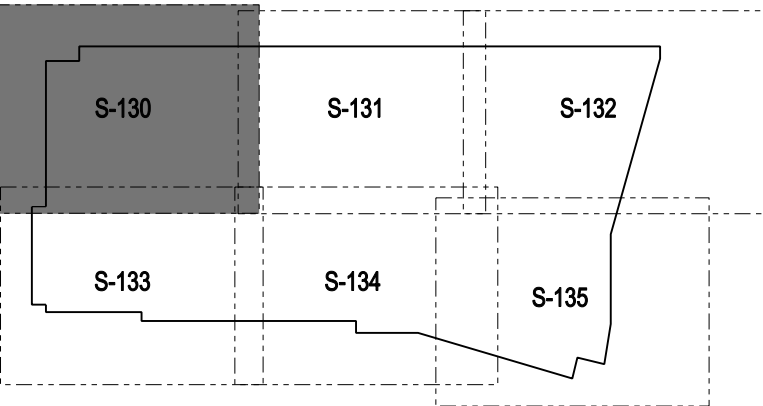

KEY PLAN

P2	11.02.11	ISSUED FOR STAGE D	TS	RP
P1	28.01.11	ISSUED FOR STAGE D - INFORMATION	BB	RP
T1	20.09.10	ISSUED FOR TENDER	BB	RP

REV	DATE	DESCRIPTION	BY	CHECKED
-----	------	-------------	----	---------



Consulting Structural and Civil Engineers
100 St. John Street
London EC1M 4ED
T +44 (0)20 7250 7777
F +44 (0)20 7250 7555
E info@akt-uk.com
W www.akt-uk.com

UKCMRI

CLIENT

UKCMRI

PROJECT

FND PLAN
SHEET 1 OF 6

TITLE

DRAWN BB SCALE 1:100 @ A1 CAD FILENAME A041949-S-FND-130.dgn

DATE JULY '10 CHECKED RP STATUS INFORMATION

A041949 S-FND-130 P2
PROJECT No. DRAWING No. REVISION

PLOT DATE 11/02/2011 BY ben.bulder

FOR CONTINUATION OF FND PLAN SEE DRAWING No. S-FND-131

FOR CONTINUATION OF FND PLAN SEE DRAWING No. S-FND-133

FOR INFORMATION ONLY

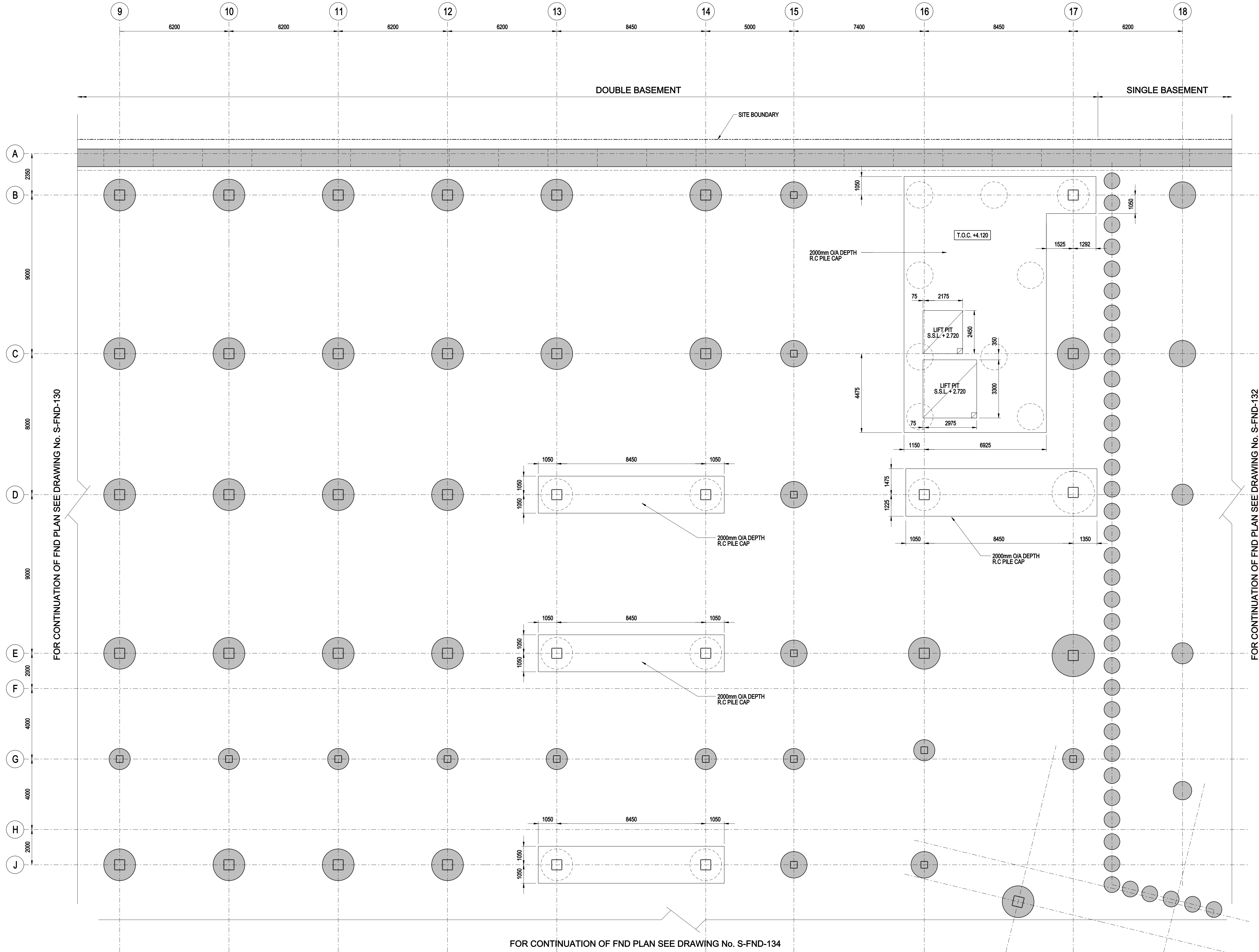

- NOTES
1. THIS DRAWING IS TO BE READ IN CONJUNCTION WITH ALL OTHER ARCHITECTS AND ENGINEERS DRAWINGS, SPECIFICATIONS AND DETAILS.
 2. ALL DIMENSIONS ARE SHOWN IN MILLIMETRES UNLESS STATED OTHERWISE
 3. DO NOT SCALE FROM THIS DRAWING
 4. FOR MOVEMENT AND TOLERANCES REFER TO DRAWING No S-GEN-005
 5. FOR GENERAL NOTES PLEASE REFER TO S-GEN-001/004
 6. FOR COLUMN AND BEAM SCHEDULE REFER TO S-GEN-050
 7. BASEMENT WATERPROOFING TO ARCHITECTS DETAILS
 8. FOR CDM PROJECT RISKS REFER TO SECTION 10 OF GENERAL NOTES DRAWING S-GEN-003
 9. GENERALLY THE STRUCTURE HAS BEEN DEFINED FOR 2hr FIRE RATING IN ACCORDANCE WITH EXOVAS DRAWINGS. FOR AREAS OF 4hr FIRE RATING REFER TO HOK'S FIRE COMPARTMENTATION DRAWINGS. INCREASED CONCRETE COVER + SACRIFICIAL D88 MESH REQUIRED WITHIN CONCRETE ELEMENTS.
 10. FOR ALL BUILDERS WORK INFORMATION REFER TO APPROPRIATE ARCHITECTS, MEP OR SUB-CONTRACTORS DRAWINGS AND SPECIFICATIONS, INCLUDING:
 - CONCRETE PLINTS / SUPPORT FRAMING TO PLANT / EQUIPMENT
 - CAST IN FIXINGS SUCH AS HALFEN CHANNELS, CLADDING BRACKETS
 - LIGHTENING PROTECTION AND EARTHING PITS
 - NON-STRUCTURAL UPSTANDS
 - ALL HOLES WITH ANY DIMENSION EQUAL TO OR LESS THAN 150mm
 11. REFER TO ARCHITECTS DRAWINGS AND SPECIFICATIONS FOR ALL DETAILS OF EXPOSED CONCRETE ELEMENTS AND DETAILS OF ALL NOTCHES, RECESSES, CHAMFERS ETC

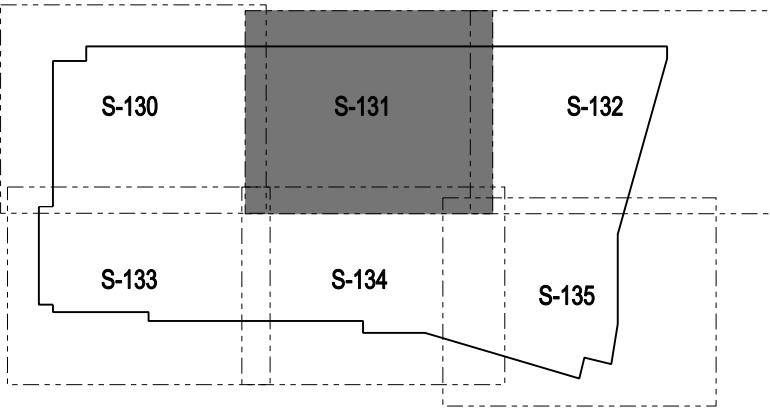

KEY PLAN

P2	11.02.11	ISSUED FOR STAGE D	TS	RP
P1	28.01.11	ISSUED FOR STAGE D - INFORMATION	BB	RP
T1	20.09.10	ISSUED FOR TENDER	BB	RP

REV	DATE	DESCRIPTION	BY	CHECKED
-----	------	-------------	----	---------



Consulting Structural and Civil Engineers
100 St. John Street
London EC1M 4ED
T +44 (0)20 7250 7777
F +44 (0)20 7250 7555
E info@akt-uk.com
W www.akt-uk.com

UKCMRI

CLIENT

UKCMRI

PROJECT

FND PLAN
SHEET 2 OF 6

TITLE

DRAWN BB SCALE 1:100 @ A1 CAD FILENAME S-FND-131.dgn

DATE JULY '10 CHECKED RP STATUS INFORMATION

A041949 S-FND-131 P2
PROJECT No. DRAWING No. REVISION

PLOT DATE 11/02/2011 BY ben.bulder

FOR CONTINUATION OF FND PLAN SEE DRAWING No. S-FND-131

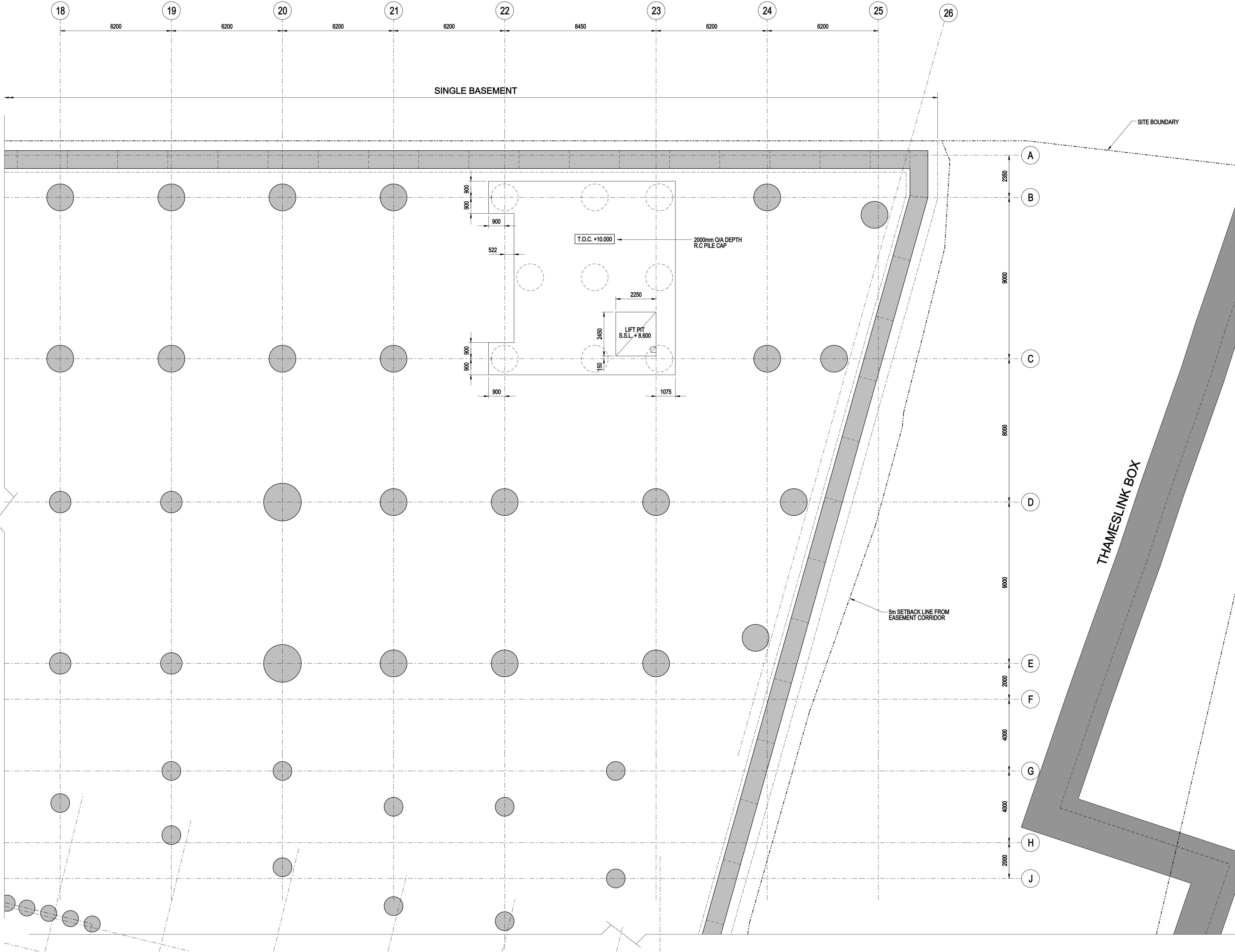

FOR CONTINUATION OF FND PLAN SEE DRAWING No. S-FND-135

FOR INFORMATION ONLY

- NOTES
1. THIS DRAWING IS TO BE READ IN CONJUNCTION WITH ALL OTHER ARCHITECTS AND ENGINEERS DRAWINGS, SPECIFICATIONS AND DETAILS.
 2. ALL DIMENSIONS ARE SHOWN IN MILLIMETRES UNLESS STATED OTHERWISE
 3. DO NOT SCALE FROM THIS DRAWING
 4. FOR MOVEMENT AND TOLERANCES REFER TO DRAWING No S-GEN-005
 5. FOR GENERAL NOTES PLEASE REFER TO S-GEN-001/004
 6. FOR COLUMN AND BEAM SCHEDULE REFER TO S-GEN-050
 7. BASEMENT WATERPROOFING TO ARCHITECTS DETAILS
 8. FOR CDM PROJECT RISKS REFER TO SECTION 10 OF GENERAL NOTES DRAWING S-GEN-003
 9. GENERALLY THE STRUCTURE HAS BEEN DEFINED FOR 2hr FIRE RATING IN ACCORDANCE WITH EXO/AS DRAWINGS. FOR AREAS OF 4hr FIRE RATING REFER TO HOX'S FIRE COMPARTMENTATION DRAWINGS. INCREASED CONCRETE COVER + SACRIFICIAL D98 MESH REQUIRED WITHIN CONCRETE ELEMENTS.
 10. FOR ALL BUILDERS WORK INFORMATION REFER TO APPROPRIATE ARCHITECTS, MEP OR SUB-CONTRACTORS DRAWINGS AND SPECIFICATIONS, INCLUDING:
 - CONCRETE PLINTS / SUPPORT FRAMING TO PLANT / EQUIPMENT
 - CAST IN FIXINGS SUCH AS HALFEN CHANNELS, CLADDING BRACKETS
 - LIGHTNING PROTECTION AND EARTHING PITS
 - NON-STRUCTURAL UPSTANDS
 - ALL HOLES WITH ANY DIMENSION EQUAL TO OR LESS THAN 150mm
 11. REFER TO ARCHITECTS DRAWINGS AND SPECIFICATIONS FOR ALL DETAILS OF EXPOSED CONCRETE ELEMENTS AND DETAILS OF ALL NOTCHES, RECESSES/ CHAMFERS ETC

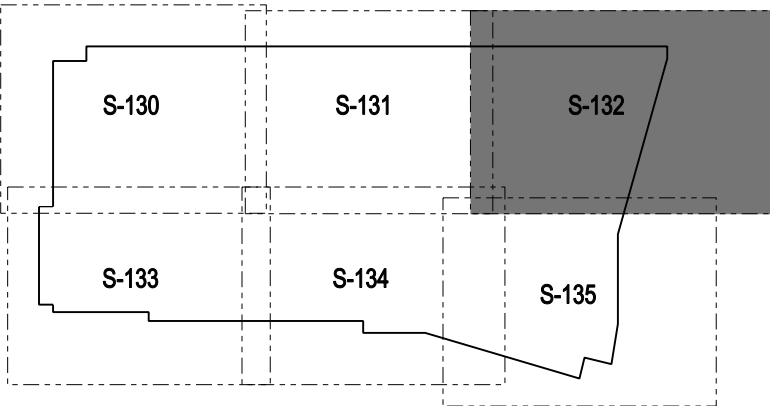

KEY PLAN

P2	11.02.11	ISSUED FOR STAGE D	TS	RP
P1	28.01.11	ISSUED FOR STAGE D - INFORMATION	BB	RP
T1	20.09.10	ISSUED FOR TENDER	BB	RP

REV	DATE	DESCRIPTION	BY	CHECKED
-----	------	-------------	----	---------



Consulting Structural and Civil Engineers
100 St. John Street
London EC1M 4ED
T +44 (0)20 7250 7777
F +44 (0)20 7250 7555
E info@akt-uk.com
W www.akt-uk.com

UKCMRI

CLIENT

UKCMRI

PROJECT

FND PLAN
SHEET 3 OF 6

TITLE

DRAWN BB SCALE 1:100 @ A1 CAD FILENAME A041949-S-FND-132.dgn

DATE JULY '10 CHECKED RP STATUS INFORMATION

A041949 S-FND-132 P2
PROJECT No. DRAWING No. REVISION

PLOT DATE 11/02/2011 BY ben.bulder

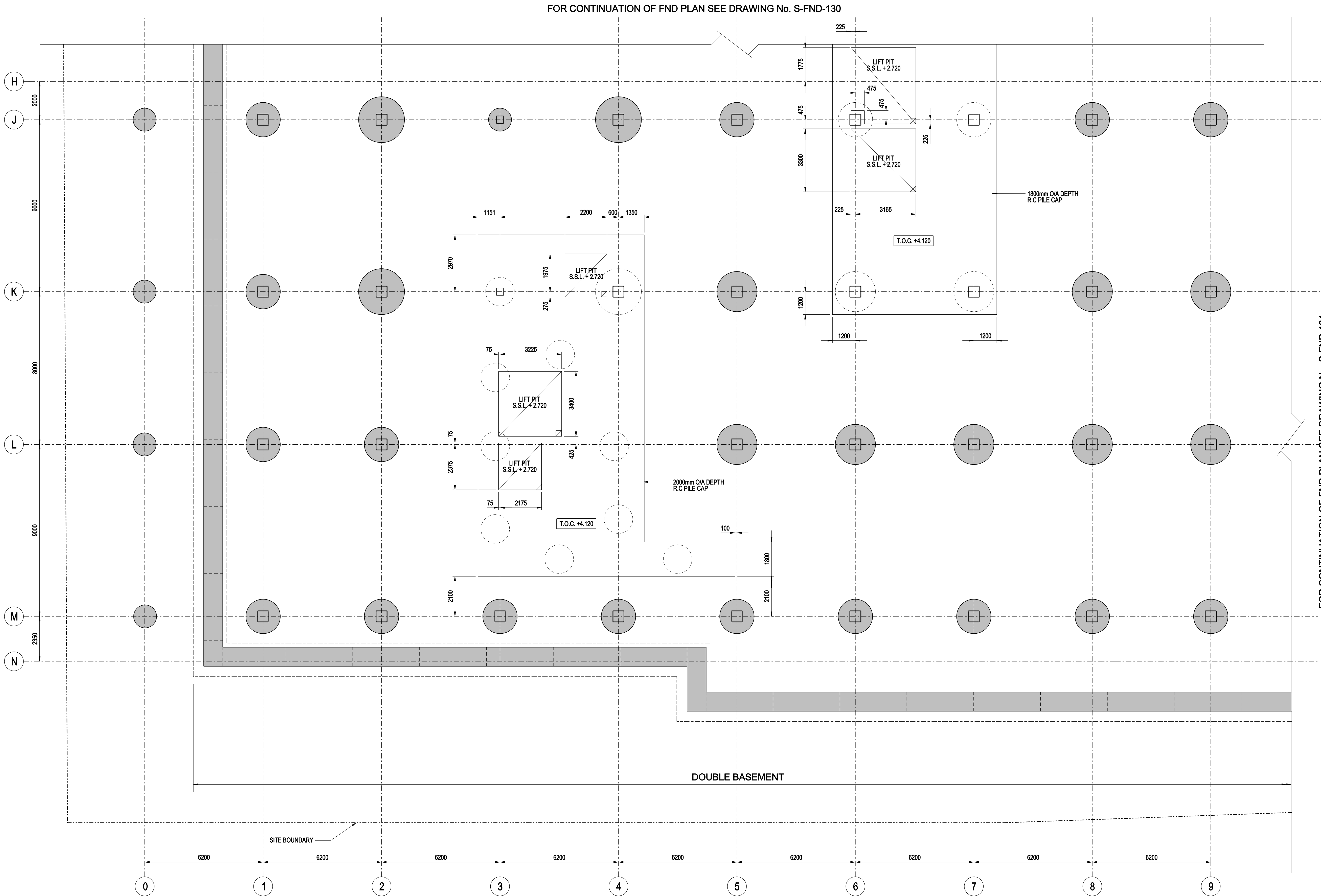

- NOTES
1. THIS DRAWING IS TO BE READ IN CONJUNCTION WITH ALL OTHER ARCHITECTS AND ENGINEERS DRAWINGS, SPECIFICATIONS AND DETAILS.
 2. ALL DIMENSIONS ARE SHOWN IN MILLIMETRES UNLESS STATED OTHERWISE
 3. DO NOT SCALE FROM THIS DRAWING
 4. FOR MOVEMENT AND TOLERANCES REFER TO DRAWING No S-GEN-005
 5. FOR GENERAL NOTES PLEASE REFER TO S-GEN-001/004
 6. FOR COLUMN AND BEAM SCHEDULE REFER TO S-GEN-050
 7. BASEMENT WATERPROOFING TO ARCHITECTS DETAILS
 8. FOR CDM PROJECT RISKS REFER TO SECTION 10 OF GENERAL NOTES DRAWING S-GEN-003
 9. GENERALLY THE STRUCTURE HAS BEEN DEFINED FOR 2hr FIRE RATING IN ACCORDANCE WITH EXOVAS DRAWINGS. FOR AREAS OF 4hr FIRE RATING REFER TO HOV'S FIRE COMPARTMENTATION DRAWINGS. INCREASED CONCRETE COVER + SACRIFICIAL D98 MESH REQUIRED WITHIN CONCRETE ELEMENTS.
 10. FOR ALL BUILDERS WORK INFORMATION REFER TO APPROPRIATE ARCHITECTS, MEP OR SUB-CONTRACTORS DRAWINGS AND SPECIFICATIONS, INCLUDING:
 - CONCRETE PLINTS / SUPPORT FRAMING TO PLANT / EQUIPMENT
 - CAST IN FIXINGS SUCH AS HALFEN CHANNELS, CLADDING BRACKETS
 - LIGHTENING PROTECTION AND EARTHING PITS
 - NON-STRUCTURAL UPSTANDS
 - ALL HOLES WITH ANY DIMENSION EQUAL TO OR LESS THAN 150mm
 11. REFER TO ARCHITECTS DRAWINGS AND SPECIFICATIONS FOR ALL DETAILS OF EXPOSED CONCRETE ELEMENTS AND DETAILS OF ALL NOTCHES, RECESSES, CHAMFERS ETC

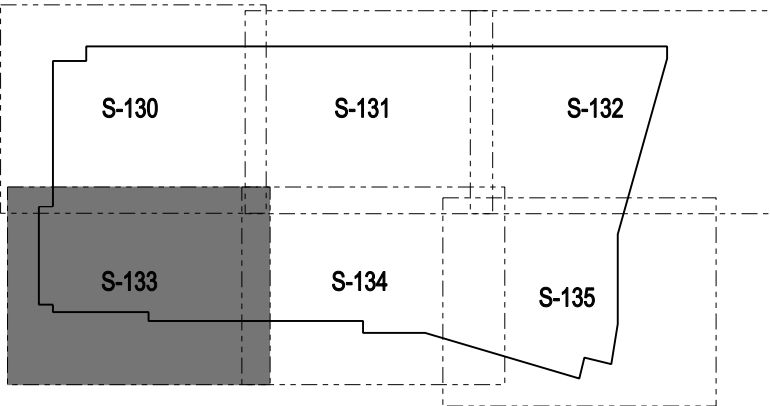

KEY PLAN

P2	11.02.11	ISSUED FOR STAGE D	TS	RP
P1	28.01.11	ISSUED FOR STAGE D - INFORMATION	BB	RP
T1	20.09.10	ISSUED FOR TENDER	BB	RP

REV	DATE	DESCRIPTION	BY	CHECKED
-----	------	-------------	----	---------



Consulting Structural and Civil Engineers
100 St. John Street
London EC1M 4ED
T +44 (0)20 7250 7777
F +44 (0)20 7250 7555
E info@akt-uk.com
W www.akt-uk.com

UKCMRI

CLIENT

UKCMRI

PROJECT

FND PLAN
SHEET 4 OF 6

TITLE

DRAWN BB SCALE 1:100 @ A1 CAD FILENAME A041949-S-FND-133.dgn

DATE JULY '10 CHECKED RP STATUS INFORMATION

A041949 S-FND-133 P2

PROJECT No. DRAWING No. REVISION

PLOT DATE 11/02/2011 BY ben.bulder

FOR INFORMATION ONLY

FOR CONTINUATION OF FND PLAN SEE DRAWING No. S-FND-131

NOTES

1. THIS DRAWING IS TO BE READ IN CONJUNCTION WITH ALL OTHER ARCHITECTS AND ENGINEERS DRAWINGS, SPECIFICATIONS AND DETAILS.
2. ALL DIMENSIONS ARE SHOWN IN MILLIMETRES UNLESS STATED OTHERWISE
3. DO NOT SCALE FROM THIS DRAWING
4. FOR MOVEMENT AND TOLERANCES REFER TO DRAWING No S-GEN-005
5. FOR GENERAL NOTES PLEASE REFER TO S-GEN-001/004
6. FOR COLUMN AND BEAM SCHEDULE REFER TO S-GEN-050
7. BASEMENT WATERPROOFING TO ARCHITECTS DETAILS
8. FOR CDM PROJECT RISKS REFER TO SECTION 10 OF GENERAL NOTES DRAWING S-GEN-003
9. GENERALLY THE STRUCTURE HAS BEEN DEFINED FOR 2hr FIRE RATING IN ACCORDANCE WITH EXOVAS DRAWINGS. FOR AREAS OF 4hr FIRE RATING REFER TO HOK'S FIRE COMPARTMENTATION DRAWINGS. INCREASED CONCRETE COVER + SACRIFICIAL D98 MESH REQUIRED WITHIN CONCRETE ELEMENTS.
10. FOR ALL BUILDERS WORK INFORMATION REFER TO APPROPRIATE ARCHITECTS, MEP OR SUB-CONTRACTORS DRAWINGS AND SPECIFICATIONS, INCLUDING:
 - CONCRETE PLINTS / SUPPORT FRAMING TO PLANT / EQUIPMENT
 - CAST IN FIXINGS SUCH AS HALFEN CHANNELS, CLADDING BRACKETS
 - LIGHTENING PROTECTION AND EARTHING PITS
 - NON-STRUCTURAL UPSTANDS
 - ALL HOLES WITH ANY DIMENSION EQUAL TO OR LESS THAN 150mm
11. REFER TO ARCHITECTS DRAWINGS AND SPECIFICATIONS FOR ALL DETAILS OF EXPOSED CONCRETE ELEMENTS AND DETAILS OF ALL NOTCHES, RECESSES, CHAMFERS ETC

FOR CONTINUATION OF FND PLAN SEE DRAWING No. S-FND-135

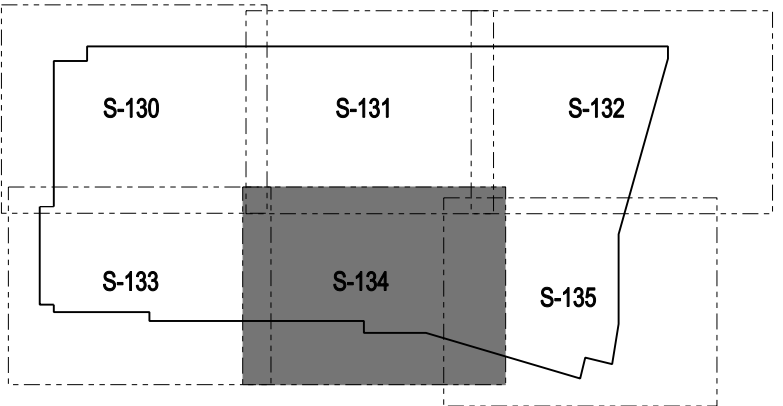

KEY PLAN

P2	11.02.11	ISSUED FOR STAGE D	TS	RP
P1	28.01.11	ISSUED FOR STAGE D - INFORMATION	BB	RP
T1	20.09.10	ISSUED FOR TENDER	BB	RP

REV	DATE	DESCRIPTION	BY	CHECKED
-----	------	-------------	----	---------



Consulting Structural and Civil Engineers
100 St. John Street
London EC1M 4ED
T +44 (0)20 7250 7777
F +44 (0)20 7250 7555
E info@akt-uk.com
W www.akt-uk.com

UKCMRI

CLIENT

UKCMRI

PROJECT

FND PLAN
SHEET 5 OF 6

TITLE

DRAWN BB SCALE 1:100 @ A1 CAD FILENAME A041949-S-FND-134.dgn

DATE JULY '10 CHECKED RP STATUS INFORMATION

A041949 S-FND-134 P2

PROJECT No. DRAWING No. REVISION

PLOT DATE 11/02/2011 BY ben.bulder

FOR CONTINUATION OF FND PLAN SEE DRAWING No. S-FND-133

DOUBLE BASEMENT

DOUBLE BASEMENT

SINGLE BASEMENT

BRITISH LIBRARY
TANK FARM

FOR INFORMATION ONLY

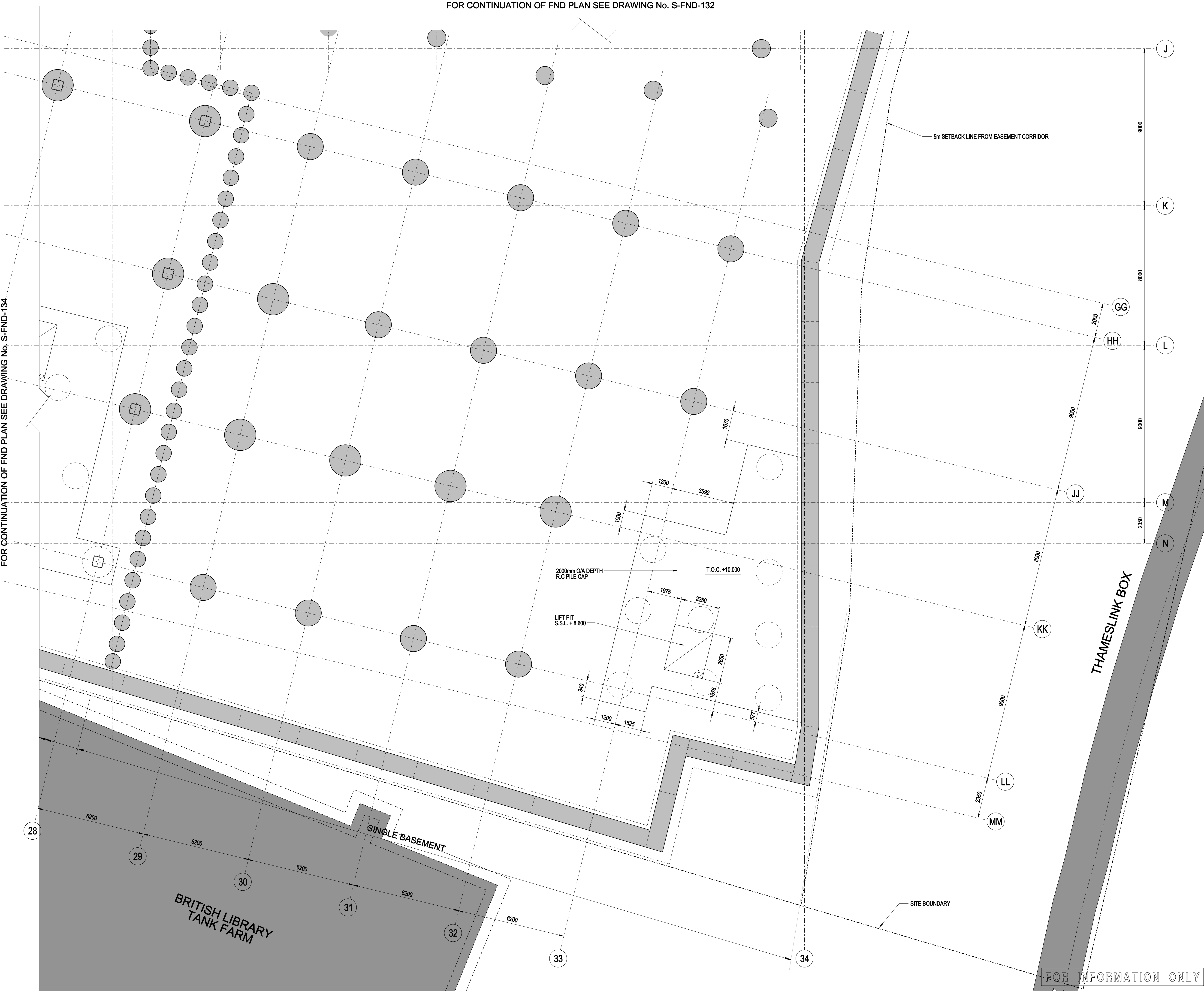

- NOTES
1. THIS DRAWING IS TO BE READ IN CONJUNCTION WITH ALL OTHER ARCHITECTS AND ENGINEERS DRAWINGS, SPECIFICATIONS AND DETAILS.
 2. ALL DIMENSIONS ARE SHOWN IN MILLIMETRES UNLESS STATED OTHERWISE.
 3. DO NOT SCALE FROM THIS DRAWING
 4. FOR MOVEMENT AND TOLERANCES REFER TO DRAWING No S-GEN-005
 5. FOR GENERAL NOTES PLEASE REFER TO S-GEN-001/004
 6. FOR COLUMN AND BEAM SCHEDULE REFER TO S-GEN-050
 7. BASEMENT WATERPROOFING TO ARCHITECTS DETAILS
 8. FOR CDM PROJECT RISKS REFER TO SECTION 10 OF GENERAL NOTES DRAWING S-GEN-003
 9. GENERALLY THE STRUCTURE HAS BEEN DEFINED FOR 2hr FIRE RATING IN ACCORDANCE WITH EXOVAS DRAWINGS. FOR AREAS OF 4hr FIRE RATING REFER TO HOK'S FIRE COMPARTMENTATION DRAWINGS. INCREASED CONCRETE COVER + SACRIFICIAL D98 MESH REQUIRED WITHIN CONCRETE ELEMENTS.
 10. FOR ALL BUILDERS WORK INFORMATION REFER TO APPROPRIATE ARCHITECTS, MEP OR SUB-CONTRACTORS DRAWINGS AND SPECIFICATIONS, INCLUDING:
 - CONCRETE PLINTS / SUPPORT FRAMING TO PLANT / EQUIPMENT
 - CAST IN FIXINGS SUCH AS HALFEN CHANNELS, CLADDING BRACKETS
 - LIGHTNING PROTECTION AND EARTHING PITS
 - NON-STRUCTURAL UPSTANDS
 - ALL HOLES WITH ANY DIMENSION EQUAL TO OR LESS THAN 150mm
 11. REFER TO ARCHITECTS DRAWINGS AND SPECIFICATIONS FOR ALL DETAILS OF EXPOSED CONCRETE ELEMENTS AND DETAILS OF ALL NOTCHES, RECESSES, CHAMFERS ETC

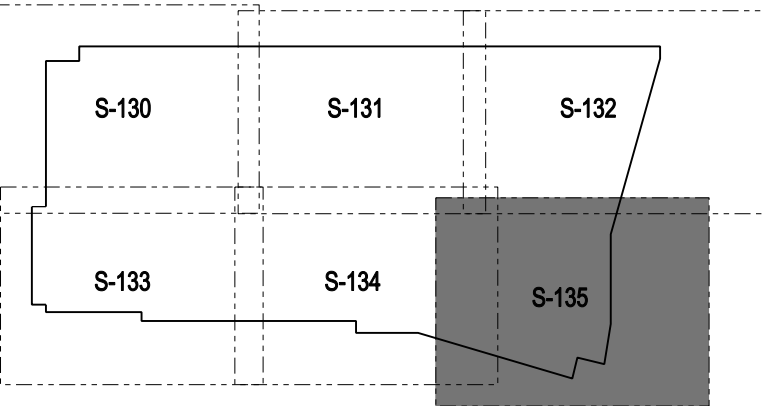

KEY PLAN				
P2	11.02.11	ISSUED FOR STAGE D	TS	RP
P1	28.01.11	ISSUED FOR STAGE D - INFORMATION	BB	RP
T1	20.09.10	ISSUED FOR TENDER	BB	RP

REV	DATE	DESCRIPTION	BY	CHECKED



ADAMS KARA TAYLOR
A WIG Group Company

Consulting Structural and Civil Engineers
100 St. John Street
London EC1M 4ED
T +44 (0)20 7250 7777
F +44 (0)20 7250 7555
E info@akt-uk.com
W www.akt-uk.com

UKCMRI				
CLIENT				
UKCMRI				
PROJECT				
FND PLAN SHEET 6 OF 6				
TITLE				
DRAWN	BB	SCALE	1:100 @ A1	CAD FILENAME S-FND-135.dgn
DATE	JULY'10	CHECKED	RP	STATUS INFORMATION
A041949		S-FND-135		P2
PROJECT NO.		DRAWING NO.		REVISION

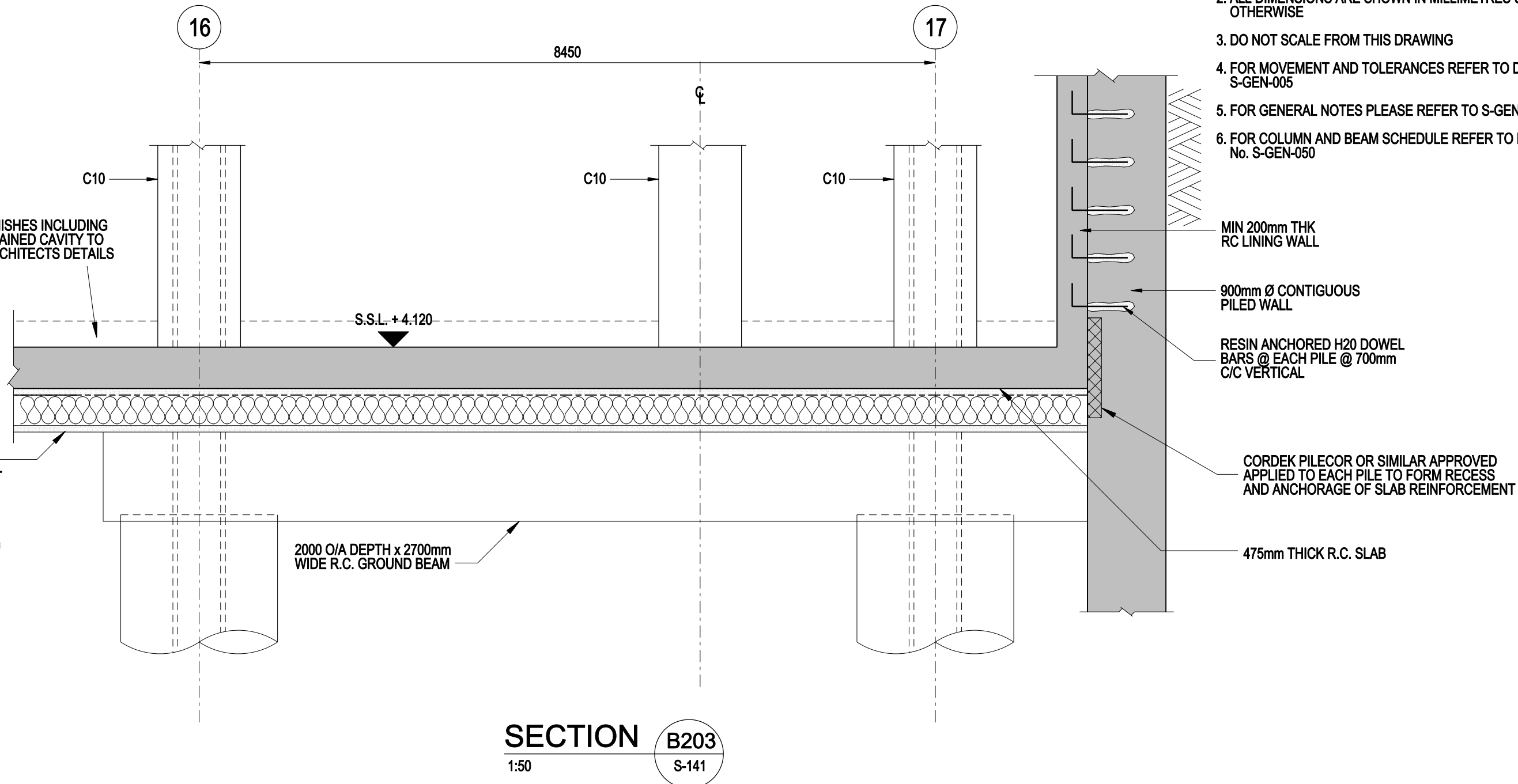
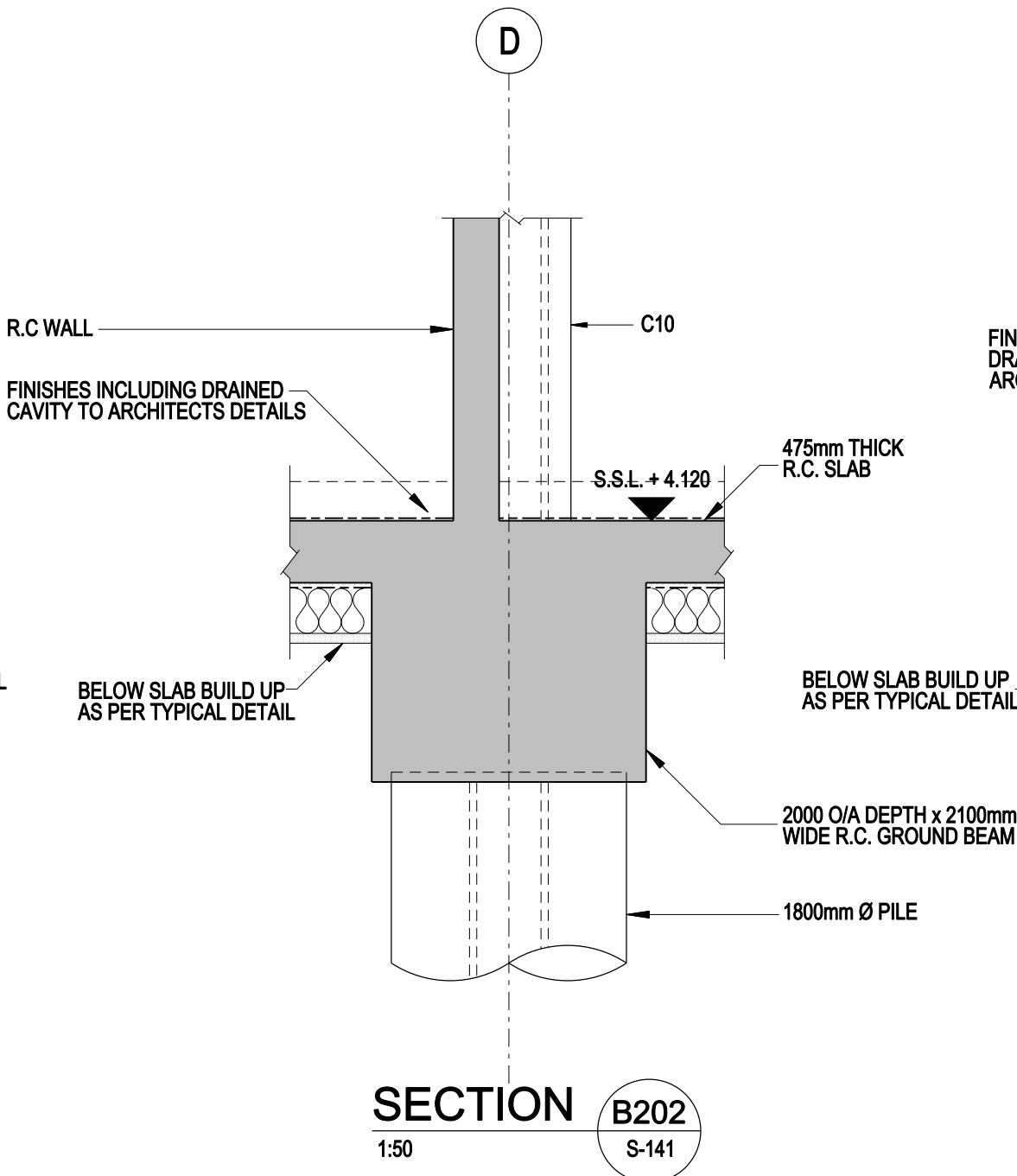
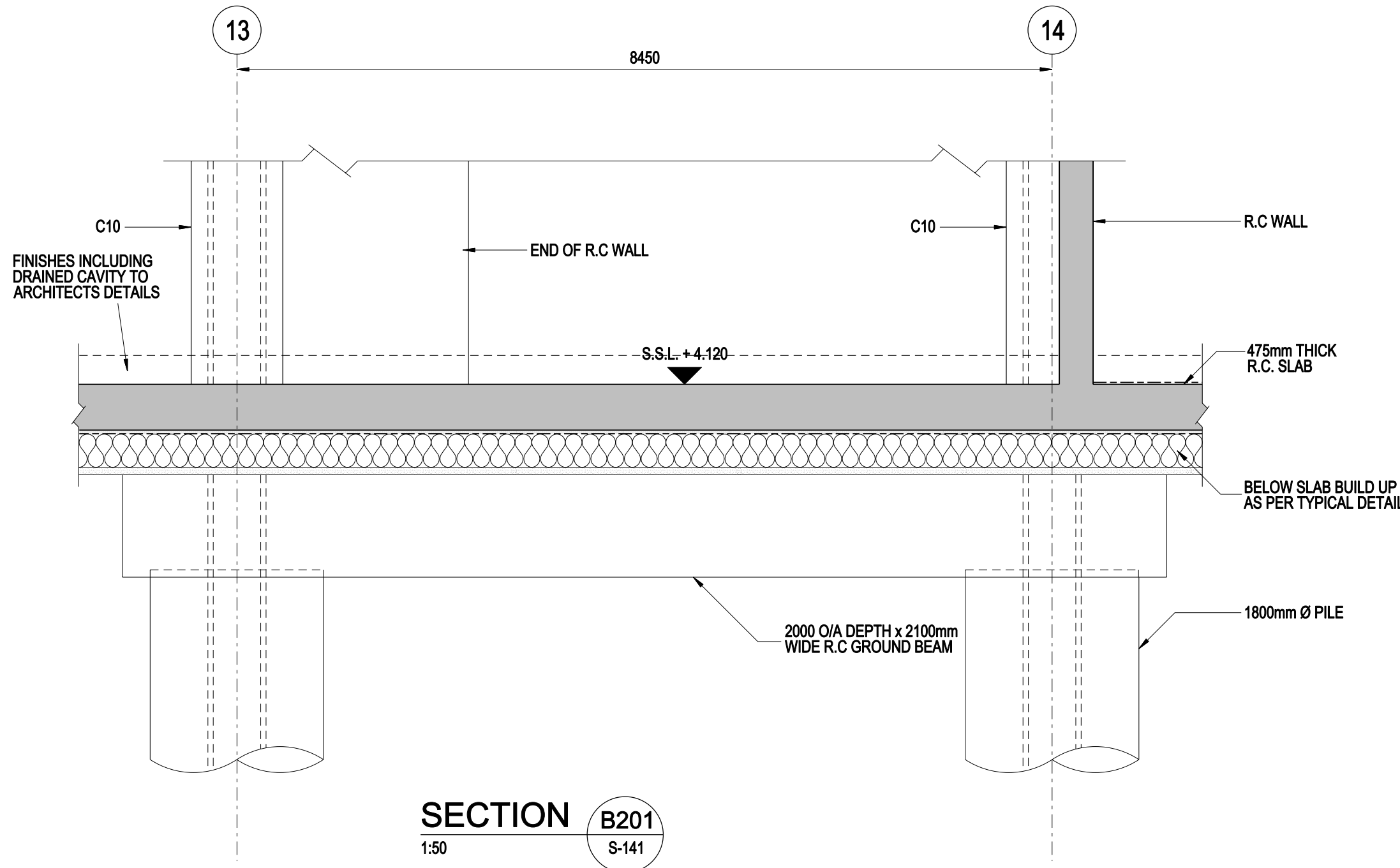

- NOTES
1. THIS DRAWING IS TO BE READ IN CONJUNCTION WITH ALL OTHER ARCHITECTS AND ENGINEERS DRAWINGS, SPECIFICATIONS AND DETAILS.
 2. ALL DIMENSIONS ARE SHOWN IN MILLIMETRES UNLESS STATED OTHERWISE
 3. DO NOT SCALE FROM THIS DRAWING
 4. FOR MOVEMENT AND TOLERANCES REFER TO DRAWING No S-GEN-005
 5. FOR GENERAL NOTES PLEASE REFER TO S-GEN-001/004
 6. FOR COLUMN AND BEAM SCHEDULE REFER TO DRAWING No. S-GEN-050

- MIN 200mm THK RC LINING WALL
- 900mm Ø CONTIGUOUS PILED WALL
- RESIN ANCHORED H20 DOWEL BARS @ EACH PILE @ 700mm C/C VERTICAL
- CORDEK PILECOR OR SIMILAR APPROVED APPLIED TO EACH PILE TO FORM RECESS AND ANCHORAGE OF SLAB REINFORCEMENT
- 475mm THICK R.C. SLAB

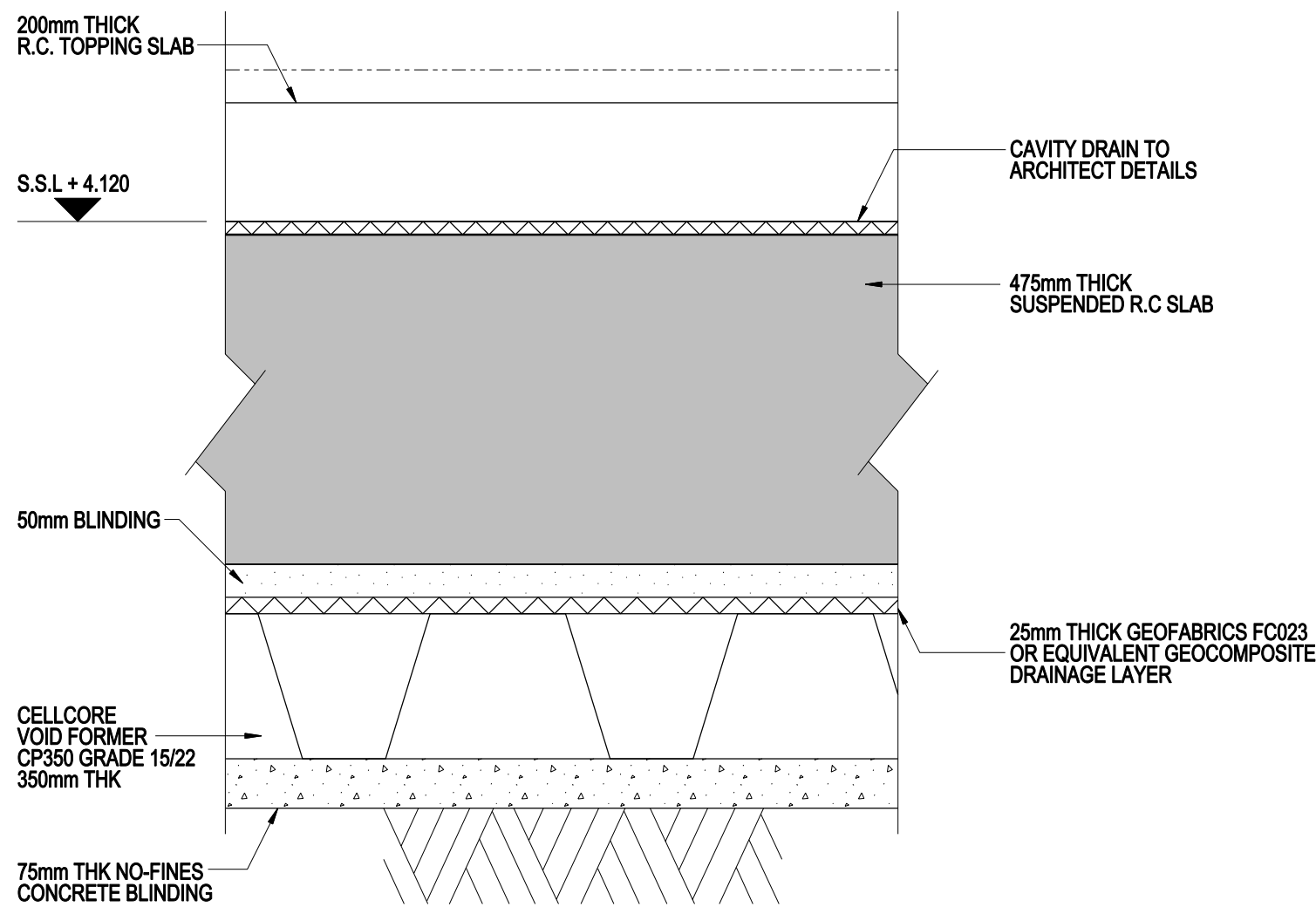
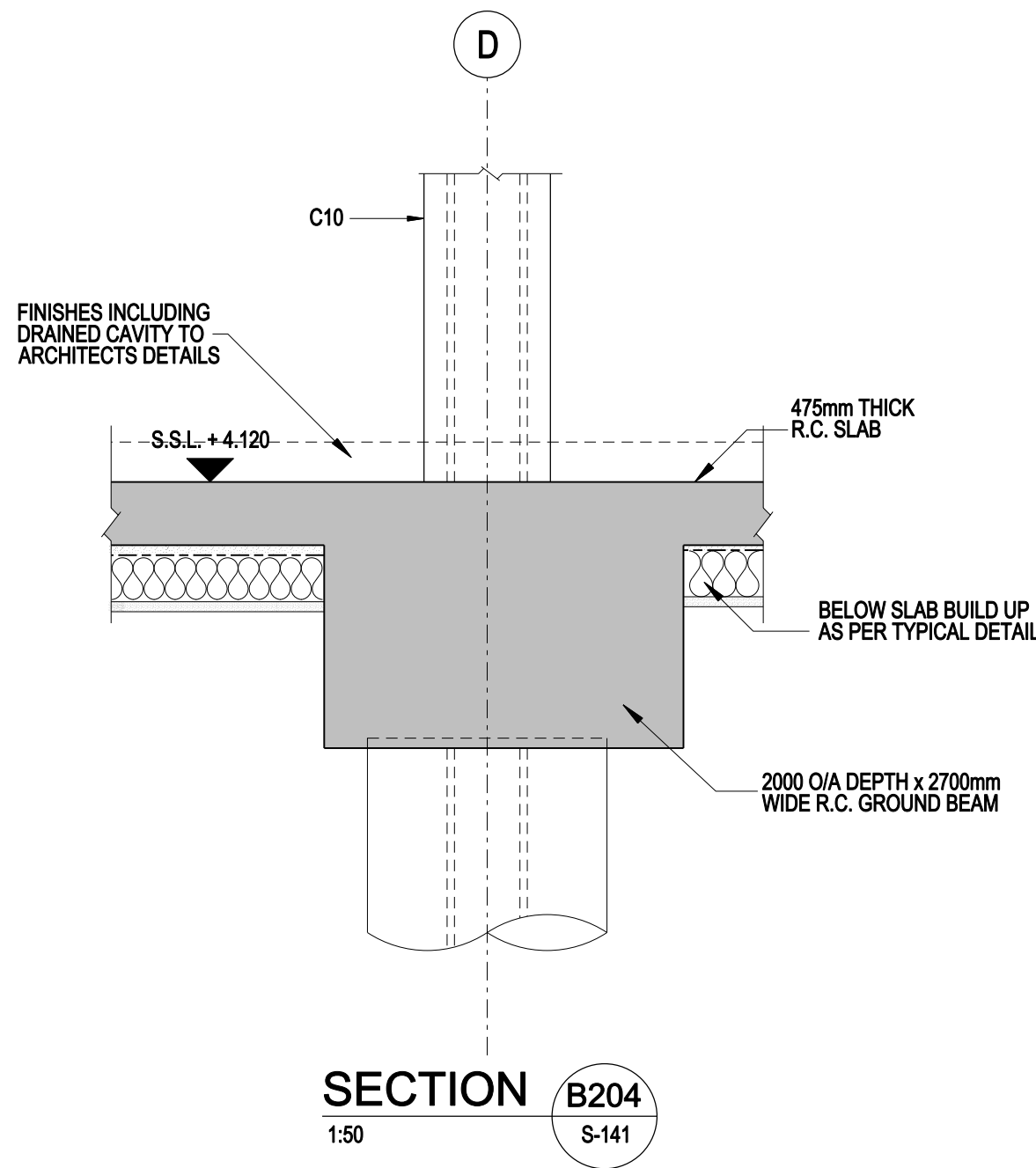

TYPICAL BASEMENT SLAB BUILD UP
SCALE 1:10

P1	11.02.11	ISSUED FOR STAGE D	BB	RP
T1	20.09.10	ISSUED FOR TENDER	BB	RP
REV	DATE	DESCRIPTION	BY	CHECKED



Consulting Structural and Civil Engineers
100 St. John Street
London EC1M 4ED
T +44 (0)20 7250 7777
F +44 (0)20 7250 7555
E info@akt-uk.com
W www.akt-uk.com

UKCMRI

CLIENT

UKCMRI

PROJECT

LB4 SECTIONS AND DETAILS
SHEET 1 OF 3

TITLE	1:25 @ A1 (U.N.O)	S-LB4-710.dgn
DRAWN JH	SCALE	CAD FILENAME
DATE AUG 10	CHECKED RP	STATUS TENDER

A041949	S-LB4-710	P1
PROJECT No.	DRAWING No.	REVISION

PLOT DATE 11/02/2011 BY ben.builer

PRELIMINARY