

EXISTING BASEMENT

EX-01

This drawing is the property of Ganguly Architects Ltd and copyright is reserved by them.

This drawing is issued on condition that it is not copied, used or disclosed by or to any unauthorized person without the prior written consent of Ganguly Architects Ltd.

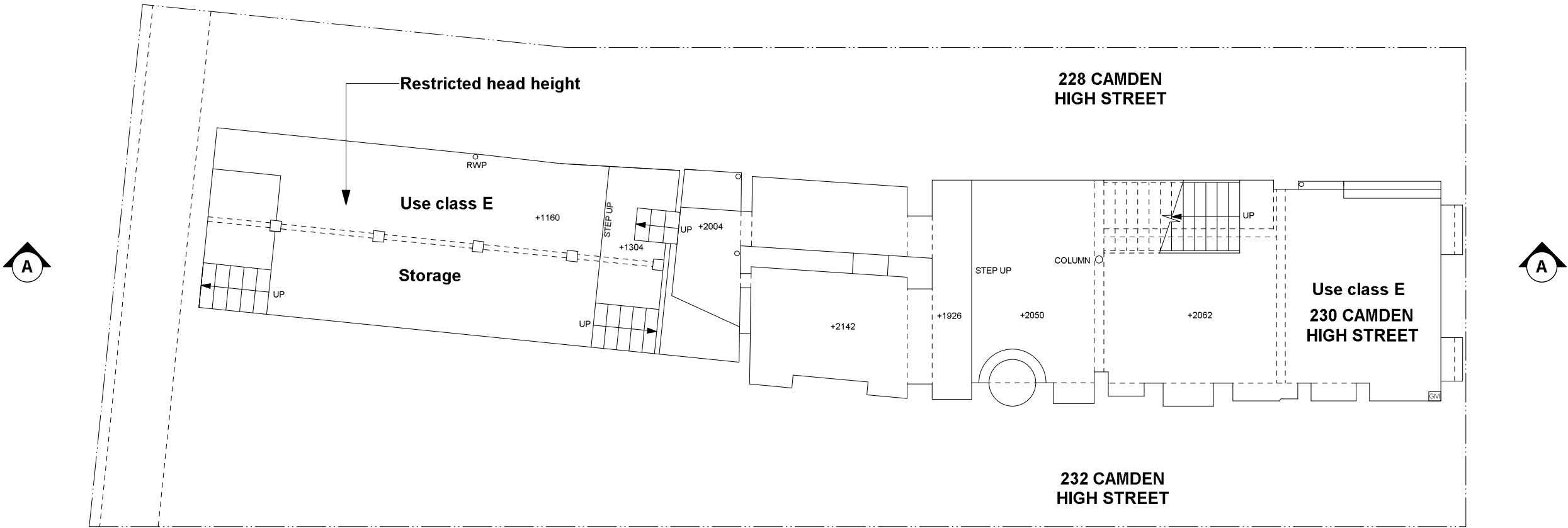

REV.	DATE	DESCRIPTION	BY

CLIENT:
**K FOOD
LONDON LTD**

GANGULY ARCHITECTS LTD
Tel.: 020 7617 7590
E-MAIL: info@ganguly.co.uk
www.ganguly.co.uk

PROJECT:
**230
CAMDEN
HIGH STREET
LONDON, NW1 8QS**

DRAWING TITLE:
**EXISTING
BASEMENT**

SCALE: 1:100@A3	DATE: 15.02.2022	DRAWN: AGH
---------------------------	----------------------------	----------------------

DRAWING NO.: 230CHS-2022-EX-01	REVISION:
--	-----------

