

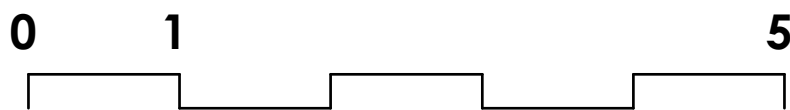

- KEY**
- 1 Roman brick
  - 2 Metal window frame
  - 3 Metal panels to match window frames
  - 4 Timber door in HW frame
  - 5 Perforated metal screens

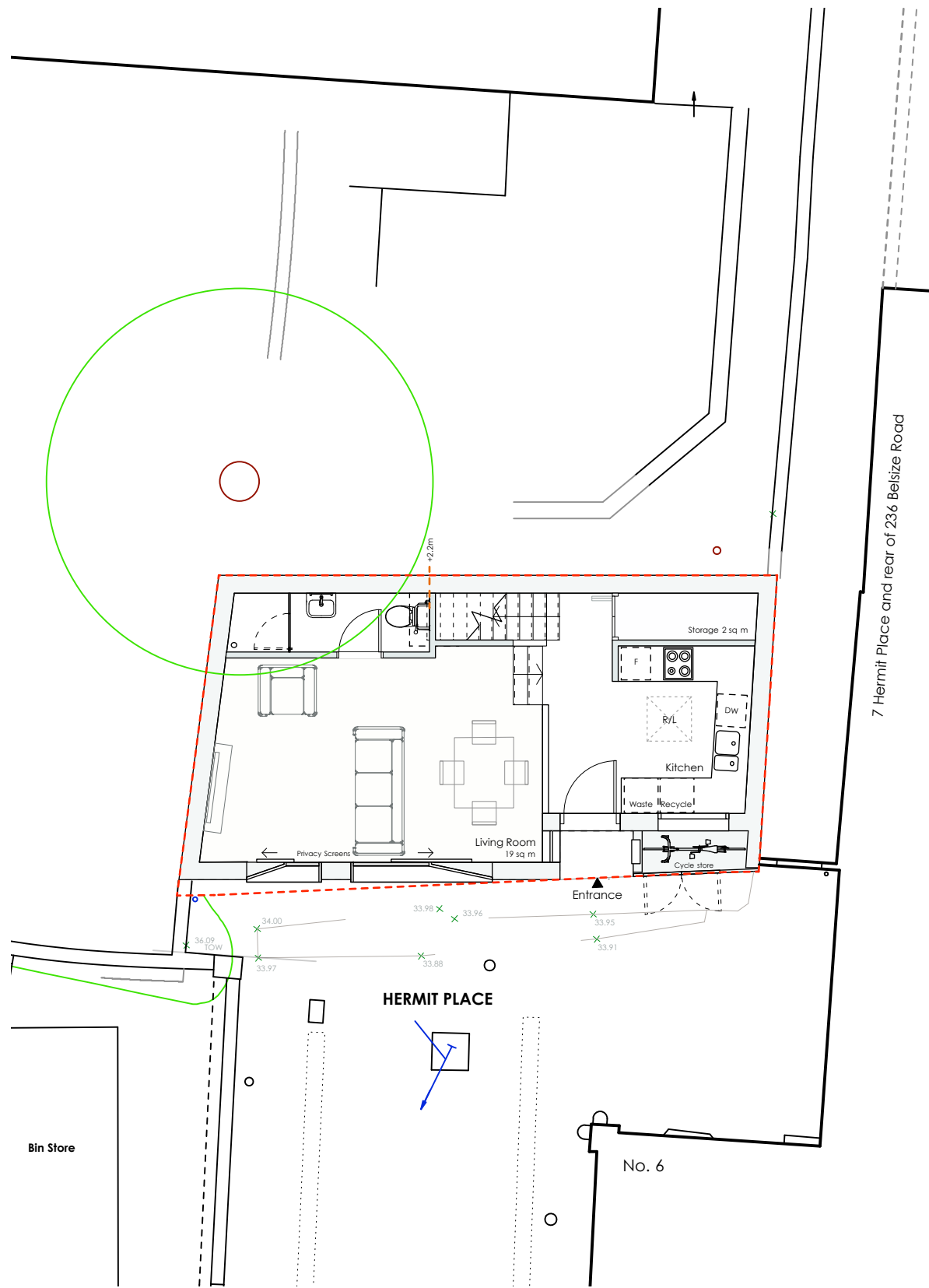

**PLANNING ISSUE 2022**

<div>AP (a.)</div> <div>alan power   (ARCHITECTS.)</div> <div>Alan Power Architects Ltd 13 Needham Road London, W11 2RP Tel. 020 7229 9375 Fax. 020 7221 4172</div>	<b>DRAWING</b> PROPOSED FRONT (SOUTH-WEST) ELEVATION	<b>DRWG. N°.</b> 527/305
	<b>PROJECT</b> 5 HERMIT PLACE LONDON NW6 4BZ	<b>Rev.</b>
	<b>CLIENT</b> EMPIRE COMMUNICATIONS LTD	<b>Scale</b> 1:50 @ A2 1:100 @ A4
		<b>Date</b> March 2022 <b>Drawn</b>

DO NOT SCALE FROM THIS DRAWING. ALL DIMENSIONS TO BE CHECKED ON SITE AND DISCREPANCIES REPORTED TO ARCHITECT