

**HARD LANDSCAPE EDGE DETAILS: refer to hard landscape plan SP108\_04\_HL & to relevant engineer's information**  
**TIMBER EDGES**

**Timber edges - ED1**

[Soft landscape - Timber cobbles]

- Location: Central public space
- Material: Treated (tanalised) softwood timber

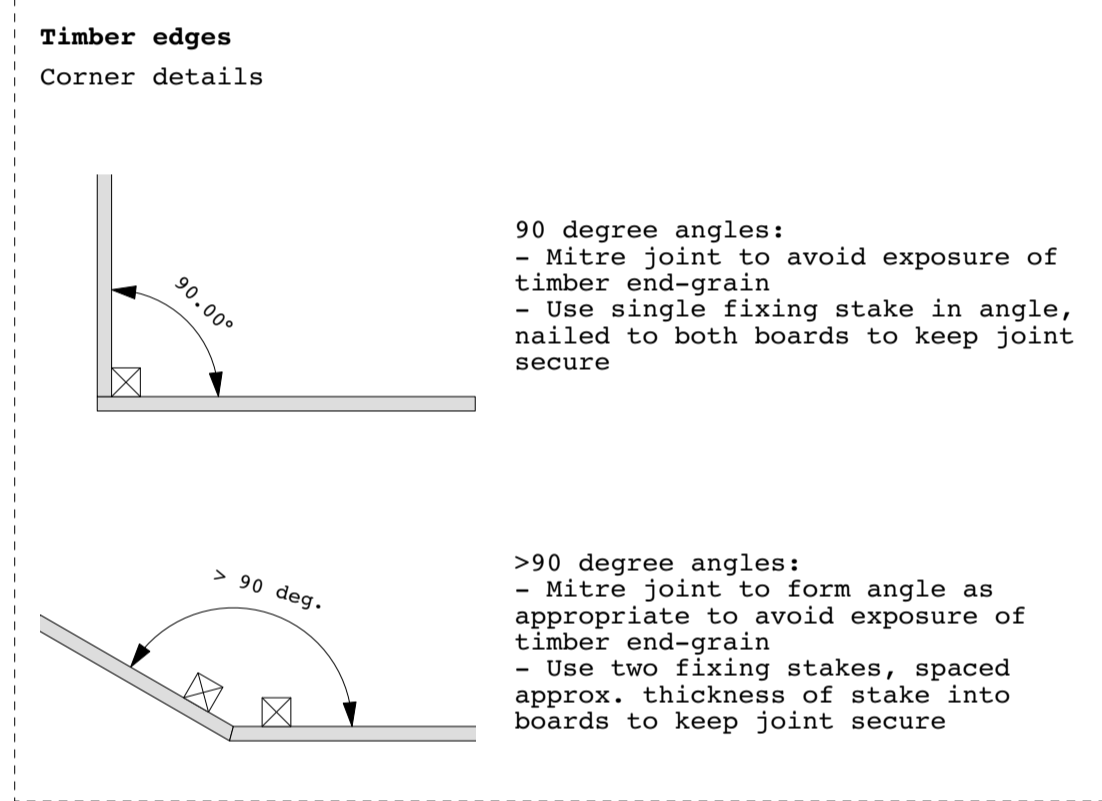
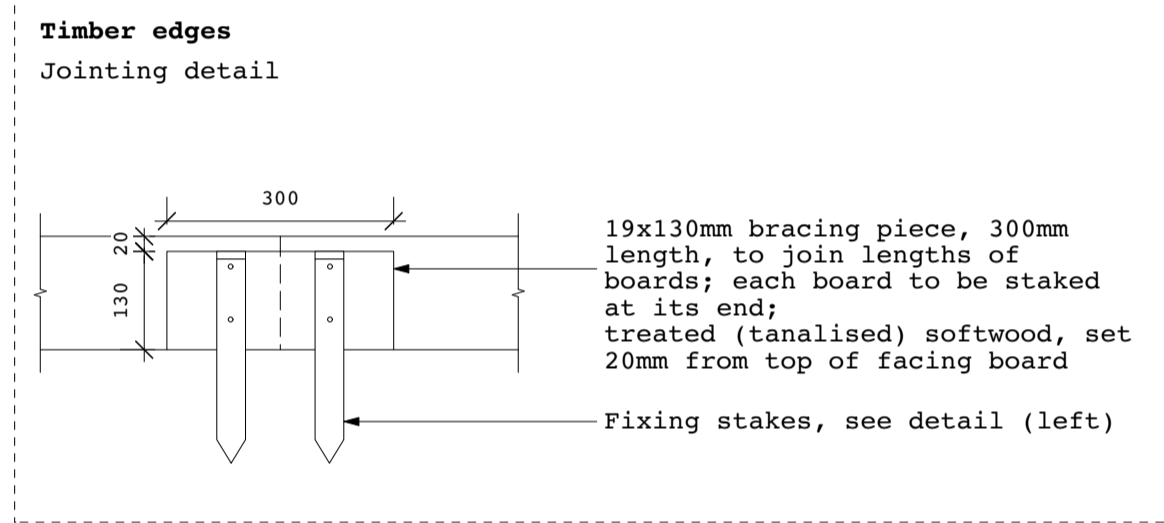
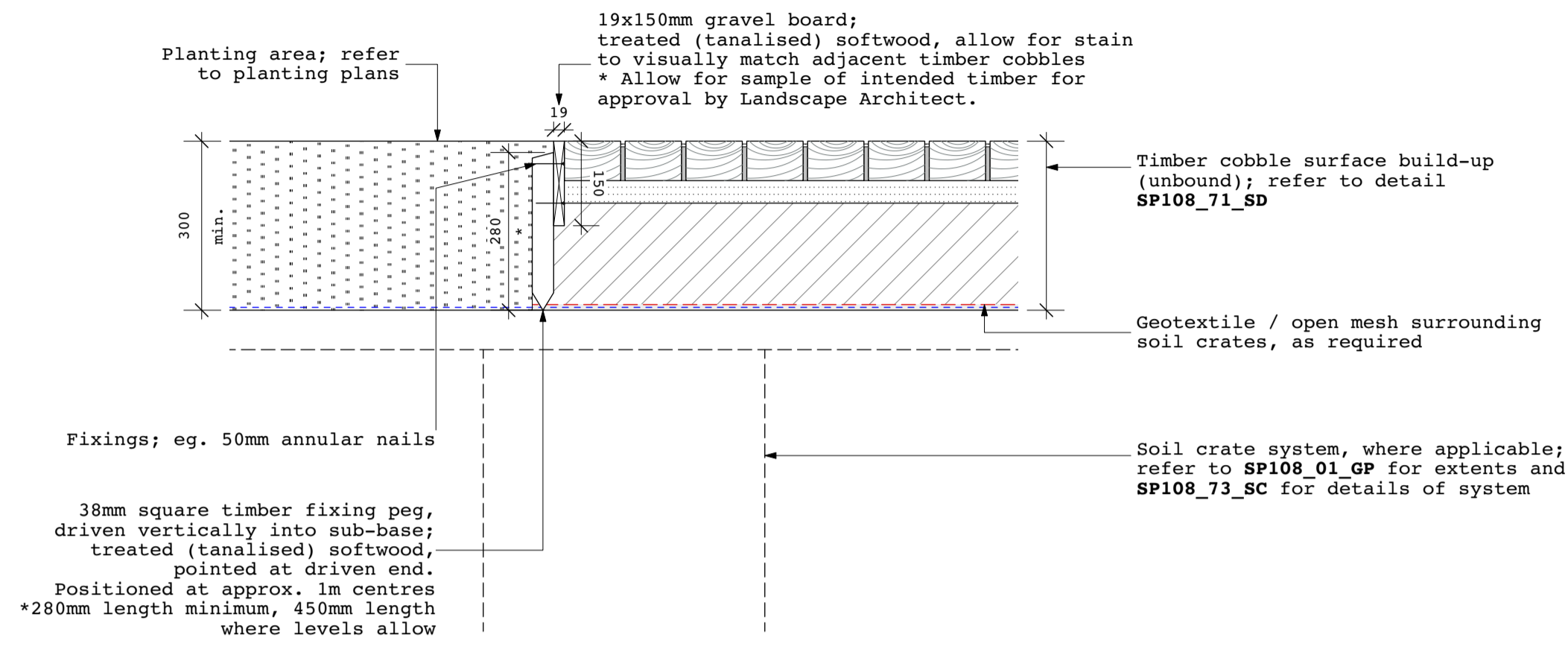

**Timber edges - ED2**

[Edging to planting area in play garden - refer to layout plan]

- Location: Central public space
- Material: Treated (tanalised) softwood timber

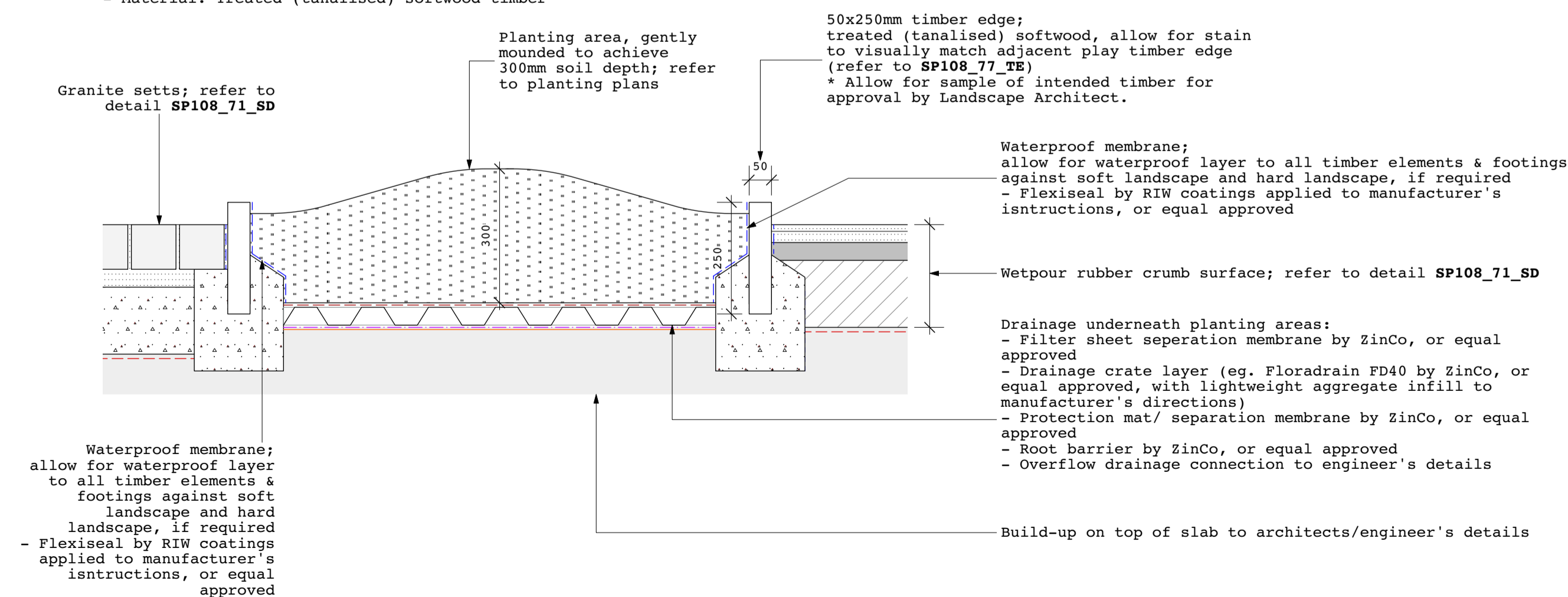

For surfaces key and areas, refer to hard landscape plan: SP108\_04\_HL

© JCLA

Do not scale from this drawing. Any discrepancies or queries should be brought to the attention of the authors. Dimensions are to be verified on site prior to construction.

All existing site, tree and building information has been compiled from different sources.

Refer to current revisions of all referenced files.

Notes:

Key:

Rev	Date	Description
T1	30.10.20	Issued for Tender
T2	18.02.22	Timber sample request note added

<b>JCLA</b>	
Jonathan Cook Landscape Architects Ltd 3A Lifford Yard LONDON SE17 3QA Tel +44 (0)207 703 3270 www.jcla.co.uk	
Client	W.RE
Project	SP108: St Pancras Commercial centre
Drawing Title	Edge details 1: Timber
Drawing Number	SP108-72-ED-1
Date	18.02.22
Revision	T2
Scale (8 A1)	1:10
Drawing Status	Stage 4