

HARD LANDSCAPE SURFACE DETAILS: refer to hard landscape plan SP108_04_HL & to relevant engineer's information

Granite setts - Square format

[Vehicular loading & pedestrian/occasional MEWP loading]

- Location: Central public space
- Size: 100x100mm x 100mm depth
- Finish: Bush-hammered
- Product: Granite, mid grey colour eg. Natural granite setts by Hardscape - Silva Montemuro Cinza, or equal approved
- Bound construction, mortar bedded and jointed to resist wheel turning etc.
- > Site category for vehicle loading has been confirmed by project engineers as category III according to Table 1 of BS 7533-10; design joint widths & bedding have been specified accordingly
- For contrasting setts at vehicle exit to St Pancras Way, use a contrasting colour; eg. Preta Odilvelas by Hardscape, or equal approved - refer to SP108_11_01

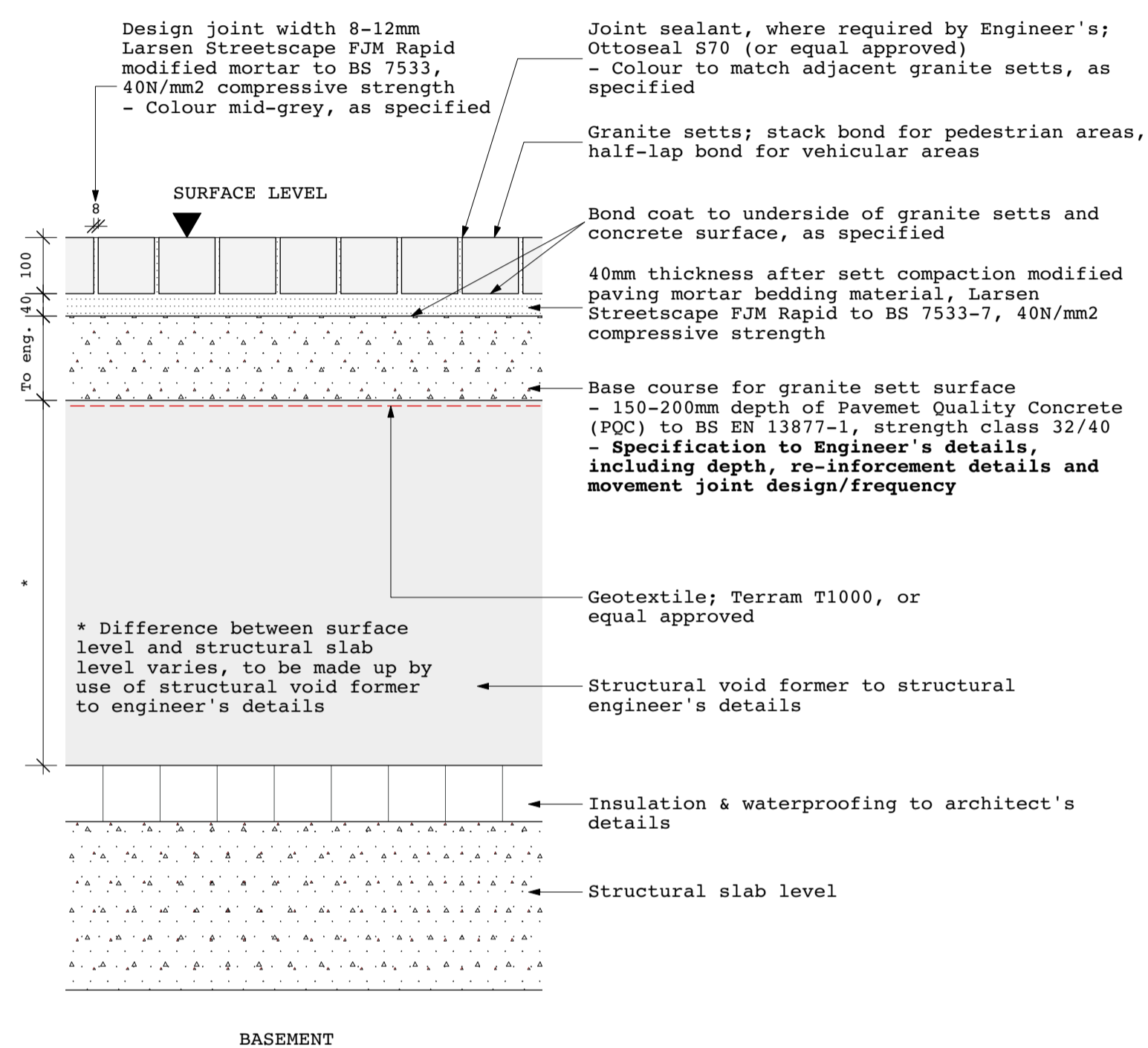

Timber cobbles

[Pedestrian loading]

- Location: Central public space
- Size: 100mm square x 70mm depth
- Finish: Untreated, refer to manufacturer's guidance for slip resistance testing - Note additional cleaning requirements to maintain slip resistance, refer to specification & landscape management plan
- Product: Oak setts, natural finish eg. PW640 oaks setts (natural) by Allgreen group, or equal approved
- Permeable construction, using 'Drainjoint' product by Hardscape, or equal approved, in-between cobbles

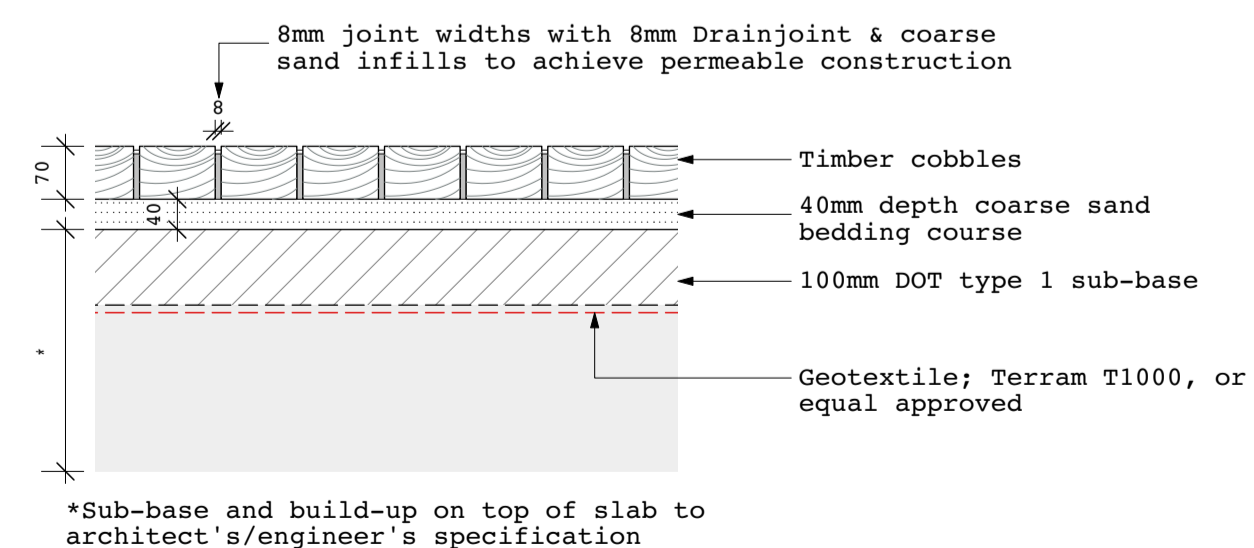

Granite paving over smoke vent panel

[Pedestrian/MEWP access loading]

- Location: Central public space
- Size: 100x100 x 35mm thickness (TBC following breakout test, as note below)
- Finish: Bush-hammered
- Product: Granite to match setts eg. Natural granite, Silva Montemuro Cinza by Hardscape or equal approved
- Bound construction
- Note requirements for mock-up panel and breakout test to be witnessed by London Fire Brigade Officer; contractor to allow for this process - refer to specification Q25/330 - Type B

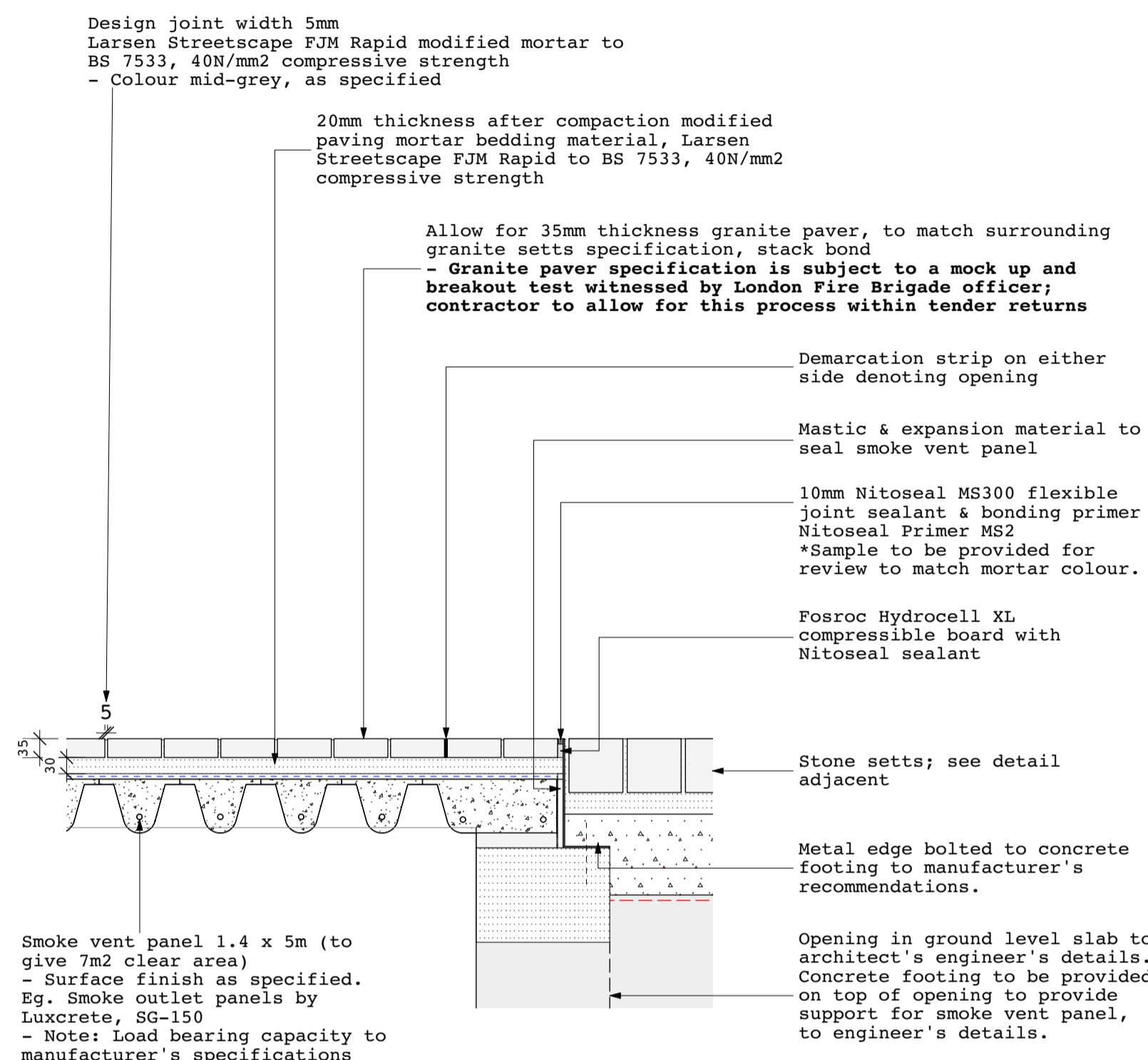

Wetpour rubber crumb surface

[Pedestrian loading]

- Location: Central public space, play area
- Size: as specified on plans
- Finish: Porous rubber crumb, refer to manufacturer's guidance for slip resistance
- Product: eg. Novaplay by Novasport, or equal approved to same level of accreditation for play surfaces
- Colour: Bespoke colour mixture using 4/5 different colours to achieve 'sand' colour
- Permeable construction, using fully porous macadam base

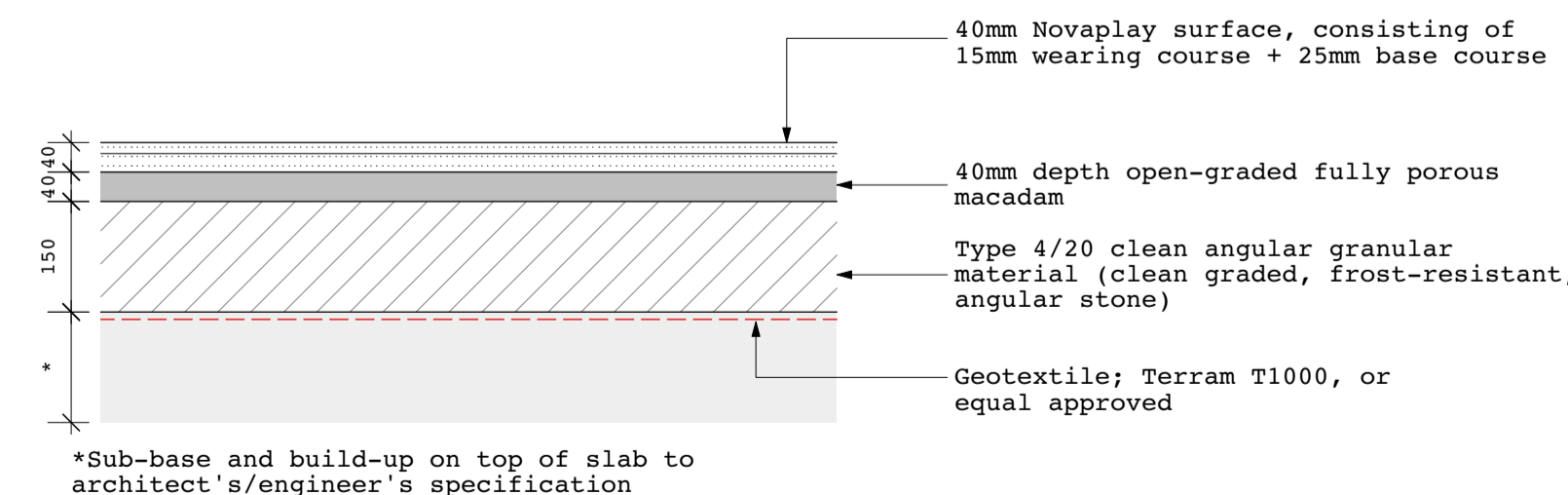

Notes:

- Sub-base build-ups (where not above basement) are to engineer's specifications, based on the assumption that the CBR value is 2.0%, subject to confirmation by the contractor on site
- For surfaces key and areas, refer to hard landscape plan: SP108_04_HL

Key:

Rev	Date	Description
S31	03.02.20	Stage 3 issue
T1	30.10.20	Issued for Tender
T2	09.11.20	Updated spec. of granite setts to civil engineer's details
T3	18.02.22	Added flexible joint provision and mortar details

JCLA	
Jonathan Cook Landscape Architects Ltd 3A Lillife Yard LONDON SE17 3QA Tel +44 (0)207 703 3270 www.jcla.co.uk	
Client	W.RE
Project	SP108: St Pancras Commercial centre
Drawing Title	Surface details
Drawing Number	SP108-71-SD
Date	18.02.22
Revision	T3
Scale (8 A1)	1:10
Drawing Status	Stage 4