

Central garden (West) - Area F

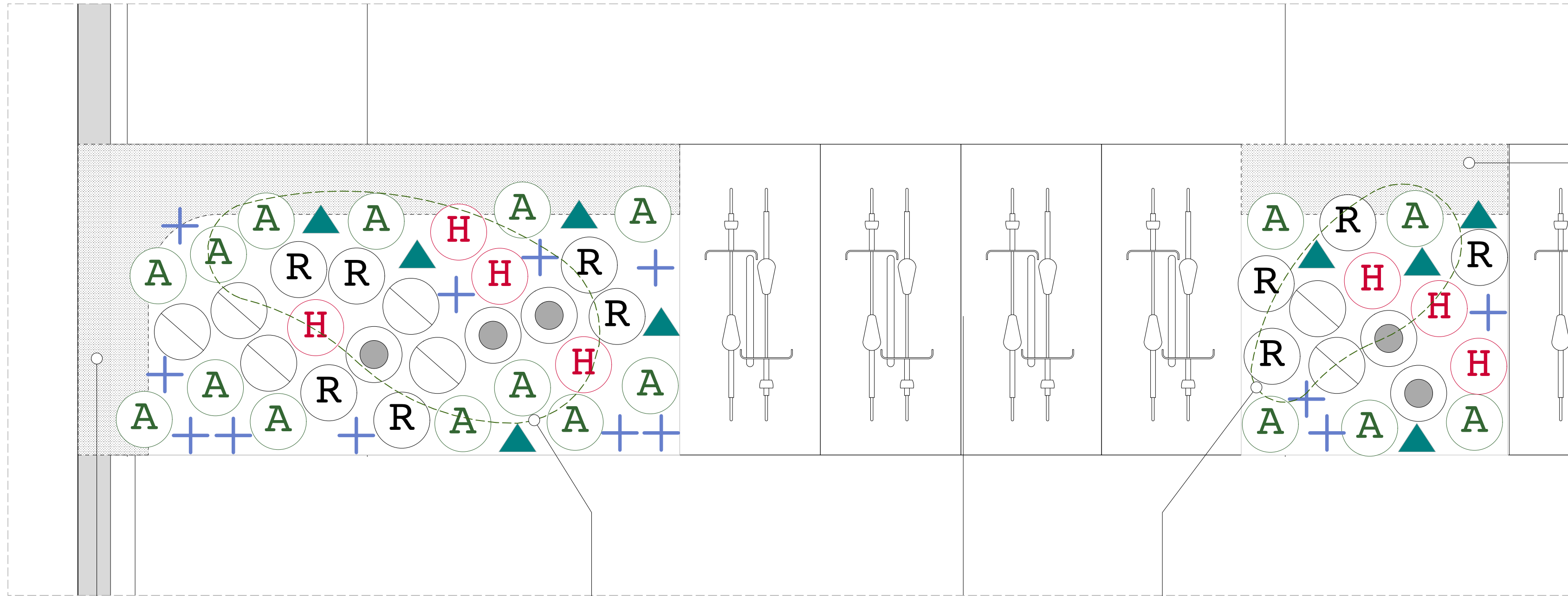

Edge matrix 2 (brighter): 1m2
 All plants to be 2L CG; distributed randomly throughout the area shown to the numbers & percentages below, to achieve a naturalistic appearance (7 plants/m2)

Herbaceous plants:
 - Geranium 'Ingwersen's Variety' - 40% - 3no.
 - Sanguisorba 'Tanna' - 30% - 2no.
 Grasses:
 - Sesleria heufleriana - 30% - 2no

Mid-height (bright):
 Plant as directed by symbol below, to achieve an overall density of 7 plants/m2

- Herbaceous plants, 2L CG:
- + - Achillea filipendulina 'Parker's Variety' - 13no.
 - ▲ - Dryopteris ethyrosora - 9no.
 - Ⓜ - Helenium 'Morheim Beauty' - 7no.
 - Ⓡ - Rudbeckia fulgida 'Goldsturm' - 10no.
 - ⊗ - Salvia nemerosa 'Ostfreisland' - 7no.
 - - Verbena bonariensis - 5no.
 - Grasses, 2L CG:
 - Ⓐ - Anemathele lessoniana - 18no.

Edge matrix 2 (brighter): 3m2
 All plants to be 2L CG; distributed randomly throughout the area shown to the numbers & percentages below, to achieve a naturalistic appearance (7 plants/m2)

Herbaceous plants:
 - Geranium 'Ingwersen's Variety' - 40% - 9no.
 - Sanguisorba 'Tanna' - 30% - 7no.
 Grasses:
 - Sesleria heufleriana - 30% - 7no.

Bulbs: 2m2
 Narcissus poeticus var. recurvus (8/m2)
 - sow in drifts as shown on drawing, to achieve naturalistic appearance - 16no.

Bulbs: 2m2
 Narcissus poeticus var. recurvus (8/m2)
 - sow in drifts as shown on drawing, to achieve naturalistic appearance - 16no.

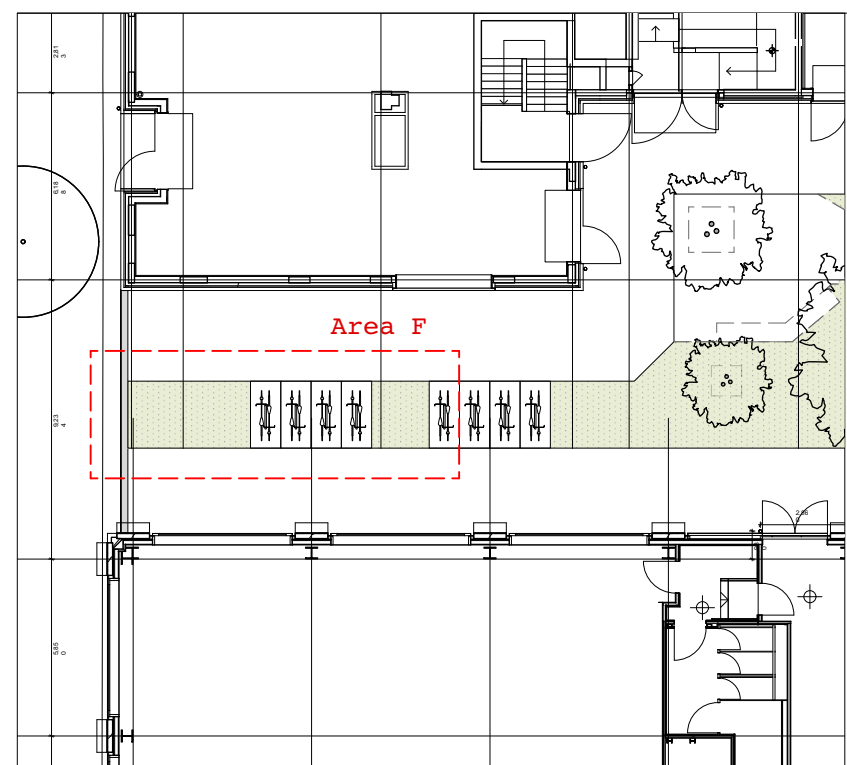

Notes:

- Refer to separate Tree Survey by Tim Moya Associates (March 2019) - RPA information taken from Tree Survey.
- Refer to Tree Protection Plan and Arboricultural Impact Assessment by Tim Moya Associate (Jan-20).

This drawing must be printed and read in full colour.

Proposed trees:
 - Refer to SP108_01_GP and planting schedule

Topsoil/growing medium for planting:
 - Refer to Q28/711 in landscape specification SP108_Doc04_LS for summary of growing medium & depths

Establishment fencing:
 - Refer to Q31/730 in landscape specification SP108_Doc04_LS
 - Refer also to planting schedule SP108_Doc05_PS

Rev	Date	Description
T1	30.10.20	Issued for Tender
T2	18.02.22	Updated plan layout

JCLA

Jonathan Cook Landscape Architects Ltd
 3A Iliffe Yard
 LONDON SE17 3QA
 Tel +44 (0)207 703 3270
 www.jcla.co.uk

© JCLA

Do not scale from this drawing. Any discrepancies or queries should be brought to the attention of the authors. Dimensions are to be verified on site prior to construction.

To be read in conjunction with all relevant Architects', Services and Structural Engineers' drawings.

All existing site, tree and building information has been compiled from different sources.

Refer to current revisions of all referenced files.

Client W.RE	
Project SP108: St Pancras Commercial centre	
Drawing Title Proposed planting plan: Public space - Area F	
Drawing Number SP108-31-PP-4	
Date 18.02.22	Revision T2
Scale (8 A1) 1:25	Drawing Status Stage 4