

Design Intent Note:

- Planters to existing boundary wall at 450mm depth supporting climber species. Trellis structure to be installed on top of existing walls below 2.4m height to support existing vegetation screening on site in line with Lymington Rd resident's requirements.

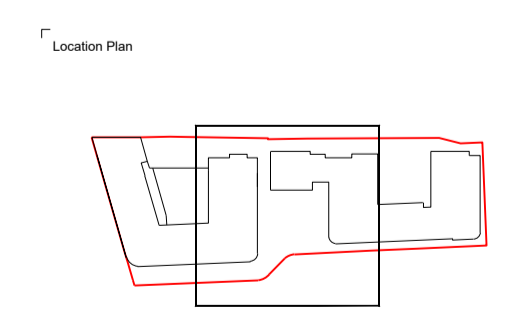

fabik landscape architects
 First Floor Studio | The Old School | 4 Exton Street | London | SE1 8UE
 T: 0207 620 1453 | E: london@fabrik.com | W: www.fabrik.com

Project: West End Lane, London
 Client: Astir
 Drawing Title: Planting Plan Ground Floor East Block (Sheet 3 of 3)
 Project of Issue: STAGE 4
 Drawn By: KBP
 Checked By: PDC
 Drawn Date: 1:100 @ A1
 Date of First Issue: NOV | 2021

Project Number	Role	Originator	Type	Series	Level	Number	Revision
0001	L	FAB	DRG	XX	00	3003	T04

Rev	Date	By	Check	Description
T04	01 08 2022	KBP	PDC	Stage 4 - Layout update
T03	17 12 2021	KBP	PDC	Stage 4 - Challenge of conditions
T02	12 11 2021	KBP	PDC	Challenge of conditions
T01	04 11 2021	KBP	PDC	Tender

Drawn: KBP
 Checked: PDC

Disclaimer:
 1. This drawing is copyright of fabrik ltd. It must not be copied or reproduced without written consent from the owner.
 2. Do not scale from this drawing. Only figured dimensions are to be taken from this drawing.
 3. All contractors must read and be responsible for taking and checking all dimensions related to the works shown on the drawing prior to fabrication or setting out.
 4. This drawing uses coloured lines. Please do not rely on a monochrome copy.

External References: