

Design Intent Notes:

1. **Kinley Raft System**
 - a. The accessible roof area has been designed using the Kinley Raft system. The system is made up of components including an aluminium sub-structure, planting trays, metal planter edges/walls and benches.
 - b. The contractor/manufacturer will be required to submit workshop drawings for approval for the entire system prior to fabrication.
 - c. The system will utilise a 50mm deep aluminium substructure where possible. Where build up depth is limited, a 30mm deep substructure will be used.
 - d. The raft system continues across the extent of the podium and includes the maintenance areas. This to allow the full support of perimeter planters. Any reduction in raft system will be part of the supplier and contractor design.
2. **Maintenance Strip:**
 - a. Setting out the works should allow for a minimum 600mm maintenance strip between all raised planters and the roof parapet wall.
 - b. The maintenance strip shall be secured from public access by a welded mesh fence and a gated access.
3. **Fire Prevention**
 - a. All systems, materials and components at roof level will need to be approved by Building Control and the fire safety consultant.
4. **Protection from Falling (Post Construction)**
 - a. A 1.1m high welded mesh fence will provide fall protection at from publicly accessible areas at roof level. This fence has been positioned to ensure that members of the public the encroach into the planted areas are protected from falling over the roof parapet. When setting out of the roof area, the contractor must ensure that all areas of raised planting bed within 1m of the roof parapet are protected by a minimum 1.1m high impenetrable barrier.

Design Intent Notes Continued:

5. **Artificial Grass Surfacing**
 - a. The artificial grass surfacing is specified as a fire rated system which has been tested and approved as a complete system and not as individual elements (refer to the specification (Q26 350A). Substituting any part of this system will invalidate the fire rating.
- For biodiverse/solar roof layouts refer to: 0001-L-FAB-DRG-XX-RF-1001-Site Wide Green Roofs Plan**

●●●●● Scope of works lines

Rev	Rev Date	Rev Description	Issued By
T03	17.12.2021	Stage 4	KBP
T02	12.11.2021	Conditions Discharge	KBP
T01	04.11.2021	Issued for Tender	KBP

1. This drawing is copyright of fabrik ltd. It must not be copied or reproduced without written consent from the owner.
 2. Do not scale from this drawing. Only figured dimensions are to be taken from this drawing.
 3. All contractors must visit site and be responsible for taking and checking all dimensions related to the works shown on the drawing prior to fabrication or setting out.
 4. This drawing uses coloured lines. Please do not rely on a monochrome copy.

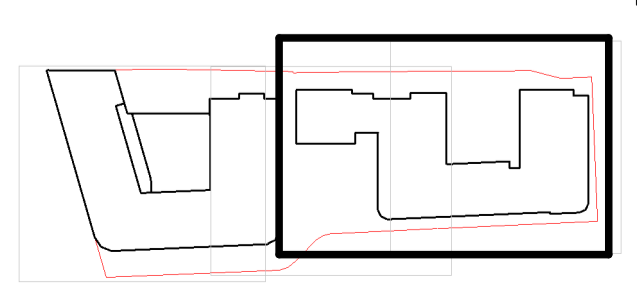
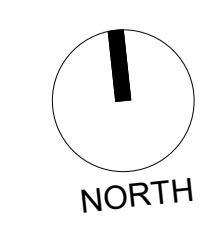

fabrik landscape architects

Project: West End Lane
Client: Astrir

Drawing Title: East Block Roof Levels General Arrangement Plan

Project Number: 0001
Role: L
Originator: FAB
File Type: DRG
Series: XX
Level: RF
Number: 2006
Revision: T03

First Floor | 4-8 Emerson Street | London | SE1 9DU
T: 0207 820 1453 | E: london@fabrikuk.com | W: www.fabrikuk.com

Drawn By: MC
Checked By: PDC
Drawn Scale: 1:100
Date of First Issue: Nov 21