

NOTES  
DO NOT SCALE FROM THIS DRAWING.  
CONTRACTOR TO CHECK ALL DIMENSIONS ON SITE.  
ANY DISCREPANCIES TO BE REPORTED TO THE ARCHITECT IMMEDIATELY.  
COPYRIGHT MICA ARCHITECTS LTD ©  
Text

- KEY
- Proposed demolition
  - Proposed demolition of walls
  - High Level service penetrations

Note:  
All works to be in accordance with outline spec.  
fire strategy, MEP and Structural drawings  
All works subject to confirmation of building  
control, planning and listed building consent.  
Drawing shows required number and area of service  
penetrations required. The exact locations are  
approximate and may be subject to slight adjustments  
following further structural and MEP coordination.  
Where possible, penetrations use, or enlarge existing  
openings in walls.  
Refer to drawing 19230 for internal elevations showing  
service penetrations.

PL3	11.02.22	PLANNING UPDATE
PL2	04.02.22	PLANNING UPDATE
PL1	10.11.21	PLANNING ISSUE
P6	04.10.21	PLANNING ISSUE
P5	31.08.21	STAGE 3 ISSUE
P4	20.08.21	DRAFT STAGE 3 ISSUE
P3	18.05.21	STAGE 2 ISSUE
T2	04.02.21	SOFT STRIP TENDER ISSUE
T1	29.01.21	SOFT STRIP TENDER ISSUE
P2	28.01.21	PRELIMINARY ISSUE
P1	06.08.20	PRELIMINARY ISSUE
REV	DATE	DESCRIPTION

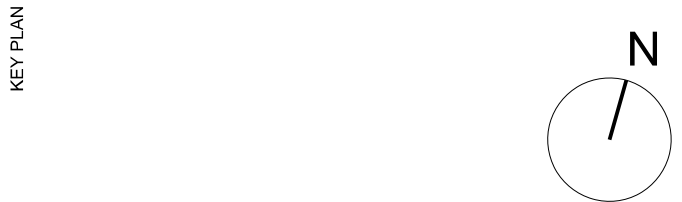

STATUS  
**PLANNING**

**MICA**  
123 Camden High Street London NW1 7JR  
T: 020 7284 1727 F: 020 7267 7626  
info@micaarchitects.com www.micaarchitects.com

JOB  
**NORFOLK HOUSE**  
13 Southampton Place  
Holborn

TITLE  
**Existing- demolition**  
First floor plan

DRG # **710-MICA-NH-01-DR-A-11102** REV **PL3**

CHECKED PW	DRAWN RM	SCALE 1:50	SIZE A1	REV/DATE 11.02.22
---------------	-------------	---------------	------------	----------------------