

Existing Lower Ground Floor Plan

As per measured survey

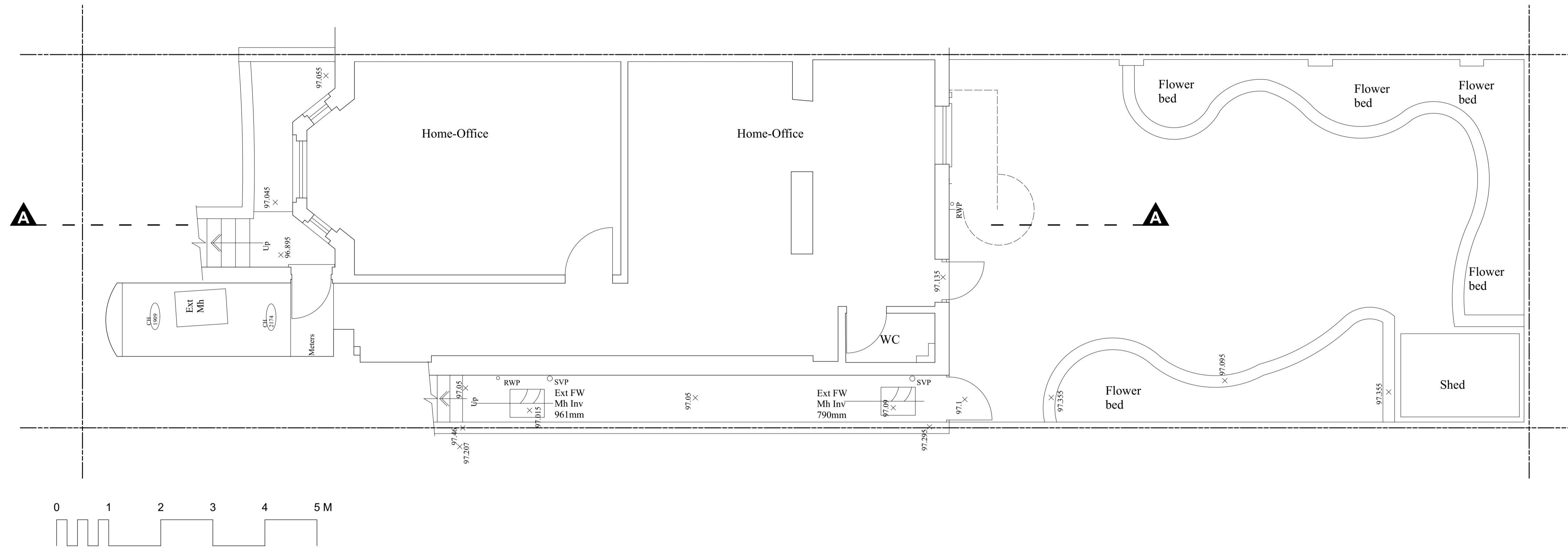
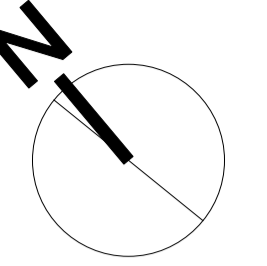

Undercover

Undercover Architecture
The Studio, 48 Mornington Terrace
Regents Park
London NW1 7TX
T: 020 7388 7698
E: info@undercoverarchitecture.com

This drawing is the copyright of Undercover Architecture Ltd. and may not be copied, altered or reproduced in anyway or passed to a third party without written authority. All dimensions are subject to site survey and site verification. Do not scale.

General Notes:

Project

11 Laurier Road, London NW5 1SD

Client

Andrew McMaster

Sheet Title

Existing Lower Ground Floor Plan

Date

02/03/2022

Sheet Number PA 101

Revision
Planning

Scale
1:50@A1 / 1:100@A3