

GENERAL NOTES:
 ALL DIMENSIONS TO BE CHECKED ON SITE AND ANY DISCREPANCIES TO BE REPORTED TO RSS
 ALL FINISHES, SAMPLES AND MOCK UPS TO BE APPROVED BY RSS PRIOR TO MANUFACTURE
 FOR SANITARYWARE AND LIGHTING REFER TO RSS SPECIFICATION INDEX FOR FURTHER INFORMATION
 FOR FINISHES REFER TO FINISHES SCHEDULE
 REFER TO RSS SPEC INDEX FOR LIST OF ALL FF&E ITEMS
 ALL EXISTING FURNITURE TO BE REMOVED UNLESS STATED OTHERWISE BY THE CLIENT

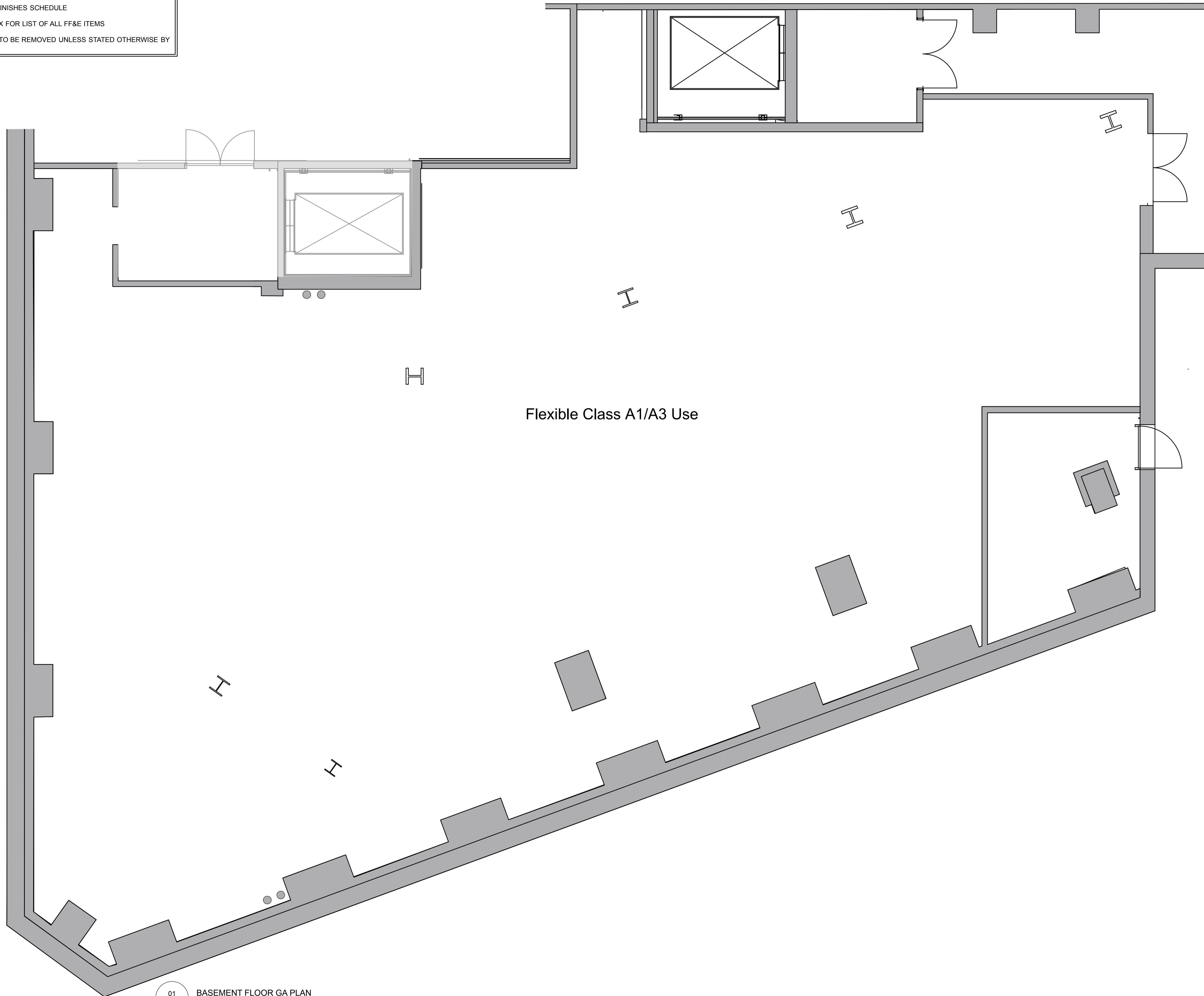

01 PL-B-01 BASEMENT FLOOR GA PLAN
 Scale: 1:50

REVISIONS:		
CODE	DATE	DESCRIPTION
A	24.02.22	ISSUE FOR INFORMATION

Russell Sage Studio
 St Michael's House | Elizabeth Street | London | SW1W 9RB | T: +44 (0)20 7730 3258
russellsagestudio.co.uk

THIS DRAWING IS THE PROPERTY OF RUSSELL SAGE STUDIO. COPYRIGHT IS RESERVED TO THEM AND THE DRAWING IS ISSUED ON THE CONDITION THAT IT IS NOT COPIED EITHER WHOLLY OR IN PART WITHOUT THE CONSENT IN WRITING OR RUSSELL SAGE STUDIO.

- ALL DIMENSIONS, DRAWINGS AND SPECIFICATIONS ARE TO BE VERIFIED ON SITE BY THE CONTRACTOR AND ANY DISCREPANCIES REPORTED TO RSS PRIOR TO THE COMMENCEMENT OF WORK.
- THIS PLAN HAS BEEN EXTRACTED FROM SUPPLIED DRAWINGS AND HENCE IS SUBJECT TO SURVEY AND CONTRACTOR SETTING OUT PLAN.
- CONTRACTOR TO TAKE RESPONSIBILITY AND ENSURE ALL CONSTRUCTION METHODS, TECHNIQUES, FITTINGS AND FINISHES ETC CONFORM TO THE REQUIRED BUILDING REGULATIONS IN THE APPLICABLE COUNTRY, AND TO THE RELEVANT BUILDING CONTROL OFFICERS SATISFACTION.
- ALL SPECIFIED ITEMS ARE TO BE INSTALLED IN ACCORDANCE WITH THE MANUFACTURERS RECOMMENDATIONS.
- ALL FINISHES ARE TO BE CARRIED OUT TO A HIGH STANDARD.

THIS DRAWING IS TO BE READ IN CONJUNCTION WITH ALL OTHER RELEVANT CONSULTANTS DRAWINGS. ALL REQUESTED DRAWINGS SHOWING FIXINGS AND CONSTRUCTION DETAILS TO BE APPROVED BY RSS PRIOR TO COMMENCEMENT OF WORK. CONTRACTORS TO CHECK AND APPRAISE DESIGN, FITTING OUT AND CONSTRUCTION DETAILS AND OFFER SUITABLE ALTERNATIVES TO THE DESIGNERS FOR APPROVAL PRIOR TO MANUFACTURE AND INSTALLATION. CONTRACTOR TO PROVIDE A SUITABLE WORKING ENVIRONMENT WHICH CONFORMS TO THE CURRENT HEALTH AND SAFETY CONDITIONS AND LOCAL AUTHORITY REGULATIONS.
 DRAWING STATUS: **TENDER**

CLIENT:		SANDBOX VR	
PROJECT NO:	PROJECT:	5230 THE POST BUILDING	
DATE:	DRAWN:	CHECKED:	SCALE:
7th Dec 21	JR	LK	1:50 @ A1 1:100 @ A3
TITLE:			
EXISTING BASEMENT FLOOR GENERAL ARRANGEMENT PLAN			
DWG. NO:			REV:
5230-PL-B.01			A