

DISCLAIMER:
 FOR ACCURACY, ALL DIMENSIONS AND SPECIFICATIONS MUST BE CONFIRMED AT THE SITE AND WITH RELEVANT TECHNICAL DRAWINGS.
 TO BE READ IN CONJUNCTION WITH STRUCTURAL ENGINEER'S DRAWINGS AND SPECIFICATIONS.
 TO BE READ IN CONJUNCTION WITH SERVICE ENGINEER'S DRAWINGS AND SPECIFICATIONS.
 ANY DISCREPANCY BETWEEN DRAWINGS AND DIMENSION ON SITE ARE TO BE BROUGHT TO THE ATTENTION OF THE ARCHITECT PRIOR TO CONSTRUCTION.
 2022 © CHARLES TASHIMA ARCHITECTURE. ALL RIGHTS RESERVED. NO INFORMATION OR DESIGNS CONTAINED WITHIN THIS DOCUMENT SHOULD BE COPIED OR REPRODUCED WITHOUT THE CONSENT OF CHARLES TASHIMA ARCHITECTURE.

- KEY**
- 1 - Extension replacement at lower ground floor
 - 2 - Lowering the sills in the bay window for a double doorset in the central window, and a single door to the LHS window.
 - 3 - Three new rear elevation windows
 - 4 - Widening of door on existing balcony
 - 5 - Removal of existing planters
 - 6 - Removal of hedge trees
 - 7 - Introduction of new skylight
 - 8 - Replacement of existing skylight
 - 9 - Conversion of doorway to window

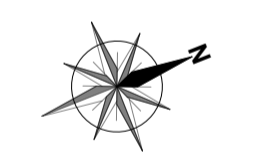
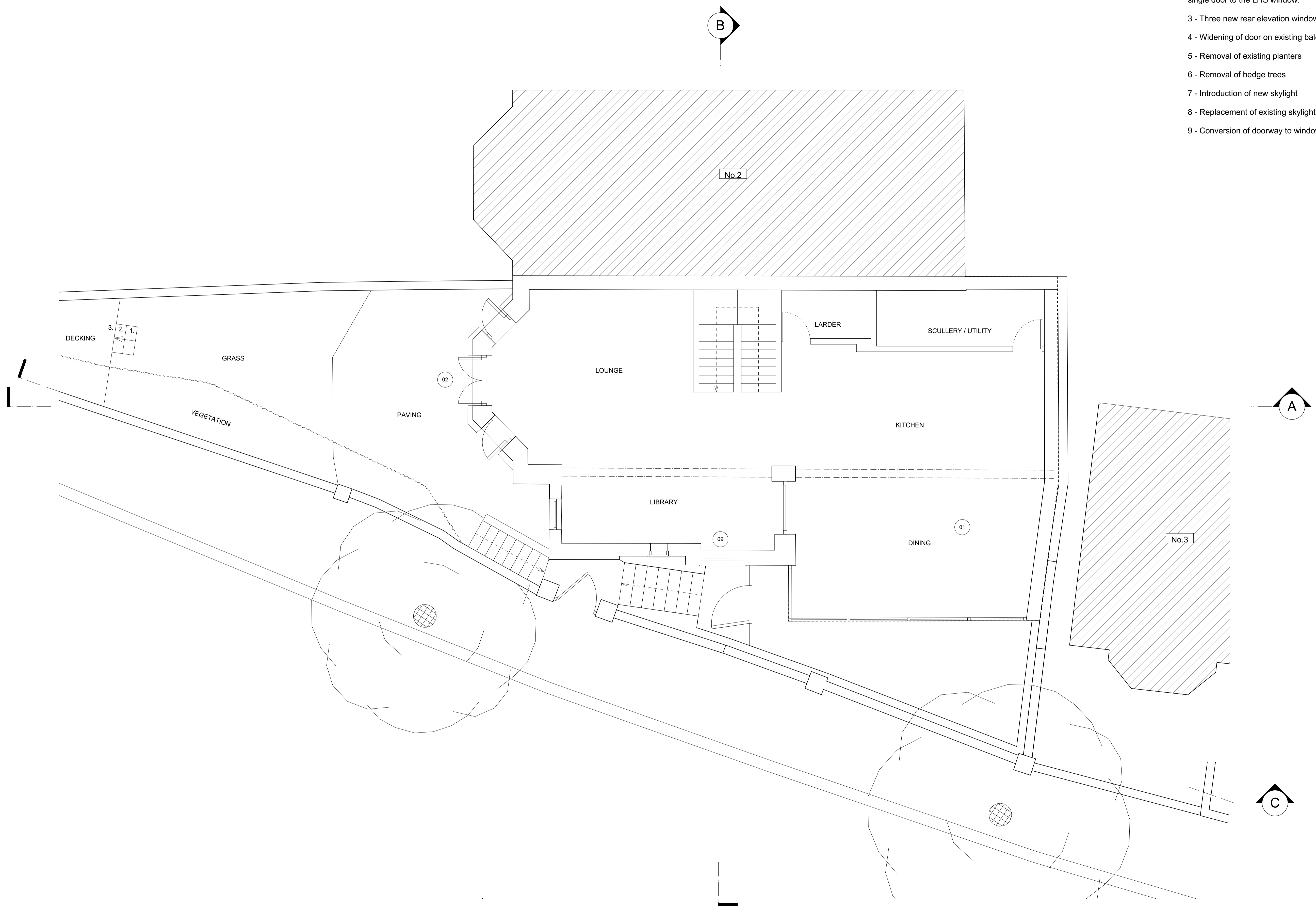

PLANNING

PROJECT:
**1 SOUTH HILL PARK GARDENS
 LONDON NW3 2TD**

PROJECT NUMBER:	1122
PROJECT STAGE:	PLANNING
ISSUE DATE:	FEBRUARY 2022
SCALE:	1:50 @ A1 1:100 @ A3
DOCUMENT NUMBER:	110
REVISION:	

SUBJECT:
**PROPOSED PLAN
 LOWER GROUND FLOOR**

CLIENT: Lauren Segal & Jonathan Broomberg

CHARLES TASHIMA ARCHITECTURE
 Unit 12A
 Blackstock Mews
 London N4 2BT

Landline: +44(0)20 7281 2351
 Email: info@ct-arch.co.uk
 Website: www.ct-arch.co.uk

