

THIS DRAWING SHOULD BE READ IN CONJUNCTION WITH ALL
OTHER PROJECT RELATED DRAWINGS, SPECIFICATIONS AND
DOCUMENTS AS PART OF A SINGLE PROJECT PACKAGE.

PLEASE CONSULT THE AUTHOR OR PROJECT MANAGER SHOULD
THE READER REQUIRE CLARIFICATION ON ANY PART OF THIS
DRAWING.

NOTES

P02	03.02.22	SEJ	BG	JM	Issued for Planning Issue
P01	02.02.22	SEJ	BG	JM	Issued for Comment
Rev	Date	By	Chk	Apr	Comment

B



FRANKHAM

Frankham Consultancy Group Limited
 E: enquire@frankham.com
 www.frankham.com



<p>SIDCUP OFFICE</p> <p>Irene House Five Arches Business Park Maidstone Road Sidcup, Kent DA14 5AE T: 020 8309 7777</p>	<p>OXFORD OFFICE</p> <p>Citibase Oxford New Barclay House 234 Botley Road Oxford OX2 0HP T:01865 322500</p>
<p>LONDON OFFICE</p> <p>First Floor Bridge House 181 Queen Victoria Street London EC4V 4EG T: 020 7651 0790</p>	<p>STEVENAGE OFFICE</p> <p>Suite 237, Second Floor Kings Court Business Centre London Road, Stevenage Hertfordshire SG1 2NG T:020 3714 2063</p>

Client: _____

[illegible]

Project Title:
37 Glenloch Road, Camden,
NW3 4DJ
Window and Rear Door
Replacement Works

Drawing Title:

Existing and Proposed Window Details 1

Status:	
---------	--

D		D		D		D		D	

Original Issue Date: 02/02/2022	Scale @ A2: 1:10
------------------------------------	---------------------

Job No/ File Ref 228021		Originator FCG	Zone MB	Level EL
Type DR	Discipline B	Number 2400	Suitability S4	Revision P02

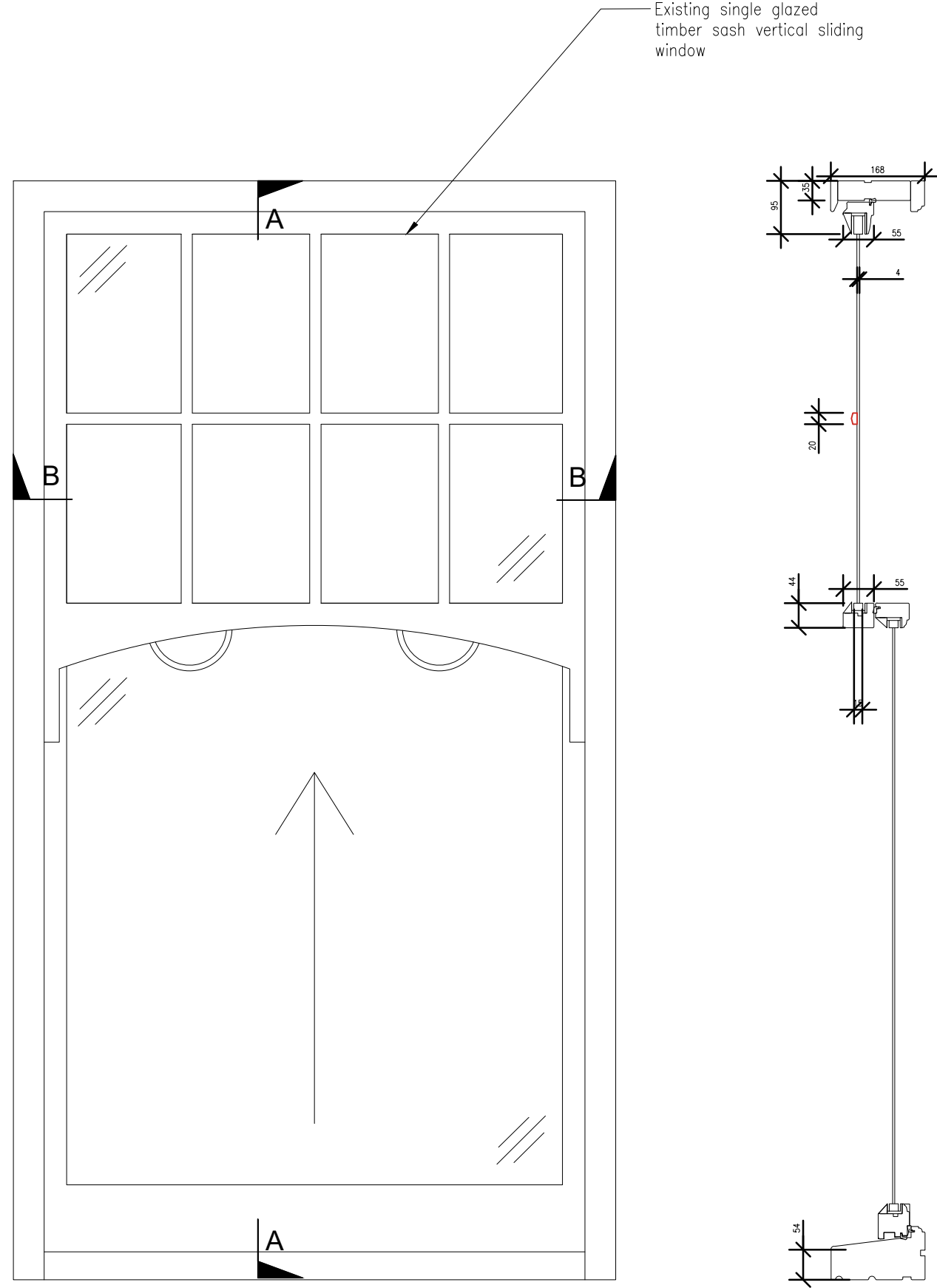

Elevation Detail B

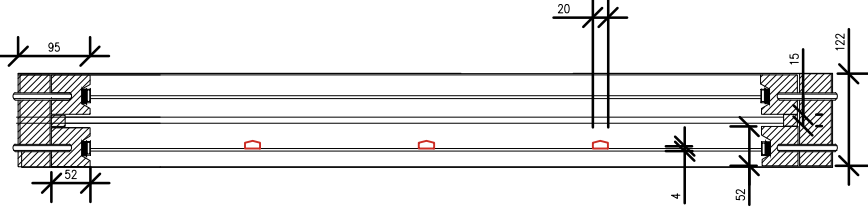

Detail A

EXISTING TYPICAL SLIDING SASH WINDOW DETAIL
(Refers to W05, W06, W07, W10, W11, W12, W14, W16 & W17 –
sizes vary similar style)
Scale @ 1:10

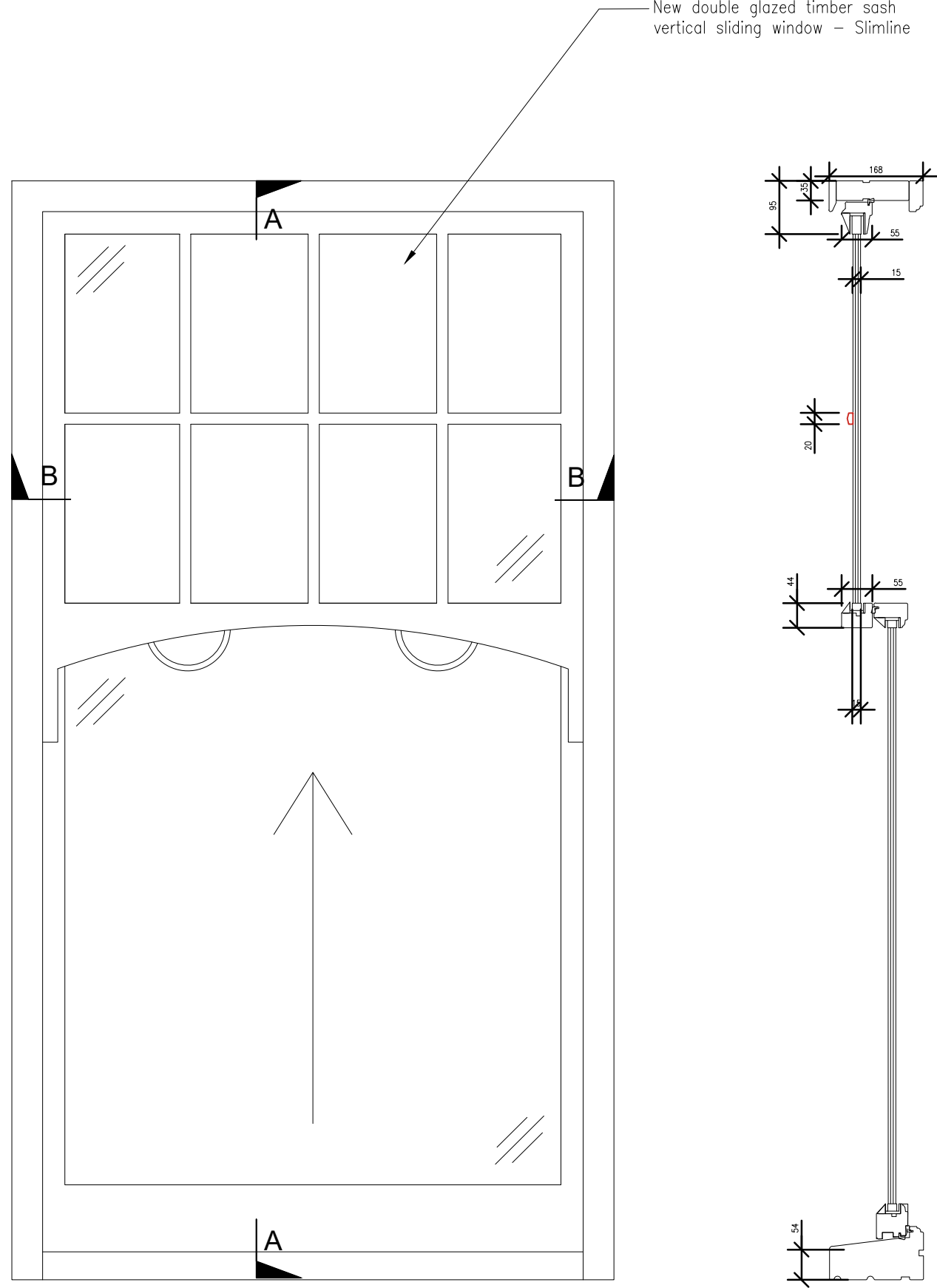

Elevation Detail B

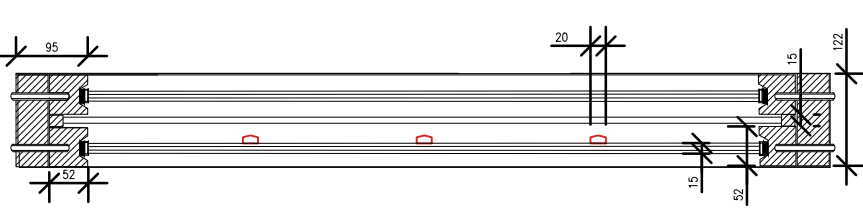

Detail A

PROPOSED TYPICAL SLIDING SASH WINDOW DETAIL
(Refers to W05, W06, W07, W10, W11, W12, W14, W16 & W17
sizes vary similar style)

