



Planning Department, London Borough of Camden
2nd Floor, 5 Pancras Square, c/o Town Hall, Judd Street
London WC1H 9JE

30 January 2022

Attn: David Fowler: David.Fowler@camden.gov.uk; Laura.Dorbeck@camden.gov.uk

**Cc planning@camden.gov.uk ; patricia.callaghan@camden.gov.uk;
Richard.Cotton@camden.gov.uk;**

RE: Planning application 2022/0142/P Hawley Wharf: OBJECTION unless conditions applied

This application seeks to change the operating hours of the two rooftop restaurants on Hawley Wharf to align with the operating model of a prospective long-term tenant. There is a parallel licence application in progress.

The limitations on the operating hours were imposed by Camden Planning to safeguard the amenities of the adjoining premises and the area generally in accordance with the requirements of policies CS5 and CS7 of the London Borough of Camden Local Development Framework Core Strategy and policy DP12, DP26 and DP28 of the London Borough of Camden Local Development Framework Development Policies.

The conditions for the restaurants and the rooftop terrace are as follows:

- Condition 11: Restaurants on roof top of Area A: 08:00 - 00:00 Monday to Sunday and on Public/Bank Holidays [this includes no customers on the premises outside this time].

*The new application is seeking to extend the restaurant operating hours as follows:
08:00 – 00:00 Sunday-Thursday and 08:00 – 00:30 Fridays and Saturdays*

- Condition 13: The outdoor terrace area surrounding the rooftop restaurant uses shall be closed to restaurant customers between 21:00 and 08:00 hours, 7 days a week, and bank and public holidays.

The new application is seeking to extend the outdoor terrace area surrounding the rooftop restaurant operating hours by 1 hour so they are closed to customers between 22:00 – 08:00 7 days a week.

We would like any approval of this application to be made with reference to the in force licenced areas for the restaurants to ensure that the areas being granted extended hours of use are explicitly limited to the licenced area. Any misunderstanding of the hours of use of the terrace would be extremely detrimental to nearby residents.

TRA TRACT ACT



Above shows extent of licenced area (red line) where extended hours of use are to be limited to for restaurant A1

TRACT ACT

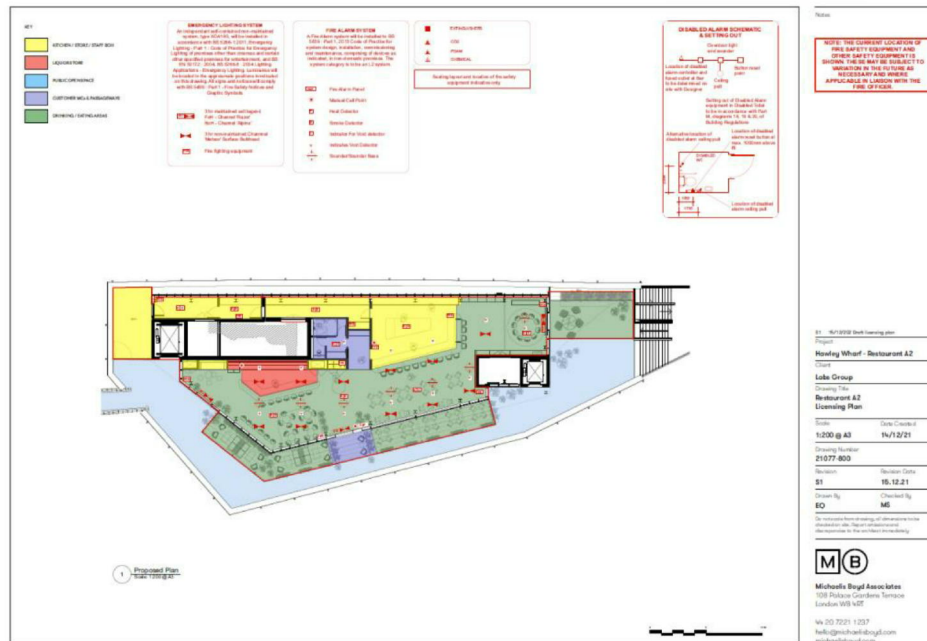

Above shows extent of licenced area (red line) where extended hours of use are to be limited to for restaurant A2.

We will support this application only if the above plans are included to explicitly identify the terrace areas surrounding the restaurants. No seating to be allowed outside of these areas.

Yours sincerely,

[Redacted Signature]

Kate Gemmell
TRACT Chair