

1. DETAIL IN PLAN - JUNCTION WITH WALKWAY
SCALE - 1:5

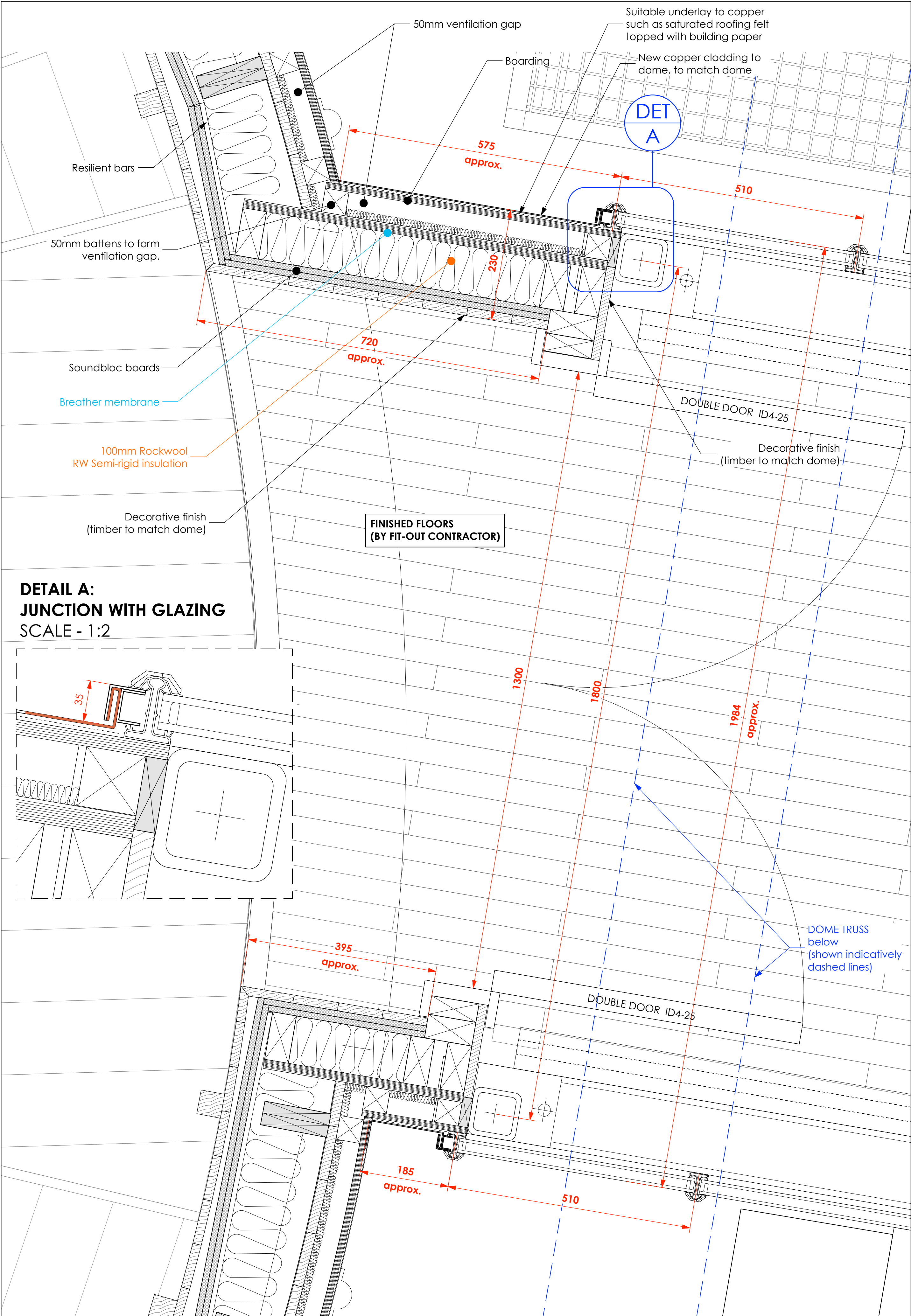

2. DETAIL IN SECTION - JUNCTION WITH WALKWAY
SCALE - 1:5

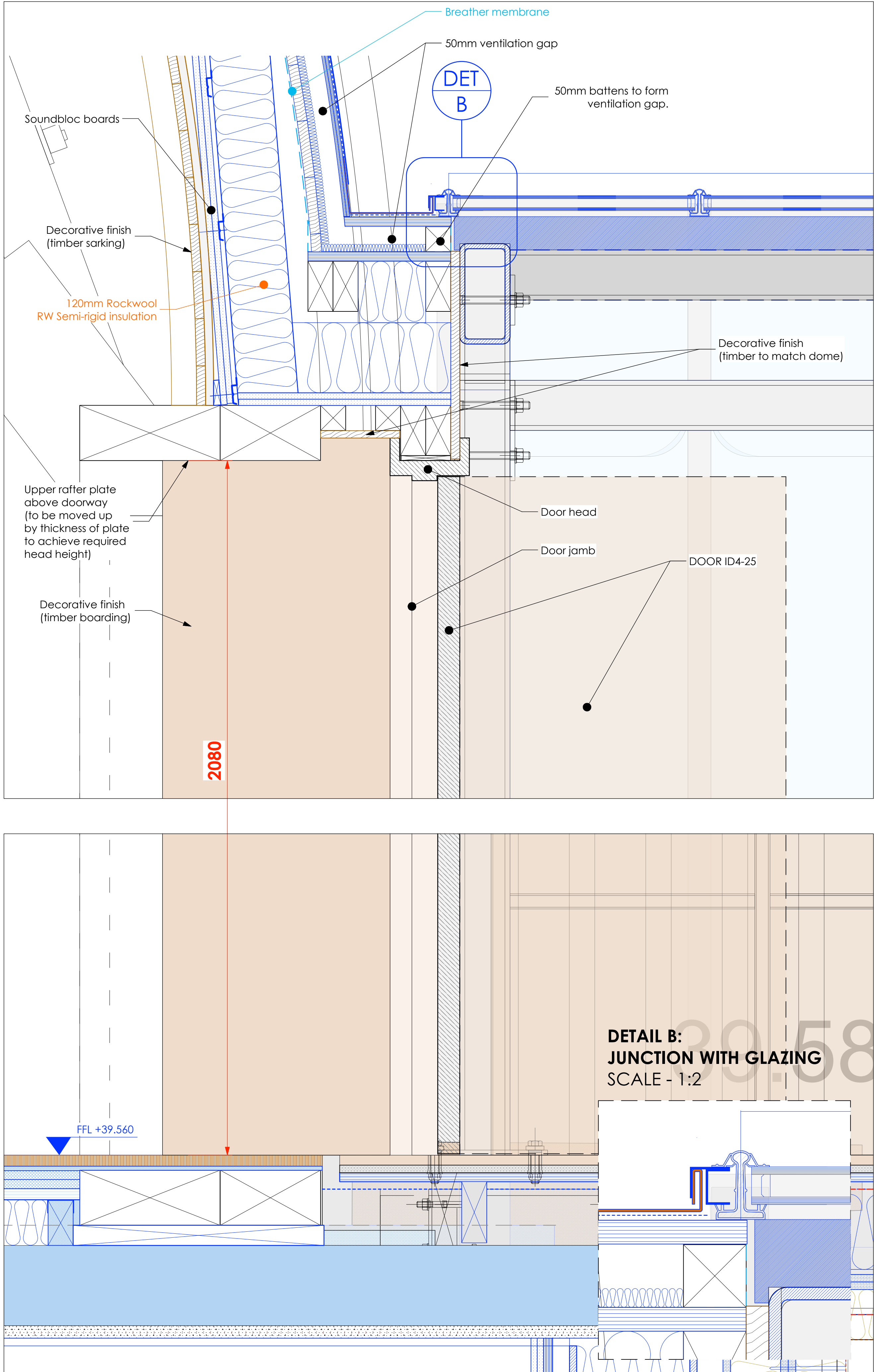

Copyright: All rights reserved. This drawing must not be reproduced without permission.
Only the original drawing should be relied upon. Contractors, subcontractors and suppliers must verify all dimensions on site before commencing any work or making any shop drawings.
All shop drawings to be submitted to the architect for comment prior to fabrication.
This drawing is to be read in conjunction with the Architect's specification, bills of quantities / schedules, structural, mechanical & electrical drawings and all discrepancies are to be reported to the architect.
Do not scale from this drawing. Dimensions are in millimetres unless otherwise stated.

revision	date	amendments
-	18/01/21	Construction issue

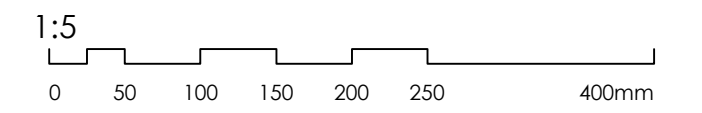

CONSTRUCTION
Archer Humphries Architects
Basement
Central House
142 Central Street
London, United Kingdom
EC1V 8AR
T: +44 (0) 20 7251 8555

project title	KOKO + Hope & Anchor + Bayham Place Camden, London
drawing title	Dome copper cladding details (sheet 3)
drawing number	AHA/KKR/DET/053
scale	1:5
date	08.01.21
drawn	PD
checked	DA
revision	-