

1. New wall
2. Lower ground floor level lowered by 380 mm
3. Lower ground floor level lowered by 750 mm
4. New openings between vaults
5. Doors to vaults fixed shut
6. Door to be replaced
7. New door
8. New steps
9. Steps removed
10. New cupboard

PLANNING

GENERAL NOTES

COPYRIGHT BELSIZE ARCHITECTS.

NO IMPLIED LICENSE EXISTS. THIS DRAWING SHOULD NOT BE USED TO CALCULATE AREAS FOR THE PURPOSES OF VALUATION. ALL DIMENSIONS TO BE CHECKED ON SITE BY THE CONTRACTOR AND SUCH DIMENSIONS TO BE THEIR RESPONSIBILITY. DO NOT SCALE DRAWINGS

THIS DRAWING IS TO BE READ IN CONJUNCTION WITH ALL OTHER CONTRACT DOCUMENTS AND SPECIFICATIONS AND ALL OTHER CONSULTANTS DRAWINGS. ALL LEVELS AND DIMENSIONS SHOULD BE CHECKED ON SITE

ALL WORK MUST COMPLY WITH RELEVANT BRITISH STANDARDS AND BUILDING REGULATIONS REQUIREMENTS DRAWING ERRORS AND OMISSIONS TO BE REPORTED TO THE ARCHITECT

REVISIONS

- 12.11.2021_REV A
 - Light well omitted.
 07.01.2022_REV B
 - Library door changed into single door.

NOTES

205 ALBANY STREET
 LONDON, NW1 4AB

PROPOSED LOWER GROUND FLOOR PLAN

DWG No: 205AS/P101B

SCALE: 1:50 @A3

DATE: JUNE 2020

BELSIZE ARCHITECTS

48 PARKHILL ROAD, LONDON, NW3 2YP
 T: 020 7482 4420
 E: MAIL@BELSIZEARCHITECTS.COM

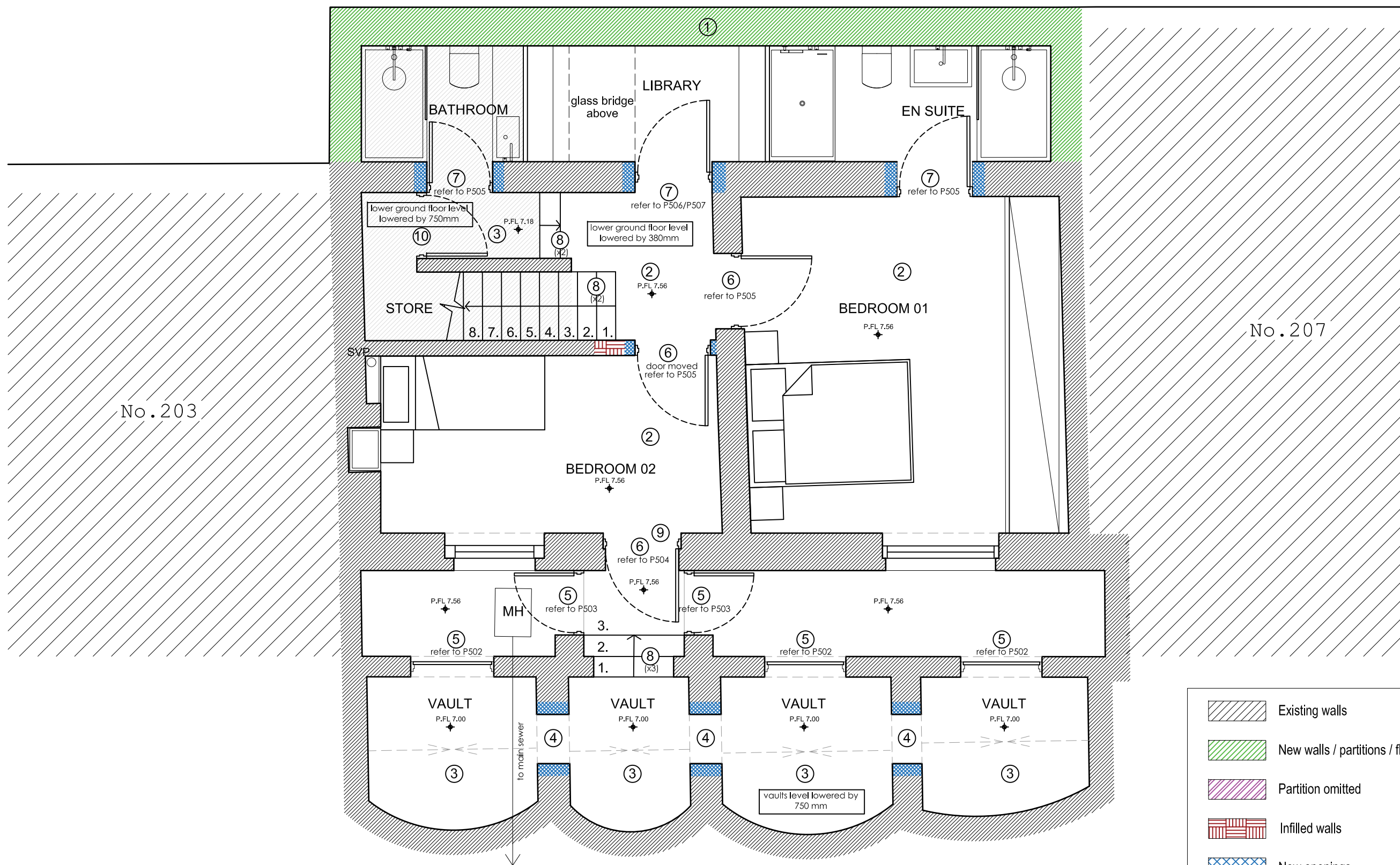

- Existing walls
- New walls / partitions / floors
- Partition omitted
- Infilled walls
- New openings

1 Proposed Lower Ground Floor Plan
 1:50 @ A3

