

Proposed Exterior Seating Plan

Important Note:
This drawing is copyright of Studio Fox Ltd and no portion should be used without consent. All dimensions and levels on this drawing are to be checked on site by the contractor and any discrepancies reported to Studio Fox Ltd, prior to commencement of any work. If in doubt ask!

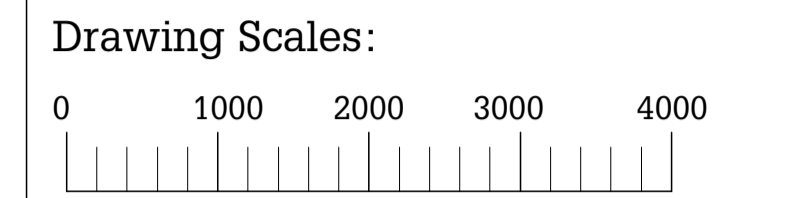

Drawing Status:
APPROVAL

Revision:	Date:	By:	Description:
A	01.10.15	GFF	Exterior seating layout and quantities revised
B	14.10.15	GFF	Exterior furniture notes and finishes added

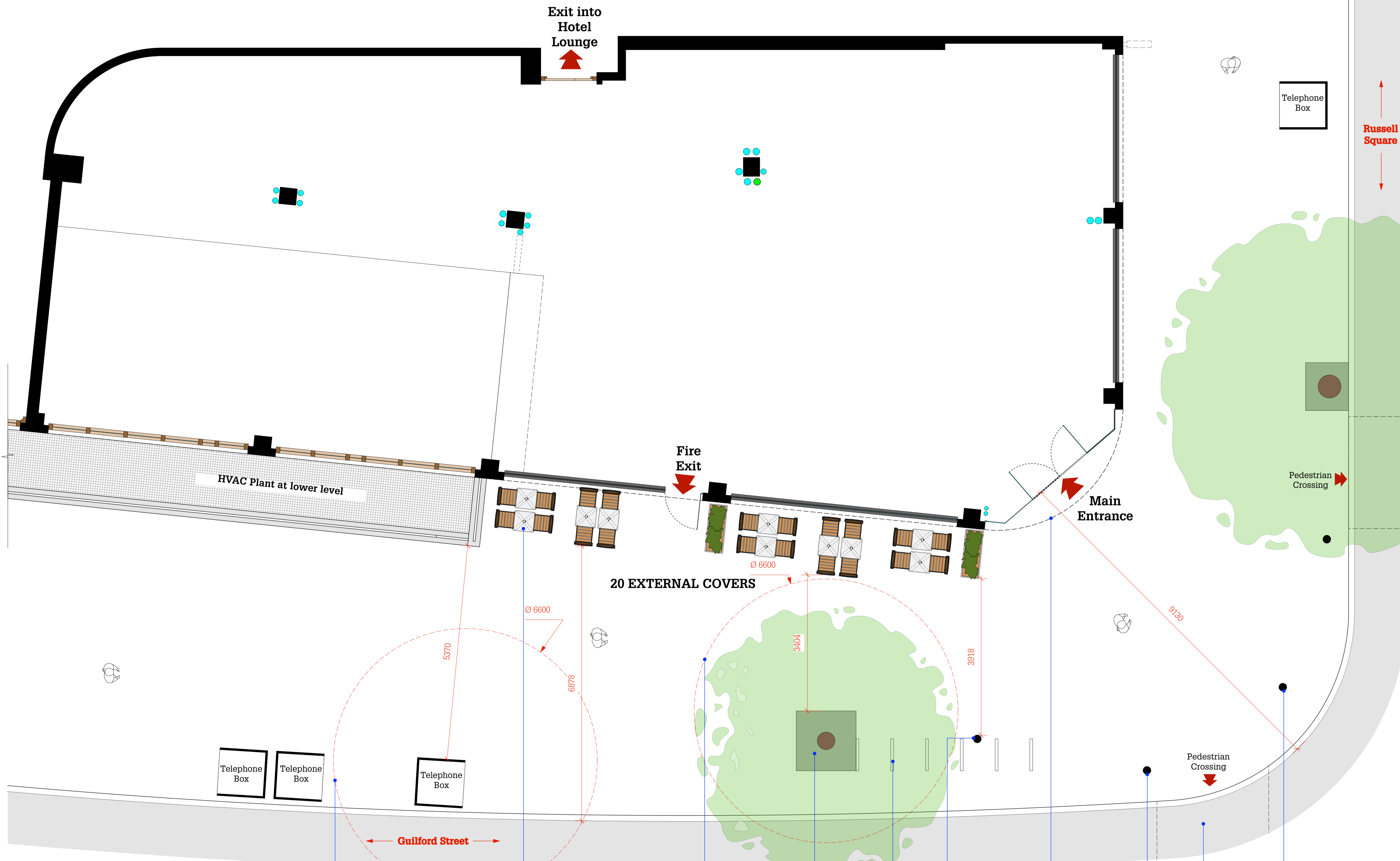

20 EXTERNAL COVERS

Red dashed line indicated 3.3M clear pedestrian zone between Pret A Mange furniture and street furniture

Refer to furniture legend for further information

Red dashed line indicated 3.3M clear pedestrian zone between Pret A Mange furniture and street furniture

Furniture Legend

Exterior Chair, Colour Black frame and teak slats. O/A Dims 460mm wide x 525mm deep
20no in Total

Exterior planter. 450mm x 1200mm x 900mm high
2no in Total

Exterior Teak Table Small (500mm x 500mm)
10no in Total

Total Exterior Covers = 20

Exterior Seating Plan

Scale 1:50 @ A1

Client:
Pret a Manger

Project:
73/74 Russell Square London WC1B 5BG

Title:
Exterior Seating Plan

Drawn By: GMC	Scale: 1:50 (A1)	Drawn Date: 17.09.15	Revised Date: 07.11.15
-------------------------	----------------------------	--------------------------------	----------------------------------

Drawing No: 15-PRET-RS14	Revision: C
------------------------------------	-----------------------

Studio Fox Ltd
57 Broad Street, Lyme Regis
Dorset, DT7 3QF
T: 01297 445 322
E: gary@studiofox.co.uk