

Key - Drainage Arrangements
G1 Gully (Ductile Iron)
380x310mm D400 Heavy Duty Pedestrianised Gully Grating KD50DP (Ductile Iron).
380x310mm D400 Heavy Duty Pedestrianised Gully Grating (overall frame dimension 560x410mm) or similar.
Possible Supplier
Peter Savage Ltd
<http://www.peter-savage.co.uk/iron-products/d400-hinged.html>

G2 Yard Gully (Ductile Iron)
225x225mm C250 Yard Gully with Pedestrianised Grating KD70 (Ductile Iron).
<https://www.ejco.com/petersavage/iron-products/c250-gully-gratings.html>

Slot 1 Slot Drain Galvanised steel slot drain with 10mm throat width and nominal 150mm throat depth. V-shaped channel provides internal flow (no requirement to lay to falls)
<https://www.gatic.com/products/paveslot>

Slot 2 Threshold Drain Galvanised steel facade drain with 10mm throat width and nominal 150mm throat depth. V-shaped channel provides internal flow (no requirement to lay to falls)
<https://www.gatic.com/products/facade-slot>

Slot 3 Threshold Drain Galvanised steel angle inset within areas of permeable paving. 75mmx75mmx3mm EA to form 10mm open slot to allow surface water to discharge into permeable paving base below

D1 Drainage Channel
Precast Concrete Drainage Channel with Ductile Iron Cover (nominal 150mm wide cover)
<https://www.aco.co.uk/products/multitrain-md>

Key - External Lighting
BL Bollard Light
Bollard light. Colour: RAL 7012
<https://www.bega.com/en/products/led-garden-and-pathway-luminaires-for-the-private-sector-772-64/>

WL Wall Light (Recessed within Brickwork)
Wall light recessed within brickwork of Garden Walls. 650mm long linear light fitting.
<https://www.orlight.com/en/cat/exterior-lighting/UNGO.html>

UL Uplighters
In-ground spike light fitting to be mounted within planting beds to uplight large shrubs / small trees
<https://www.orlight.com/en/cat/exterior-lighting/ORLUM66.html>

Marker Light
Stainless Steel in-ground luminaire (directional light fitting)
<https://www.orlight.com/en/cat/exterior-lighting/ORLM88-1.html>

Key - Boundary Treatments Level 00
LEVEL 00 BRICK GARDEN WALLS WITH INTEGRAL RAILINGS (R1, R2, R3, R4 & F1)
Brickwork to match adjacent architectural brickwork. 'Kingston Weathered Gault' and 30mm thick brick coping as required to match building. Stretcher Bond with Brick on Edge Coping.

W1 Brick Garden Walls with Integral Railings to Level 00 Private Garden Boundaries (Nominal 0.5m high)
215mm brick wall with brick on edge coping and integral railings (R1 and F1)

W2 Brick Garden Walls with no railings to Level 00 External Landscape (height varies)
Brick Raised Planters & Low Brick Retaining Structures

W3 Reinforced Concrete Retaining Structures with Brickwork Face & Integral Railings to Level 00 External Landscape (height varies)
215mm brick wall with brick on edge coping

W4 Gough Street Entrance Brick Boundary Wall (Nominal 2.3m high)
215mm brick wall with brick on edge coping. Boundary wall to recreate former demolished structure and to incorporate gateway for access to Core D1. Gateway to include ornate precast concrete lintel to reflect original structure prior to demolition

W5 Phoenix Place Entrance Brick Boundary Wall (Nominal 2.0m high)
215mm brick wall with brick on edge coping. Boundary wall to include gated access to Basement Vehicle Ramp and Refuse Storage Area

R1 Railings (0.65m high to Level 00 Private Garden Boundaries)
0.65m high railings to provide secure boundary between private gardens and adjacent communal areas.

R2 Railings (1.1m high edge protection to Level 00 Public Realm Changes in Level)
Nominal 0.9m high railings to provide 1.1m high edge protection at changes in levels within external public realm. Height varies. Refer to specific section details for confirmation.

R3 Railings (1.8m high secure boundary with Calthorpe House)
1.7m, 1.3m & 0.9m high railings to provide secure boundary between Level 00 external landscape and Calthorpe House

R4 Railings (Steps)
Nominal 0.9m high railings to provide edge protection adjacent to steps. Height varies. Profile of railings to correspond with angle of steps and associated brick wall.

F1 Fence (1.8m high boundary between Block B Lower Ground Floor Gardens)
Timber Fence Panel (F1) to provide privacy between adjacent private gardens. Fence to be integral with 215mm brick wall with brick on edge coping. Weston Red Cedar horizontal timber panels mounted upon powder coated steel posts.

Gate R1 (Level 00 Private Gardens)
985mm wide gate to provide secure boundary to private courtyard gardens. Gates to match adjacent railings.

Gate R3 (Secure Boundary with Calthorpe House)
1.4m wide gate to provide secure boundary with Calthorpe House. Gates to match adjacent railings. Gates to include automatic key fob entry system

Gate W4 to Gough St Entrance
1495mm wide single leaf gate to provide secure pedestrian entrance to Core D1. Nominal 2.1m high. Gate to correspond with precast concrete lintel arrangement. Gates to include automatic key fob entry system.

Gate W5 (985mm) to Phoenix Place Entrance
985mm wide gate to provide secure pedestrian entrance to Basement Vehicle Ramp. Nominal 2.0m high. Gates to match adjacent railings. Gate to include automatic key fob entry system.

Gate W5(m)
3010mm wide double leaf gate to provide secure vehicle entrance to Basement Vehicle Ramp. Nominal 2.0m high. Gates to match adjacent railings. Gates to include automatic key fob entry system.

Key - Boundary Treatments Level 01
LEVEL 01 BRICK GARDEN WALLS WITH INTEGRAL RAILINGS (R11, R12, R13 & R14)
Brickwork to match adjacent architectural brickwork. 'Kingston Weathered Gault'. Stretcher Bond with Brick on Edge Coping. Level 01 Podium brick walls to be founded upon drainage board above insulation layer.

Brick walls to be established above Podium Level 'intensive green roof' drainage system. Brick wall base to ensure an uninterrupted flow of surface water towards drainage outlet locations is maintained (brick walls must not form a barrier to surface water flows).

W11 Brick Garden Walls with Integral Railings to Level 01 Private Garden Boundaries (Nominal 0.5m high)
215mm brick wall with brick on edge coping and integral railings (R11)

W12 Brick Raised Planters with no railings to Level 01 Courtyard (height varies)
Brick Raised Planters & Low Brick Retaining Structures

W13 Reinforced Concrete Retaining Structures with Brickwork Face incorporating Ventilation Structures (height varies)
215mm brick wall with brick on edge coping (no railings)

W14 Reinforced Concrete Retaining Structures with Brickwork Face and no railings to Level 01 Courtyard Access (height varies)
215mm brick wall with brick on edge coping (no railings)

W15 Reinforced Concrete Retaining Structures with Brickwork Face and Integral Railings to Level 01 Gough St Boundary (height varies)
215mm brick wall with brick on edge coping (no railings)

R11 Railings (0.5m high to Level 01 Private Garden Boundaries)
0.5m high railings to provide secure boundary between private gardens and adjacent communal courtyard.

R12 Railings (0.9m high to Level 01 Public Realm Changes in Level)
0.9m high railings to provide edge protection between changes in levels within external public realm.

R13 Railings (1.4m high to Gough Street Boundary)
1.4m & 1.1m high railings to provide secure boundary between Level 01 Communal Courtyard and Gough Street.

R14 Railings (Steps)
0.5m high railing to provide edge protection adjacent to steps

Gate R11 (Level 01 Private Garden Gates)
784mm wide gate to provide secure boundary to Level 01 Private Courtyard Gardens. Gates to match adjacent railings.

Gate R13 (Level 01 Communal Courtyard Access Gates)
1885mm wide gate to provide secure access into Level 01 Communal Courtyard. Gates to match adjacent railings. Accessible to residents only. Gough Street gates to include automatic key fob entry system.

Key Fixtures & Furniture
Cycle Stands
Stainless Steel 'Ollerton' in 'Stainless Steel' finish as supplied by Marshalls
<https://www.marshalls.co.uk/commercial/products/sheffield-cyclic-stand-steel-stainless-steel>

Hardwood Timber Seats mounted upon Brick Garden Wall below.
440mm x 65mm x 45mm hardwood slats screw fixed into appropriate stainless steel frame.
Hardwood slat dimensions to correspond with brick on edge coping dimensions

Handrail (H)
Handrail to be provided to all steps. Handrails to be formed from steel galvanised and powder coated to match adjacent architectural railings

Bench
Hardwood Timber Bench
<http://www.walesandwales.com/portfolio/harp>

Bin
Litter Bin to Lower Ground Floor Communal Garden
Residents' Round Litter Bin by Brovap or similar as approved by Landscape Architect
<https://www.brovap.com/resinre-litter-bin.html>

Colour: RAL 7012

Watering Point (WP)
Bib tap to allow both manual irrigation of planting areas and general cleaning operations (e.g. pressure washing of paved surfaces). Exact location of external bib taps to be coordinated with M&E Engineer and Employer to ensure that all areas of planting are accessible to 50m hose.

Possible Supplier: External Bib Taps
Detach-A-Tap Removable Tap - chrome Square
Arrow Valves Ltd
York House, Northbridge Road, Berkhamsted HP4 1TA. Tel: 01442 823 123
<http://www.arrowvalves.co.uk/media/wysiwyg/pdf/huddatsheet.pdf>

S6 (R) Square P Bollard (Removable) (Phase 1 Scheme Area)
Removable Bollard painted black.

Possible Supplier:
Townscape Polymer St Pancras (BOL/0109) removable bollard.
<https://www.townscapeproducts.co.uk/street-furniture-products/bollards/st-pancras-bollards>

NOTES
1. All dimensions in millimetres unless otherwise shown.
2. All levels in metres above Ordinance Datum (in AOD) unless otherwise shown.
3. All dimensions to be checked on site and any discrepancies reported to Landscape Architect or Employer before pricing / work starts.
4. Any ambiguities or discrepancies within this drawing and any other information given elsewhere must be reported to the Landscape Architect or the Employer for clarification before pricing or construction works commence.
5. All drawings to be read in conjunction with other drawings and specification information as appropriate.
6. Refer to relevant Engineer's and Architect's information as appropriate for confirmation of all engineering and architectural details (including base and sub-base formation layers).
7. All works to be carried out in accordance with the latest British Standards and appropriate codes of practice as a minimum.

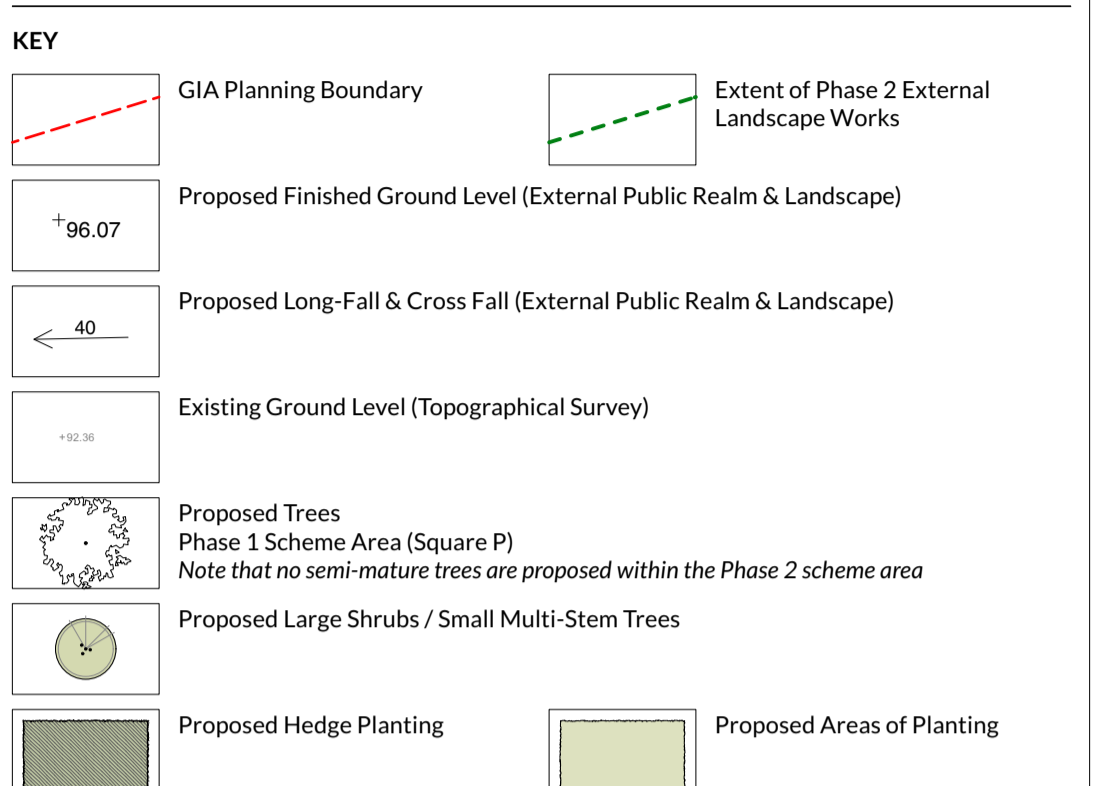

Key - Areas of Paved Surface (Level 00 External Landscape)
Bitumen Macadam to Areas of Vehicle Circulation (Basement Car Park Access) (Bit Mac)
On site bitumen macadam cross-over to link new vehicle ramp (basement car park access) with the carriageway of Phoenix Place. New bitumen macadam vehicular route between Block H Basement Car Park Access and Calthorpe Street Highway. Bitumen macadam specification to match existing highway surfaces and to be to the approval of the Local Highway Authority. For confirmation refer to Highway Engineers' details.

Precast Concrete Flag Footpath (to be reinstated where affected by the works) (PCC)
New precast concrete flag footways to match adjacent Adopted Highway Footways. Referred to as ASP (Artificial Stone Paving) within Broadway Malaysian details.
600mm x 600mm x 50mm thick Precast Concrete Slabs to Phoenix Place and Gough Street Footways (Camden Local Highway Authority)

'Natural' precast concrete flags to Local Highway Authority specification
Contractor to note that any additional areas of the Phoenix Place or Gough Street Footway will not be adopted by the Local Highway Authority. Where required the exact extent of Highway Land and adjacent development land must be marked by an appropriate Stainless Steel Stud. Exact detail to be agreed with the Local Highway Authority.

In-Situ Concrete (Conc)
In-situ concrete surface to Basement Car Park Vehicular Ramp Access and associated bin storage area. Tamped and brushed finish. Natural colour.

P01A 300mm Coursed Granite Paving for Communal Courtyard Spaces
300mm coursed x 50mm thick x random lengths (900mm long; 600mm long or 300mm long)
Random mix of granite flag colours referred to as
'Phase 2 Granite Flag Mix':
'Silver Grey' (45%); 'Mid Grey' (35%); & 'Pink/Buf' (20%) Granite Flags
Rigid construction with mortar joints and a mortar bed

P01B 300mm Coursed Granite Paving for Communal Courtyard Spaces
300mm coursed x 50mm thick x random lengths (900mm long; 600mm long or 300mm long)
Random mix of granite flag colours referred to as
'Phase 2 Granite Flag Mix':
'Silver Grey' (45%); 'Mid Grey' (35%); & 'Pink/Buf' (20%) Granite Flags
Permeable construction with 4mm permeable infiltration joint

P02A 200mm Coursed Granite Paving for Private Gardens & Building Entrance Interface
200mm coursed x 50mm thick x 600mm length in a stretcher bond
Random mix of granite flag colours referred to as
'Phase 2 Granite Flag Mix':
'Silver Grey' (45%); 'Mid Grey' (35%); & 'Pink/Buf' (20%) Granite Flags
Rigid construction with mortar joints and a mortar bed

P02B 200mm Coursed Granite Paving for Private Gardens & Building Entrance Interface
200mm coursed x 50mm thick x 600mm length in a stretcher bond
Random mix of granite flag colours referred to as
'Phase 2 Granite Flag Mix':
'Silver Grey' (45%); 'Mid Grey' (35%); & 'Pink/Buf' (20%) Granite Flags
Permeable construction with 4mm permeable infiltration joint

Key - Areas of Paved Surface (Level 01 Semi-Private Courtyard)
P03 300mm Coursed Granite Paving for Level 01 Courtyard Access
300mm coursed x 50mm thick x random lengths (900mm long; 600mm long or 300mm long)
Alternative build-up (concrete base) for interface with podium slab below
Random mix of granite flag colours referred to as
'Phase 2 Granite Flag Mix':
'Silver Grey' (45%); 'Mid Grey' (35%); & 'Pink/Buf' (20%) Granite Flags
Rigid construction with mortar joints and a mortar bed
Concrete base suitable for interface with structural slabs of podium construction below

P04 300mm Coursed Granite Paving for Level 01 Podium (permeable construction with 'DrainJoint')
300mm coursed x 50mm thick x 600mm length in a stretcher bond Random mix of granite flag colours referred to as
'Phase 2 Granite Flag Mix':
'Silver Grey' (45%); 'Mid Grey' (35%); & 'Pink/Buf' (20%) Granite Flags
Permeable construction to Level 01 Podium Communal Courtyard
4mm permeable infiltration joint (with free draining grit per joints and 'DrainJoint' horizontal joints).
Permeable aggregate bed and base

Artificial Grass Surface (GR)
Artificial Grass Lawn laid over 25mm thick shockpad (a stable and permeable sub-base)
Combination of Artificial Grass and appropriate shockpad base to provide 'fall zone' for children's play equipment. Shockpad to provide a 1.2m 'critical fall height'.

Possible Supplier:
'Nomow' Artificial Grass Surface with 50mm high 'grass' pile height and 25mm shockpad
<https://www.nomow.co.uk/shop/fire-retardant-artificial-grass/>

Rev: Date: Description: Revised by: Checked by:
P00 07.05.2021 - First Issue. Planning Condition Discharge. DWJ KMW
P01 14.01.2022 - Level 01 Podium layout updated to include lawn turf in lieu of artificial grass. - All external ground levels and structures coordinated with below ground structural RC concrete. - Location of Block D Green Wall annotated.

Tri External Landscape Design LLP
www.3Tri.co.uk

Postmark (Phoenix Place Site), Phases 2, London
Taylor Wimpey Central London

General Arrangement - Public Realm & Landscape (Planning Issue)

Status: (S4) Issued for stage approval
Drawing Number: MP2-TRI-ZZ-ZZ-PL-L-1001
Revision: P01
Scale: 1:250@A1
Date: 07.05.2021