

Repairs to Boundary Wall
At 14B Downshire Hill.

Before starting work.

1. Make sure all party wall agreement is in place.
2. Inform party wall surveyors of works to be carried out.
3. Inform all occupants of the neighbours when work is to start.
4. Make sure there are sufficient materials.

Remedial Works.

1. Install HeliBars at location 1 shown on drawing 7864922/10.
2. Make good all plaster, reinstate like for like plaster.
3. Clean the gutter and drains over the sloping roof. Replace any damaged coping stones (like for like).
4. Install HeliBars across cracks in locations 3 & 4 on drawing 7864922/10. HeliBars to be installed in accordance with manufacturers details. Make good plaster as 2 above.
5. At location 4 remove loose bricks and rebuild area with mortar to provide bond to walls.
6. In area 5 check the existing timber wall plate and rafters for rot and replace where necessary. Also check the straps and replace where necessary. Straps to be provided as shown on drawing 7864922/12. In all places make good plaster, like for like.

Repairs Along
Boundary Wall

14B Downshire Hill

7864922/10

15 Downshire

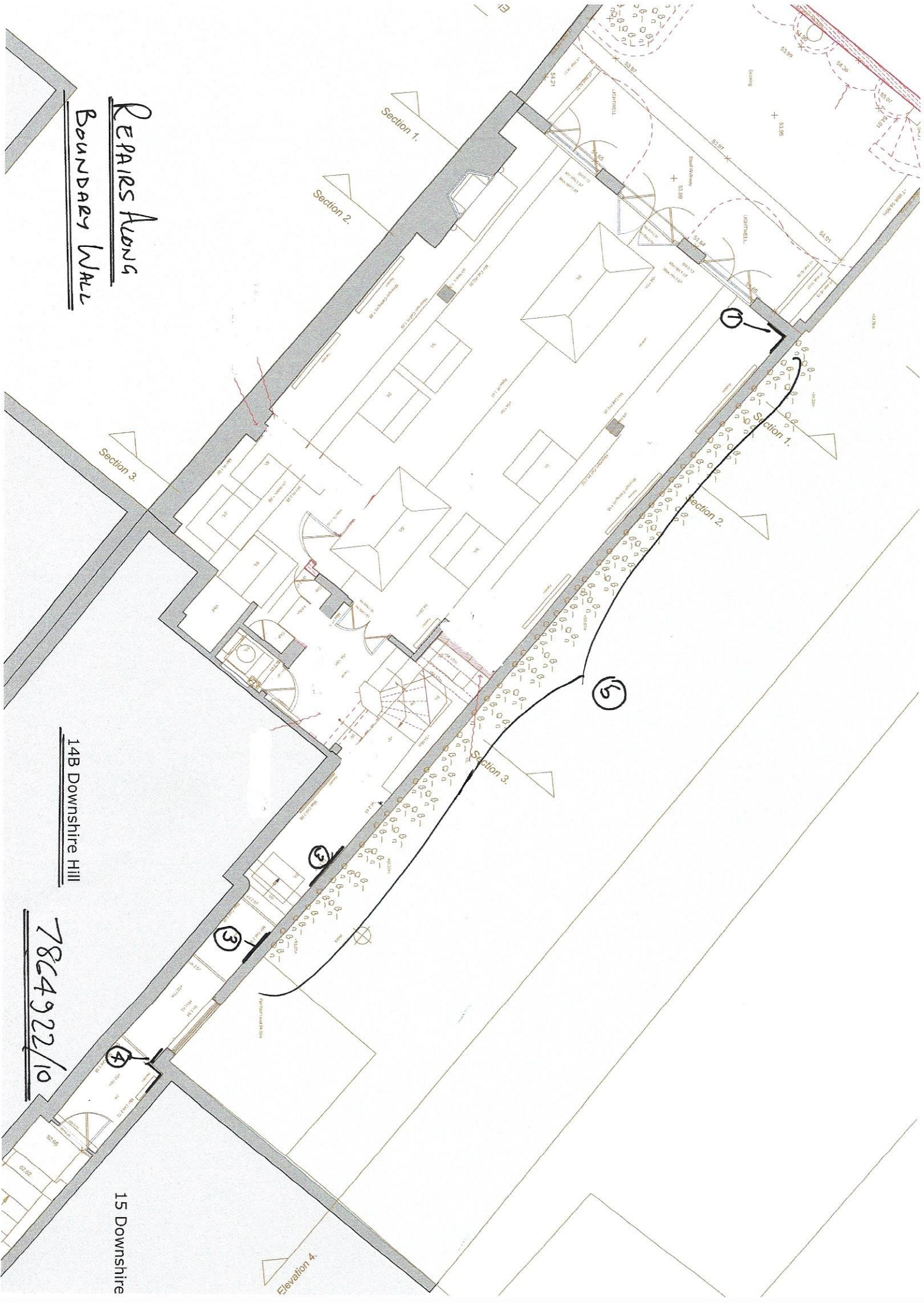

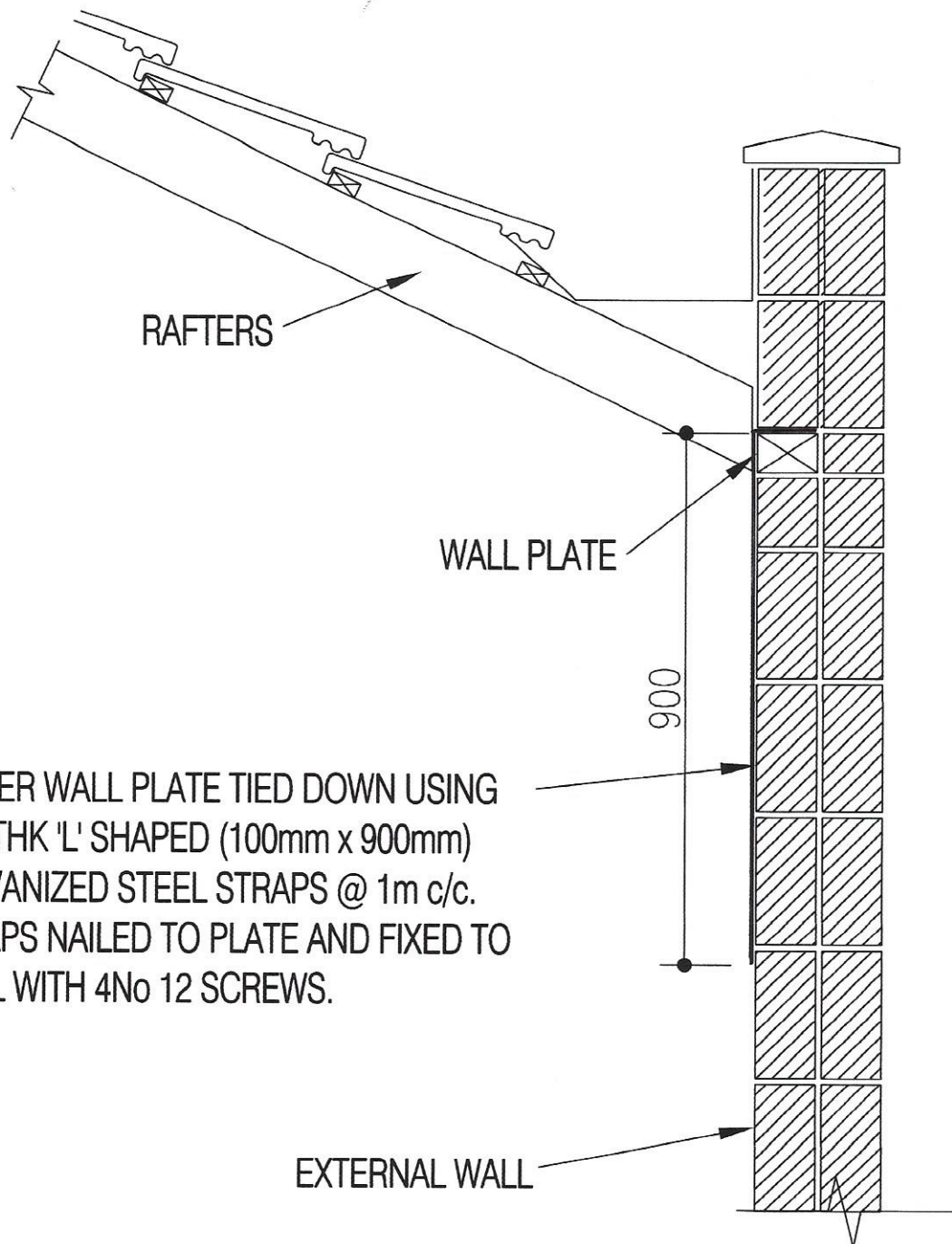

TIMBER WALL PLATE TIED DOWN USING
 30x5THK 'L' SHAPED (100mm x 900mm)
 GALVANIZED STEEL STRAPS @ 1m c/c.
 STRAPS NAILED TO PLATE AND FIXED TO
 WALL WITH 4No 12 SCREWS.

Rev	Description	Dwn	Date	Chkd
Drawing Status				
CONSTRUCTION				
RESTRAINT DETAILS				
Date	DECEMBER 2020	Drawing Number		Revision
A4 Scale		7864922 / 12		
Drawn	RJV			
Checked				

VERSI
ASSOCIATES LTD
 STRUCTURAL ENGINEERS

Job
 14B DOWNSHIRE HILL
 LONDON NW3