

LEWISFORD Group

Unit 2, Bridge Park, Merrow Lane,
Guilford, Surrey,
GU4 7BF, United Kingdom

TEL: 02089 121 712
FAX: 020839 09866
info@lewisfordgroup.com

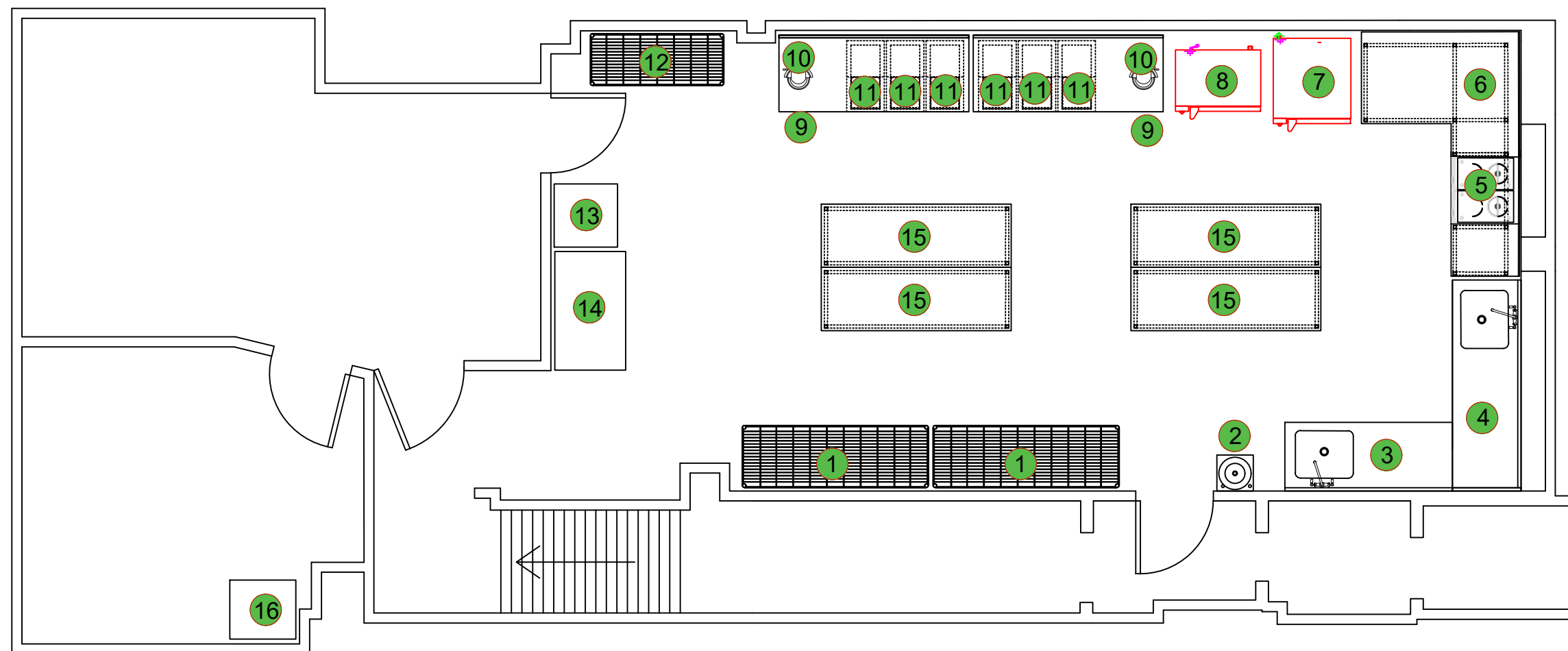

1. 1800 x 600mm 4 tier wire racking
- 2.HWB
- 3.Prep sink
- 4.Wash up sink
- 5.Induction hobs
- 6.Induction hob bench
- 7.New Blueseal Oven
- 8.Existing Blueseal oven
- 9.Ingredients bench
- 10.Existing mixers
- 11.Ingredients bin
- 12.1300 x 500mm 4 tier wire racking
- 13.Existing upright freezer
- 14.Existing large chest freezer
15. Mobile centre bench
- 16.Existing small chest freezer

PROJECT:
Kirby Street

CLIENT:
Ohlala

DRAWING TITLE:
Basement

DRAWING NUMBER: 1996 REVISION: C

SCALE:
1:50 @A3

| | | | |
|--------------|----------------|-----------------|-------------------|
| DRAWN: MB | CHECKED: DB | APPROVED: DB | DATE: 01.11.21 |
|--------------|----------------|-----------------|-------------------|

© Copyright Lewisford Group 2019
All dimensions and details are approximate and must be checked on site. No part of this drawing may be reproduced or transmitted in any form or by any means, electronic or mechanical, including photocopying, without prior permission in writing from Lewisford Group.