

Conservation Rooflight Reference Image

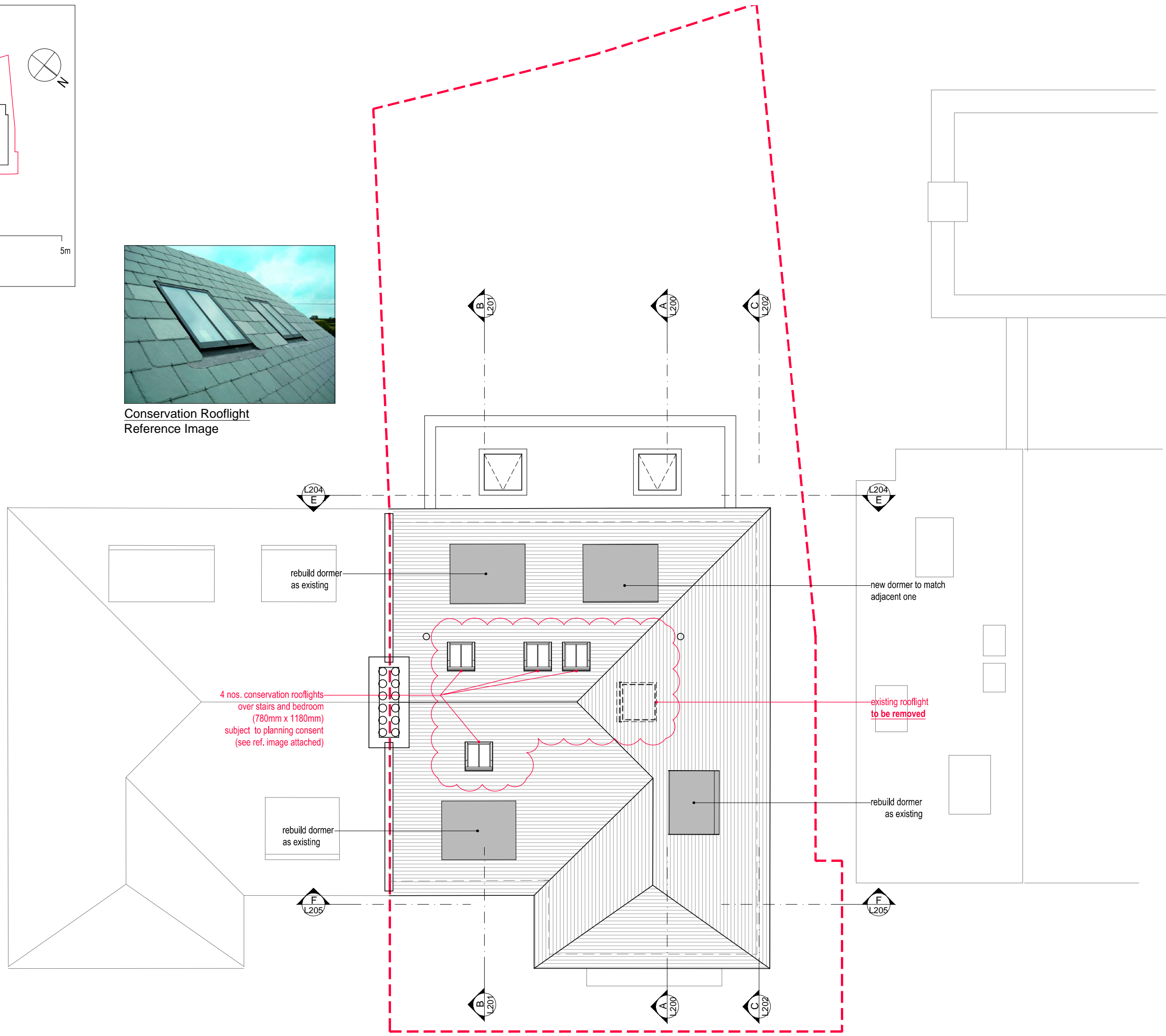

# PLANNING

|     |          |  |       |         |
|-----|----------|--|-------|---------|
| 06  | 06/08/21 | Variation of Planning Consent (Condition no.3):<br>- Front Garden Renovation<br>- Addition of no.4 Conservation Rooflights<br>- Removal of no.1 Existing Rooflight | DC    | RM      |
| 05  | 27/11/20 | Revisions by RMA   | CL    | RM      |
| Rev | Date     | Description  | Drawn | Checked |

Do not scale from this drawing  
All dimensions are to be checked on site  
Any discrepancies are to be reported immediately to the Architect or Main Contractor

**COPYRIGHT © 2020**  
ALL RIGHTS RESERVED IN THE CHAPTER IV OF THE COPYRIGHT DESIGN AND PATENTS ACT 1988. HAVE BEEN GENERALLY ASSERTED

**Richard Morton Architects Ltd**  
The Bungalow, Home Yard, Hatfield House, AL9 5NF  
Tel: 0203 179 9030  
Email: richard@rm-architects.com  
Web: www.rm-architects.com

**Client**  
**Mrs Kit Man Tam**

**Project**  
**34 Glenilla Road**  
**Belsize Park, London**

**Drawing**  
**Proposed Roof Plan**

**Scale**  
1:50@A1 / 1:100@A3

|                           |                              |                              |
|---------------------------|------------------------------|------------------------------|
| <b>Project No.</b><br>189 | <b>Drawing No.</b><br>P L103 | <b>Revision</b><br><b>06</b> |
| <b>Status</b><br>Planning | <b>Date</b><br>Sep21         | <b>Drawn by</b><br>CL        |
|                           |                              | <b>Checked by</b><br>RM      |