

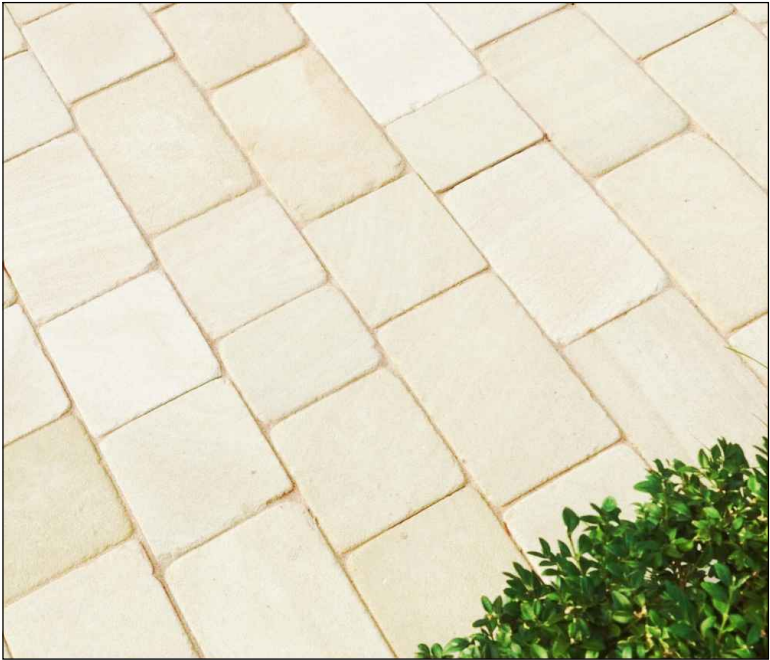

1. LORENTO marble steps:

- colour: Perlino (cream tone)
- thickness: 50mm

Lorento is a superb marble that is regarded as one of the most luxurious stones available. This sawn edge stone has been gently tumbled to create a classic look while the white mottling and delicate veining add to the rich aesthetics.



4. Permeable Stone Setts:

- cut from a mid-grained, beige to biscuit coloured sandstone
- subtle banding and granular appearance
- sawn on six sides then lightly tumbled to give a gentle finish



2. HADDONSTONE cast stone paving slabs:

- colour: off-white
- offered in four standard sizes, but can be cut to a unique specification
- the joints can be mortar pointed, in case a clean architectural appearance is required
- the slabs can be laid unpointed, edge to edge, if a softer appearance is required



5. RESIN BONDED AGGEGATES Resin Paving (parking area):

- 10mm chestnut brown rounded gravel
- provides good drainage



3. Bricks (front wall)

- colour: grey (same as current)



6. Railings:

- standard vertical bar railings
- colour: black
- material: galvanised steel

PLANNING

Key Plan

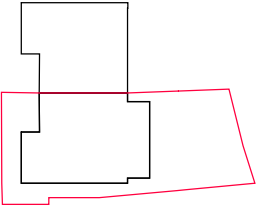

|     |          |  |       |         |
|-----|----------|--|-------|---------|
| 02  | Dec21    | Variation of Planning Consent (Comments):<br>- Brick Piers lowered (1250mm)<br>- Bin Position changed<br>- Permeable area improved                             | DC    | RM      |
| 01  | 06/08/21 | Variation of Planning Consent (Condition no.3):<br>- Front Garden Renovation<br>- Addition of no.4 Conserv. Rooflights<br>- Removal of no.1 Existing Rooflight | DC    | RM      |
| Rev | Date     | Description  | Drawn | Checked |

Do not scale from this drawing  
All dimensions are to be checked on site  
Any discrepancies are to be reported immediately to the Architect or Main Contractor

COPYRIGHT © 2021  
ALL RIGHTS DESCRIBED IN THE CHAPTER IV OF THE COPYRIGHT  
DESIGN AND PATENTS ACT 1988, HAVE BEEN GENERALLY ASSERTED

Richard Morton Architects Ltd

The Bungalow, Home Yard, Hatfield House, AL9 5NF  
Tel: 0203 179 9030

Email: richard@rm-architects.com  
Web: www.rm-architects.com



Client  
Mrs Kit Man Tam

Project  
34 Glenilla Road  
Belsize Park London

Drawing  
Proposed Front Garden  
Reference Images

|             |             |          |            |
|-------------|-------------|----------|------------|
| Scale       |             |          |            |
| Project No. | Drawing No. | Revision |            |
| 189         | 124         | 02       |            |
| Status      | Date        | Drawn by | Checked by |
| Planning    | Dec21       | DC       | RM         |