

FRONT GARDEN PLAN (existing) - 1:50

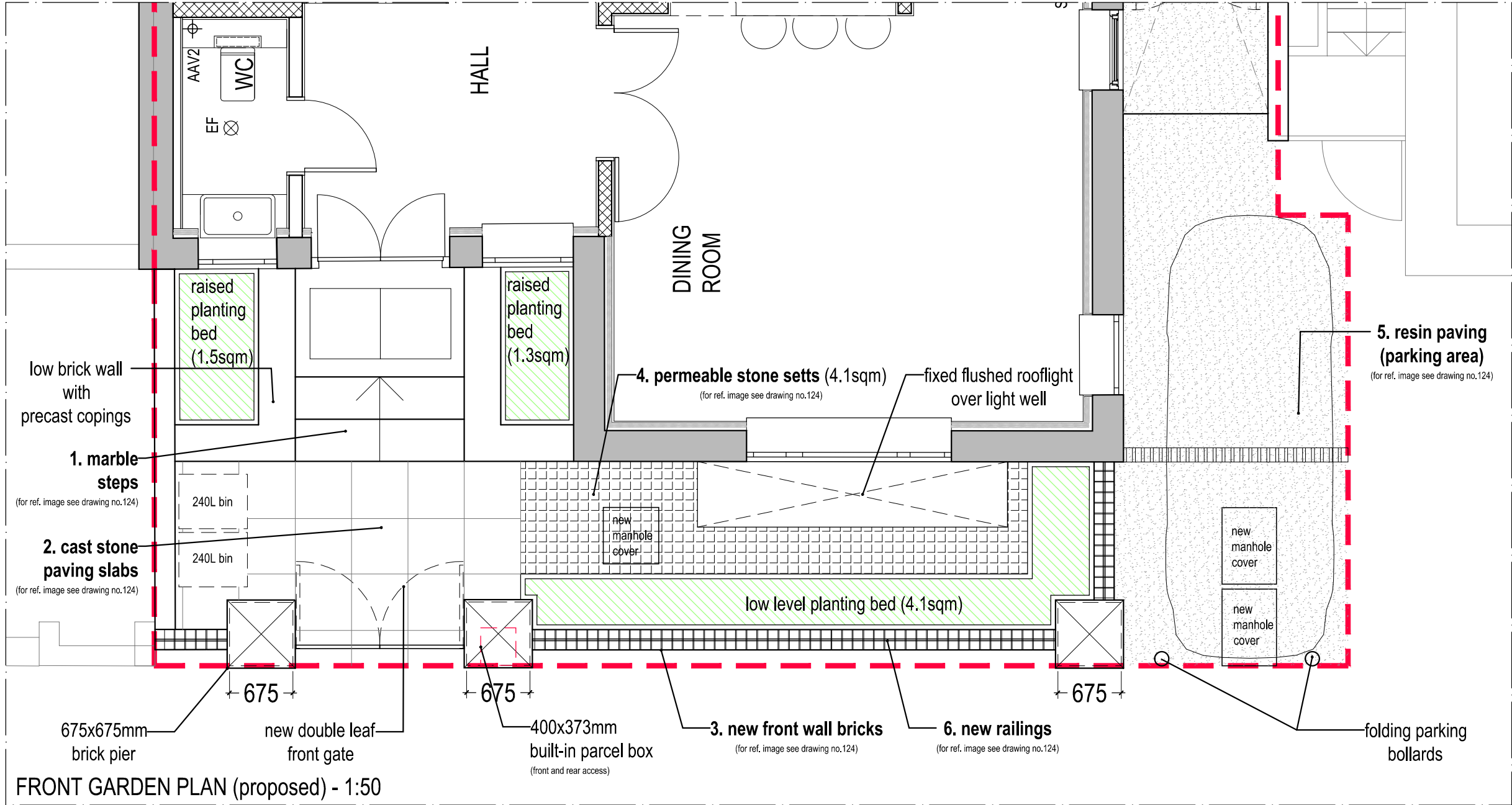

FRONT GARDEN PLAN (proposed) - 1:50

PLANNING

Key Plan

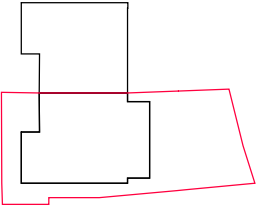

| | | | | |
|-----|----------|--|-------|---------|
| 02 | Dec21 | Variation of Planning Consent (Comments): - Brick Piers lowered (1250mm) - Bin Position changed - Permeable area improved | DC | RM |
| 01 | 06/08/21 | Variation of Planning Consent (Condition no.3): - Front Garden Renovation - Addition of no.4 Conserv. Rooflights - Removal of no.1 Existing Rooflight | DC | RM |
| Rev | Date | Description | Drawn | Checked |

Do not scale from this drawing
All dimensions are to be checked on site
Any discrepancies are to be reported immediately to the Architect or Main Contractor

COPYRIGHT © 2021
ALL RIGHTS DESCRIBED IN THE CHAPTER IV OF THE COPYRIGHT DESIGN AND PATENTS ACT 1988, HAVE BEEN GENERALLY ASSERTED

Richard Morton Architects Ltd

The Bungalow, Home Yard, Hatfield House, AL9 5NF
Tel: 0203 179 9030

Email: richard@rm-architects.com
Web: www.rm-architects.com



Client

Mrs Kit Man Tam

Project

**34 Glenilla Road
Belsize Park London**

Drawing

**Existing Front Garden Plan
Proposed Front Garden Plan**

Scale

1:50 @ A3

| | | |
|-------------|-------------|-----------|
| Project No. | Drawing No. | Revision |
| 189 | 122 | 02 |

| | | | |
|----------|-------|----------|------------|
| Status | Date | Drawn by | Checked by |
| Planning | Dec21 | DC | RM |