

NORTH ELEVATION - 1:100 (proposed)

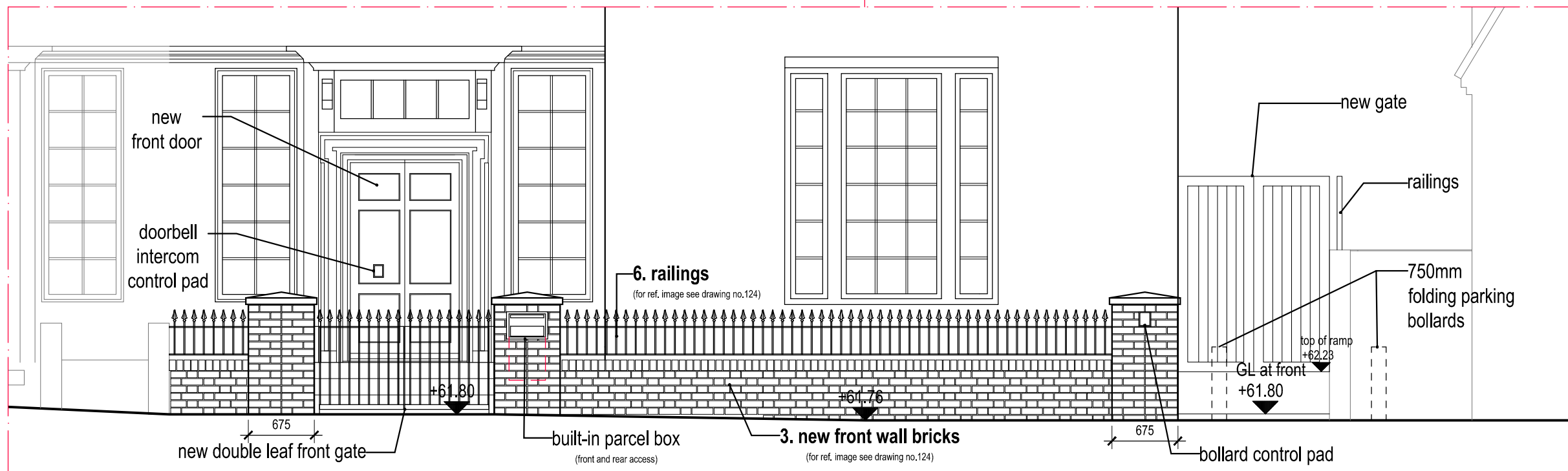

FRONT GARDEN ELEVATION (proposed) - 1:50

PLANNING

Key Plan

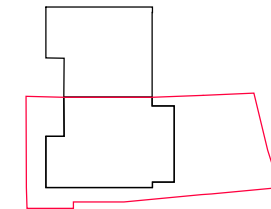

Scale bar

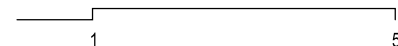

02	Dec21	Variation of Planning Consent (Comments): - Brick Piers lowered (1250mm) - Bin Position changed - Permeable area improved	DC	RM
01	06/08/21	Variation of Planning Consent (Condition no.3): - Front Garden Renovation - Addition of no.4 Conserv. Rooflights - Removal of no.1 Existing Rooflight	DC	RM
Rev	Date	Description	Drawn	Checked

Do not scale from this drawing
All dimensions are to be checked on site
Any discrepancies are to be reported immediately to the Architect
or Main Contractor

COPYRIGHT © 2021
ALL RIGHTS DESCRIBED IN THE CHAPTER IV OF THE COPYRIGHT
DESIGN AND PATENTS ACT 1988, HAVE BEEN GENERALLY ASSERTED

Richard Morton Architects Ltd

The Bungalow, Home Yard, Hatfield House, AL9 5NF
Tel: 0203 179 9030

Email: richard@rm-architects.com
Web: www.rm-architects.com



Client

Mrs Kit Man Tam

Project

**34 Glenilla Road
Belsize Park London**

Drawing

**Proposed North Elevation
Front Garden Elevation**

Scale

1:100, 1:50 @ A3

Project No.	Drawing No.	Revision
189	121	02

Status	Date	Drawn by	Checked by
Planning	Dec21	DC	RM