

GREEN WALLS - COMPTON CLOSE (west elevation of 59 Clarence Gardens)



EXISTING ARRANGEMENTS
As shown in the adjacent photograph the existing site comprised of a 14000mm wide planting bed, enclosed by 600 mm high bow top fencing. The adjacent brick wall (west facade of 59 Clarence Gardens) is a blank wall with no window or openings.

PROPOSALS
The existing planting bed is to be cultivated and planted with shade/drought tolerant plants, including evergreen climbers that will be supported by a wire trellis attached to the wall. The bow top railings will be replaced with 450 mm high timber rail to match the other green walls in the neighborhood. Introducing greenery and seasonal interest to soften the surrounding built environment.

LOCATION PLAN - Site Address Compton Close, Clarence Gardens, NW1.



Proposed Green Wall to match those in the surrounding streets, including metal trellis, timber knee rail and planting style.

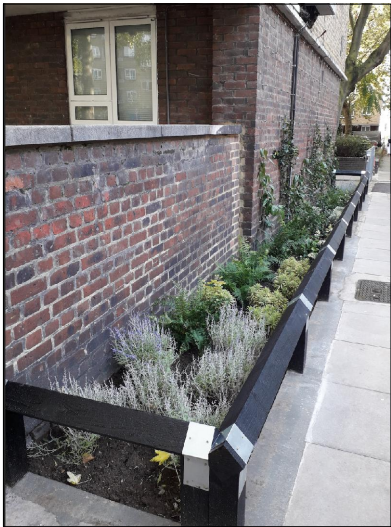

Robert Street GreenWall

PLAN OF GREEN WALL PROPOSALS

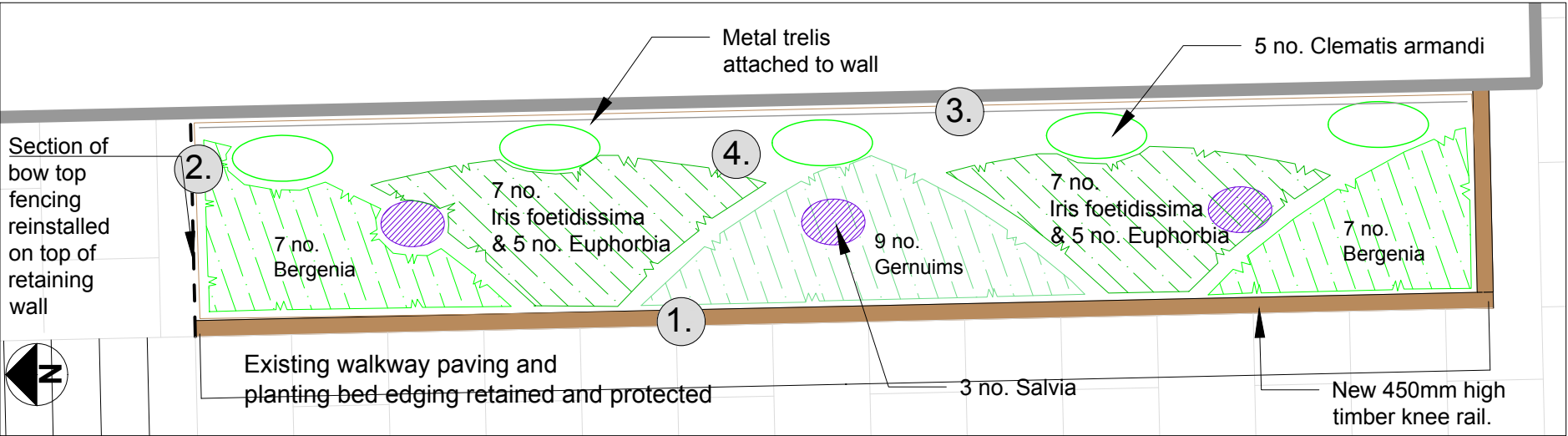

PLANTING SCHEDULE

Item	Name	Size	No.
1.	Clematis armandi	5L	5
2.	Iris foetidissima	10L	14
3.	Euphorbia robbiae	5L	10
4.	Bergenia 'silberlicht'	3L	14
5.	Geranium 'Rozanne'	3L	9
6.	Salvia 'Amlstad'		
7.	Total		52



Metal trellis for climbing plants.

KEY

1. New knee rail 100 x 100 mm pressure treated timber rails supported on bird mouth fixings 100 x 100 mm posts with galvanized metal fixing straps to secure railing posts. Height from ground level 450mm.
2. Section of existing bow top fencing retained and reinstalled along raised paving edge on the north edge of the planter.
3. New metal wire trellis attached to wall, fixing to be at 300mm centers height 1800mm x 6000mm wide.
4. New planting including evergreen climbers and shade and drought tolerant shrubs.

ELEVATION OF GREEN WALLS PROPOSALS

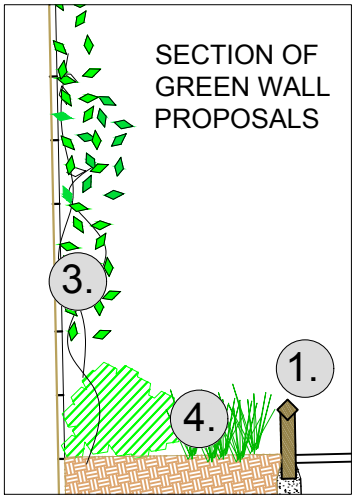
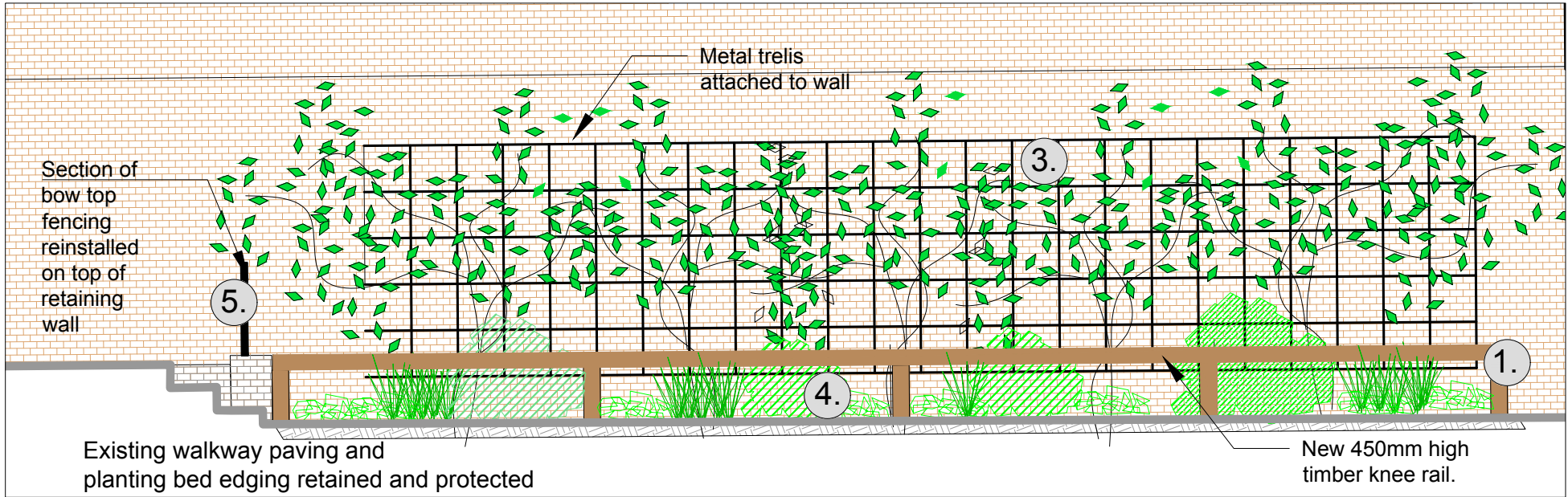

Drg Title	Green Walls - Compton Close
Client	LB of Camden
Drawn by	PB
Scale	1:25 / As shown
Date	10/11/21
Drawing no.	GW 5.

