

GREEN WALLS - Vardell Street



**EXISTING ARRANGEMENTS**  
The existing open space includes a lawn and perimeter planting bed around the housing block, which has recently been planted with low growing flowering shrubs and grasses.

**PROPOSALS**  
Metal trellis is to be installed on to the flank wall to provide support for flowering climbing plants, that will thrive in this south facing, sunny aspect.

LOCATION PLAN - Site Address Vardell Street, NW1.

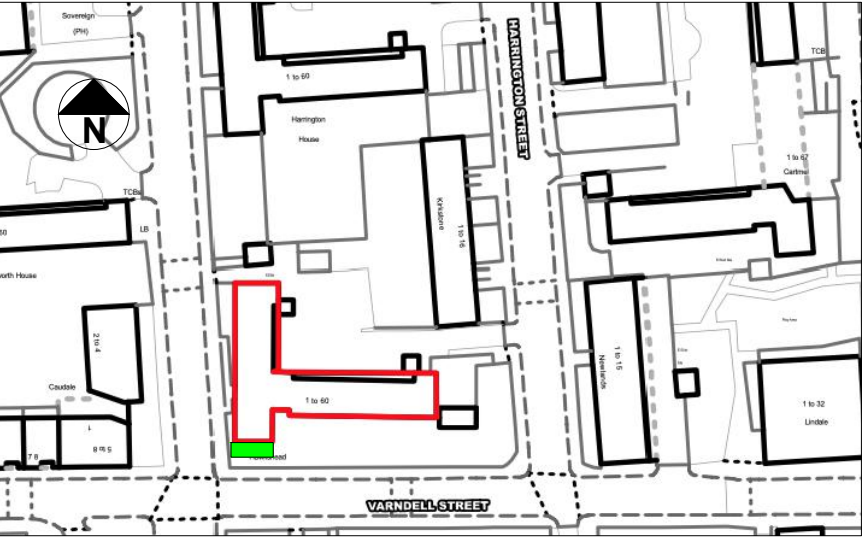

Works to include installing metal trellis on to flank wall and adding flowering climbers to the existing planting bed.



Existing planting bed

PLAN OF GREEN WALL PROPOSALS

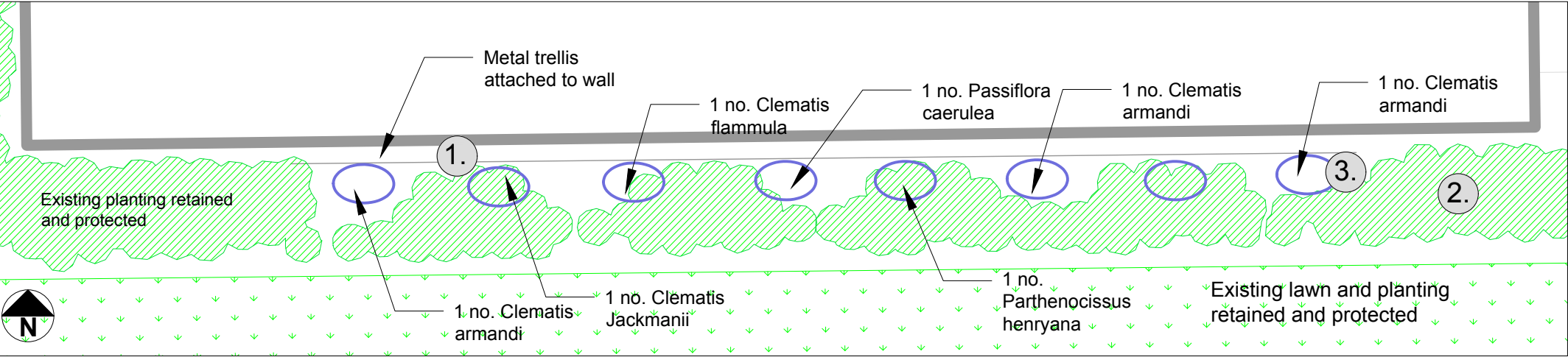

PLANTING SCHEDULE

Item	Name	No.
1.	Clematis armandi	3
1.	Clematis Jackmanii	2
2.	Clematis flammula	1
3.	Parthenocissus henryana	1
4.	Passiflora caerulea	1



Metal trellis for climbing plants.

KEY

1. New metal wire trellis attached to wall, fixing to be at 300mm centers height 1800mm x 6000mm wide.
2. Existing planting retained and protected.
3. New flowering climbing plants.

ELEVATION OF GREEN WALLS PROPOSALS

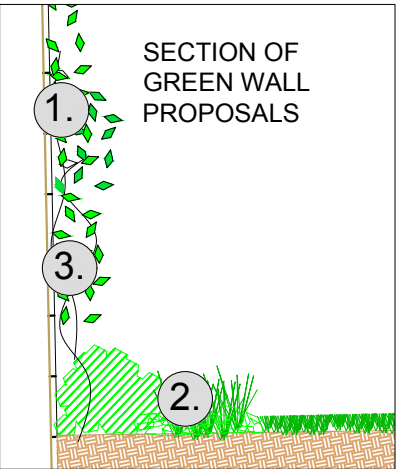
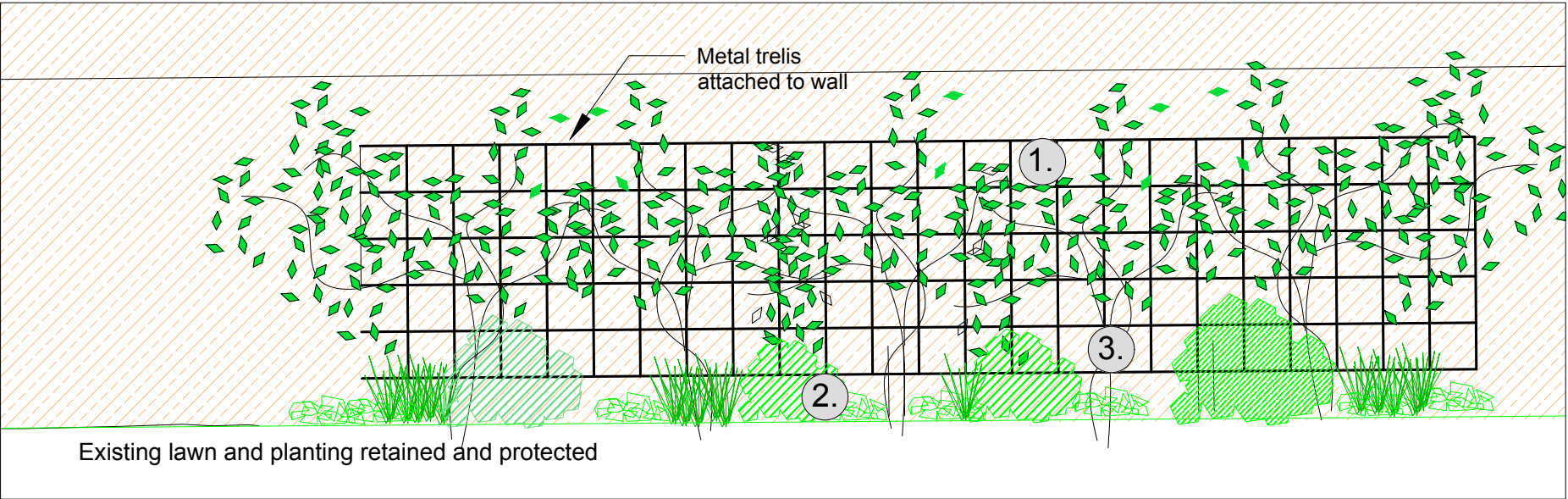

Drg Title	Green Walls - Vardell Street
Client	LB of Camden
Drawn by	PB
Scale	1:25 / As shown
Date	10/11/21
Drawing no.	GW 6.

**LUSH**  
LANDSCAPES