

1 Rear garden groundworks
Scale: 1:50

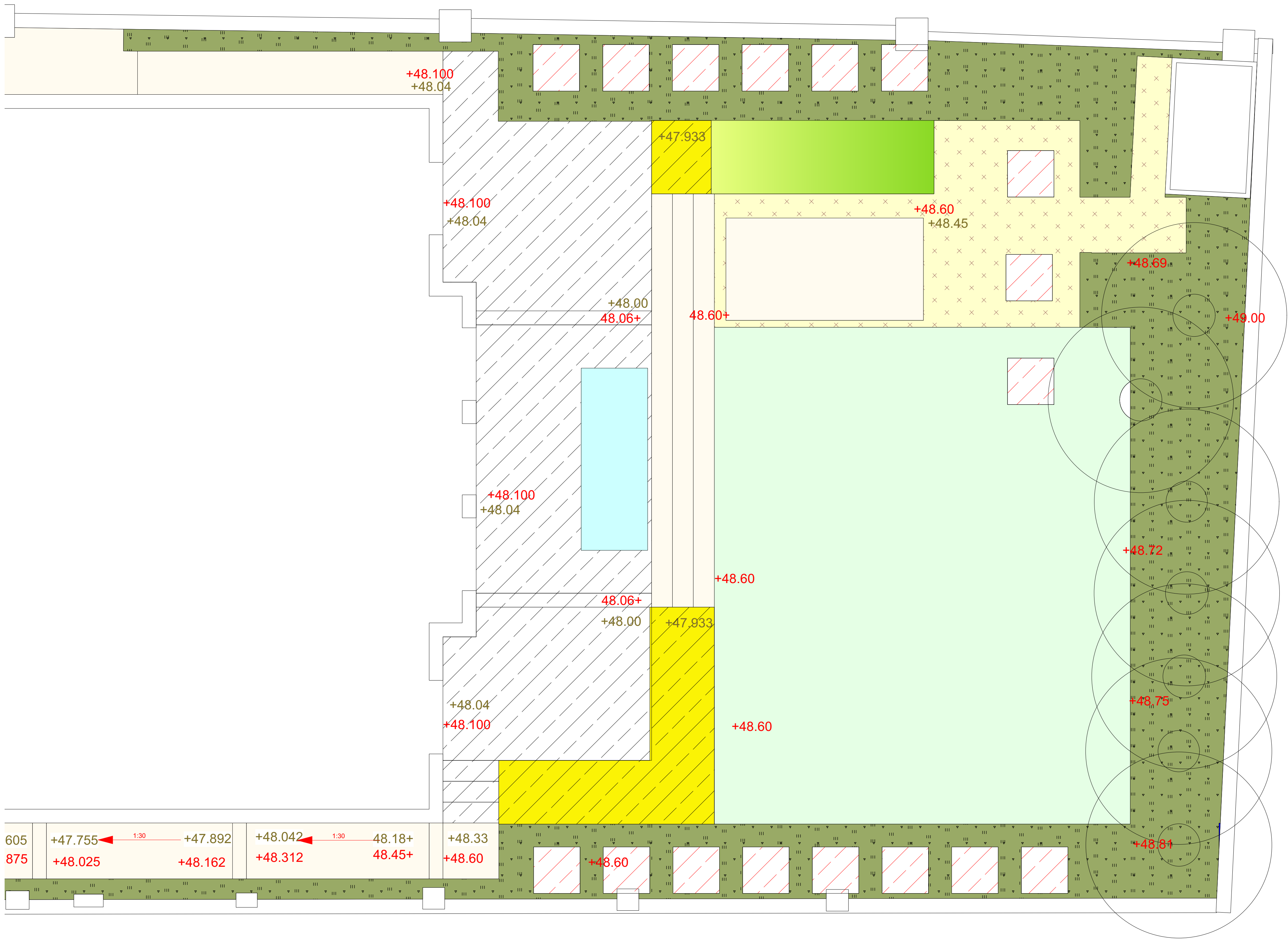

- notes
1. Read in conjunction with all relevant Architects, Engineers & design team drawings & specifications
 2. Any discrepancies must be drawn to the attention of the lead consultant in writing
 3. All dimensions are in millimeters unless otherwise noted & are subject to checking on site prior to fabrication or ordering of materials
 4. This drawing is the copyright of CLIFTON NURSERIES LTD. (and other consultants where referenced)

NOTE:

To be read in conjunction with Landscape Masterplan 13-02 and Hardworks Plan drawings to shown heights.

Any works to be carried out within the RPA to be hand dug.

All tree pits/areas should have any hard material/waste removed by Audley to a depth of approx. 800mm in a 1m square area per tree so that we are left with topsoil/subsoil to excavate for the tree pits.

All lawn areas existing soil to be retained. Audley to a excavate any hardcore / contaminated soil / debris etc. to depth of approx. 200mm. Any pan ripped through and broken out by Audleys.

All planting areas/borders to be excavated by Audley to a depth of 450mm deep and any hard construction material removed beneath this to at least 700mm deep and any pan ripped through and broken out so that we are left with topsoil/subsoil at a depth of 450mm below finished levels. If suitable existing topsoil is found below excavations this can be retained subject to inspection by Clifton Nurseries.

All Sofia limestone paving areas to be built up/excavated by Audley to approx. 270mm below finished levels

Rear terrace waterproofing and concrete screed by Audley to falls away from house leaving us a depth of approx. 60mm from screed to finished levels.

Rear terrace waterproofing and concrete screed by Audley to falls away from house leaving us a depth of approx. 60mm from screed to finished levels.

Breedon gravel areas to be built up/excavated by Audley to approx. 150mm below finished levels

Excavation / build up to formation levelby Audleys in preparation for landscaping by Clifton Nurseries.

Finished levels

Rooflight

Orig 1 OCT 21 BL PC n/a
rev date by chk notes

Clifton Nurseries Ltd., Woburn Hill, Addlestone, Surrey, KT15 2QG

project title
62 Avenue Road

drawing
Rear garden ground works

job number drawing number
2643 2643-14-02

status
TENDER

scale 1:50@A1



CLIFTON
NURSERIES

