

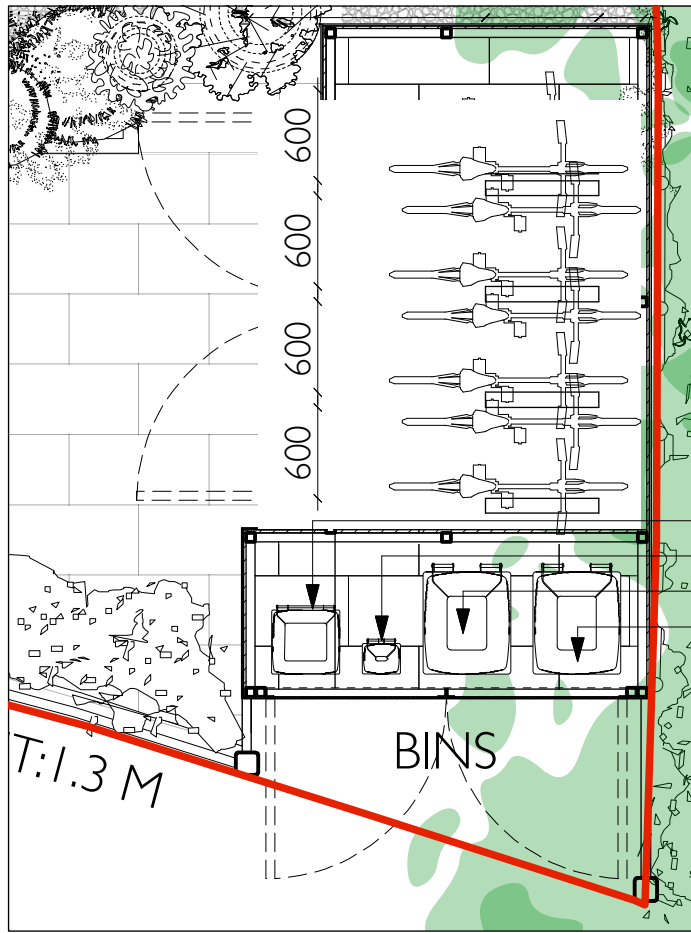

ELSWORTHY ROAD WASTE STORAGE



WADHAM GARDENS WASTE STORAGE / BICYCLE SHED

GENERAL NOTES

All dimensions are to be checked on site before commencement of works.

All sizes and dimensions to any structural elements are indicative only. See structural engineer's drawings for actual sizes/dimensions.

Sizes of and dimensions to any service elements are indicative only. See service engineer's drawings for actual sizes/dimensions.

This drawing to be read in conjunction with all relevant Architect's drawings, specifications and other consultants' information.

DO NOT SCALE FROM THIS DRAWING

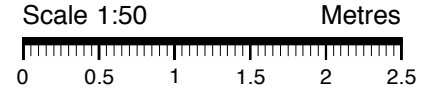

- 90L SACK - GARDEN
- 7L CADDY - KITCHEN
- 240L WHEELIE - RECYCLE - 160L MINIMUM
- 240L EUROBIN - REFUSE - 160L MINIMUM

LEGEND

— SITE BOUNDARY

WASTE RECYCLING & STORAGE PER WEEK

- APARTMENT 1 - 2 BEDROOMS - 170 LITRES
- APARTMENT 2 - 3 BEDROOMS - 240 LITRES
- APARTMENT 3 (The Cottage) - 4 BEDROOMS - 320 LITRES
- APARTMENT 4 - 1 BEDROOM - 100 LITRES
- APARTMENT 5 - 2 BEDROOMS - 170 LITRES
- APARTMENT 6 - 1 BEDROOM - 100 LITRES

TOTAL: 1100 LITRES (MINIMUM WASTE)

BICYCLE STORAGE + 1M² TOOLS (BREEAM REQUIREMENTS)

- 1 BICYCLE
- 1 BICYCLE
- 2 BICYCLES
- 0.5 BICYCLE
- 1 BICYCLE
- 0.5 BICYCLE

TOTAL OF 6 BICYCLES (1BREEAM CREDIT) + 1 BICYCLE (VISITORS); 7 BICYCLES

REV:	DATE:	DESCRIPTION:	INITIALS:
------	-------	--------------	-----------

1 WADHAM GARDENS PROPOSED DRAWINGS

PROJECT:	Wadham Gardens		
CLIENT:	Marcus Cooper Group		
DRAWING:	Proposed Waste/Cycle Storage		
SCALE:	1:50@A4	DRAWN:	MF
DATE:	May-18	CHECKED:	SW
CAD FILE:	1179-04 Proposed		
DRAWING NO:	1179-04 Proposed	REV:	-