









Key

-  Existing enclosure
-  Existing floor
-  Existing structure
-  Existing element
-  Temporary works as described
-  Demolition as described
-  Demolish in elevation
-  Strip finish / layer as described

i This drawing is based on a survey conducted by Target Survey Ltd in November 2018 for the purposes of establishing the general arrangement of the existing property. Tree information by Tree Craft Ltd. in 2018

! Existing services: incl. drainage & electrics are yet to be located

! Do not construct from this drawing

! To be read in conjunction with referenced schedule of works document and all other drawings

! Do not scale from this drawing

All linear dimensions in millimeters (mm), Areas in m², volumes in m³

! Report any discrepancies or ambiguities to the design team for comment

Measure on site before undertaking works, ordering, or manufacture

! No Asbestos or other contaminants survey has yet been undertaken. Given the age of the building Asbestos is to be suspected.

! The nature, stability, and bearing capacity of existing constructions is not known

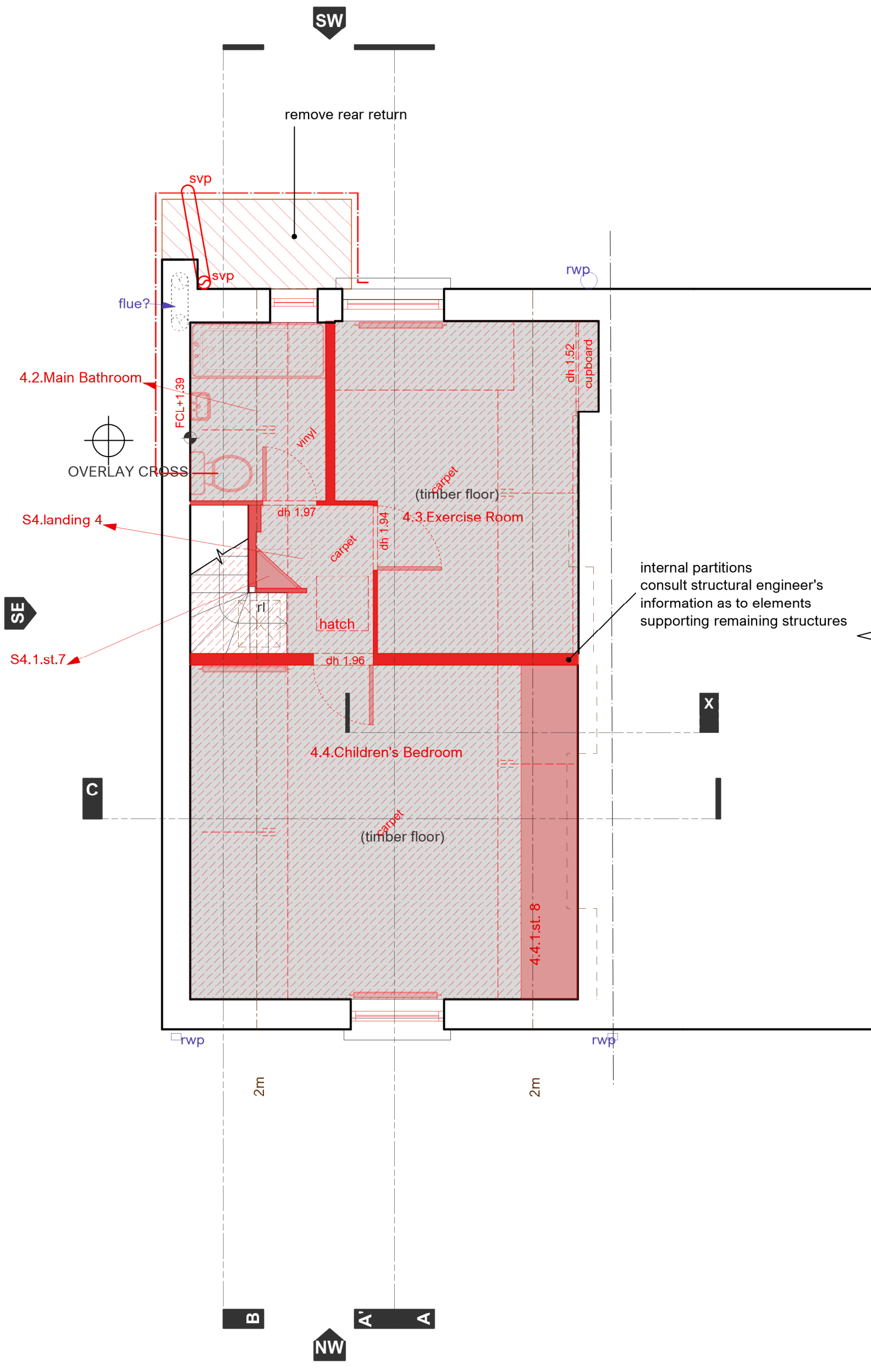
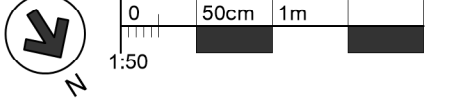

No change from that under planning permission 2019/5671/P

Citizen Architects
www.citizenarchitects.eu | tel: 020 3865 1453

Project & Site Address:
Wildwood Residence
1 Wildwood Terrace, London, UK, NW3 7HT

Client:
A&M

Sheet Title:
Second Floor Plan
Existing & Remedial

Level of Detail: Planning 1 | Date 1st Issued: 31.03.2021 | Scale: 1:50 | Size: A3

Project No:	Drawing
Phase:	Type: Number: Revision:
057WT	X GA X04 A

© all information is copyright of citizen architects limited unless attributed. reproduction in part of full is withheld and must be approved in writing