









KEY	
	New timber studs or joists
	Decoded up joists
	Existing masonry wall
	New cavity wall
	New ground bearing slab
	New strip or pad foundations
	New steel columns
	Limit shown above



STEEL COLUMN SCHEDULE		
SECTION	GRADE	NOTES
C1: LUC 152 x 152 x 40	S275	-
C2: SHS 100 x 100 x 12.5	S275	-
C3: SHS 100 x 100 x 8	S275	Weight could be reduced in column design
C4: RHS 100 x 100 x 8	S275	Weight could be reduced in column design

FOUNDATION SCHEDULE	
Dimensions (Width x Thickness)	NOTES
Strip 1: 400 (w) 100mm (th)	Foundation width 100mm
Strip 1: 750 x 750	Foundation width 100mm
Pad 2: 200 x 200	Foundation width 100mm

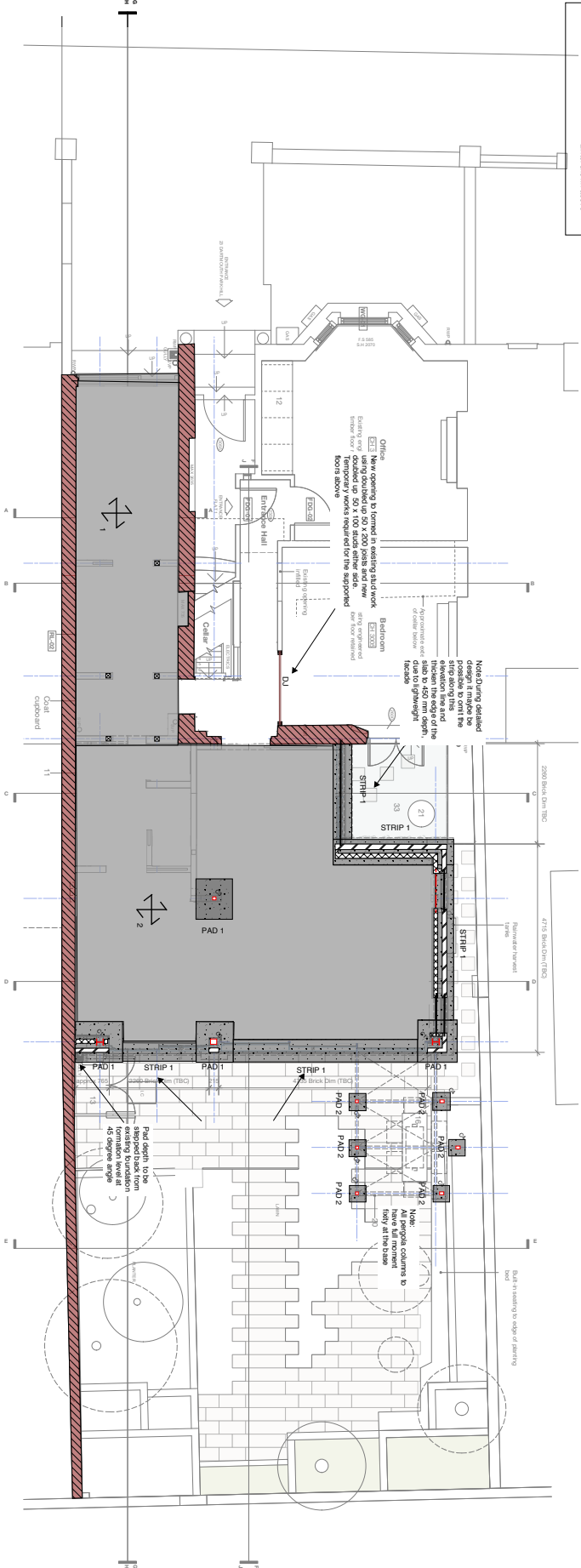
100 mm thick ground bearing slab
containing and 150 mm
compacted hardcore

150 mm thick ground bearing slab
containing and 150 mm
compacted hardcore

PROPOSED GROUND FLOOR

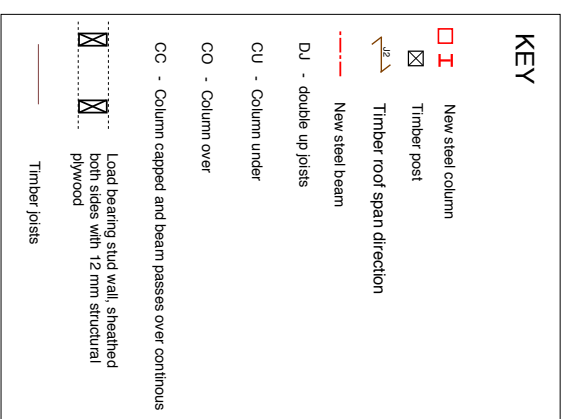

TIMBER SCHEDULE		
SECTION	GRADE	REMARKS
Jt. 50 X 150	C-16	10 m. including plywood members only
Jc. 50 X 25	C-16	10 m. including plywood members only
Dkt. 250x50 X 150	C-16	10 m. structural plywood members only
Dkt. 250x50 X 200	C-16	10 m. structural plywood members only
Dkt. 250x50 X 200	C-16	10 m. structural plywood members only

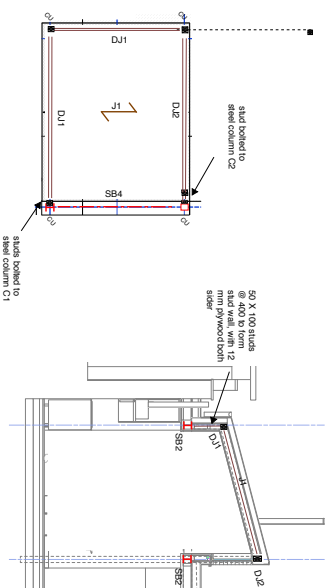

PROPOSED FIRST FLOOR - TIMBER ROOF LANTERN OPTION