

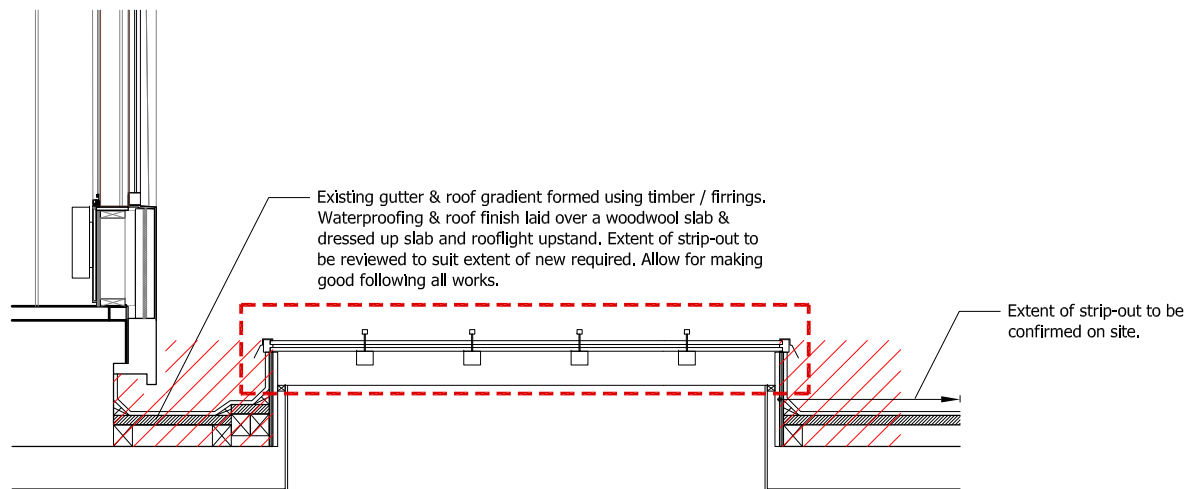

© Architon LLP 2014
This drawing is the property of Architon LLP and must not be divulged to anyone, copied or reproduced, or used for marketing, advertising or promotional purposes without the express written permission of Architon LLP.

All dimensions are to be checked on site and not scaled from this drawing. Contractors must verify all dimensions on site before setting out, commencing work or preparing shop drawings. Any discrepancies on this drawing with other contract documentation to be reported immediately for clarification.

Notes



KEY

ALLOW FOR CAREFUL REMOVAL OF EXISTING WATERPROOFING / ROOF FINISH, EXISTING WOOLBOARD SLAB AS WELL AS CAREFUL REMOVAL OF EXISTING TIMBER ROOF CONSTRUCTION TO SUIT NEW CONSTRUCTION REQUIRED FOR NEW ROOFLIGHTS, TO S.E. DETAIL DESIGN.

EXISTING ROOF LIGHTS TO BE CAREFULLY REMOVED

S2 LEVEL 5 ROOFLIGHTS
EXISTING SECTION 1:20

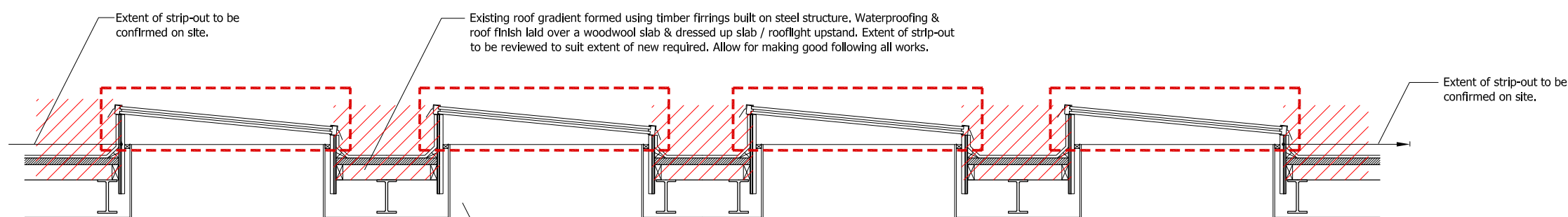

S1 LEVEL 5 ROOFLIGHTS
EXISTING SECTION 1:20

Internal ceilings stripped out by demolitions contractor to reveal, see strip-out & demolition plan

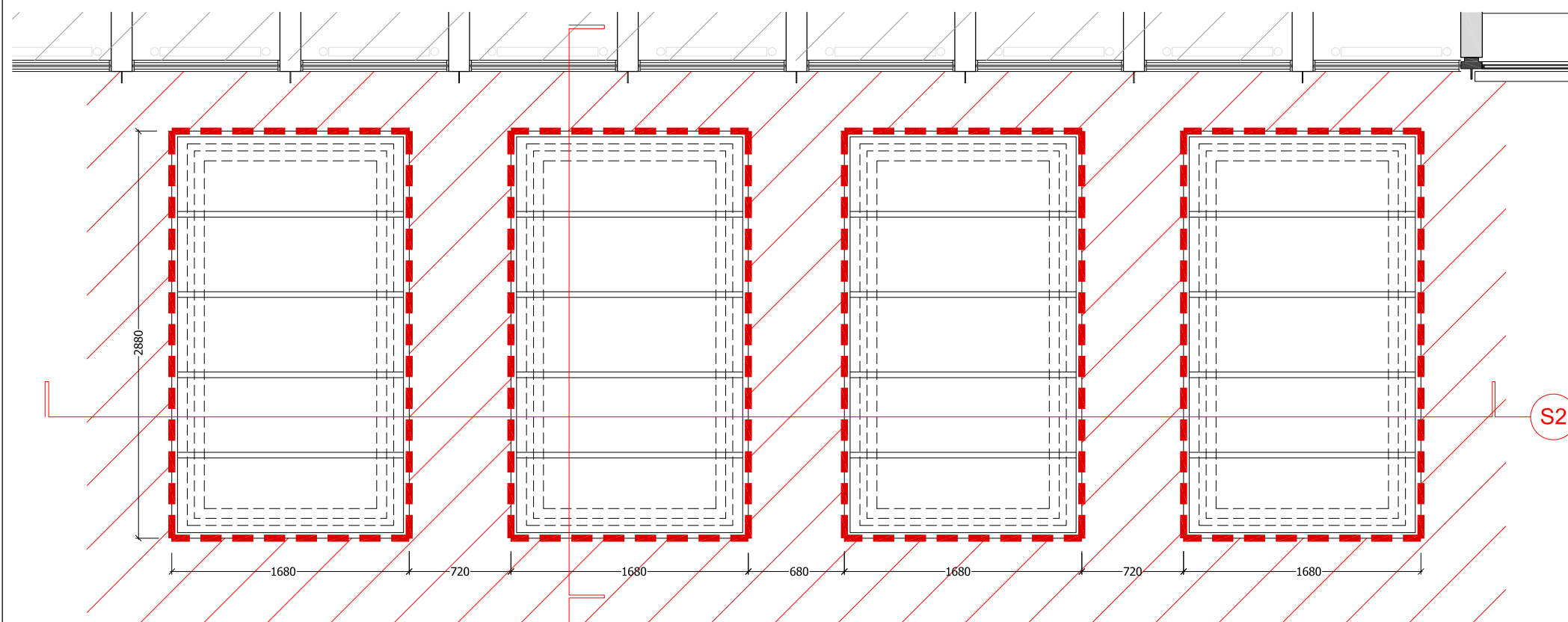

2 LEVEL 5 ROOFLIGHTS
EXISTING PLAN 1:20

S1

S2

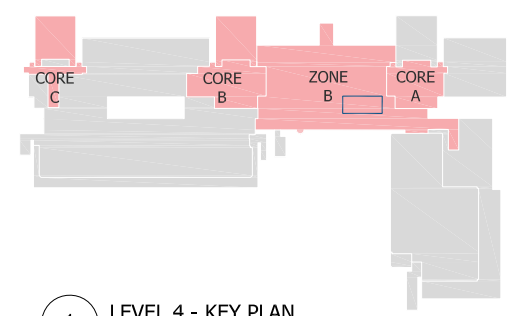

1 LEVEL 4 - KEY PLAN
FOR REFERENCE NTS 1:20

PLANNING ISSUE

P3	FINAL PLANNING ISSUE	08/12/21
P2	PLANNING ISSUE	16/04/21
P1	ISSUED FOR FINAL COMMENTS	01/02/21
Rev	Description	Date



Client
Job title
University College London
Institute of Education
Phase 2
20 Bedford Way, WC1H 0AL

Drawing title
Level 4 Rooflight
Existing Plan & Sections
Strip-out & Preparation
Planning Application 2C

Scale	Date	Drawn
1:20 @A1	DEC 20	MJR

ARCHITON LLP
CHARTERED ARCHITECTS - DESIGN
PLANNING CONSULTANTS - DEVELOPMENT
BUILDING COST MANAGEMENT
REGENCY HOUSE
17 WEST STREET
EPSOM KT18 7RL
TEL: 01372 745600
FAX: 01372 745016
Email: info@architon.com

Drawing No	ARCHITON LLP certified to: BS EN ISO 9001 BS EN ISO 14001 IIP Accreditation
3147-P3-2431 P3	