

2 LEVEL 4 - CORE A & ZONE B
REFLECTED CEILING FINISHES 1:100

PLANNING ISSUE

P5	FINAL PLANNING ISSUE	08/12/21
P4	PLANNING ISSUE	07/05/21
P3	PLANNING ISSUE	16/04/21
P2	ISSUED FOR FINAL COMMENTS	01/02/21
P1	ISSUED FOR COMMENTS	11/12/20
Rev	Description	Date



Client
University College London
Institute of Education
Phase 2
20 Bedford Way, WC1H 0AL

Drawing title
Level 4 Zone B
Reflected Ceiling Finishes
Planning Application 2C

Scale	Date	Drawn
1:100 @ A1	DEC 20	IL

ARCHITON LLP
 CHARTERED ARCHITECTS · DESIGN · PLANNING CONSULTANTS · DEVELOPMENT · BUILDING COST MANAGEMENT
 REGENCY HOUSE 17 WEST STREET EPSOM KT18 7RL
 TEL: 01372 745600 FAX: 01372 745016 Email: info@architon.com

Drawing No
3147-P3-2411 P5
 ARCHITON LLP certified to:
 BS EN ISO 9001
 BS EN ISO 14001
 IIP Accreditation

LEGEND

- AREA OUTSIDE SCOPE OF WORKS, EXCEPT FOR MAKING GOOD WHERE DISTURBED
- LINE / FACE OF BULKHEAD / LOWERED SOFFIT
- DUST SEAL TO SOFFIT ONLY
- 600 x 600 MF SUSPENDED CEILING - ACOUSTIC PERFORMANCE TO SUIT AV TESTING
- ACOUSTIC TIMBER BATTENS WITH EXPOSED SOFFIT OVER - SERVICES TO BE PAINTED WHITE
- CLEAN EXISTING CONCRETE SURFACES AND ALLOW FOR KEIM COATING
- EXPOSE CONCRETE SOFFITS. INSPECT CONDITION, GOOD QUALITY / UNFINISHED CONCRETE TO BE RETAINED & CLEANED. POOR QUALITY / PAINTED / ENCAPSULATED SOFFIT TO BE REPAINTED, TO MATCH PHASE 1.
- PLASTERBOARD SUSPENDED CEILING
- ECOPHON FOCUS DS RAFT SYSTEM
- METAL SUSPENDED CEILING - PLANKS
- ACOUSTIC RAFT
- MAKE GOOD, PAINT FINISH TO EXISTING PLASTERBOARD CEILING
- SUPPLY GRILLE - REFER TO M&E LAYOUTS/SPEC
- ACOPHON FOCUS DS RAFT SYSTEM
- METAL SUSPENDED CEILING - PLANKS
- MAKE GOOD, PAINT FINISH TO EXISTING PLASTERBOARD CEILING
- SUPPLY GRILLE - REFER TO M&E LAYOUTS/SPEC

NOTE:

APPLY PAINT FINISH TO ALL EXPOSED INTERNAL SOFFITS, TO INCLUDE ABOVE ALL M&E SERVICES AND ACOUSTIC PANELS.

EXPOSE CONCRETE SOFFITS. INSPECT CONDITION, GOOD QUALITY / UNFINISHED CONCRETE TO BE RETAINED & CLEANED. POOR QUALITY / PAINTED / ENCAPSULATED SOFFIT TO BE REPAINTED, TO MATCH PHASE 1.

- PLASTERBOARD SUSPENDED CEILING
- ECOPHON FOCUS DS RAFT SYSTEM
- METAL SUSPENDED CEILING - PLANKS
- ACOUSTIC RAFT
- MAKE GOOD, PAINT FINISH TO EXISTING PLASTERBOARD CEILING
- SUPPLY GRILLE - REFER TO M&E LAYOUTS/SPEC

GENERAL:
 CONTRACTOR TO CHECK LIGHT SETTING OUT ON SITE TO CONFIRM ANY FURTHER WALL CLASHES PRIOR TO CONSTRUCTION.
 REFER TO M&E CONSULTANT'S DETAIL DESIGN FOR ALL M&E LAYOUTS, SYMBOLS & LIGHTING REFERENCES. ALL LEVELS SHOWN NOMINAL AND TO BE CHECKED AGAINST EXISTING LEVELS ON SITE.

ENSURE NO STRIP OUT, DEMOLITION OR BUILDING WORKS ARE UNDERTAKEN WITHOUT THE REQUIRED LISTED BUILDING AND PLANNING CONSENTS FROM THE LOCAL AUTHORITY AND ENGLISH HERITAGE.

DRAWINGS ARE BASED ON INFORMATION PROVIDED BY UCL.

- DRAWINGS TO BE READ IN CONJUNCTION WITH:-
- ARCHITECTURAL DRAWINGS, SCHEDULES AND SPECIFICATIONS.
 - STRUCTURAL DRAWINGS AND SPECIFICATIONS.
 - M&E DRAWINGS AND SPECIFICATIONS.
 - ACOUSTIC REPORTS.
 - FIRE STRATEGY.

ALL WORKS TO BE FULLY CO-ORDINATED WITH MEP / STRUCTURAL PROPOSALS, AS APPROPRIATE.

ALL SETTING-OUT INFORMATION TO BE CHECKED AGAINST SITE DIMENSIONS

ALL WORKS TO BE IN ACCORDANCE WITH ALL STATUTORY REQUIREMENTS. WHERE AMENDED PROPOSALS DIFFER FROM THOSE APPROVED BY LA, NEW APPROVALS TO BE OBTAINED PRIOR TO COMMENCING WORKS.

FIRE RATED COMPONENTS TO BE IN ACCORDANCE WITH OVER-ARCHING FIRE STRATEGY FOR THE IOE.

ACOUSTIC RATED COMPONENTS TO BE IN ACCORDANCE WITH ACOUSTIC STRATEGY - PREPARED BY B.H.

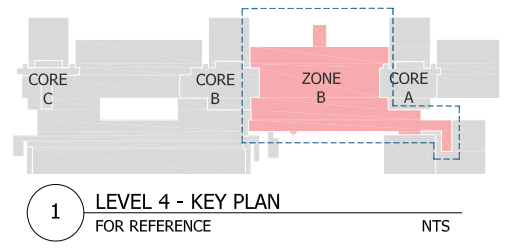

1 LEVEL 4 - KEY PLAN FOR REFERENCE NTS

