

**ENSURE NO STRIP OUT, DEMOLITION OR BUILDING WORKS ARE UNDERTAKEN WITHOUT THE REQUIRED LISTED BUILDING AND PLANNING CONSENTS FROM THE LOCAL AUTHORITY AND ENGLISH HERITAGE.**

DRAWINGS ARE BASED ON INFORMATION PROVIDED BY UCL.

- DRAWINGS TO BE READ IN CONJUNCTION WITH:-
- ARCHITECTURAL DRAWINGS, SCHEDULES AND SPECIFICATIONS.
  - STRUCTURAL DRAWINGS AND SPECIFICATIONS.
  - M&E DRAWINGS AND SPECIFICATIONS.
  - ACOUSTIC REPORTS.
  - FIRE STRATEGY.

ALL WORKS TO BE FULLY CO-ORDINATED WITH MEP / STRUCTURAL PROPOSALS, AS APPROPRIATE.

ALL SETTING-OUT INFORMATION TO BE CHECKED AGAINST SITE DIMENSIONS

ALL WORKS TO BE IN ACCORDANCE WITH ALL STATUTORY REQUIREMENTS. WHERE AMENDED PROPOSALS DIFFER FROM THOSE APPROVED BY LA, NEW APPROVALS TO BE OBTAINED PRIOR TO COMMENCING WORKS.

FIRE RATED COMPONENTS TO BE IN ACCORDANCE WITH OVER-ARCHING FIRE STRATEGY FOR THE IOE.

ACOUSTIC RATED COMPONENTS TO BE IN ACCORDANCE WITH ACOUSTIC STRATEGY - PREPARED BY B.H.

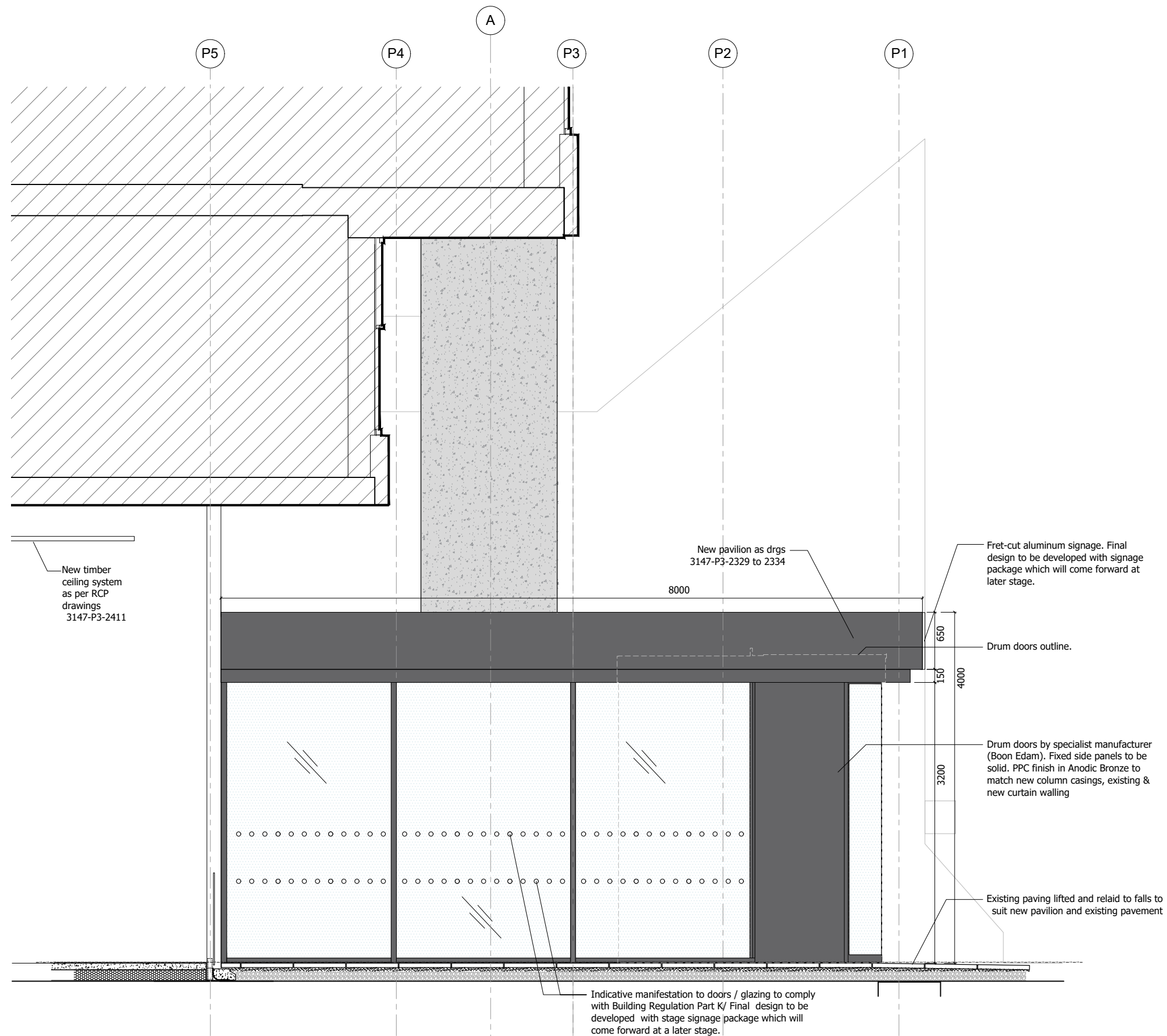

**PLANNING ISSUE**

P2	FINAL PLANNING ISSUE	16/04/21
P1	ISSUED FOR FINAL COMMENTS	01/02/21
Rev	Description	Date

**overbury** Client

Job title  
University College London  
Institute of Education  
Phase 2  
20 Bedford Way, WC1H 0AL

Drawing title  
Level 3 - Pavilion  
South Elevation- As Proposed  
Planning Application 3

Scale	Date	Drawn
1:50@A3	DEC 20	IL

**ARCHITON LLP**  
CHARTERED ARCHITECTS · DESIGN · PLANNING CONSULTANTS · DEVELOPMENT · BUILDING COST MANAGEMENT

REGENCY HOUSE  
17 WEST STREET  
EPSOM KT18 7RL  
TEL: 01372 745600  
FAX: 01372 745016  
Email: info@architon.com

Drawing No	ARCHITON LLP certified to: BS EN ISO 9001 BS EN ISO 14001 IIP Accreditation
3147-P3-2333 P2	

1 Pavilion - South Elevation E3  
As Proposed 1:50 @ A3

