

This drawing is the property of Architon LLP and must not be divulged to anyone, copied or reproduced, or used for marketing, advertising or promotional purposes without the express written permission of Architon LLP.

All dimensions are to be checked on site and not scaled from this drawing. Contractors must verify all dimensions on site before setting out, commencing work or preparing shop drawings. Any discrepancies on this drawing with other contract documentation to be reported immediately for clarification.

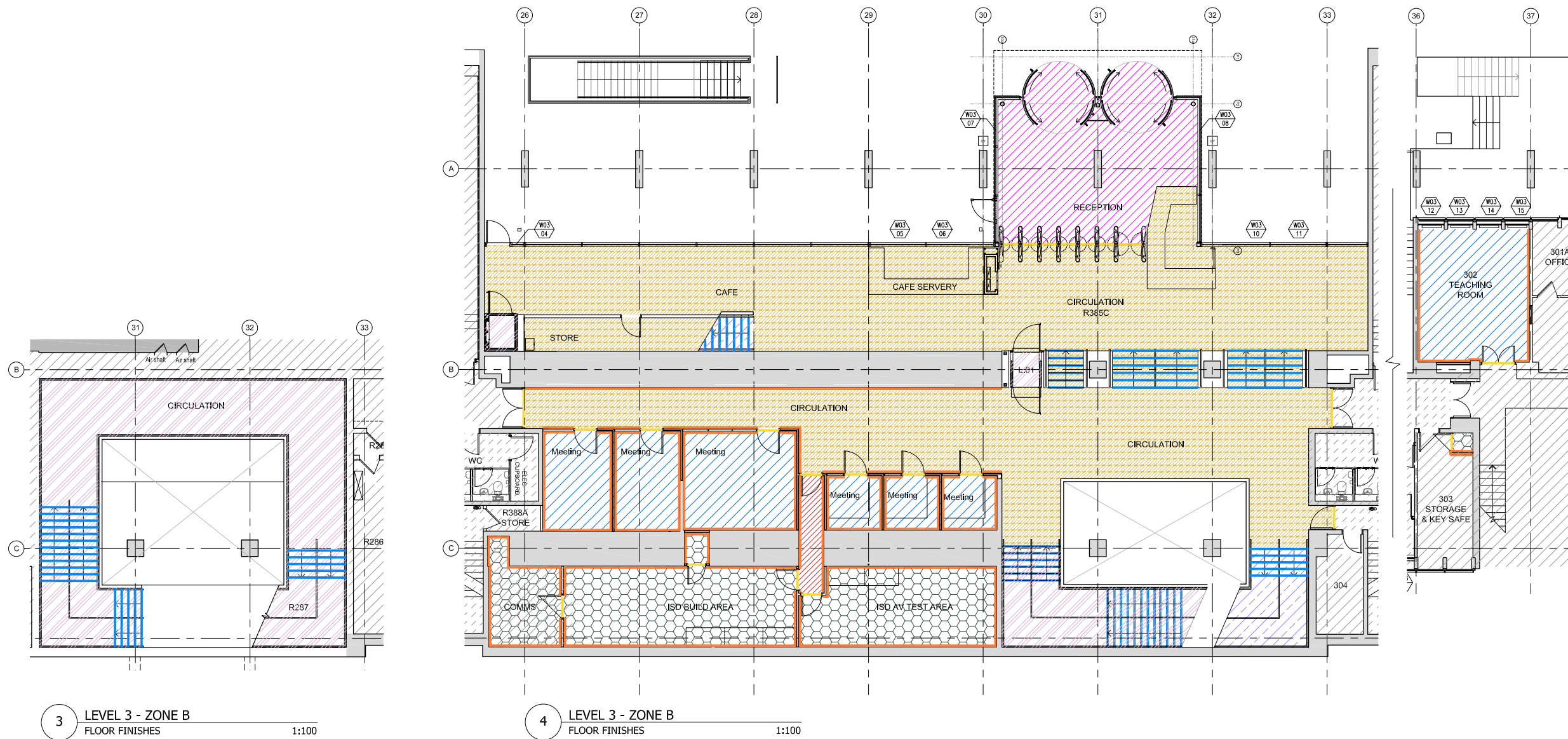

3 LEVEL 3 - ZONE B FLOOR FINISHES 1:100

4 LEVEL 3 - ZONE B FLOOR FINISHES 1:100

LEGEND

- AREA OUTSIDE SCOPE OF WORKS, EXCEPT FOR MAKING GOOD WHERE DISTURBED
- WORKS BEING CARRIED OUT AS PLANNING / LISTED CONSENTS, REFERENCE: 2019/6386/P & 2019/6410/L
- CARPET - CORES EGE EPOCA CLASSIC ECT350 COKE - 078278548
- ANTI-STATIC FLOORING - COMMS ROOM / TEA-POINT / RAMP/ CUPBOARD/ NORAPLAN, SENTICA ED - 6520 - LRV - 36.74
- CARPET - TEACHING SPACES MILLIKEN, CULTURE CANVAS STREET ART - SAT152-79 FLICKS. LRV 11
- SLIP RESISTANT RUBBER FLOOR - NORAMENT 926 - GREY 6173
- NON-SLIP CERAMIC TILES - TOILETS
- BARRIER MATTING
- HIGH QUALITY RESIN/COMPOSITE FLOORING
- EXISTING FLOOR CONFIRM CONDITION
- MAKE GOOD/ CLEAN EXISTING FLOOR TILES
- SKIRTING SK-01 - TIMBER
- FLOOR TRIM / THRESHOLD STRIP
- NEW BRASS STAIR NOSING WITH CONTRAST INSERTS TO MATCH PHASE 1 STAIR LEVEL 2 TO LEVEL 4.

GENERAL REQUIREMENTS:

- ALLOW FOR LEVELING SCREED TO TAKE UP DIFFERENCES / LEVEL SUBSTRATE AS APPROPRIATE INCLUDING WHERE EXISTING WALLS REMOVED AS PART OF DEMOLITION & STRIP-OUT.
- ALLOW FOR LAYING NEW LATEX SCREED OVER EXISTING CONCRETE SCREED AS SPEC AS REQUIRED
- ALLOW FOR LOCAL REPAIR / REPLACEMENT OF EXISTING FLOOR FINISHES, AS APPROPRIATE

ENSURE NO STRIP OUT, DEMOLITION OR BUILDING WORKS ARE UNDERTAKEN WITHOUT THE REQUIRED LISTED BUILDING AND PLANNING CONSENTS FROM THE LOCAL AUTHORITY AND ENGLISH HERITAGE.

DRAWINGS ARE BASED ON INFORMATION PROVIDED BY UCL.

- DRAWINGS TO BE READ IN CONJUNCTION WITH:-
- ARCHITECTURAL DRAWINGS, SCHEDULES AND SPECIFICATIONS.
 - STRUCTURAL DRAWINGS AND SPECIFICATIONS.
 - M&E DRAWINGS AND SPECIFICATIONS.
 - ACOUSTIC REPORTS.
 - FIRE STRATEGY.

ALL WORKS TO BE FULLY CO-ORDINATED WITH MEP / STRUCTURAL PROPOSALS, AS APPROPRIATE.

ALL SETTING-OUT INFORMATION TO BE CHECKED AGAINST SITE DIMENSIONS

ALL WORKS TO BE IN ACCORDANCE WITH ALL STATUTORY REQUIREMENTS. WHERE AMENDED PROPOSALS DIFFER FROM THOSE APPROVED BY LA, NEW APPROVALS TO BE OBTAINED PRIOR TO COMMENCING WORKS.

FIRE RATED COMPONENTS TO BE IN ACCORDANCE WITH OVER-ARCHING FIRE STRATEGY FOR THE IOE.

ACOUSTIC RATED COMPONENTS TO BE IN ACCORDANCE WITH ACOUSTIC STRATEGY - PREPARED BY B.H.

PLANNING ISSUE

P4	FINAL PLANNING ISSUE	08.12.2021
P3	PLANNING ISSUE	21.07.2021
P2	PLANNING ISSUE	16.04.2021
P1	ISSUED FOR FINAL COMMENTS	10.02.2021
Rev	Description	Date



Job title
University College London
Institute of Education
Phase 2
20 Bedford Way, WC1H 0AL

Drawing title
Level 3 & 2 Zone B
Floor Finishes
Planning Application 2C

Scale	Date	Drawn
1:100 @ A1	Feb 21	IL

ARCHITON LLP
 CHARTERED ARCHITECTS . DESIGN .
 PLANNING CONSULTANTS . DEVELOPMENT .
 BUILDING COST MANAGEMENT
 REGENCY HOUSE 17 WEST STREET EPSON KT18 7RL
 TEL:01372 745600 FAX:01372 745016
 Email:info@architon.com

Drawing No	ARCHITON LLP certified to: BS EN ISO 9001 BS EN ISO 14001 IIP Accreditation
3147-P3-2313 - P4	

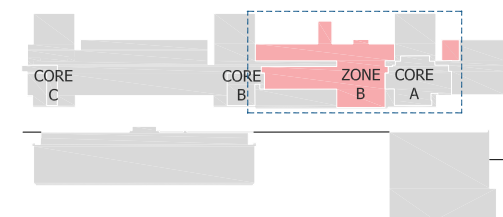

2 LEVEL 3 - KEY PLAN FOR REFERENCE NTS

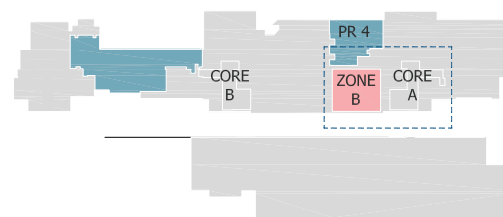

1 LEVEL 2 - KEY PLAN FOR REFERENCE NTS

