

© Architon LLP 2014

This drawing is the property of Architon LLP and must not be divulged to anyone, copied or reproduced, or used for marketing, advertising or promotional purposes without the express written permission of Architon LLP.

All dimensions are to be checked on site and not scaled from this drawing. Contractors must verify all dimensions on site before setting out, commencing work or preparing shop drawings. Any discrepancies on this drawing with other contract documentation to be reported immediately for clarification.

- LEGEND
- AREA OUTSIDE SCOPE OF WORKS, EXCEPT FOR MAKING GOOD WHERE DISTURBED
- NOTE:
- APPLY PAINT FINISH TO ALL EXPOSED INTERNAL SOFFITS, TO INCLUDE ABOVE ALL M&E SERVICES AND ACOUSTIC PANELS.
- EXPOSE CONCRETE SOFFITS. INSPECT CONDITION, GOOD QUALITY / UNFINISHED CONCRETE TO BE RETAINED & CLEANED. POOR QUALITY / PAINTED / ENCAPSULATED SOFFIT TO BE REPAINTED, TO MATCH PHASE 1.
- PLASTERBOARD SUSPENDED CEILING
- ECOPHON FOCUS DS RAFT SYSTEM
- METAL SUSPENDED CEILING - PLANKS
- ACOUSTIC RAFT
- METAL SUSPENDED CEILING - PLANKS
- MAKE GOOD, PAINT FINISH TO EXISTING PLASTERBOARD CEILING
- SUPPLY GRILLE - REFER TO M&E LAYOUTS/SPEC

- LINE / FACE OF BULKEAD / LOWERED SOFFIT
- DUST SEAL TO SOFFIT ONLY
- 600 x 600 MF SUSPENDED CEILING - ACOUSTIC PERFORMANCE TO SUIT AV TESTING
- ACOUSTIC TIMBER BATTENS WITH EXPOSED SOFFIT OVER - SERVICES TO BE PAINTED WHITE
- CLEAN EXISTING CONCRETE SURFACES AND ALLOW FOR KEIM COATING
- DESIGN HEIGHT FOR SUSPENDED CEILING ELEMENT, SUBJECTED TO FINAL SERVICES INSTALLATION LEVEL

GENERAL:

CONTRACTOR TO CHECK LIGHT SETTING OUT ON SITE TO CONFIRM ANY FURTHER WALL CLASHES PRIOR TO CONSTRUCTION.

REFER TO M&E CONSULTANT'S DETAIL DESIGN FOR ALL M&E LAYOUTS, SYMBOLS & LIGHTING REFERENCES. ALL LEVELS SHOWN NOMINAL AND TO BE CHECKED AGAINST EXISTING LEVELS ON SITE.

ENSURE NO STRIP OUT, DEMOLITION OR BUILDING WORKS ARE UNDERTAKEN WITHOUT THE REQUIRED LISTED BUILDING AND PLANNING CONSENTS FROM THE LOCAL AUTHORITY AND ENGLISH HERITAGE.

DRAWINGS ARE BASED ON INFORMATION PROVIDED BY UCL.

- DRAWINGS TO BE READ IN CONJUNCTION WITH:-
- ARCHITECTURAL DRAWINGS, SCHEDULES AND SPECIFICATIONS.
 - STRUCTURAL DRAWINGS AND SPECIFICATIONS.
 - M&E DRAWINGS AND SPECIFICATIONS.
 - ACOUSTIC REPORTS.
 - FIRE STRATEGY.

ALL WORKS TO BE FULLY CO-ORDINATED WITH MEP / STRUCTURAL PROPOSALS, AS APPROPRIATE.

ALL SETTING-OUT INFORMATION TO BE CHECKED AGAINST SITE DIMENSIONS

ALL WORKS TO BE IN ACCORDANCE WITH ALL STATUTORY REQUIREMENTS, WHERE AMENDED PROPOSALS DIFFER FROM THOSE APPROVED BY LA, NEW APPROVALS TO BE OBTAINED PRIOR TO COMMENCING WORKS.

FIRE RATED COMPONENTS TO BE IN ACCORDANCE WITH OVER-ARCHING FIRE STRATEGY FOR THE IOE.

ACOUSTIC RATED COMPONENTS TO BE IN ACCORDANCE WITH ACOUSTIC STRATEGY - PREPARED BY B.H.

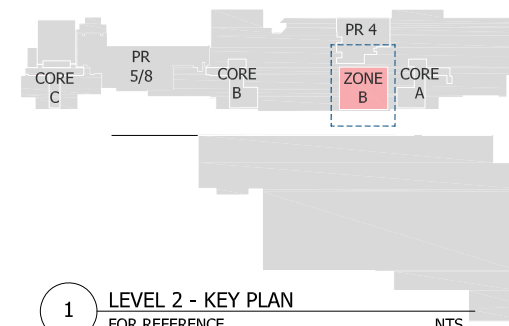
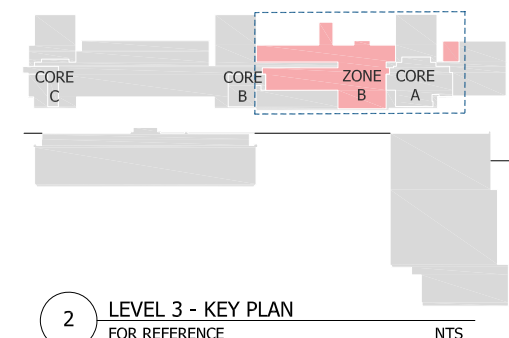

PLANNING ISSUE

P5	FINAL COMMENTS ISSUE	08/12/21
P4	COMMENTS ISSUE	16/04/21
P3	ISSUED FOR FINAL COMMENTS	01/02/21
P2	COMMENTS INCORPORATED	23/12/20
P1	ISSUED FOR COMMENTS	11/12/20
Rev	Description	Date

overbury Client

Job title

University College London
Institute of Education
Phase 2
20 Bedford Way, WC1H 0AL

Drawing title

Level 2 & Level 3 Zone B
Reflected Ceiling Finishes
Planning Application 2C

Scale	Date	Drawn
1:100 @ A1	DEC 20	IL

ARCHITON LLP

CHARTERED ARCHITECTS · DESIGN · PLANNING CONSULTANTS · DEVELOPMENT · BUILDING COST MANAGEMENT

REGENCY HOUSE
17 WEST STREET
EPSOM KT18 7RL
Email: info@architon.com

TEL: 01372 745600
FAX: 01372 745016

Drawing No

3147-P3-2311 P5

ARCHITON LLP
certified to:
BS EN ISO 9001
BS EN ISO 14001
IIP Accreditation