

WT97					
Window Type	Manufacturer	Structural Opening Size		U-Value	Finish
		SO Width	SO Height		
WT97	West Coast Windows	2710	2400	1.4	RAL 1014
Total: 1					

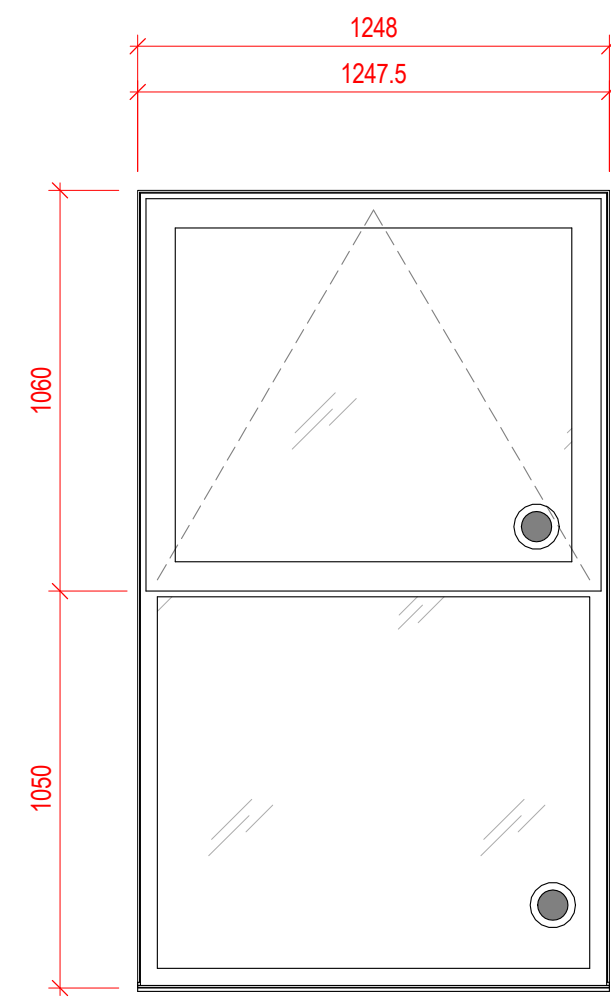

WT55					
Window Type	Manufacturer	Structural Opening Size		U-Value	Finish
		SO Width	SO Height		
WT55	Ideal Combi	1248	2110	1.4	RAL 1014
Total: 1					

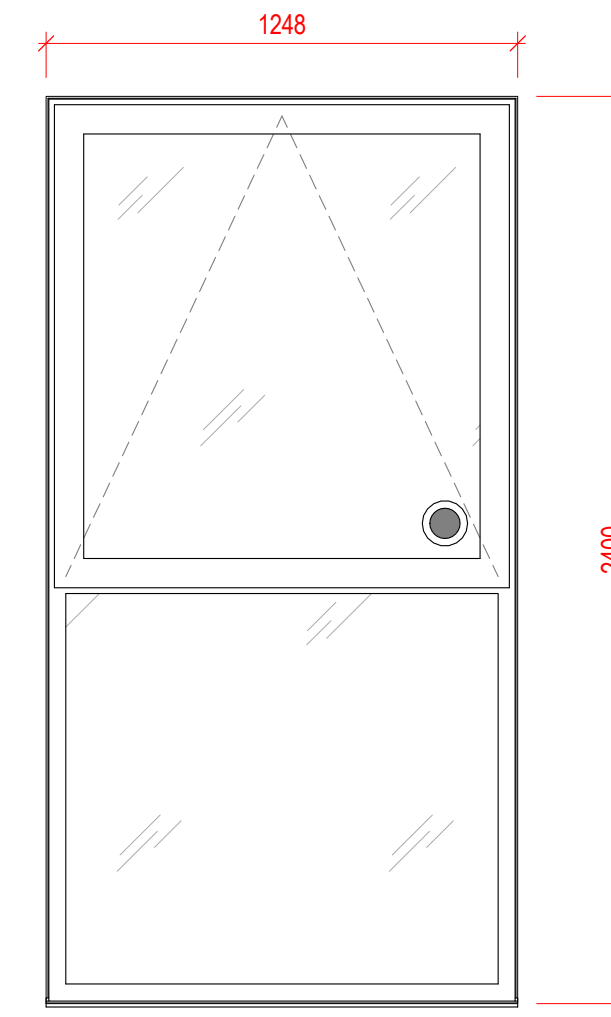

WT65					
Window Type	Manufacturer	Structural Opening Size		U-Value	Finish
		SO Width	SO Height		
WT65	Ideal Combi	1248	2400	1.4	RAL 1014
Total: 2					

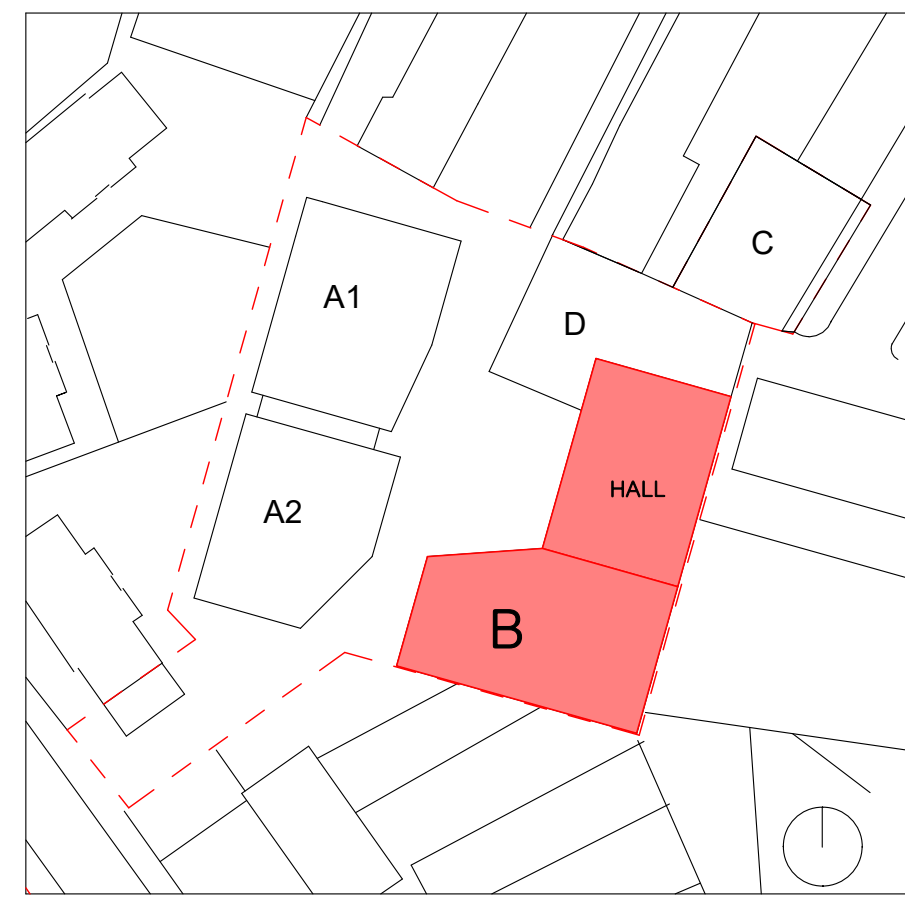

Key Plan

Windows

- Refer to architect's general arrangement & elevation drawings for window locations and handing. Lines indicating opening in elevations point to the hinge side.
- Dimensions are structural opening dimensions. **CONTRACTOR TO CHECK ALL SITE DIMENSIONS PRIOR TO ORDERING.** All windows to be sized to allow for installation and building tolerances.
- Except for ACV and egress windows, windows shall be fitted with a lockable security restrictor (without push buttons) to allow the windows to be opened a minimum of 75mm and to prevent the windows being opened more than 100mm. It should not be possible to operate the security restrictor from outside of window.
- Ironmongery to be to the Employers approval. Handles to incorporate window locks (key operated) to lock the window in the closed and night vent positions. Push button will not be acceptable. Ironmongery to wheelchair units require specialist handles. Extension poles not acceptable. Refer to adaptability schedule for requirements (if any) to wheelchair adaptable units.
- Allow for obscure/opaque glazing units to bathrooms, shower rooms WCs and Kitchen where worktop passes in front of glazing.
- Window boards shall be moisture resistant, MDF with a bull nosed exposed edge.
- Glazing throughout is to be hermetically sealed double/triple glazed, laminated/toughened glass units with internal glazing beads. To be factory glazed and finished where practical. Internally beaded.
- Refer to fire strategy drawings for locations of fire rated glazing.

Glazing

- Safety glass
- Refer to schedule for laminated glass requirements for SBD.

Top of transom below operable casement and tilt & turn to be no lower than 800mm above FFL.

Please note that window elevations shown are the elevation of the outside face of the window.

Rev	Date	By	Description
C05	30/11/21	CR	Construction Issue - Full set for Completeness
C04	10/11/21	CR	Rooflights revised as per M+E comments
C03	10/09/21	CR	Windows Construction Issue
C02	05/08/21	CR	Windows Construction Issue
C01	16/06/21	CR	Revised as per RCKa Comments

Revision History



Rooflights					
Window Type	Manufacturer	Structural Opening Size		U-Value	Finish
		SO Width	SO Height		
RL05	The Rooflight Company	2044	3092	1.4	RAL 1014
RL06	The Rooflight Company	3092	965	1.4	RAL 1014
RL07	The Rooflight Company	1544	965	1.4	A rooflight designed for flat roofs, sitting at only 95mm above the kerb height.
RL08	The Rooflight Company	1544	965	1.4	Openable Roof light with actuators
Total: 19					

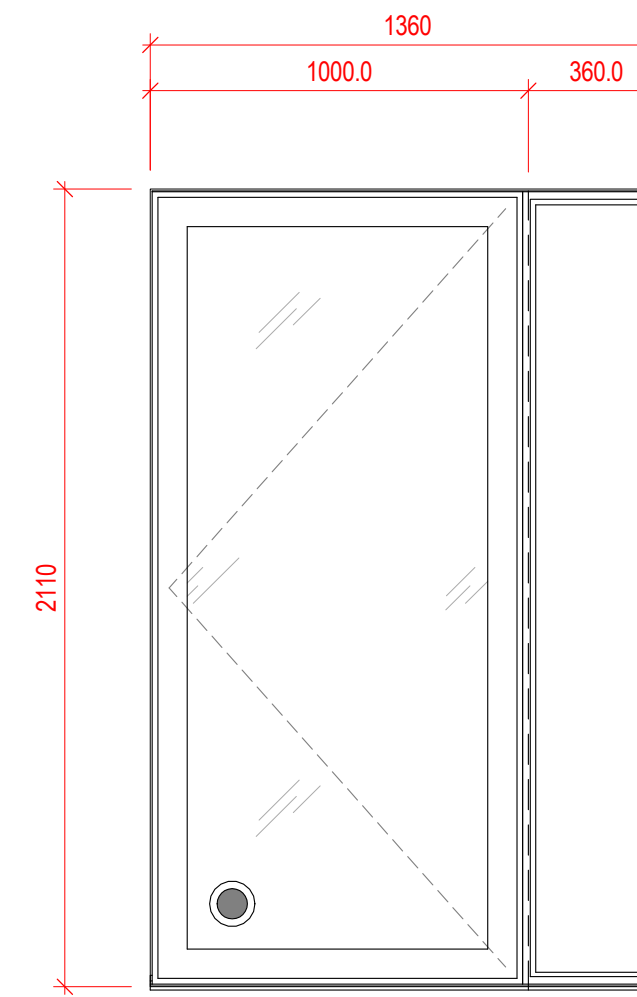
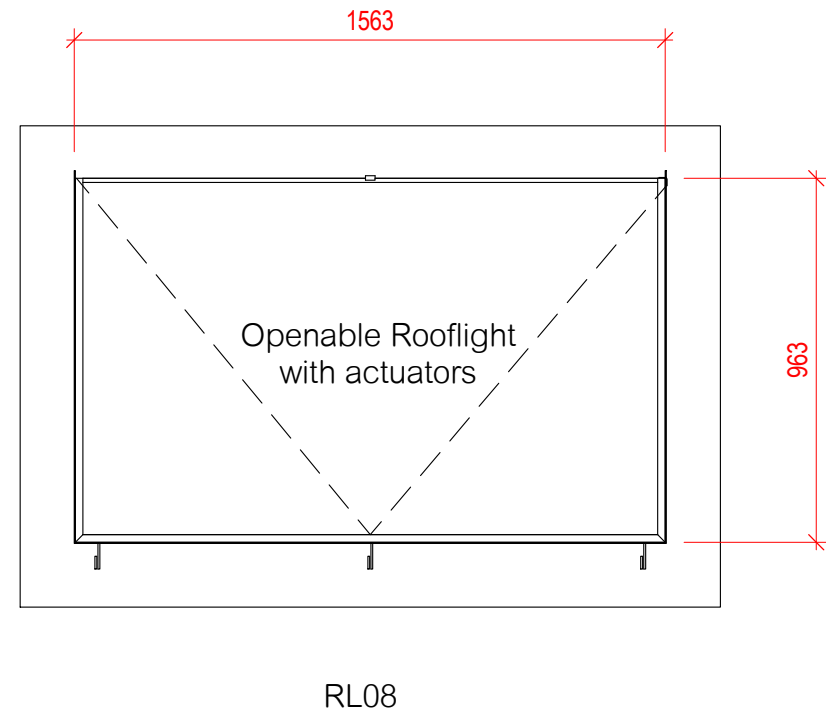

WT23					
Window Type	Manufacturer	Structural Opening Size		U-Value	Finish
		SO Width	SO Height		
WT23	Ideal Combi	1360	2110	1.4	RAL 1014
Total: 1					

Space One Beadon Road
London W8 0EA
T 020 8237 8200
mail@hunters.co.uk
www.hunters.co.uk

FARRANS
Camden
Doran
CONSULTING
Camlins
simple mckillop
Harvey

HNCC

25 Bertram Street,
Highgate,
London,
N19 5DQ

BLOCK B & HALL - WINDOW TYPES 02 Sheet 02 of 02

Status: **S4 - CONSTRUCTION**

hunters project number: M9920	client project number: HNCC	scale: 1 : 20 @ A1	drawn by: CR	checked by: PG
----------------------------------	--------------------------------	-----------------------	-----------------	-------------------

drawing title:
HNCC HUN- 04- ZZ- DR- A- 54-41002

revision: C05	date: 30/11/21	revised by: CR
-------------------------	-------------------	-------------------

Construction Issue - full set for Completeness

