

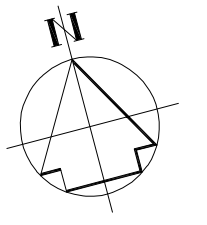

scales 1:50 @ A1  
1:100 @ A3

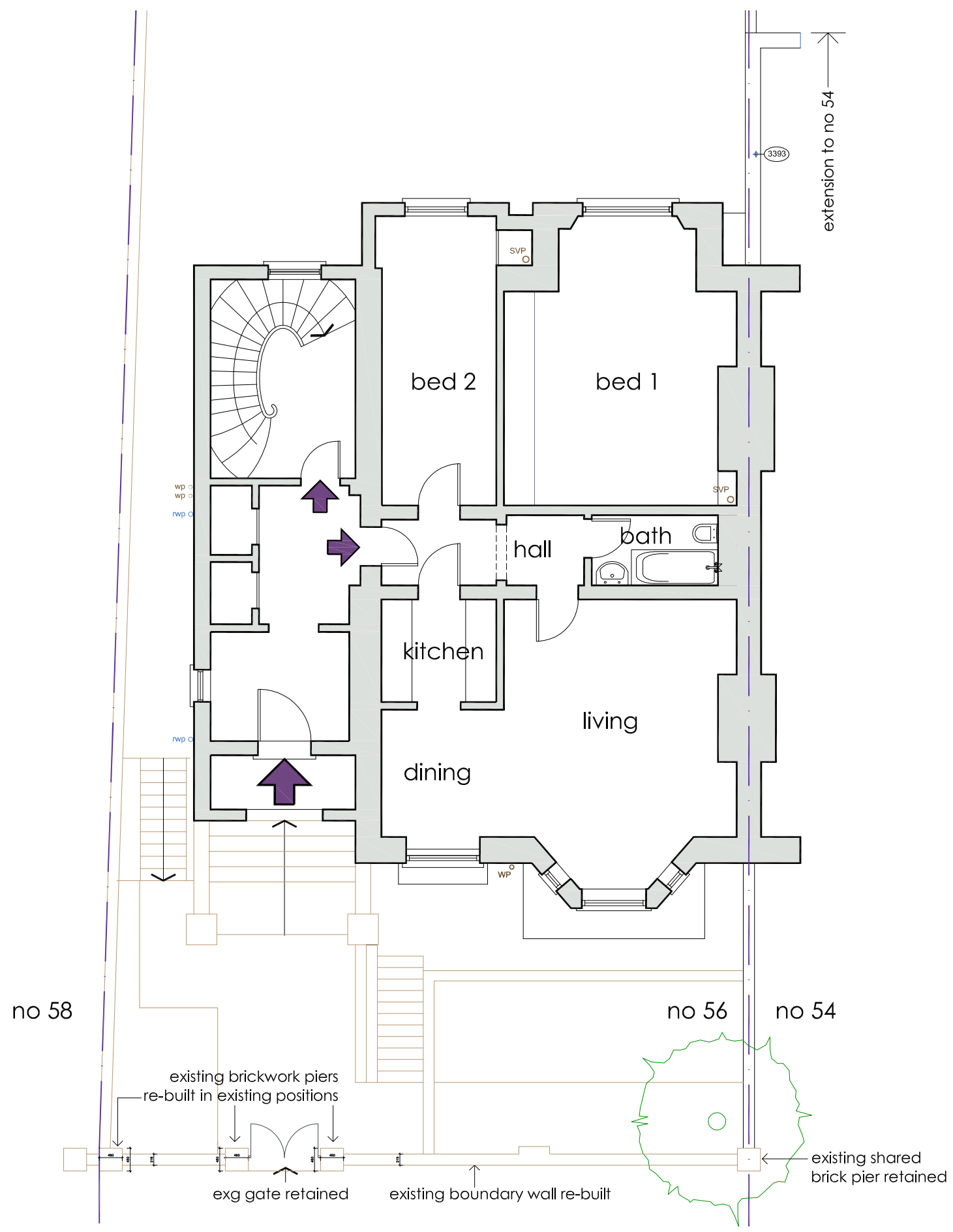

# ground floor as proposed



REGENTS PARK ROAD

## ground floor

**DVM**  
ARCHITECTS

4a Murray Street . London . NW1 9RE  
Telephone 0207 485 2121 . Facsimile 0207 267 2527  
e-mail: studio@dvmarch.com

---

**Client**  
John Cottrell

---

**Project**  
56 Regents Park Road  
London NW1 7SX

---

**Title**  
Ground Floor Plan  
as Proposed

<b>Scale</b> 1:50	<b>Date</b> 12.12.21	<b>Job No.</b> 1161	
<b>Drawing No.</b> 1161-13	<b>Rev.</b> A		

All dimensions are to be checked on site.  
© This drawing is copyright and remains the property of David & Victoria Mercer at all times and may not be reproduced in part or whole without written consent.