



Space House

Planning Condition Discharge Report

Conditions 3LBC a)

For Seaforth Land

December 2021

Document History

Rev	Date	Purpose of Issue	Author	Reviewer
A	20/09/21	Planning Condition Discharge	MPa	CW
B	17/12/21	Planning Condition Discharge	MPa	CW

Contents

1.0 Introduction

1.1 Purpose of the Report

2.0 Planning Condition 3LBC a)

2.1 Tower and Kingsway extension terrace railings

2.2 Bridge-Link level 1 & 2 balcony balustrade

2.3 Bridge-Link Level 3 terrace balustrade

2.3 Car Park Ramp railings

1.0 Introduction

1.1 Purpose of the Report

This document has been prepared by Squire and Partners to provide support information for the discharge of Conditions 3LBC a) in relation to the approved development at Space House (refs: 2021/1058/P and 2021/1106/L).

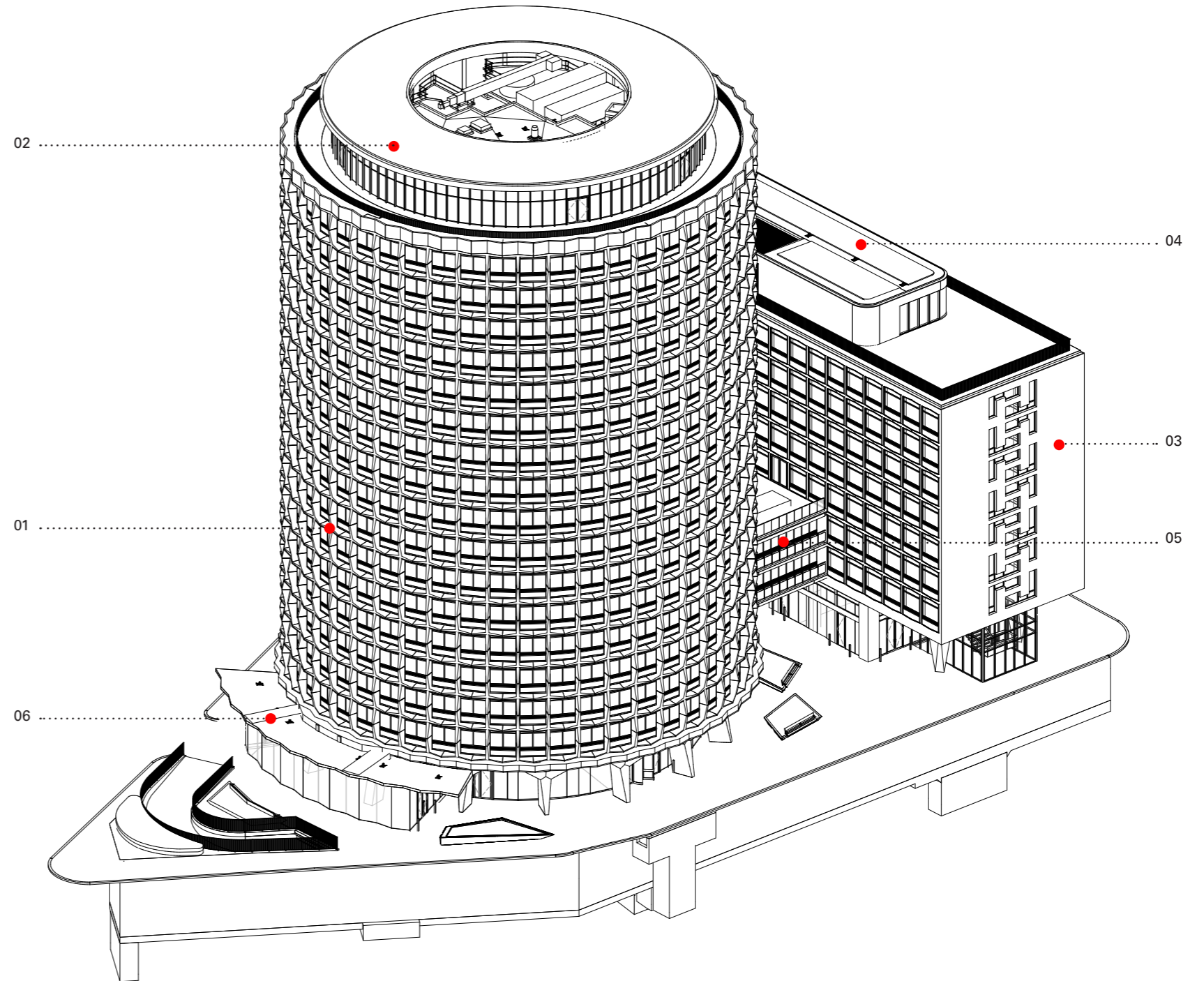

Fig. 1.0.1 Space House Axonometric

Key:

- 01. Tower building
- 02. Tower extension
- 03. Kingsway building
- 04. Kingsway extension
- 05. Bridge-Link
- 06. Western Canopy (Filling Station)

2.0 Planning Condition 3LBC a)

“Detailed drawings, or samples of materials as appropriate, in respect of the following, shall be submitted to and approved in writing by the local planning authority before the relevant part of the work is begun:

a) Details of new railings at a scale of 1:10, including materials, finish and method of fixing.

The relevant part of the works shall be carried out in accordance with the details thus approved and all approved samples shall be retained on site during the course of the works.”

2.1 Space House railings and balustrades

Location 01 - Tower extension terrace balustrade

Mild steel balustrade bars and handrails.

Location 02 - Kingsway extension terrace balustrade

Mild steel balustrade bars and handrails.

Location 03 - Bridge-Link level 1 & 2 balcony balustrade

New balustrade system to match the existing balustrade. Brushed stainless steel balustrade posts with clear glazed panel infills. Retained timber handrail.

Location 04 - Bridge-Link Level 3 terrace balustrade

Glazed balustrade system with aluminium base fixing. Clear glass panel infills with silicone vertical joints. Aluminium top cap.

Location 05 - Car Park Ramp railings

Brushed 316 stainless steel balustrade system.

All facing materials will be discharged under Planning Condition 3LBC e) at a later stage once relevant subcontractors have been appointed.

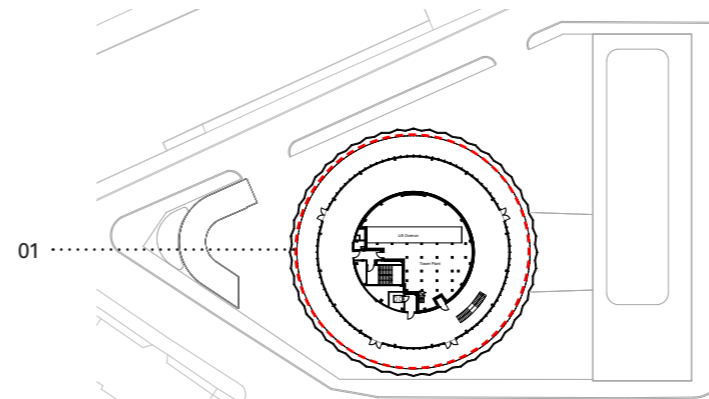

Fig. 2.0.1 Proposed Roof Plan

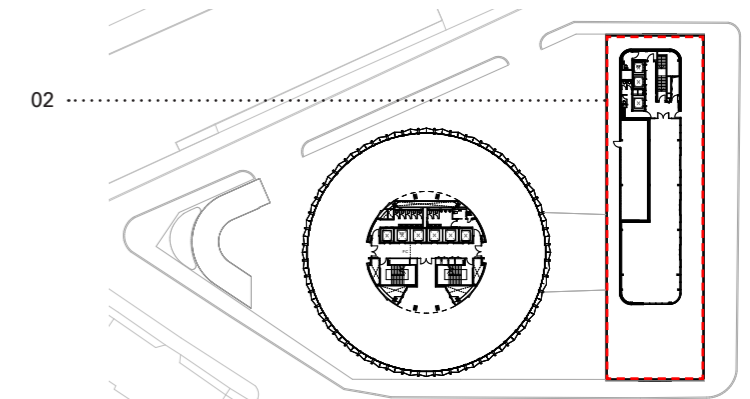

Fig. 2.0.2 Proposed Level 08 Plan

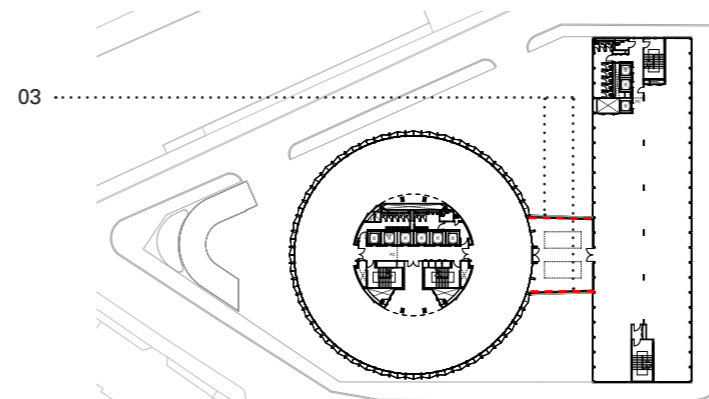

Fig. 2.0.3 Proposed Level 03 Plan

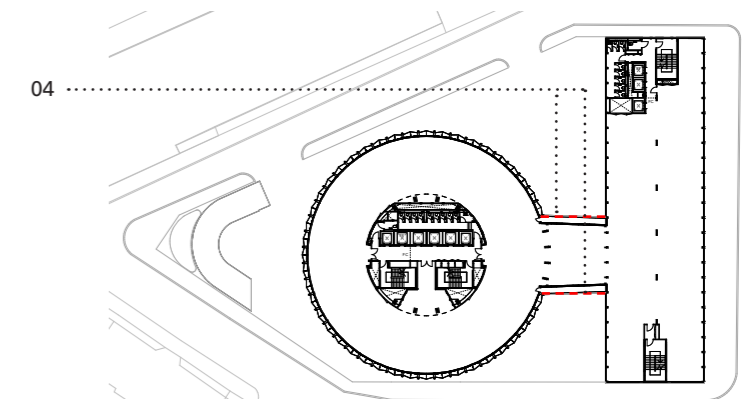

Fig. 2.0.4 Proposed Level 1 & 2 Plan

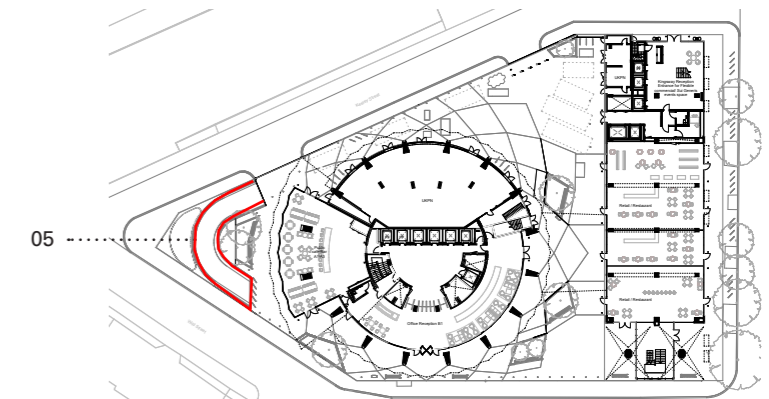

Fig. 2.0.5 Proposed Ground Floor Plan

Key:

01. Tower terrace balustrade

02. Kingsway terrace balustrade

03. Bridge-Link terrace balustrade

04. Bridge-Link balconies balustrade

05. Car Park Ramp railings



Precedent image - Locations 01 & 02

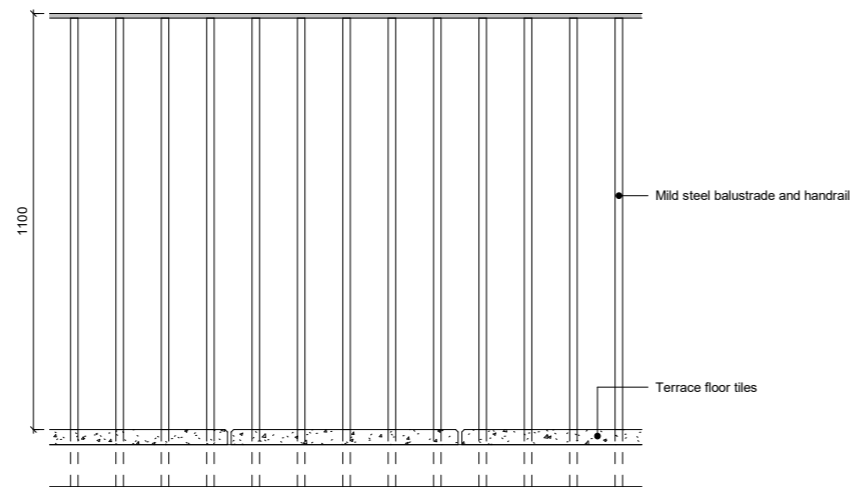

1 Tower Terrace - Balustrade Elevation
1:10

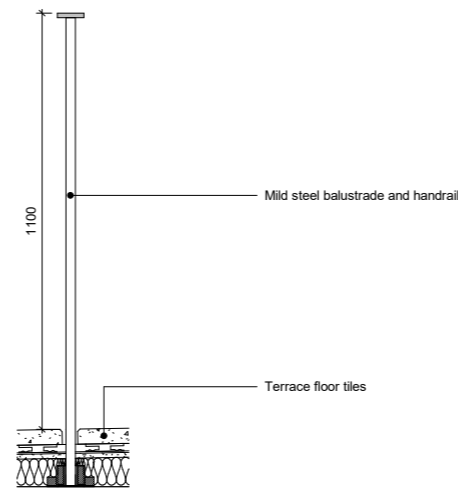

2 Tower Terrace - Balustrade Section
1:10

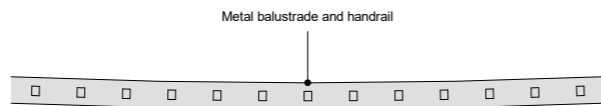

3 Tower Terrace - Balustrade Plan
1:10

Do not scale from this drawing. All dimensions to be checked on site. All omissions and discrepancies to be reported to the Architect immediately

This work is copyright and shall not be reproduced or used for any other purpose without the written permission of Squire and Partners.

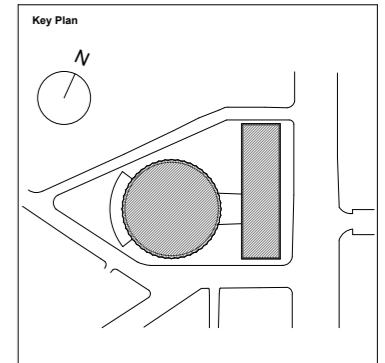

Scale 1:10
0 100 200 300 400 500

LOCATION 01

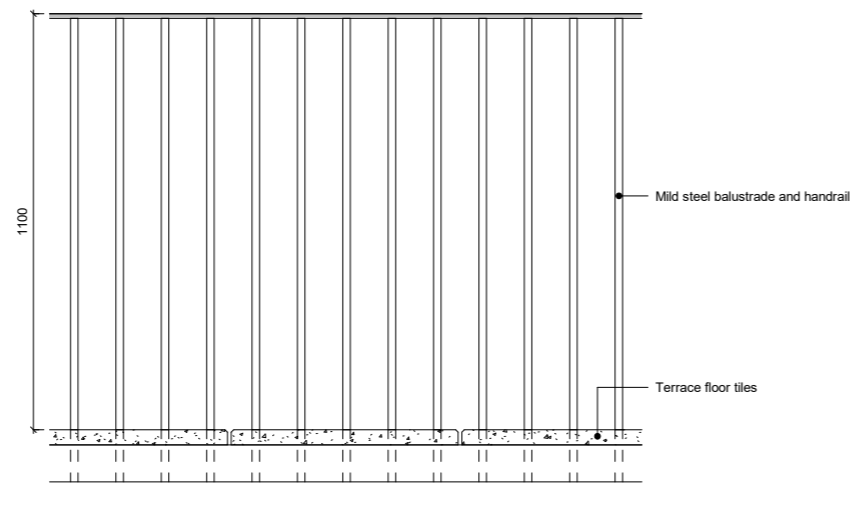

4 Kingsway Terrace - Balustrade Elevation
1:10

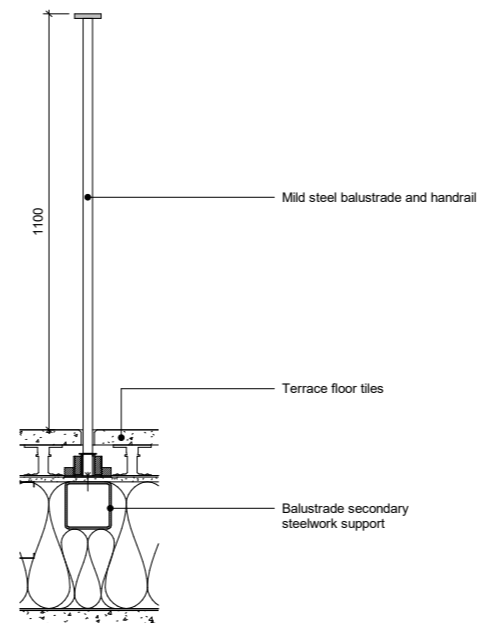

5 Kingsway Terrace - Balustrade Section
1:10

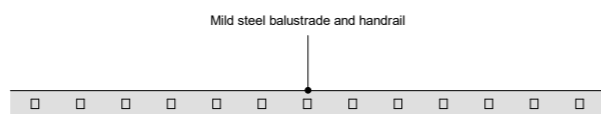

6 Kingsway Terrace - Balustrade Plan
1:10

Planning Condition Discharge Description	20/09/21	SQP	A
Date	Dm/Chk	Rev	

SQUIRE & PARTNERS

Squire and Partners LLP
The Department Store
248 Ferndale Road, London SW9 8FR
T: 020 7278 5555

info@squireandpartners.com
www.squireandpartners.com

Project
Space House
London
WC2

Title
Terrace Balustrades
Metal Balustrade Type
Location 01 & 02

Date	Scale @ ISO A1	Job Number
20/09/2021	1:10	18077
Drawing Number	Revision	
18077-SQP-ZZ-ZZ-DR-A-PL34401	A	

LOCATION 02

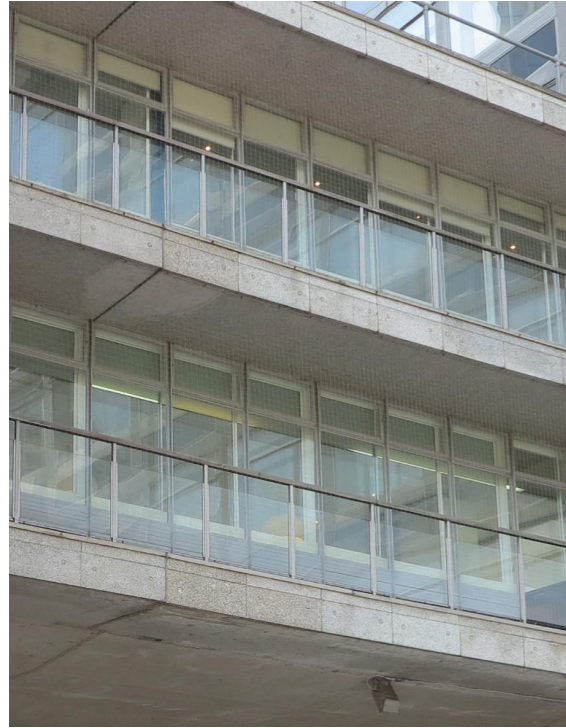

Existing balustrade design to be replicated - Location 03

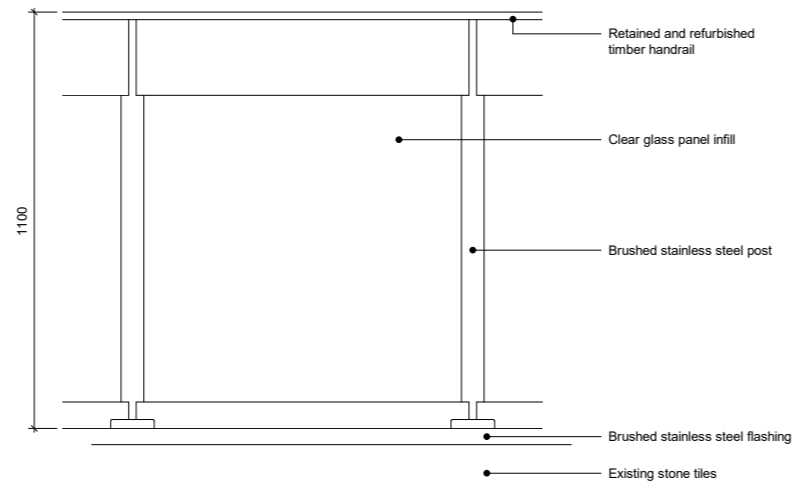

4 Bridge Link Balconies - Balustrade Elevation
1:10

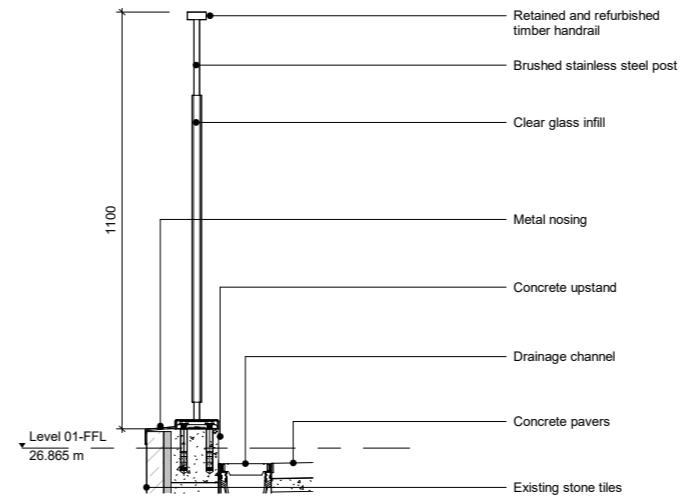

5 Bridge Link Balconies - Balustrade Section
1:10



6 Bridge Link Balconies - Balustrade Plan
1:10

Do not scale from this drawing. All dimensions to be checked on site. All omissions and discrepancies to be reported to the Architect immediately

This work is copyright and shall not be reproduced or used for any other purpose without the written permission of Squire and Partners.

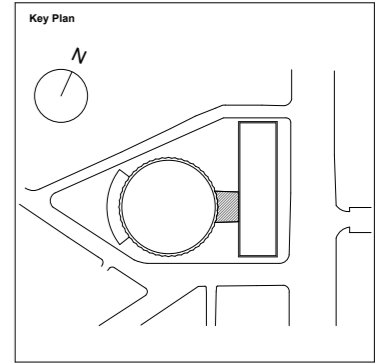

Scale 1:10
0 100 200 300 400 500

LOCATION 03

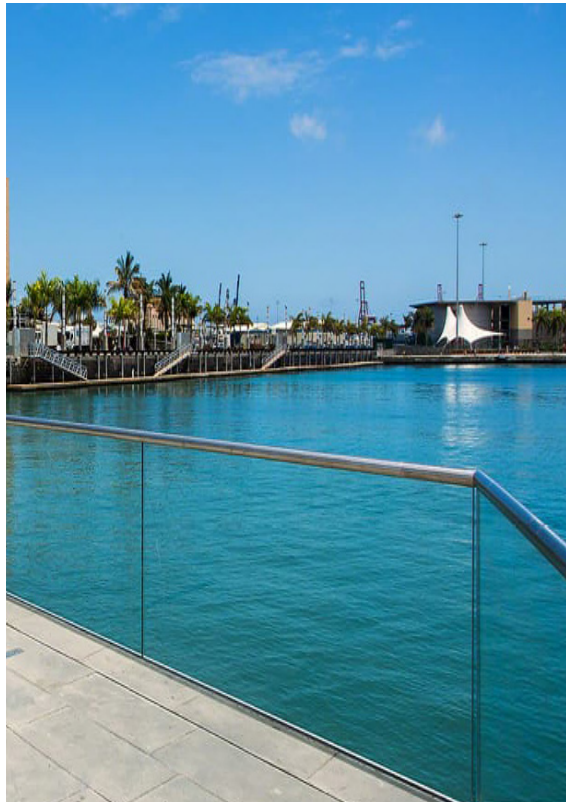

Precedent image - Location 04

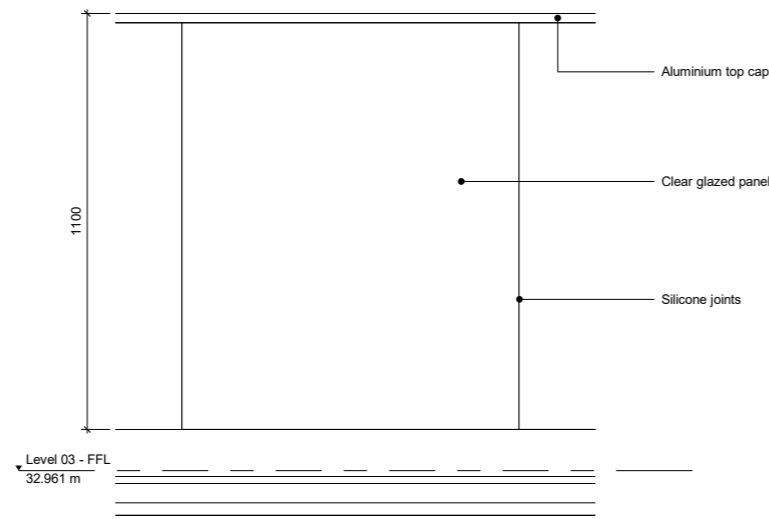

1 Bridge Link Terrace - Balustrade Elevation
1:10

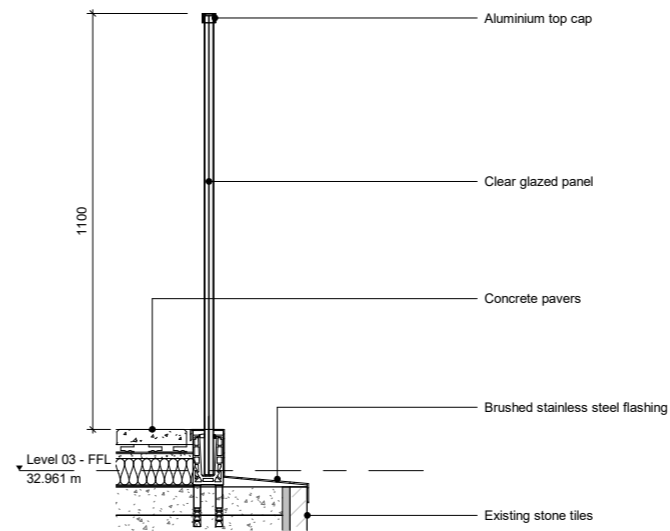

2 Bridge Link Terrace - Balustrade Section
1:10

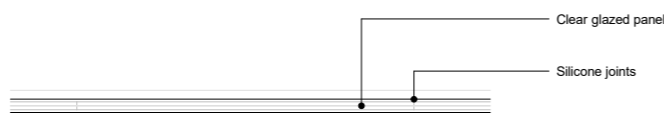

3 Bridge Link Terrace - Balustrade Plan
1:10

Planning Condition Discharge Description	20/09/21	SQP	A
Date	Dm/Chk	Rev	

SQUIRE & PARTNERS

Squire and Partners LLP
The Department Store
248 Ferndale Road, London SW9 8FR
T: 020 7278 5555

info@squireandpartners.com
www.squireandpartners.com

Project
**Space House
London
WC2**

Title
**Bridge Link Balustrades
Glass Balustrade Details
Location 03 & 04**

Date	Scale @ ISO A1	Job Number
20/09/2021	1:10	18077
Drawing Number	Revision	
18077-SQP-01-ZZ-DR-A-PL34402	A	

LOCATION 04

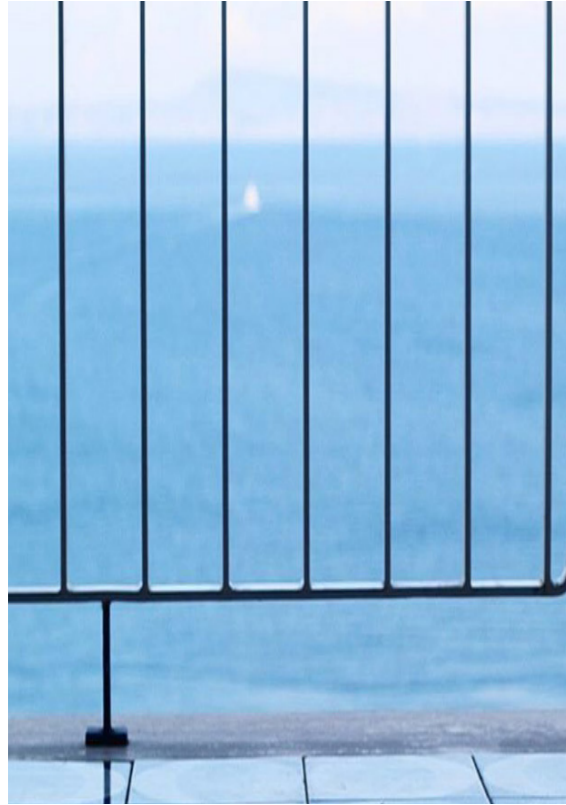

Precedent image - Location 05

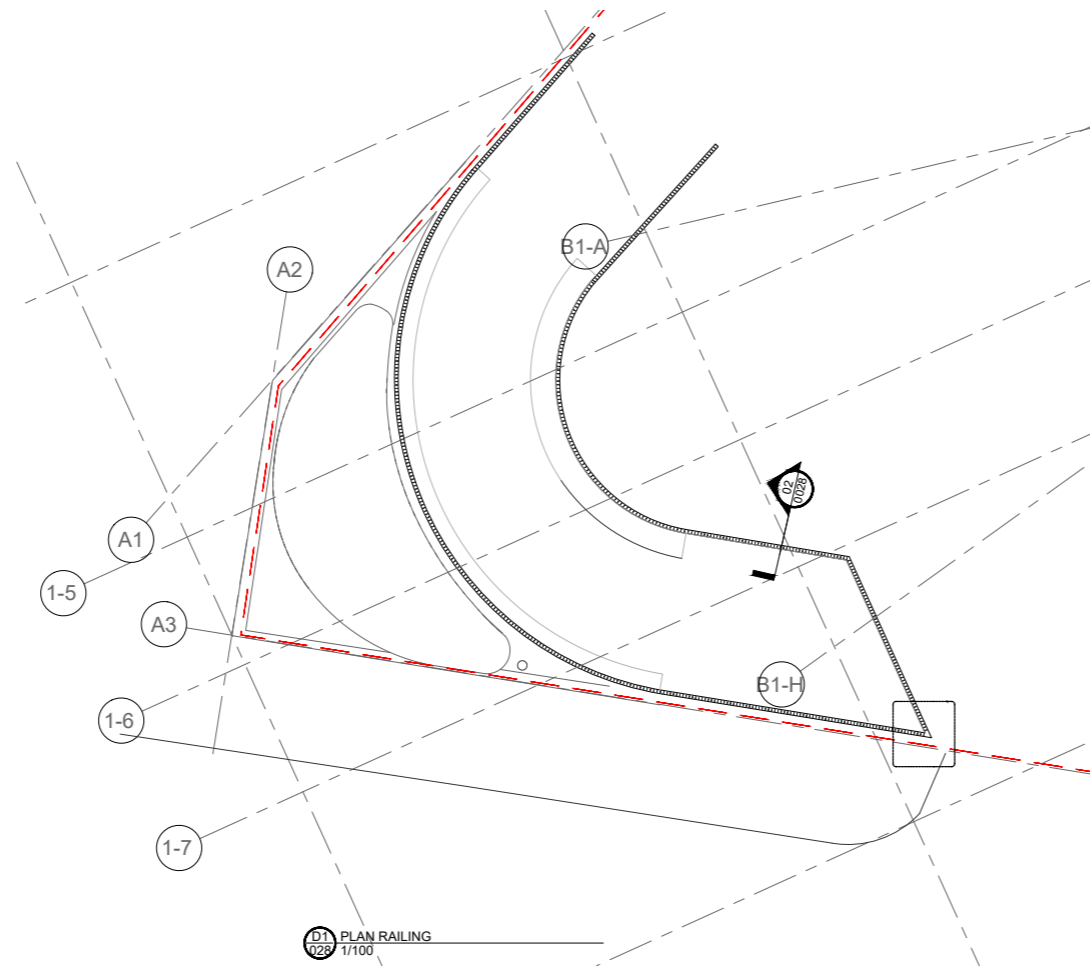

D1 PLAN RAILING
1/100

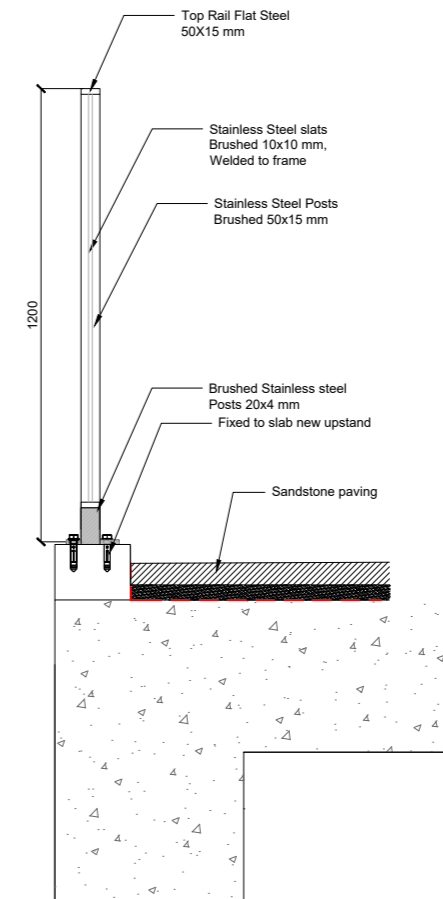

D2 TYPICAL SECTION RAILING
1/10

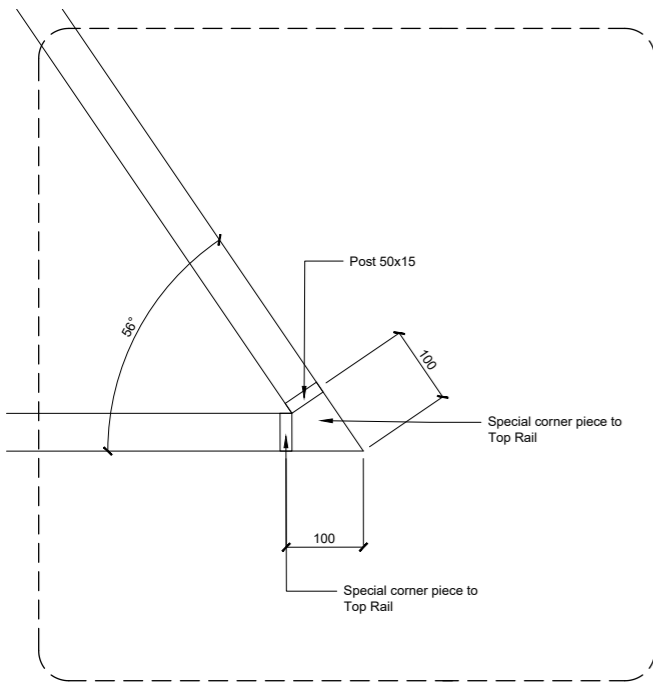
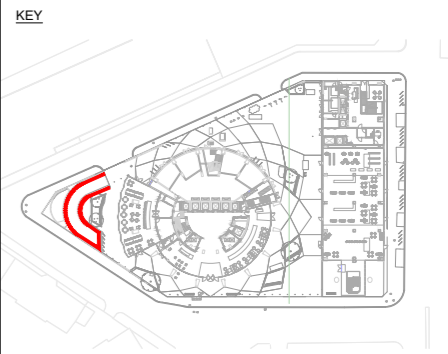

D3 TYPICAL ELEVATION
1/10

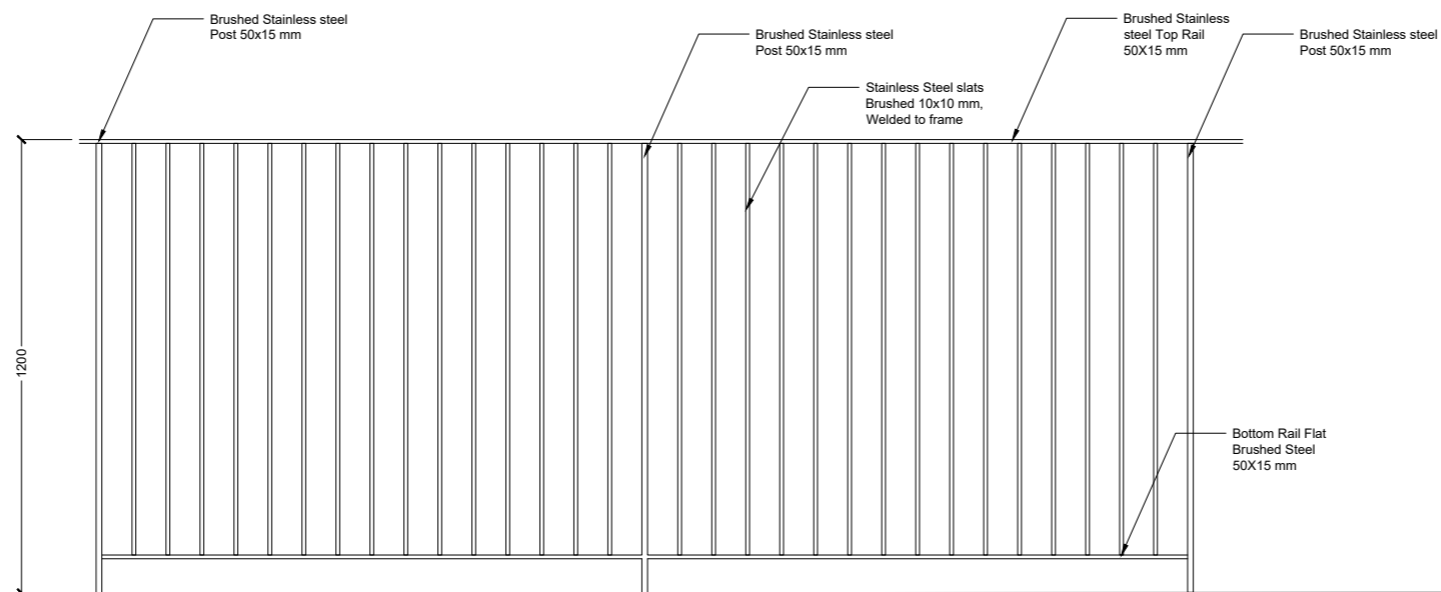

D4 TYPICAL ELEVATION
1/10

revision	date	by	chkd	appr	description
A	20/09/2021	GS	DoS	DoS	PLANNING CONDITION DISCHARGE

landscape architect
Gustafson Porter + Bowman
 1 Cobham Mews
 Agar Grove
 London NW1 9SB
 t +44 (0) 207 284 8950
 e enquiries@gp-b.com
 www.gp-b.com

architect SQUIRE & PARTNERS	engineer atelier ten
project manager AVISON YOUNG	specialist Pell Frischmann

client
SEAFORTH LAND

project
Space House

drawing title
**Car Park Ramp Railings
 Location 05**

drawing number
18077-GPB-ZZ-00-DR-L-04319

scale (@ A1) VAR.	date 20/09/2020	revision A
drawn by NK	checked by DoS	approved by DoS

Do not scale off this drawing. Use figured dimensions only. All dimensions and levels to be checked and confirmed on site. Gustafson Porter + Bowman does not accept responsibility for accuracy of survey information. Do not build from this drawing. This drawing is copyright.

Location 05

SQUIRE & PARTNERS

The Department Store, 248 Ferndale Road,
Brixton SW9 8FR
020 7278 5555 info@squireandpartners.com
www.squireandpartners.com