

100mm @ A1 (50mm @ A3)

- 1 This drawing is to be read in conjunction with all relevant architects, engineers and specialists drawings and specifications.
- 2 Do not scale from this drawing in either paper or digital form. Use written dimensions only. To check drawing has been printed to the intended scale the above bar should be 100mm long.
- 3 This is a Grade II listed building. No works are to be carried out prior to receiving listed building consent. All works shall be carried out sensitively to the existing building fabric and minimise vibration to avoid damage to existing structures.
- 4 Existing structure has been stripped out and some areas of soffit are in poor condition. Any areas where there has been loss of full depth of clinker concrete this shall be reinstated. Where filler joists are exposed from beneath cover shall be reinstated. Refer to HTS general notes sheet for further details. Contractor shall visit site to assess existing slabs in order to provide cost.
- 5 Existing location and levels of below ground drainage runs and outfalls is currently unknown. Assumptions have been made on the slab demolition and reinstatement shown in these drawings, which may change following receipt of survey data. It has been assumed no alterations to existing foundations will be required to accommodate new below ground drainage runs.
- 6 All information on the existing foundations structures are indicative as no geotechnical investigations have been carried out. Contractor to confirm profile and depth of existing footings prior to any alterations being made to existing foundations.

NOTE:
All existing details shown are based on archive drawings and limited opening up works. Assumptions have been made regarding existing construction. Materials, construction, framing and spans of existing slabs and walls to be confirmed by site investigations.

Slab levels shown in red have been derived from assumed finishes and are to be confirmed by site investigations.

Extg Steel Columns		Extg Steel Beams	
Ref	Type	Ref	Type
EC1	Existing Steel Column	EB1	Existing Steel Beam

Extg Floors	
Ref	Type
E1	Existing Filler Joist Floor
E2	Existing Structural Slab (TBC)

Existing Legend	
	Existing structural walls
	Existing structure below
	Existing padstone, TBC on site

P2	13.10.21	LG	GW	Revised Stage 3 Issue
P1	03.09.21	JMD	GW	STAGE 3 ISSUE
Rev	Date	By	Eng	Amendment

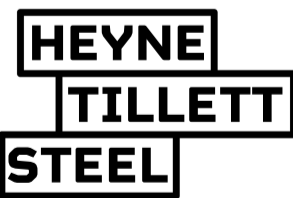

STRUCTURAL &
CIVIL ENGINEERS

<http://hts.uk.com/>

Job Name
Norfolk House
Southampton Place, 13
WC1A 2AL
Drawing Title
Existing Fifth Floor Plan

Purpose of Issue **Stage 3** Scale at A1 **1 : 50**

Drg No **2554-HTS-XX-05-DR-S-1150**

HTS Job No **S2** Suitability Rev **P2**

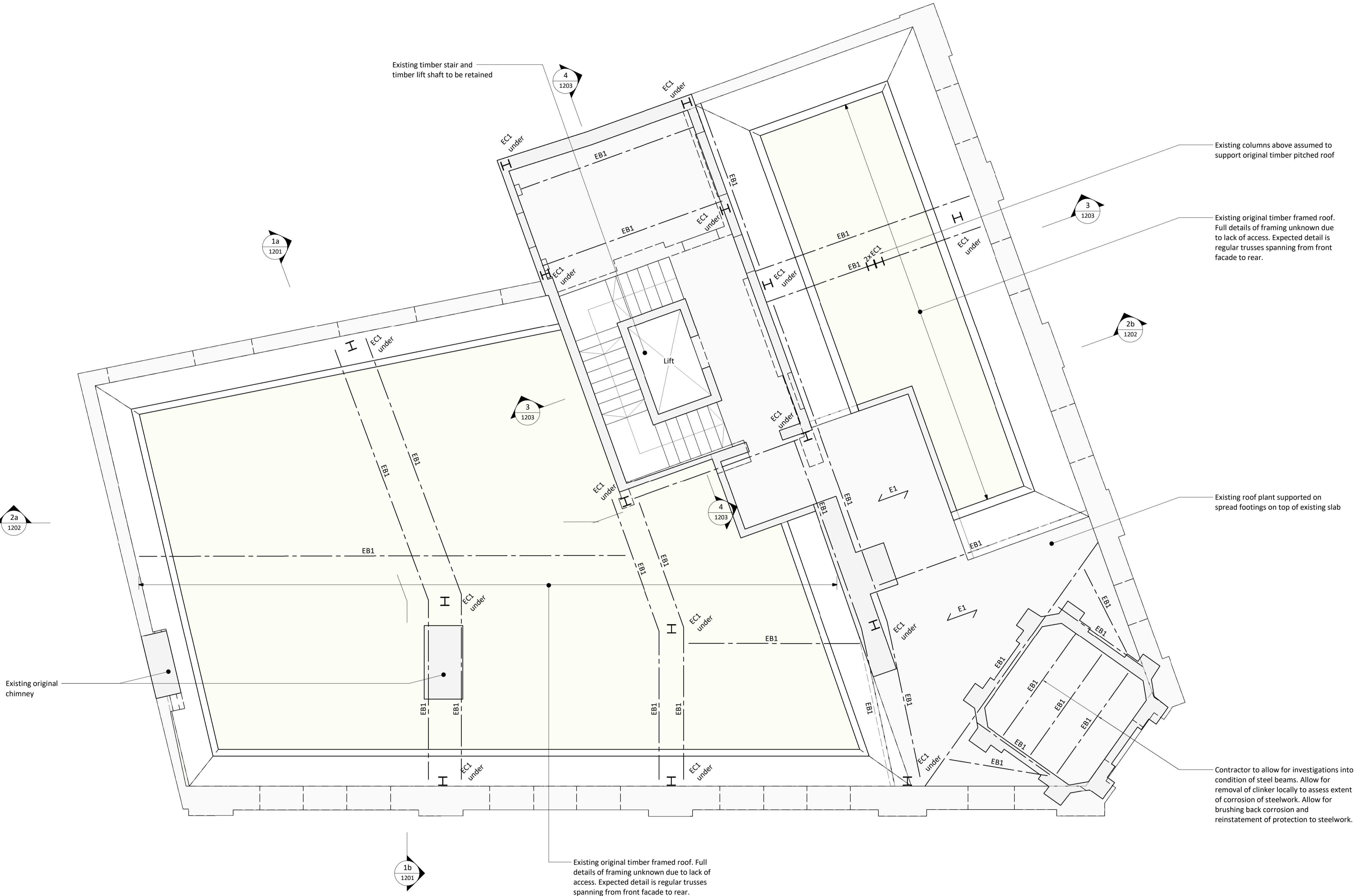

Demolition Key

1	Existing load bearing wall to be demolished. Contractor to provide temporary propping to floor structure above prior to demolition. Allow for making good to adjacent brickwork at junction between retained and demolished brickwork
2	Existing floor structure to be demolished. Contractor to allow for temporary propping to surrounding walls to provide restraint prior to demolition. Allow for making good adjacent brickwork at junction between demolished floor and retained wall structure.
3	Existing sill to be dropped to create doorway opening
4	Doorway opening created in existing masonry wall. Contractor to allow for lintel at high level to be installed prior to doorway demolition

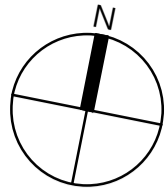

100mm @ A1 (50mm @ A3)

- This drawing is to be read in conjunction with all relevant architects, engineers and specialists drawings and specifications.
- Do not scale from this drawing in either paper or digital form. Use written dimensions only. To check drawing has been printed to the intended scale the above bar should be 100mm long
- All demolition drawings are to be read in conjunction with proposed plans
- Assume all edges of RC are to be disc-cut UNO
Where edges of slab are to be demolished, floors are to be disc cut to face of nearest beam if applicable.
- Care to be taken not to cut / adversely affect existing retained beams / columns while demolition is taking place. Contractor to undertake careful exploratory works and submit appropriate method statement to ensure retained structure is not damaged undertaking areas of demolition
- Treat all cut concrete faces with Ronabond concrete repair system by Ronacrete, or similar concrete repair system
- Temporary bracing required prior to demolition of existing stability cores and until the new stability structure is in place prior to construction of new stability structure. Contractor to submit full temporary works and sequencing proposal to the CA for review prior to commencing work
- The foundations of the existing structure must not be undermined. Upon exposing the retained structures the contractor should identify if any proposed excavation levels are deeper than the existing founding levels and notify the engineer accordingly

The existing structural information shown on these drawings is based on visual inspection of the building, limited opening up works and relevant archive information. All details of the existing construction are subject to confirmation by the Contractor during the works on site. No materials are to be ordered until the relevant details and conditions are confirmed by the Contractor on site. Should the contractor discover any discrepancies between the assumed existing structure and what is found on site they should notify the engineer immediately, and await further instruction

Demolition legend

	Area of floor to be demolished
	Beam demolished / removed
	Column demolished / removed
	RC / Masonry wall demolished
	Temporary works

P2	13.10.21	LG	GW	Revised Stage 3 Issue
P1	03.09.21	JMD	GW	STAGE 3 ISSUE
Rev	Date	By	Eng	Amendment

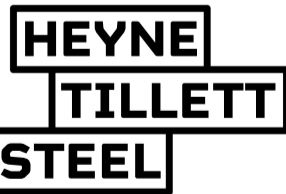

STRUCTURAL & CIVIL ENGINEERS

<http://hts.uk.com/>

Job Name
Norfolk House
Southampton Place, 13
WC1A 2AL
Drawing Title
Demolition Fifth Floor Plan

Purpose of Issue **Stage 3** Scale at A1 **1 : 50**

Drg No **2554-HTS-XX-05-DR-S-2150**

HTS Job No **S2** Suitability Rev **P2**

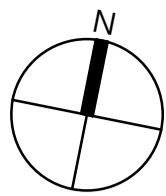

100mm @ A1 (50mm @ A3)

- This drawing is to be read in conjunction with all relevant architects, engineers and specialists drawings and specifications.
- Do not scale from this drawing in either paper or digital form. Use written dimensions only. To check drawing has been printed to the intended scale the above bar should be 100mm
- Any setting out dimensions shown in red are to be confirmed by the architect. All dimensions are to be checked by the contractor against site dimensions prior to fabrication /commencement of work on site. Beams and columns are to be centred on grid unless noted otherwise. Setting out of steelwork is shown to the centre of symmetric sections and to the back face of PFCs and RSAs.

Proposed Steel Cols

Ref	Type
C1	UC203x203x71

Proposed Steel Beams

Ref	Type
B1	UC203x203x52
B5	UC254x254x107
B6	200wd x 150dp Fabricated Box Section. 25mm webs & 40mm flanges
B7	UC203x203x86

Proposed Floors

Ref	Description
1	150 thk RC slab
2	RC slab infill

Legend

	Proposed RC structure
	Proposed WRC structure
	Proposed Steel Framing
	Red dimension TBC by architect
	MC padstone - size TBC
	ST Connection Strengthening
	C Crank
	S Splice
	M Moment connection
	TB Thermal Break
	B1 [25mm] Pre-camber
	BR Break in beam

Contractor to allow for strengthening to existing steelwork and foundations supporting lift TBC following loading from lift specialist

All exposed internal steelwork to be intumescent painted to architects details and specification

Existing soffits to be boarded over to provide fire protection to architects details and specification

Existing columns above assumed to support original timber pitched roof

Existing original timber framed roof. Full details of framing unknown due to lack of access. Expected detail is regular trusses spanning from front facade to rear.

Existing roof plant supported on spread footings on top of existing slab

Contractor to allow for investigations into condition of steel beams. Allow for removal of clinker locally to assess extent of corrosion of steelwork. Allow for brushing back corrosion and reinstatement of protection to steelwork.

Existing original timber framed roof. Full details of framing unknown due to lack of access. Expected detail is regular trusses spanning from front facade to rear.

P2	13.10.21	LG	GW	Revised Stage 3 Issue
P1	03.09.21	JMD	GW	STAGE 3 ISSUE
Rev	Date	By	Eng	Amendment

**HEYNE
TILLET
STEEL**

STRUCTURAL &
CIVIL ENGINEERS

<http://hts.uk.com/>

Job Name

Norfolk House

**Southampton Place, 13
WC1A 2AL**

Drawing Title

Proposed Fifth Floor Plan

Purpose of Issue **Stage 3** Scale at A1 **1 : 50**

Drg No **2554-HTS-XX-05-DR-S-3150**

HTS Job No **S2** Suitability Rev **P2**

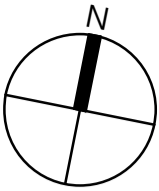
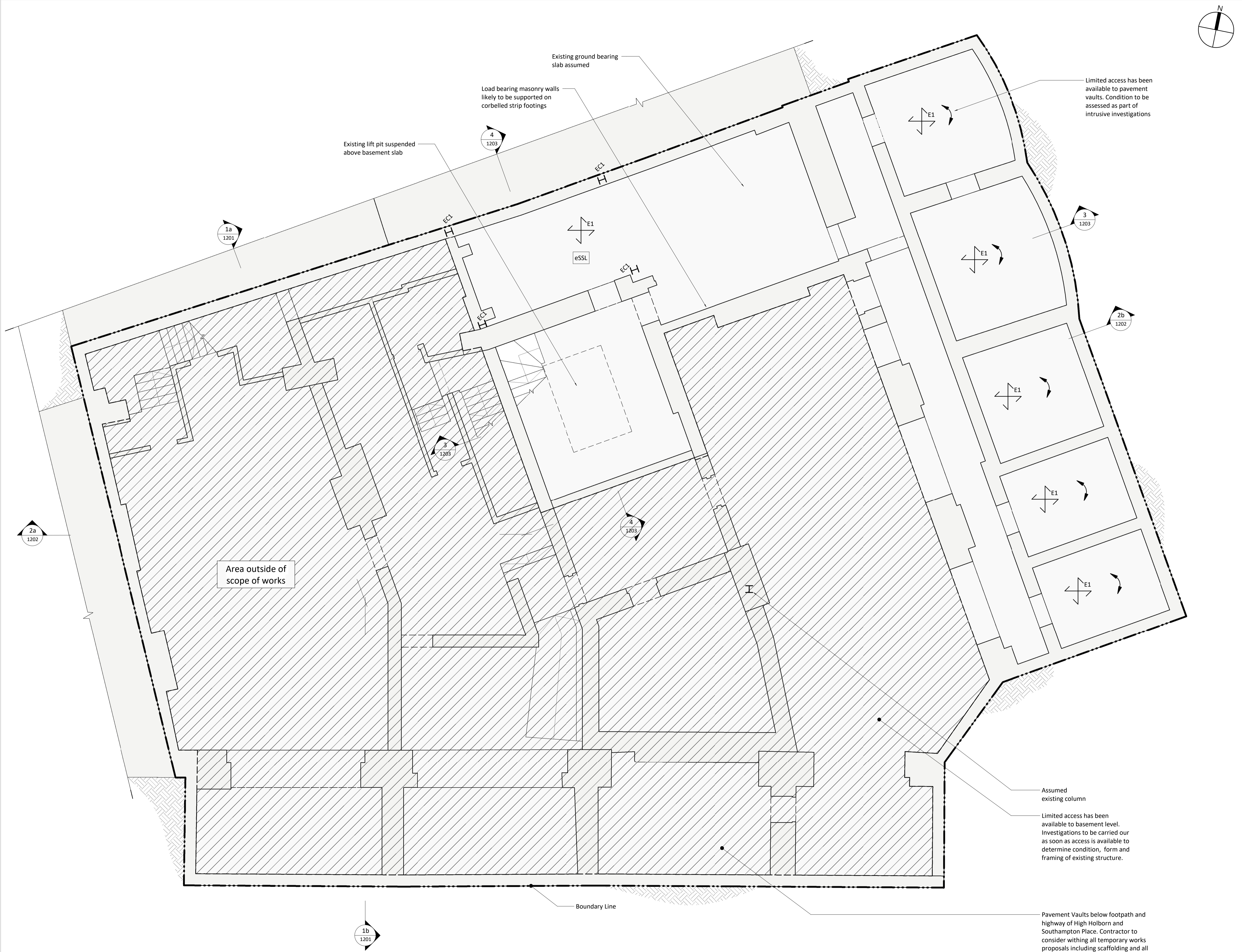

100mm @ A1 (50mm @ A3)

- 1 This drawing is to be read in conjunction with all relevant architects, engineers and specialists drawings and specifications.
- 2 Do not scale from this drawing in either paper or digital form. Use written dimensions only. To check drawing has been printed to the intended scale the above bar should be 100mm long.
- 3 This is a Grade II listed building. No works are to be carried out prior to receiving listed building consent. All works shall be carried out sensitively to the existing building fabric and minimise vibration to avoid damage to existing structures.
- 4 Existing structure has been stripped out and some areas of soffit are in poor condition. Any areas where there has been loss of full depth of clinker concrete this shall be reinstated. Where filler joists are exposed from beneath cover shall be reinstated. Refer to HTS general notes sheet for further details. Contractor shall visit site to assess existing slabs in order to provide cost.
- 5 Existing location and levels of below ground drainage runs and outfalls is currently unknown. Assumptions have been made on the slab demolition and reinstatement shown in these drawings, which may change following receipt of survey data. It has been assumed no alterations to existing foundations will be required to accommodate new below ground drainage runs.
- 6 All information on the existing foundations structures are indicative as no geotechnical investigations have been carried out. Contractor to confirm profile and depth of existing footings prior to any alterations being made to existing foundations.

NOTE:
All existing details shown are based on archive drawings and limited opening up works. Assumptions have been made regarding existing construction. Materials, construction, framing and spans of existing slabs and walls to be confirmed by site investigations.

Slab levels shown in red have been derived from assumed finishes and are to be confirmed by site investigations.

Extg Steel Columns		Extg Steel Beams	
Ref	Type	Ref	Type
EC1	Existing Steel Column	EB1	Existing Steel Beam

Extg Floors	
Ref	Type
E1	Existing Filler Joist Floor
E2	Existing Structural Slab (TBC)

Existing Legend	
	Existing structural walls
	Existing structure below
	Existing padstone, TBC on site

P2	13.10.21	LG	GW	Revised Stage 3 Issue	
P1	03.09.21	JMD	GW	STAGE 3 ISSUE	
Rev	Date	By	Eng	Amendment	

HEYNE

TILLET

STEEL

STRUCTURAL &
CIVIL ENGINEERS

<http://hts.uk.com/>

Job Name
Norfolk House
Southampton Place, 13
WC1A 2AL
Drawing Title
Existing Basement Plan

Purpose of Issue **Stage 3** Scale at A1 **1 : 50**

Drg No **2554-HTS-XX-B1-DR-S-1090**

HTS Job No **S2** Suitability Rev **P2**

Demolition Key

1	Existing load bearing wall to be demolished. Contractor to provide temporary propping to floor structure above prior to demolition. Allow for making good to adjacent brickwork at junction between retained and demolished brickwork
2	Existing floor structure to be demolished. Contractor to allow for temporary propping to surrounding walls to provide restraint prior to demolition. Allow for making good adjacent brickwork at junction between demolished floor and retained wall structure.
3	Existing sill to be dropped to create doorway opening
4	Doorway opening created in existing masonry wall. Contractor to allow for lintel at high level to be installed prior to doorway demolition

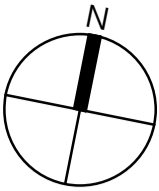
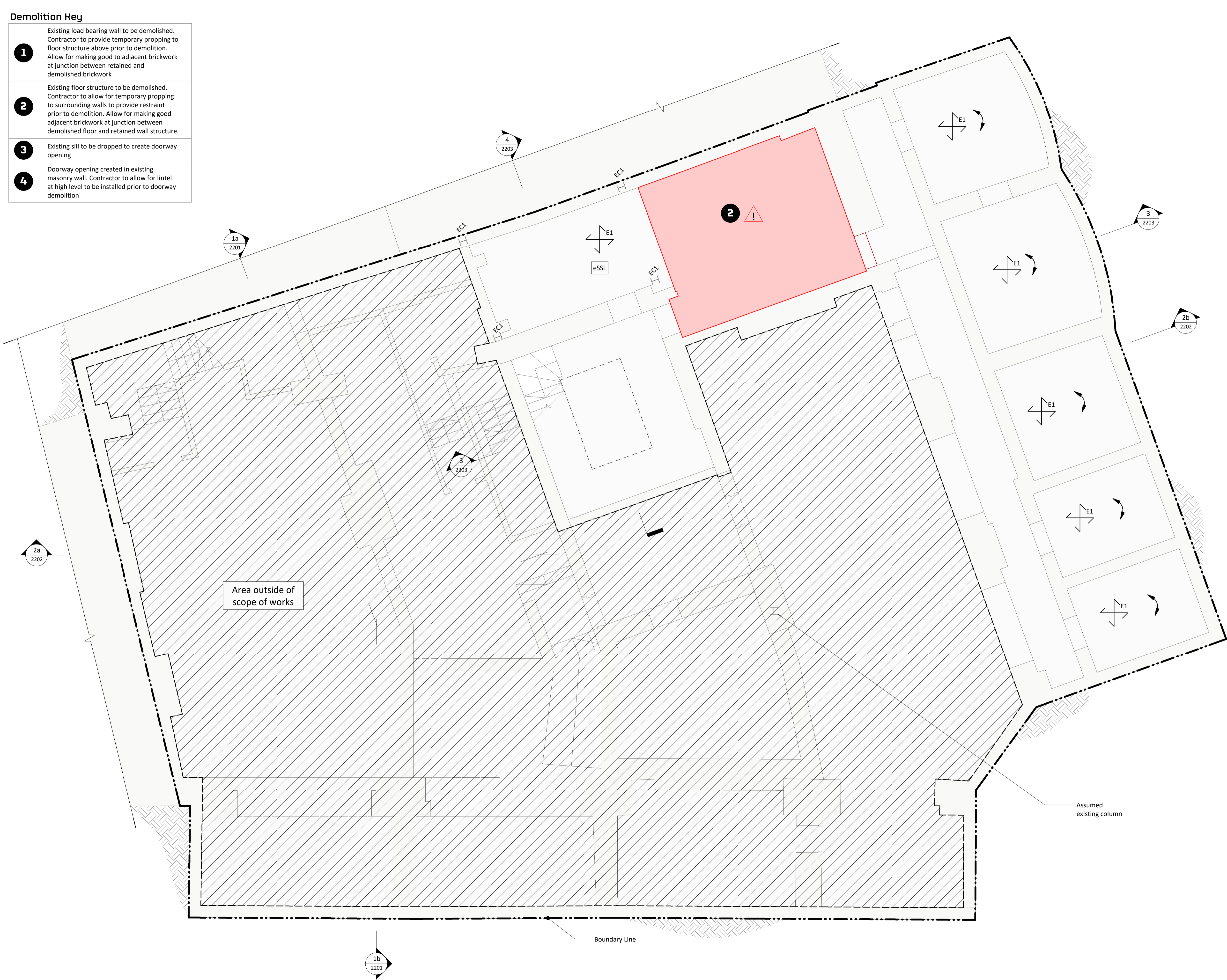

100mm @ A1 (50mm @ A3)

- This drawing is to be read in conjunction with all relevant architects, engineers and specialists drawings and specifications.
- Do not scale from this drawing in either paper or digital form. Use written dimensions only. To check drawing has been printed to the intended scale the above bar should be 100mm long
- All demolition drawings are to be read in conjunction with proposed plans
- Assume all edges of RC are to be disc-cut UNO
Where edges of slab are to be demolished, floors are to be disc cut to face of nearest beam if applicable.
- Care to be taken not to cut / adversely affect existing retained beams / columns while demolition is taking place. Contractor to undertake careful exploratory works and submit appropriate method statement to ensure retained structure is not damaged undertaking areas of demolition
- Treat all cut concrete faces with Ronabond concrete repair system by Ronacrete, or similar concrete repair system
- Temporary bracing required prior to demolition of existing stability cores and until the new stability structure is in place prior to construction of new stability structure. Contractor to submit full temporary works and sequencing proposal to the CA for review prior to commencing work
- The foundations of the existing structure must not be undermined. Upon exposing the retained structures the contractor should identify if any proposed excavation levels are deeper than the existing founding levels and notify the engineer accordingly

The existing structural information shown on these drawings is based on visual inspection of the building, limited opening up works and relevant archive information. All details of the existing construction are subject to confirmation by the Contractor during the works on site. No materials are to be ordered until the relevant details and conditions are confirmed by the Contractor on site. Should the contractor discover any discrepancies between the assumed existing structure and what is found on site they should notify the engineer immediately, and await further instruction

Demolition legend

	Area of floor to be demolished
	Beam demolished / removed
	Column demolished / removed
	RC / Masonry wall demolished
	Temporary works

P2	13.10.21	LG	GW	Revised Stage 3 Issue
P1	03.09.21	JMD	GW	STAGE 3 ISSUE
Rev	Date	By	Eng	Amendment

**HEYNE
TILLET
STEEL**

STRUCTURAL &
CIVIL ENGINEERS

<http://hts.uk.com/>

Job Name
Norfolk House
Southampton Place, 13
WC1A 2AL

Drawing Title
Demolition Basement Plan

Purpose of Issue **Stage 3** Scale at A1 1 : 50

Drg No **2554-HTS-XX-B1-DR-S-2090**

HTS Job No **S2** Suitability Rev **P2**

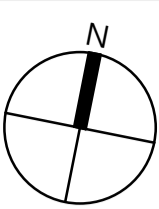
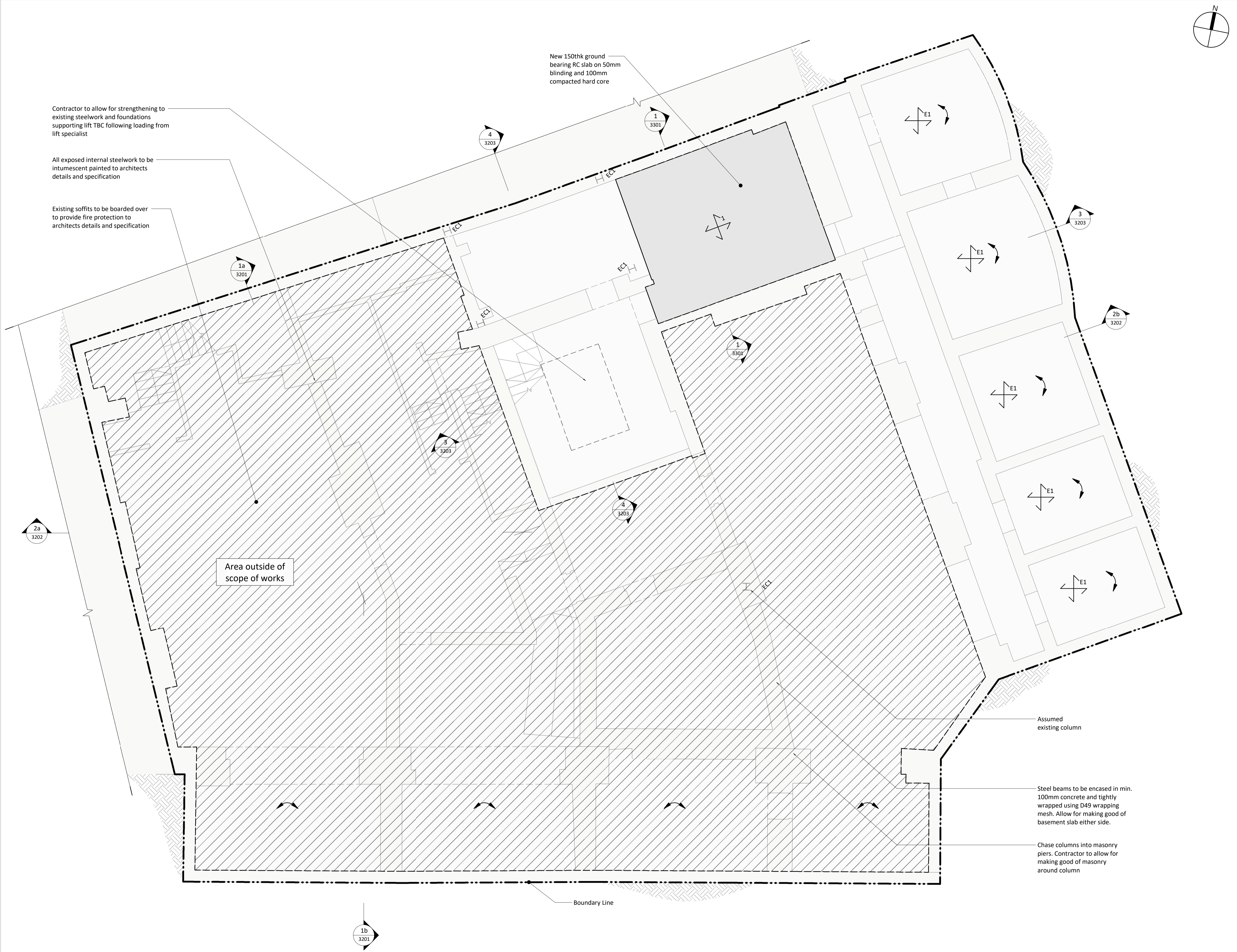

100mm @ A1 (50mm @ A3)

- This drawing is to be read in conjunction with all relevant architects, engineers and specialists drawings and specifications.
- Do not scale from this drawing in either paper or digital form. Use written dimensions only. To check drawing has been printed to the intended scale the above bar should be 100mm
- Any setting out dimensions shown in red are to be confirmed by the architect. All dimensions are to be checked by the contractor against site dimensions prior to fabrication /commencement of work on site. Beams and columns are to be centred on grid unless noted otherwise. Setting out of steelwork is shown to the centre of symmetric sections and to the back face of PFCs and RSAs.

Proposed Steel Cols

Ref	Type
C1	UC203x203x71

Proposed Steel Beams

Ref	Type
B1	UC203x203x52
B5	UC254x254x107
B6	200wd x 150dp Fabricated Box Section. 25mm webs & 40mm flanges
B7	UC203x203x86

Proposed Floors

Ref	Description
1	150 thk RC slab
2	RC slab infill

Legend

	Proposed RC structure
	Proposed WRC structure
	Proposed Steel Framing
	Red dimension TBC by architect
	MC padstone - size TBC
	Connection Strengthening
	Crank
	Splice
	Moment connection
	Thermal Break
	Break in beam
	B1 [25mm] Pre-camber

P2	13.10.21	LG	GW	Revised Stage 3 Issue
P1	03.09.21	JMD	GW	STAGE 3 ISSUE
Rev	Date	By	Eng	Amendment

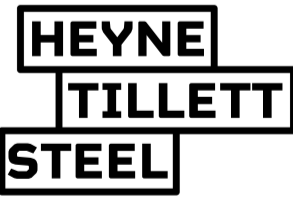

STRUCTURAL & CIVIL ENGINEERS

<http://hts.uk.com/>

Job Name
Norfolk House
Southampton Place, 13
WC1A 2AL
Drawing Title
Proposed Basement Plan

Purpose of Issue **Stage 3** Scale at A1 **1 : 50**

Drg No **2554-HTS-XX-B1-DR-S-3090**

HTS Job No **S2** Suitability Rev **P2**