

SECTION F-F

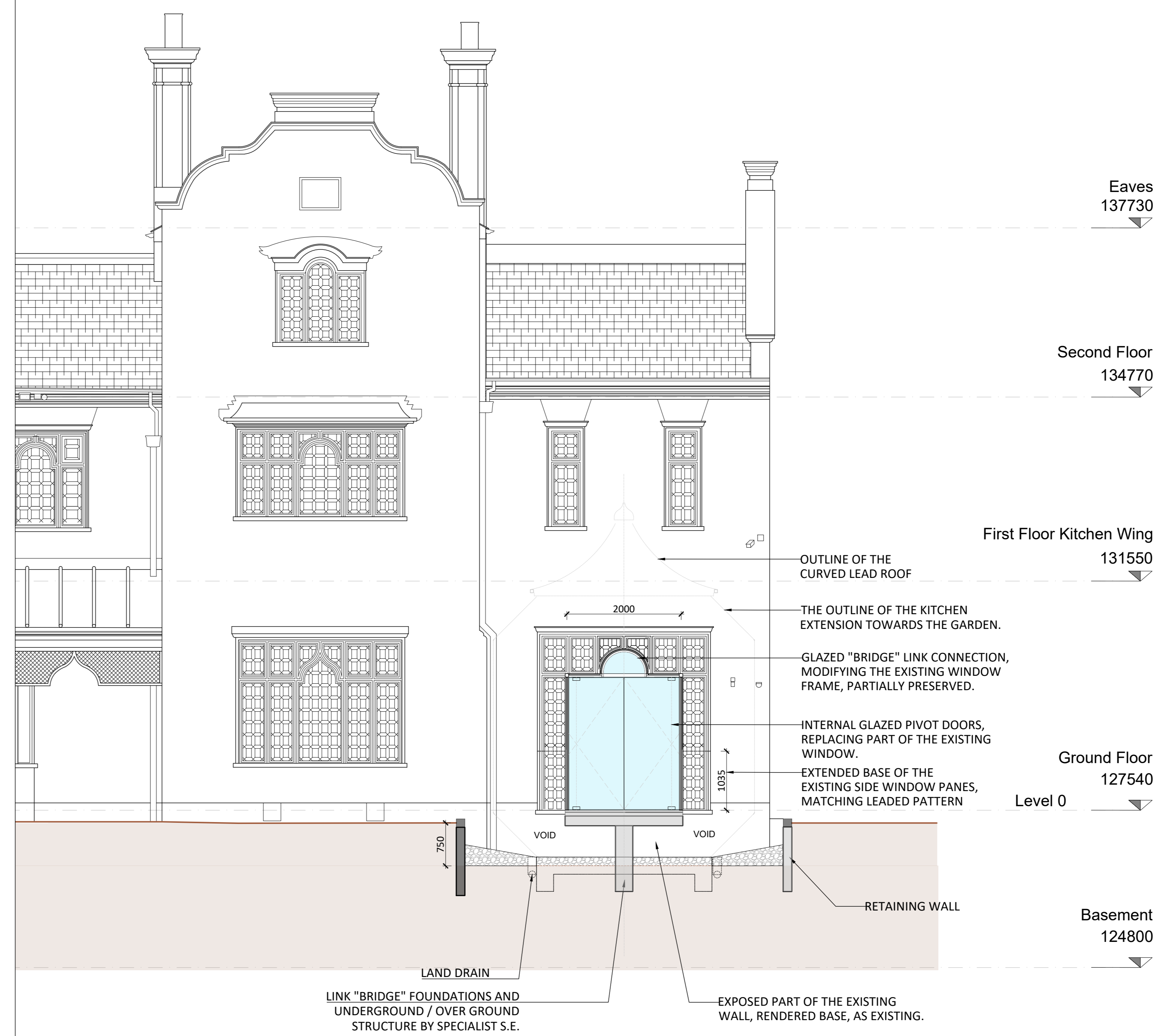

SECTION E-E

General Notes:
Report all errors, omissions and discrepancies.
Verify all dimensions on site before commencing any work on site or preparing any shop drawings.
All materials, components and workmanship are to comply with the relevant British Standards, Codes of Practice and appropriate manufacturers' recommendations that from time to time shall apply.
This drawing and design remains the property of SIAW and may not be reproduced in any way without prior consent.

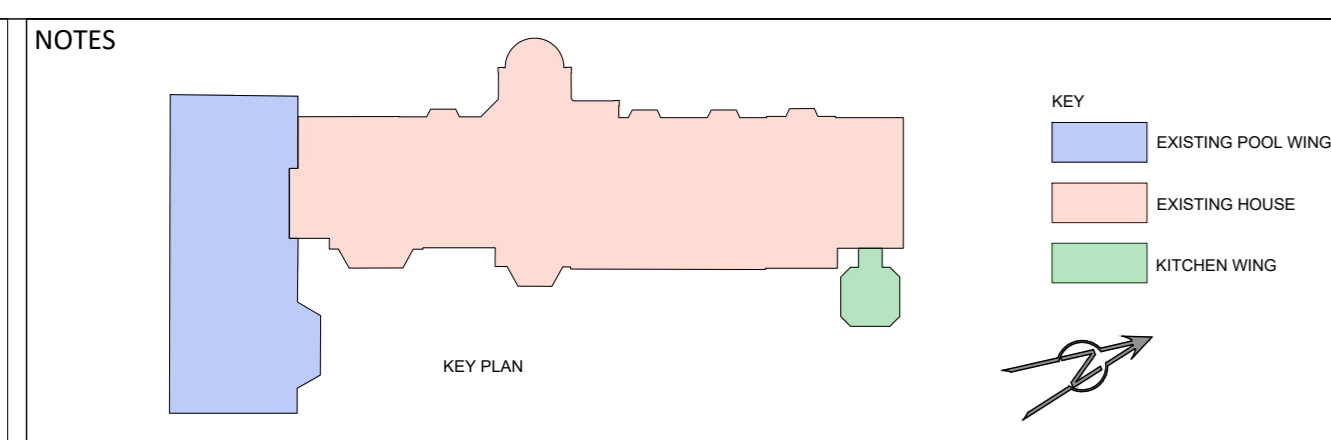

No	Date	REVISION

PROJECT
THE ELMS
COLUMBAS DRIVE
SPANIARDS ROAD, LONDON NW3 7JD

CLIENT
ELMS NOMINEES LIMITED

ZONE	DISCIPLINE	STATUS
LEVEL	ARCHITECTURE	PLANNING
CAD FILE	DRAWING NUMBER A-804	REVISION
JOB NO.	TE21	CU/SR
DRAWING TITLE	PROPOSED CROSS SECTIONS	
SCALE	DATE	DRAWN
1:50	27/10/2021	DM
		CHECKED
		BH

S. ILAN ARCHITECTURAL WORKSHOP

Winston House, 359 Regents Park Road, London, N3 1DH
T. 020 8346 0628 E. info@siaw.co.uk W. www.siaw.co.uk

PROJECT TITLE
THE ELMS

