

General Notes:
 Report all errors, omissions and discrepancies.
 Verify all dimensions on site before commencing any work on site or preparing any shop drawings.
 All materials, components and workmanship are to comply with the relevant British Standards, Codes of Practice and appropriate manufacturers' recommendations that from time to time shall apply.
 this drawing and design remains the property of SIAW and may not be reproduced in any way without prior consent.

NOTES

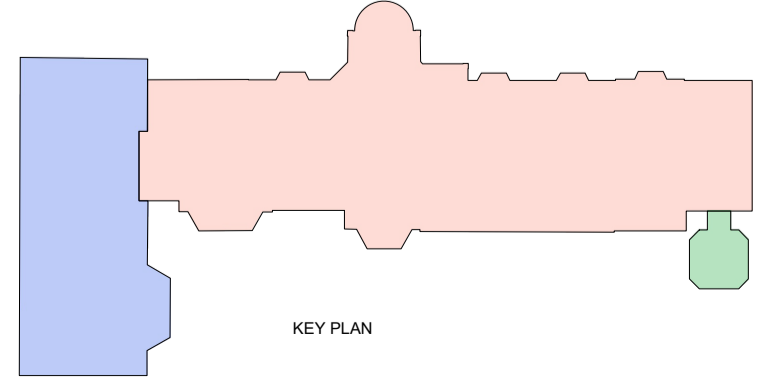

- KEY**
- EXISTING POOL WING
 - EXISTING HOUSE
 - KITCHEN WING

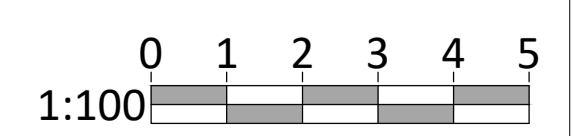

Rev	Date	Issue	REVISION

PROJECT THE ELMS COLUMBAS DRIVE SPANIARDS ROAD, LONDON NW3 7JD		CLIENT ELMS NOMINEES LIMITED	
DRAWING TITLE EXISTING GROUND FLOOR LAYOUT			
STATUS PLANNING	DRAWING NUMBER TE21-A-101	REVISION	
SCALE 1:100	SIZE A1 SHEET	DRAWN DM	CHECKED BH
		DATE 29.09.2021	



S. ILAN ARCHITECTURAL WORKSHOP

Winston House, 1st Floor, 359 Regents Park Road, London N3 1DH
 T. 020 8346 0628 E. info@siaw.co.uk W. www.siaw.co.uk

PROJECT TITLE
THE ELMS