

# 3. FLOOR PLANS - ROOF PLAN

As Approved



--- Previous Consent prior to S73 approval: Planning Permission Ref: 2015/6455/P



# 3. FLOOR PLANS - ROOF PLAN

As Proposed

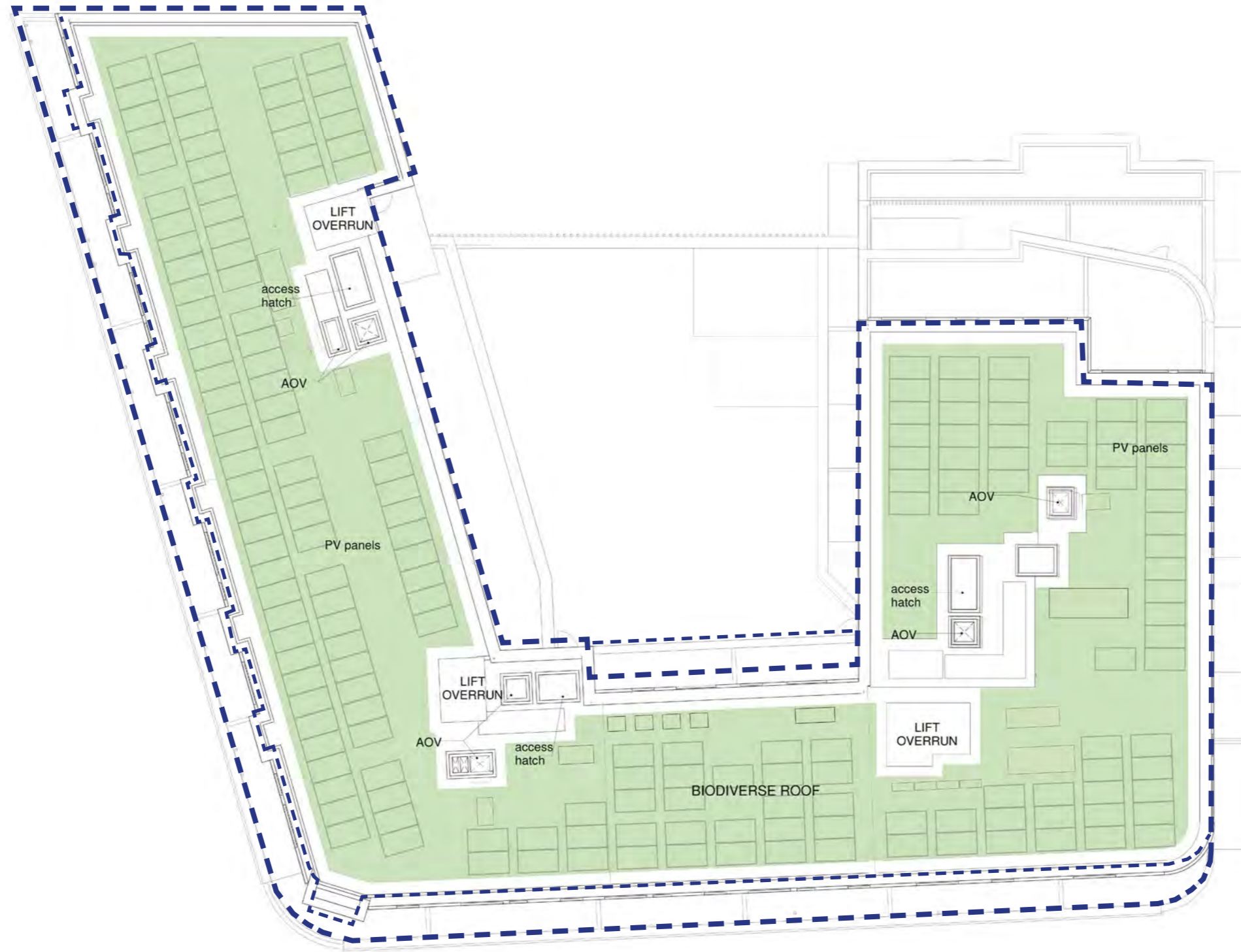

— — — — — As approved under S73 consent

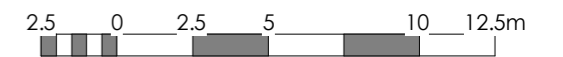



# 4. ELEVATION COMPARISON - WEST ELEVATION

As Approved



WEST END LANE

As Proposed





# 4. ELEVATION COMPARISON - SOUTH ELEVATION

As Approved



As Proposed

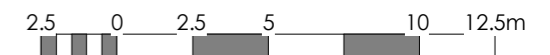



# 4. ELEVATION COMPARISON - NORTH ELEVATION

As Approved



As Proposed





# 4. ELEVATION COMPARISON - EAST ELEVATION

**As Approved**



**As Proposed**



# 5. SCHEDULE OF ACCOMMODATION

LEVEL	UNIT SIZE	QUANTITY	
		S73 APPROVED	PROPOSED
<b>FIRST FLOOR</b>			
	1B2P	8	8
	2B3P	1	1
	2B4P	1	1
	3B4P	1	1
	3B5P	1	1
		<b>12</b>	<b>12</b>
<b>SECOND FLOOR</b>			
	1B2P	9	9
	2B3P	1	1
	2B4P	2	2
	3B4P	1	1
	3B5P	2	2
	4B5P	1	1
	3B6P	2	2
	Total units:	<b>18</b>	<b>18</b>
<b>THIRD FLOOR</b>			
	1B2P	9	9
	2B4P	3	3
	3B5P	2	2
	4B5P	1	1
	3B6P	2	2
	Total units:	<b>17</b>	<b>17</b>
<b>FOURTH FLOOR</b>			
	1B2P	9	9
	2B4P	3	3
	3B5P	2	2
	4B5P	1	1
	3B6P	2	2
	Total units:	<b>17</b>	<b>17</b>
<b>FIFTH FLOOR</b>			
	1B2P	6	6
	2B3P	4	4
	2B4P	2	2
	3B4P	1	1
	3B5P	1	1
	4B5P	1	1
	Total units:	<b>15</b>	<b>15</b>
	<b>TOTAL UNITS:</b>	<b>79</b>	<b>79</b>

	WEST BLOCK UNIT MIX							Total
	S73 APPROVED							
	1B2P	2B3P	2B4P	3B4P	3B5P	4B5P	3B6P	
West Block	41	6	11	3	8	4	6	79
	PROPOSED							Total
	1B2P	2B3P	2B4P	3B4P	3B5P	4B5P	3B6P	
	West Block	41	6	11	3	8	4	



# 6. APPENDIX - DRAWING LIST

DRAWINGS LIST				
S73 DRAWING NAME	S73 APPROVED	S96A APPROVED	PROPOSED DRAWING	PROPOSED
<b>SITE PLAN</b>				
SITE PLAN	P18-048 SK0000 Rev --	0001-A-CTA-SKE-98-ZZ-1000 Rev -	SITE PLAN	0001-A-CTA-SKE-98-ZZ-1000 Rev A
<b>COMBINED FLOOR PLANS</b>				
Ground Floor Plan	P18-048 SK (00) P007 Rev R	0001-A-CTA-SKE-98-00-5651 Rev -	Ground Floor Plan	0001-A-CTA-SKE-98-00-5651 Rev A
First Floor Plan	P18-048 SK (01) P005 Rev R	0001-A-CTA-SKE-98-01-5652 Rev -	First Floor Plan	0001-A-CTA-SKE-98-01-5652 Rev A
Second Floor Plan	P18-048 SK (02) P003 Rev V	0001-A-CTA-SKE-98-02-5653 Rev -	Second Floor Plan	0001-A-CTA-SKE-98-02-5653 Rev A
Third Floor Plan	P18-048 SK (03) P003 Rev Q	0001-A-CTA-SKE-98-03-5654 Rev -	Third Floor Plan	0001-A-CTA-SKE-98-03-5654 Rev A
Fourth Floor Plan	P18-048 SK (04) P003 Rev Q	0001-A-CTA-SKE-98-04-5655 Rev -	Fourth Floor Plan	0001-A-CTA-SKE-98-04-5655 Rev A
Fifth Floor Plan	P18-048 SK (05) P003 Rev P	0001-A-CTA-SKE-98-05-5656 Rev -	Fifth Floor Plan	0001-A-CTA-SKE-98-05-5656 Rev A
Roof Plan	P18-048 SK (06) P003 Rev PL	0001-A-CTA-SKE-98-RF-5657 Rev -	Roof Plan	0001-A-CTA-SKE-98-RF-5657 Rev A
<b>FLOOR PLANS</b>				
Ground Floor Plan – West Building	P18-048 SK2101 Rev C		Ground Floor Plan – West Building	0001-A-CTA-SKE-98-00-3010 Rev -
First Floor Plan – West Building	P18-048 SK2102 Rev B		First Floor Plan – West Building	0001-A-CTA-SKE-98-01-3011 Rev -
Second Floor Plan – West Building	P18-048 SK2103 Rev B		Second Floor Plan – West Building	0001-A-CTA-SKE-98-02-3012 Rev -
Third Floor Plan – West Building	P18-048 SK2104 Rev B		Third Floor Plan – West Building	0001-A-CTA-SKE-98-03-3013 Rev -
Fourth Floor Plan – West Building	P18-048 SK2105 Rev B		Fourth Floor Plan – West Building	0001-A-CTA-SKE-98-04-3014 Rev -
Fifth Floor Plan – West Building	P18-048 SK2106 Rev B		Fifth Floor Plan – West Building	0001-A-CTA-SKE-98-05-3015 Rev -
Roof Plan – West Building	P18-048 SK2107 Rev B		Roof Plan – West Building	0001-A-CTA-SKE-98-RF-3016 Rev -
<b>ELEVATION &amp; BAY STUDY</b>				
Elevation – West End Lane Elevation	P18-048 PL(EL) P030 Rev. A		Elevation – West End Lane Elevation	0001-A-CTA-SKE-98-ZZ-3020 Rev -
Elevation – South (West Building)	P18-048 PL(EL) P031 Rev. B		Elevation – South (West Building)	0001-A-CTA-SKE-98-ZZ-3021 Rev -
Elevation – North Elevation (West Building)	P18-048 PL(EL) P034 Rev. D		Elevation – North Elevation (West Building)	0001-A-CTA-SKE-98-ZZ-3022 Rev -
Elevation – Central Courtyard (West Building)	P18-048 PL(EL) P037 Rev. E		Elevation – Central Courtyard (West Building)	0001-A-CTA-SKE-98-ZZ-3023 Rev -
Elevation – West Courtyard	P18-048 PL(EL) P039 Rev. E		Elevation – West Courtyard	0001-A-CTA-SKE-98-ZZ-3025 Rev -
Elevation – Courtyards North	P18-048 PL(EL) P040 Rev. B	0001-A-CTA-SKE-98-XX-5560 Rev -	Elevation – Courtyards North	0001-A-CTA-SKE-98-XX-5560 Rev A
West End Lane Bay Study	P18-048 PL(EL) P050 Rev. B		West Block - West End Lane Façade Bay	0001-A-CTA-SKE-98-ZZ-1350 Rev -
South Elevation (West Building)	P18-048 PL(EL) P051 Rev. B		West Block - South Elevation Façade Bay	0001-A-CTA-SKE-98-ZZ-1351 Rev -
<b>PLAN - SECOND FLOOR RELATIONSHIP TO ADJACENT PROPERTIES</b>				
Plan - Second Floor Relationship to adjacent properties	P18-048 SK(GE)P210 Rev. B	0001-A-CTA-SKE-98-02-5584 Rev -	Plan - Second Floor Relationship to adjacent properties	0001-A-CTA-SKE-98-02-5584 Rev -
Elevation – Relationship to adjacent properties	P18-048 SK(GE)P216 Rev. B	0001-A-CTA-SKE-98-XX-55661 Rev -	Elevation – Relationship to adjacent properties	0001-A-CTA-SKE-98-XX-55661 Rev A
Cycle Store plans (Affordable and Intermediate)	P18-048 PL(EL) P230 Rev. B		Cycle Store plan (Affordable and Intermediate)	0001-A-CTA-SKE-98-00-3028 Rev -
<b>AFFORDABLE UNITS</b>				
Affordable Rented – Flat Type A.01	P18-048 SK (GE) P300 -		Affordable Rented – Flat Type A.01	0001-A-CTA-SKE-98-ZZ-1300 Rev -
Affordable Rented – Flat Type A.02	P18-048 SK (GE) P301 -		Affordable Rented – Flat Type A.02	0001-A-CTA-SKE-98-ZZ-1301 Rev -
Affordable Rented – Flat Type A.03	P18-048 SK (GE) P302 -		Affordable Rented – Flat Type A.03	0001-A-CTA-SKE-98-ZZ-1302 Rev -
new flat type introduced			Affordable Rented – Flat Type A.04	0001-A-CTA-SKE-98-ZZ-1303 Rev -
Affordable Rented – Flat Type A.04	P18-048 SK (GE) P303 -		Affordable Rented – Flat Type A.05	0001-A-CTA-SKE-98-ZZ-1304 Rev -
Affordable Rented – Flat Type A.05	P18-048 SK (GE) P304 -		Affordable Rented – Flat Type A.06	0001-A-CTA-SKE-98-ZZ-1305 Rev -
Affordable Rented – Flat Type A.06	P18-048 SK (GE) P305 -		Affordable Rented – Flat Type A.07	0001-A-CTA-SKE-98-ZZ-1306 Rev -
Affordable Rented – Flat Type A.07	P18-048 SK (GE) P306 -		Affordable Rented – Flat Type A.08	0001-A-CTA-SKE-98-ZZ-1307 Rev -
Affordable Rented – Flat Type A.08	P18-048 SK (GE) P307 -		Affordable Rented – Flat Type A.09	0001-A-CTA-SKE-98-ZZ-1308 Rev -
Affordable Rented – Flat Type A.09	P18-048 SK (GE) P308 -		Affordable Rented – Flat Type A.10	0001-A-CTA-SKE-98-ZZ-1309 Rev -
Affordable Rented – Flat Type A.10	P18-048 SK (GE) P309 -		Affordable Rented – Flat Type A.11	0001-A-CTA-SKE-98-ZZ-1310 Rev -
Affordable Rented – Flat Type A.11	P18-048 SK (GE) P310 -		Affordable Rented – Flat Type A.12	0001-A-CTA-SKE-98-ZZ-1311 Rev -
Affordable Rented – Flat Type A.12	P18-048 SK (GE) P311 -		Affordable Rented – Flat Type A.13	0001-A-CTA-SKE-98-ZZ-1312 Rev -
Affordable Rented – Flat Type A.13	P18-048 SK (GE) P312 -		Affordable Rented – Flat Type A.14	0001-A-CTA-SKE-98-ZZ-1313 Rev -
Affordable Rented – Flat Type A.14	P18-048 SK (GE) P313 -		Affordable Rented – Flat Type A.15	0001-A-CTA-SKE-98-ZZ-1314 Rev -
Affordable Rented – Flat Type A.15	P18-048 SK (GE) P314 -		Affordable Rented – Flat Type A.16	0001-A-CTA-SKE-98-ZZ-1315 Rev -
Affordable Rented – Flat Type A.16	P18-048 SK (GE) P315 -		Affordable Rented – Flat Type A.17	0001-A-CTA-SKE-98-ZZ-1316 Rev -
Affordable Rented – Flat Type A.17	P18-048 SK (GE) P316 -		Affordable Rented – Flat Type A.18	0001-A-CTA-SKE-98-ZZ-1317 Rev -
Affordable Rented – Flat Type A.18	P18-048 SK (GE) P317 -		Affordable Rented – Flat Type A.19	0001-A-CTA-SKE-98-ZZ-1318 Rev -
Affordable Rented – Flat Type A.19	P18-048 SK (GE) P318 -		Affordable Rented – Flat Type A.20	0001-A-CTA-SKE-98-ZZ-1319 Rev -
Affordable Rented – Flat Type A.20	P18-048 SK (GE) P319 -		Affordable Rented – Flat Type A.21	0001-A-CTA-SKE-98-ZZ-1320 Rev -
Affordable Rented – Flat Type A.21	P18-048 SK (GE) P320 -		Affordable Rented – Flat Type A.22	0001-A-CTA-SKE-98-ZZ-1321 Rev -
Affordable Rented – Flat Type A.22	P18-048 SK (GE) P321 -		Affordable Rented – Flat Type A.23	0001-A-CTA-SKE-98-ZZ-1322 Rev -
Affordable Rented – Flat Type A.23	P18-048 SK (GE) P322 -		Affordable Rented – Flat Type A.24	0001-A-CTA-SKE-98-ZZ-1323 Rev -
<b>INTERMEDIATE UNITS</b>				
Intermediate – Flat Type S.01	P18-048 SK (GE) P400 -A		Intermediate Tenure – Flat Type I.01	0001-A-CTA-SKE-98-ZZ-1324 Rev-
Intermediate – Flat Type S.02	P18-048 SK (GE) P401 -A		Intermediate Tenure – Flat Type I.02	0001-A-CTA-SKE-98-ZZ-1325 Rev-
Intermediate – Flat Type S.03	P18-048 SK (GE) P402 -A		Intermediate Tenure – Flat Type I.03	0001-A-CTA-SKE-98-ZZ-1326 Rev-
Intermediate – Flat Type S.04	P18-048 SK (GE) P403 -A		Intermediate Tenure – Flat Type I.04	0001-A-CTA-SKE-98-ZZ-1327 Rev-
Intermediate – Flat Type S.05	P18-048 SK (GE) P404 -A		Intermediate Tenure – Flat Type I.05	0001-A-CTA-SKE-98-ZZ-1328 Rev-
Intermediate – Flat Type S.06	P18-048 SK (GE) P405 -A		Intermediate Tenure – Flat Type I.06	0001-A-CTA-SKE-98-ZZ-1329 Rev-
Intermediate – Flat Type S.07	P18-048 SK (GE) P406 -A		Intermediate Tenure – Flat Type I.07	0001-A-CTA-SKE-98-ZZ-1330 Rev-
Intermediate – Flat Type S.08	P18-048 SK (GE) P407 -A		Intermediate Tenure – Flat Type I.08	0001-A-CTA-SKE-98-ZZ-1331 Rev-
Intermediate – Flat Type S.09	P18-048 SK (GE) P408 -A		Intermediate Tenure – Flat Type I.09	0001-A-CTA-SKE-98-ZZ-1332 Rev-
Intermediate – Flat Type S.10	P18-048 SK (GE) P409 -A		Intermediate Tenure – Flat Type I.10	0001-A-CTA-SKE-98-ZZ-1333 Rev-
Intermediate – Flat Type S.11	P18-048 SK (GE) P410 -A		Intermediate Tenure – Flat Type I.11	0001-A-CTA-SKE-98-ZZ-1334 Rev-
Intermediate – Flat Type S.12	P18-048 SK (GE) P411 -A		Intermediate Tenure – Flat Type I.12	0001-A-CTA-SKE-98-ZZ-1335 Rev-





**CHAPMAN TAYLOR**  
[www.chapmantaylor.com](http://www.chapmantaylor.com)