

82.000
81.000
80.000
79.000
78.000
77.000
76.000
75.000
74.000
73.000
72.000
71.000
70.000
69.000
68.000

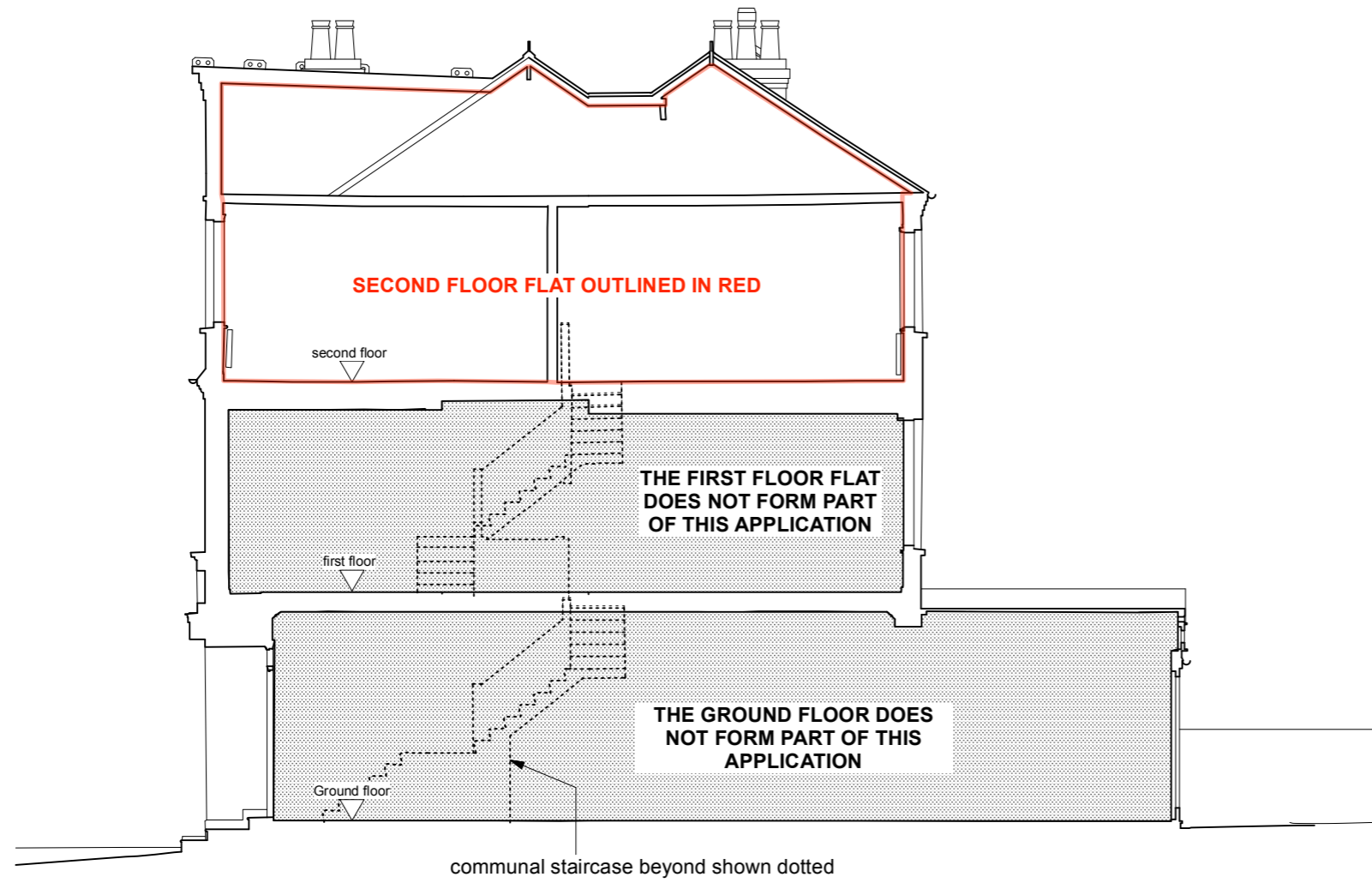

EXISTING SECTION A-A

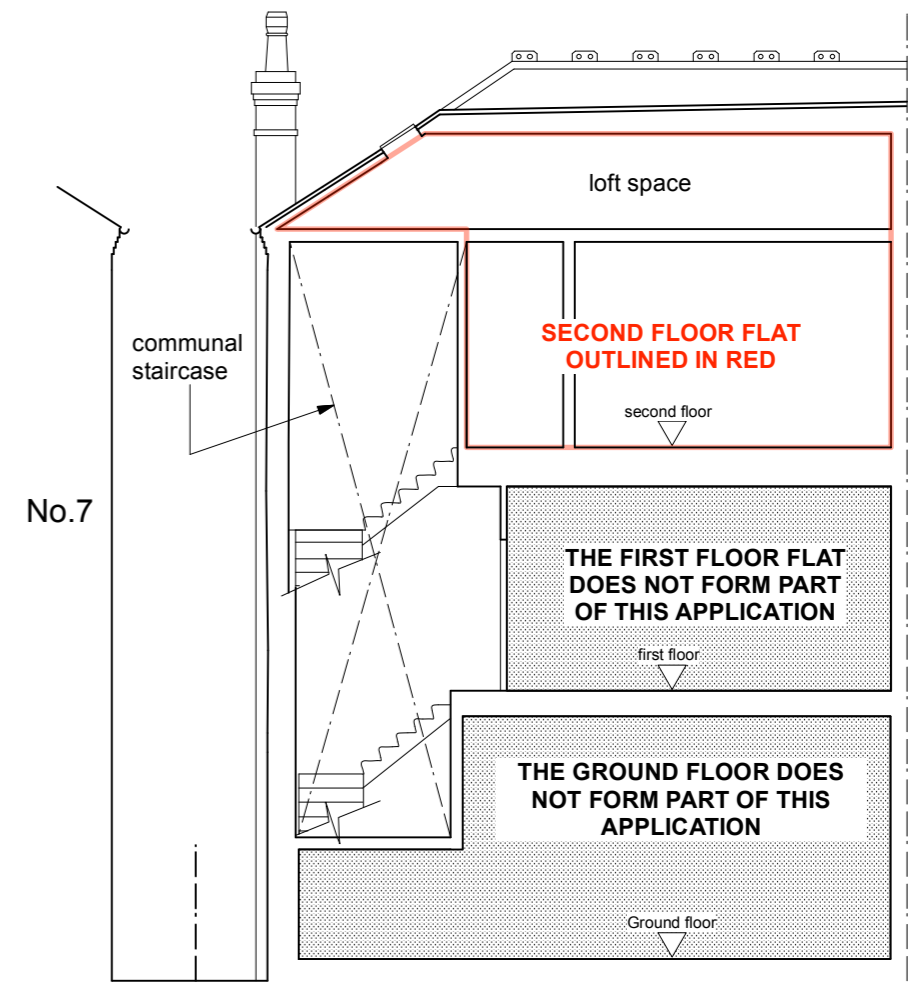

EXISTING SECTION B-B

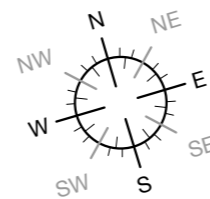
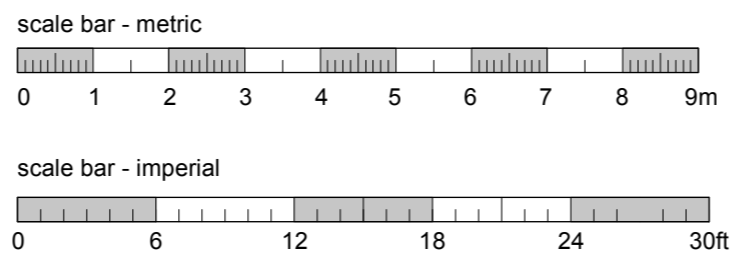

KEY:

- socket outlet (lighting)
- fuse + switch
- double socket outlet (switched)
- single pole one way switch
- pendant light
- lighting points
- multiple spotlights
- wall lights
- wall lights
- telephone socket
- Temperature Thermostat
- floor to cill, cill to head window height
- ceiling Level
- Floor Level

	CAD Surveys Ltd. Suite 2 KPC House Canterbury Road Willesborough Ashford TN24 0BP	
	www.cadsurveys.co.uk	01233 635089
Project : 9 Downside Crescent London NW3 2AN	Drawn by : SE	
Drawing title : Existing Sections		
Scale: 1:100@A3/1:50@A1	Date : 05/10/2021	Ref : 1122-S01-06