

ALL INTELLECTUAL PROPERTY RIGHTS INCLUDING DESIGN COPYRIGHTS ARE VESTED IN ENVIRONMENTAL EQUIPMENT CORPORATION LIMITED

UNDER NO CIRCUMSTANCES SHALL ANY DETAILS CONTAINED HEREIN BE RELEASED TO ANY THIRD PARTY WITHOUT THE EXPRESS WRITTEN AGREEMENT OF EEC LTD

**NOTES:**

EXTERNAL FACES TO BE COATED TO A STANDARD RAL OR BS COLOUR AND SUPPLIED WITH TOUCH UP PAINT & BRUSH.

ALL PANEL MANUFACTURING SIZES TO BE +0mm / -2mm

IF IN DOUBT ABOUT ANY DETAILS ON THIS DRAWING THEN PLEASE ASK.

PPC COLOUR TO BE ADVISED

**NOT APPROVED FOR MANUFACTURE**

No.	Reason For Issue	Date
1	FIRST ISSUE	11/11/21

Client JUDD CONSULTING (UK) LTD



**Environmental Equipment Corporation Ltd**  
 Richmond House, Churchfield Road  
 Walton-on-Thames  
 Surrey KT12 2TP  
 t: 01932 230940 f: 01932 230941  
 e: info@eecontrol.co.uk  
 www.eecnoisecontrol.co.uk

Project 10 FERNCROFT AVENUE

Title ACOUSTIC ENCLOSURE ON PLAN & ELEVATIONS

Date	Drawn	Checked	Approv.	Scale
11/11/21	LFF			1:20

Clients Ref. Job Ref. ECI8066 Paper Size A3  
 Drawing No. ECI8066-DWG-01 Issue. 1

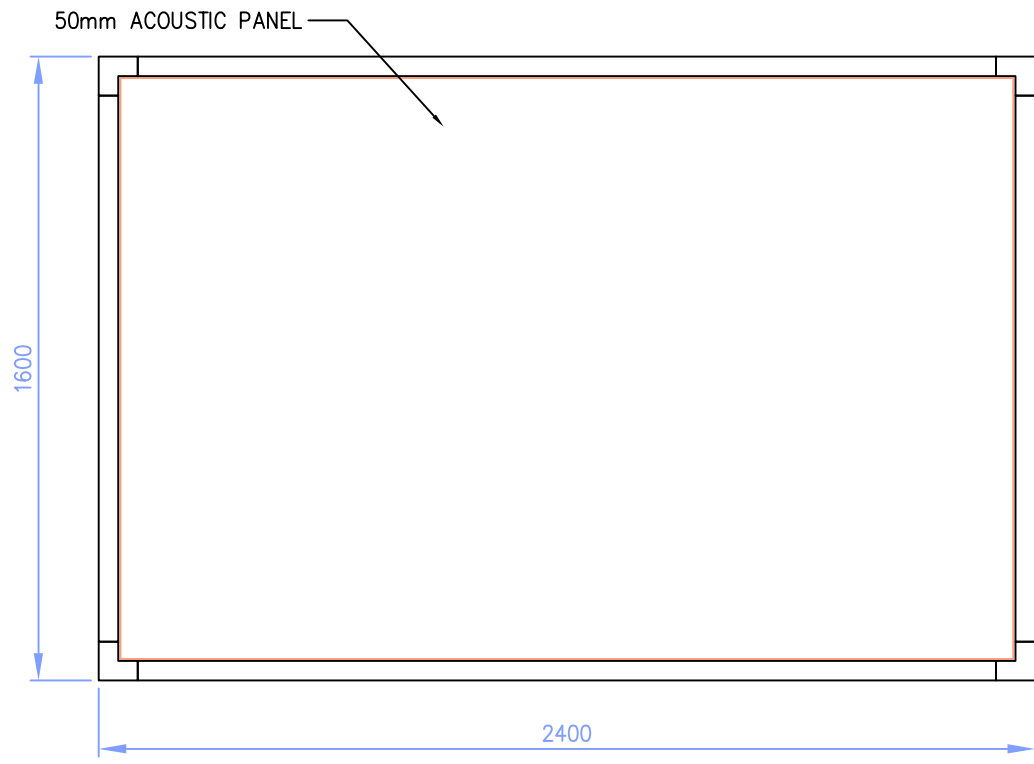

**ACOUSTIC ENCLOSURE ON PLAN VIEW**  
(SCALE 1:20)

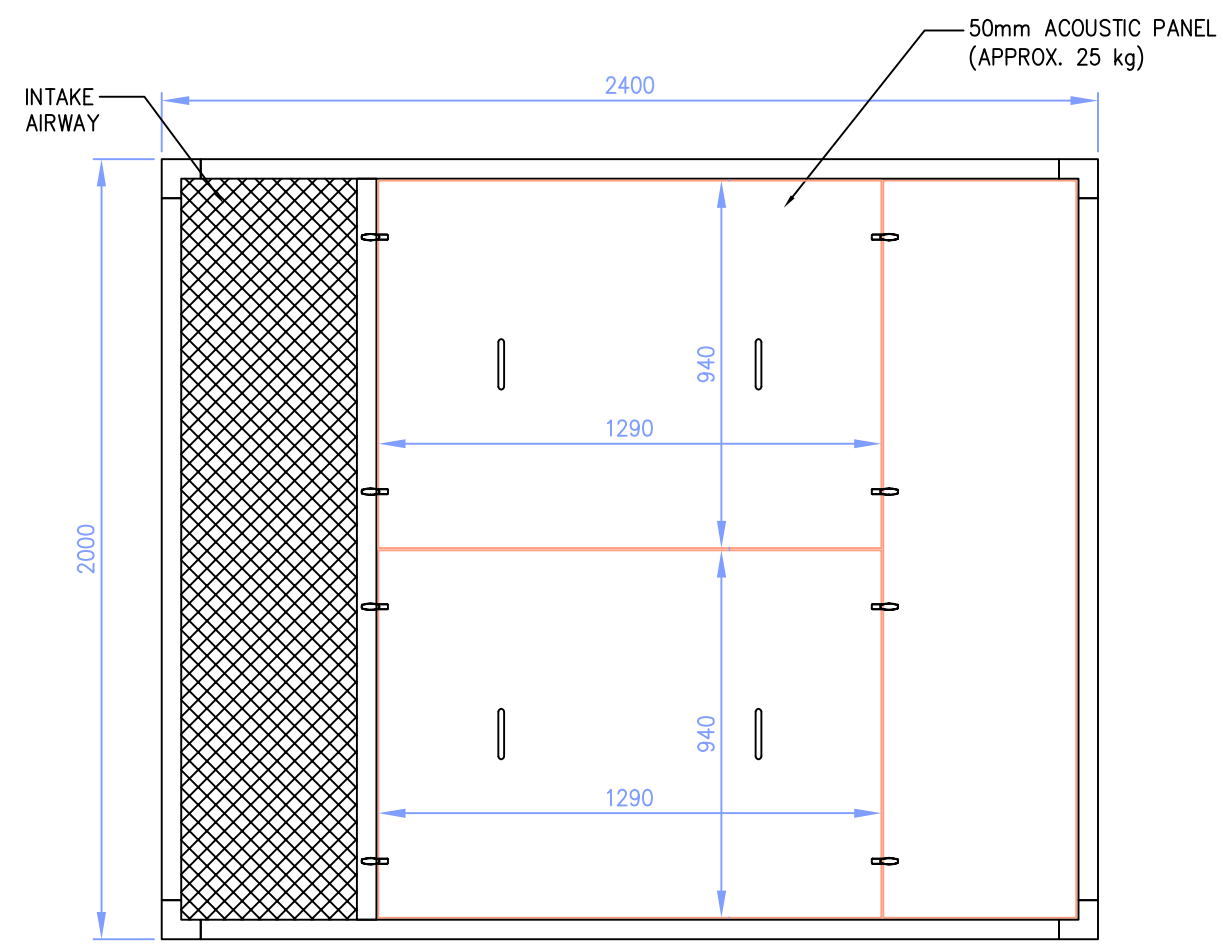

**ACOUSTIC ENCLOSURE ON FRONT ELEVATION**  
(SCALE 1:20)

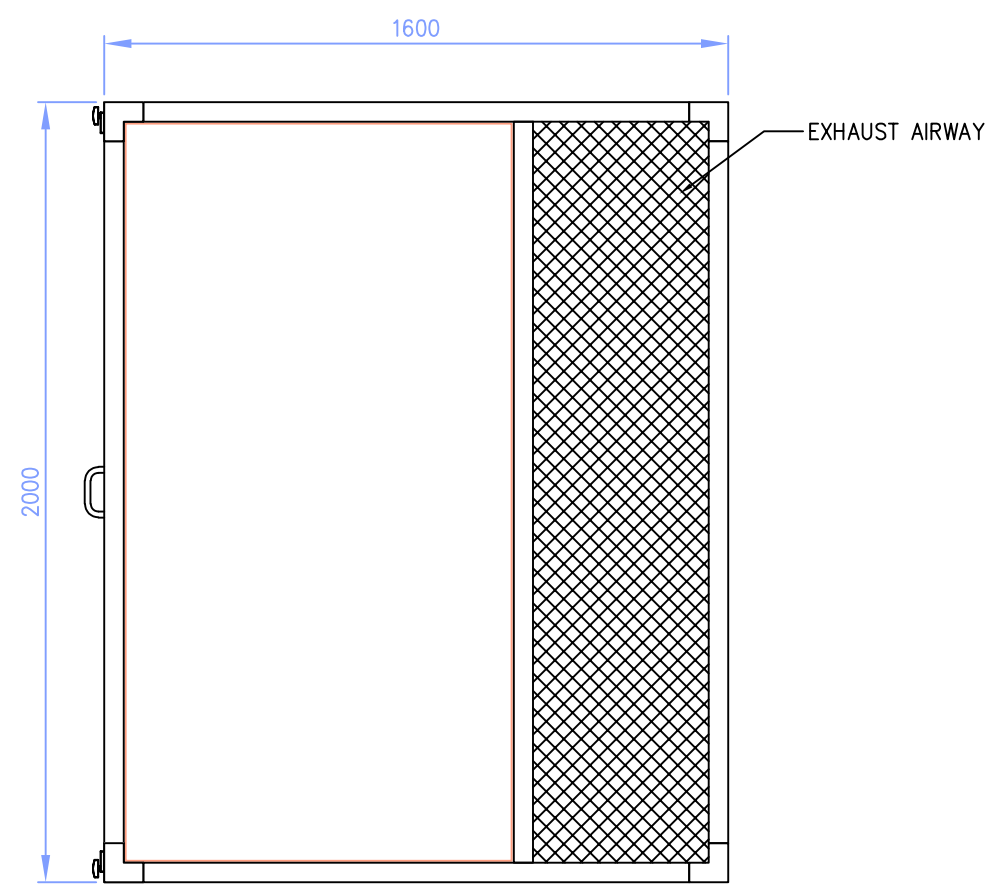

**ACOUSTIC ENCLOSURE ON SIDE ELEVATION**  
(SCALE 1:20)